



STATE OF NORTH CAROLINA
DEPARTMENT OF TRANSPORTATION

PATRICK MCCRORY
GOVERNOR

March 08, 2016

NICHOLAS J. TENNYSON
SECRETARY

MEMORANDUM TO: Mr. John Rouse, PE
Division Engineer
Division 2

FROM: Mr. John C. Farley, GISP, CPM
Manager
Geographic Information Systems Unit

SUBJECT: 2016 District 2 Road Sytem Changes

The GIS Unit's Data Conversion Group has been authorized to make the changes indicated below to the state road system. We request that you update the related maps and files in your offices and install appropriate road number signs, if necessary. If our system changes do not conform to the actual conditions in the field, please return this memorandum with recommendations.

Correction Number	County	Approval Date
COR_24_03-16_1	CRAVEN	3/3/2016

Questions or comments about changes should be referred to the GIS Help Desk at GISHelp@ncdot.gov.
Thank you for your assistance.

JCF

- cc: BSIP
- Bridge Maintenance
- Division Right of Way
- IMG
- Pavement Management
- Permit Unit
- State Road Maintenance
- Traffic Engineering
- Traffic Surveys



2016 ROAD SYSTEM CHANGES

CORRECTION REQUEST	COUNTY	APPROVAL DATE	NEW ROUTE	EXISTING ROUTE	STREET NAME	LENGTH (miles)	TYPE OF CHANGE	REMARKS (See Attached Map)
COR_24_03-16_1	CRAVEN	3/3/2016		SR 1528	RAMONA'S LAKE CT	0.10	SYSTEM ADDITION - EXISTING VIA CORRECTION REQUEST	MAP , SEGMENT

Original Document ID: 50988
BOT Date: 02/04/16

Legend

-  Addition
-  Deletion
-  Reassignment
-  SR
-  NC
-  US
-  Interstate
-  Ramp
-  Non-System
-  Obliterated

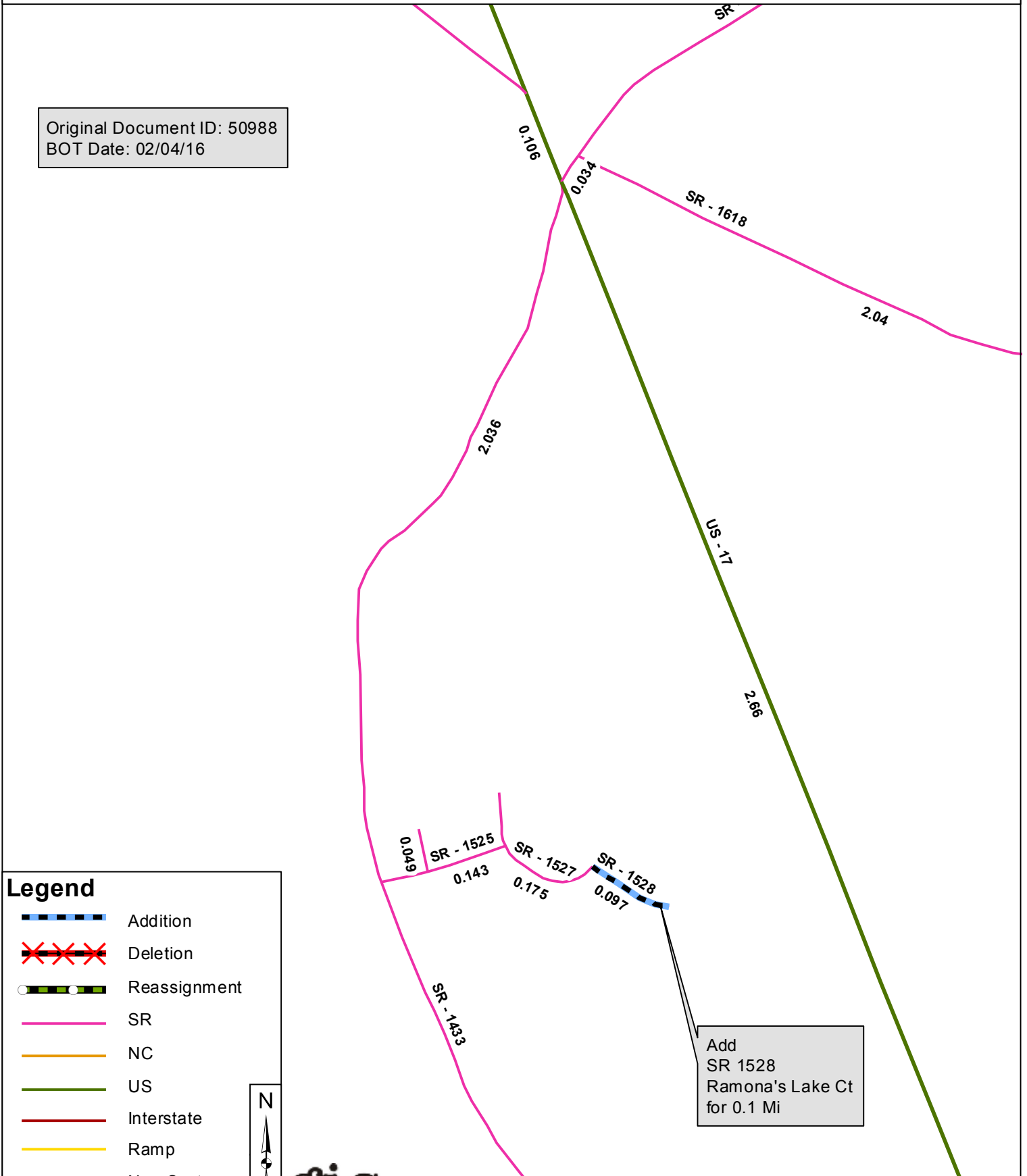
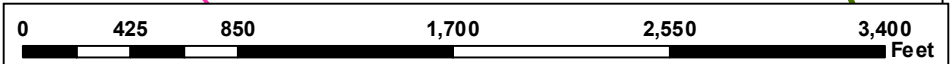

Add
SR 1528
Ramona's Lake Ct
for 0.1 Mi