



STATE OF NORTH CAROLINA
DEPARTMENT OF TRANSPORTATION

ROY COOPER
GOVERNOR

JAMES H. TROGDON, III
SECRETARY

DATE: December 12, 2017
TO: Mr. Jay Swain, PE
Division Engineer
Division 13
FROM: Mr. John C. Farley, GISP, CPM
Manager
Geographic Information Systems Unit
SUBJECT: 2017 District 1 Road System Changes

The GIS Unit's Data Conversion Group has been authorized to make the changes indicated below to the state road system. We request that you update the related maps and files in your offices and install appropriate road number signs, if necessary. If our system changes do not conform to the actual conditions in the field, please return this memorandum with recommendations.

Document Number	County	Approval Date
R-2233AB	RUTHERFORD	11/17/2015

Questions or comments about changes should be referred to the GIS Help Desk at GISHelp@ncdot.gov.
Thank you for your assistance.

JCF

cc: BSIP
Bridge Maintenance
Division Right of Way
IMG
Pavement Management
Permit Unit
State Road Maintenance
Traffic Engineering
Traffic Surveys

Mailing Address:
NC DEPARTMENT OF TRANSPORTATION
GEOGRAPHIC INFORMATION SYSTEMS
1521 MAIL SERVICE CENTER
RALEIGH, NC 27699-1521

Telephone: (919) 707-2165
Fax: (919) 707-2210
Customer Service: 1-877-368-4968
Website: www.ncdot.gov

Location:
4101 CAPITAL BLVD.
RALEIGH, NC 27604
FAX: (919) 707-2214

2017 ROAD SYSTEM CHANGES

TIP	COUNTY	APPROVAL DATE	NEW ROUTE	EXISTING ROUTE	STREET NAME	LENGTH (miles)	TYPE OF CHANGE	REMARKS (See Attached Map)
R-2233AB	RUTHERFORD	11/17/2015	SR 1226	SR 1111	JACK MCKINNEY RD	0.12	REASSIGNMENT VIA TIP	MAP A, SEGMENT
R-2233AB	RUTHERFORD	11/17/2015	SR 1227	SR 2150	BRIDGES FARM RD	0.24	REASSIGNMENT VIA TIP	MAP B, SEGMENT
R-2233AB	RUTHERFORD	11/17/2015		SR 1225	NEW BETHEL CHURCH RD	0.12	SYSTEM ADDITION - EXISTING VIA TIP	MAP A, SEGMENT
R-2233AB	RUTHERFORD	11/17/2015		SR 1111	JACK MCKINNEY RD	0.11	SYSTEM ADDITION - EXISTING VIA TIP	MAP A, SEGMENT
R-2233AB	RUTHERFORD	11/17/2015		SR 2287	JAYNES RD	0.07	SYSTEM ADDITION - EXISTING VIA TIP	MAP A, SEGMENT
R-2233AB	RUTHERFORD	11/17/2015		SR 1136	NEW BETHEL CHURCH RD	0.11	SYSTEM ADDITION - EXISTING VIA TIP	MAP A, SEGMENT
R-2233AB	RUTHERFORD	11/17/2015		SR 1137	ARTHUR HENSON RD	0.04	SYSTEM ADDITION - EXISTING VIA TIP	MAP B, SEGMENT
R-2233AB	RUTHERFORD	11/17/2015		SR 1150	LONG BRANCH RD	0.01	SYSTEM ADDITION - EXISTING VIA TIP	MAP C, SEGMENT
R-2233AB	RUTHERFORD	11/17/2015		SR 1139	TOMS LAKE RD	0.01	SYSTEM ADDITION - EXISTING VIA TIP	MAP C, SEGMENT
R-2233AB	RUTHERFORD	11/17/2015		SR 1148	SHILOH RD	0.12	SYSTEM ADDITION - EXISTING VIA TIP	MAP C, SEGMENT

TIP	COUNTY	APPROVAL DATE	NEW ROUTE	EXISTING ROUTE	STREET NAME	LENGTH (miles)	TYPE OF CHANGE	REMARKS (See Attached Map)
R-2233AB	RUTHERFORD	11/17/2015		SR 2213	BETHANY CHURCH RD	0.05	SYSTEM ADDITION - EXISTING VIA TIP	MAP C, SEGMENT
R-2233AB	RUTHERFORD	11/17/2015		SR 2164	TANNERS GROVE RD	0.06	SYSTEM ADDITION - EXISTING VIA TIP	MAP C, SEGMENT
R-2233AB	RUTHERFORD	11/17/2015		SR 2171	BURCH HUTCHINS RD	0.24	SYSTEM ADDITION - EXISTING VIA TIP	MAP D, SEGMENT
R-2233AB	RUTHERFORD	11/17/2015		US 221		5.69	SYSTEM ADDITION - EXISTING VIA TIP	MAP D, SEGMENT
R-2233AB	RUTHERFORD	11/17/2015		SR 1136	NEW BETHEL CHURCH RD	0.09	SYSTEM DELETION VIA TIP	MAP A, SEGMENT
R-2233AB	RUTHERFORD	11/17/2015		SR 2287	JAYNES RD	0.07	SYSTEM DELETION VIA TIP	MAP A, SEGMENT
R-2233AB	RUTHERFORD	11/17/2015		SR 1111	JACK MCKINNEY RD	0.10	SYSTEM DELETION VIA TIP	MAP A, SEGMENT
R-2233AB	RUTHERFORD	11/17/2015		SR 1137	ARTHUR HENSON RD	0.03	SYSTEM DELETION VIA TIP	MAP B, SEGMENT
R-2233AB	RUTHERFORD	11/17/2015		SR 1118	HOPPER RD	0.03	SYSTEM DELETION VIA TIP	MAP B, SEGMENT
R-2233AB	RUTHERFORD	11/17/2015		SR 2150	BRIDGES FARM RD	0.11	SYSTEM DELETION VIA TIP	MAP B, SEGMENT
R-2233AB	RUTHERFORD	11/17/2015		SR 1148	SHILOH RD	0.10	SYSTEM DELETION VIA TIP	MAP C, SEGMENT

TIP	COUNTY	APPROVAL DATE	NEW ROUTE	EXISTING ROUTE	STREET NAME	LENGTH (miles)	TYPE OF CHANGE	REMARKS (See Attached Map)
R-2233AB	RUTHERFORD	11/17/2015		SR 2169	OAKLAND RD	0.04	SYSTEM DELETION VIA TIP	MAP C, SEGMENT
R-2233AB	RUTHERFORD	11/17/2015		SR 2213	BETHANY CHURCH RD	0.06	SYSTEM DELETION VIA TIP	MAP C, SEGMENT
R-2233AB	RUTHERFORD	11/17/2015		SR 2269	BROOKMONT AVE	0.03	SYSTEM DELETION VIA TIP	MAP C, SEGMENT
R-2233AB	RUTHERFORD	11/17/2015		SR 2289	ROBBINS DR	0.01	SYSTEM DELETION VIA TIP	MAP C, SEGMENT
R-2233AB	RUTHERFORD	11/17/2015		SR 2308	NORTH WOODLEAF RD	0.01	SYSTEM DELETION VIA TIP	MAP C, SEGMENT
R-2233AB	RUTHERFORD	11/17/2015		SR 2164	TANNERS GROVE RD	0.07	SYSTEM DELETION VIA TIP	MAP C, SEGMENT
R-2233AB	RUTHERFORD	11/17/2015		SR 2171	BURCH HUTCHINS RD	0.27	SYSTEM DELETION VIA TIP	MAP D, SEGMENT

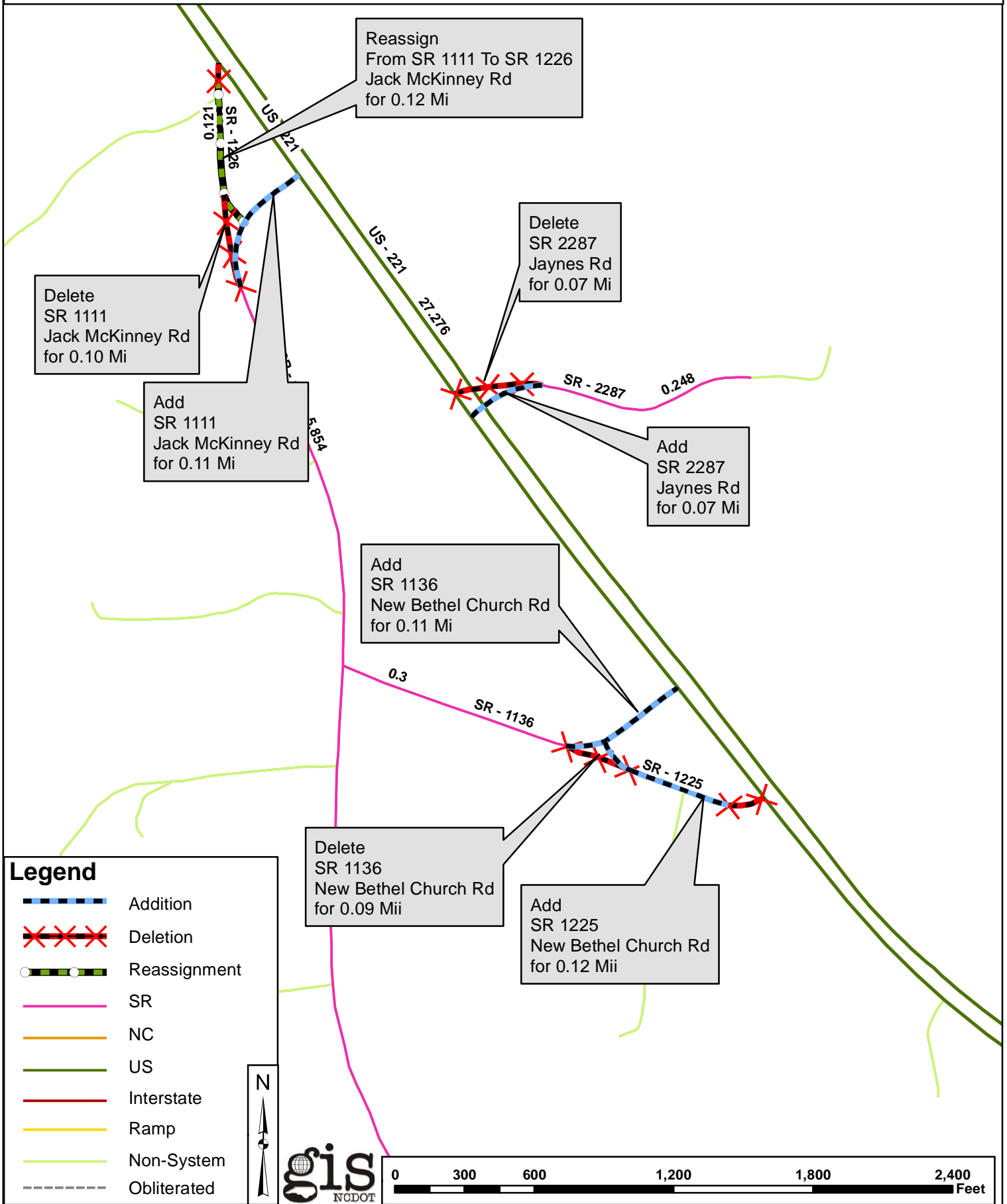

Reassign
From SR 1111 To SR 1226
Jack McKinney Rd
for 0.12 Mi

Delete
SR 1111
Jack McKinney Rd
for 0.10 Mi

Add
SR 1111
Jack McKinney Rd
for 0.11 Mi

Delete
SR 2287
Jaynes Rd
for 0.07 Mi

Add
SR 2287
Jaynes Rd
for 0.07 Mi

Add
SR 1136
New Bethel Church Rd
for 0.11 Mi

Delete
SR 1136
New Bethel Church Rd
for 0.09 Mii

Add
SR 1225
New Bethel Church Rd
for 0.12 Mii

Legend

- Addition
- Deletion
- Reassignment
- SR
- NC
- US
- Interstate
- Ramp
- Non-System
- Obliterated

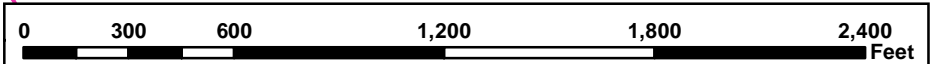

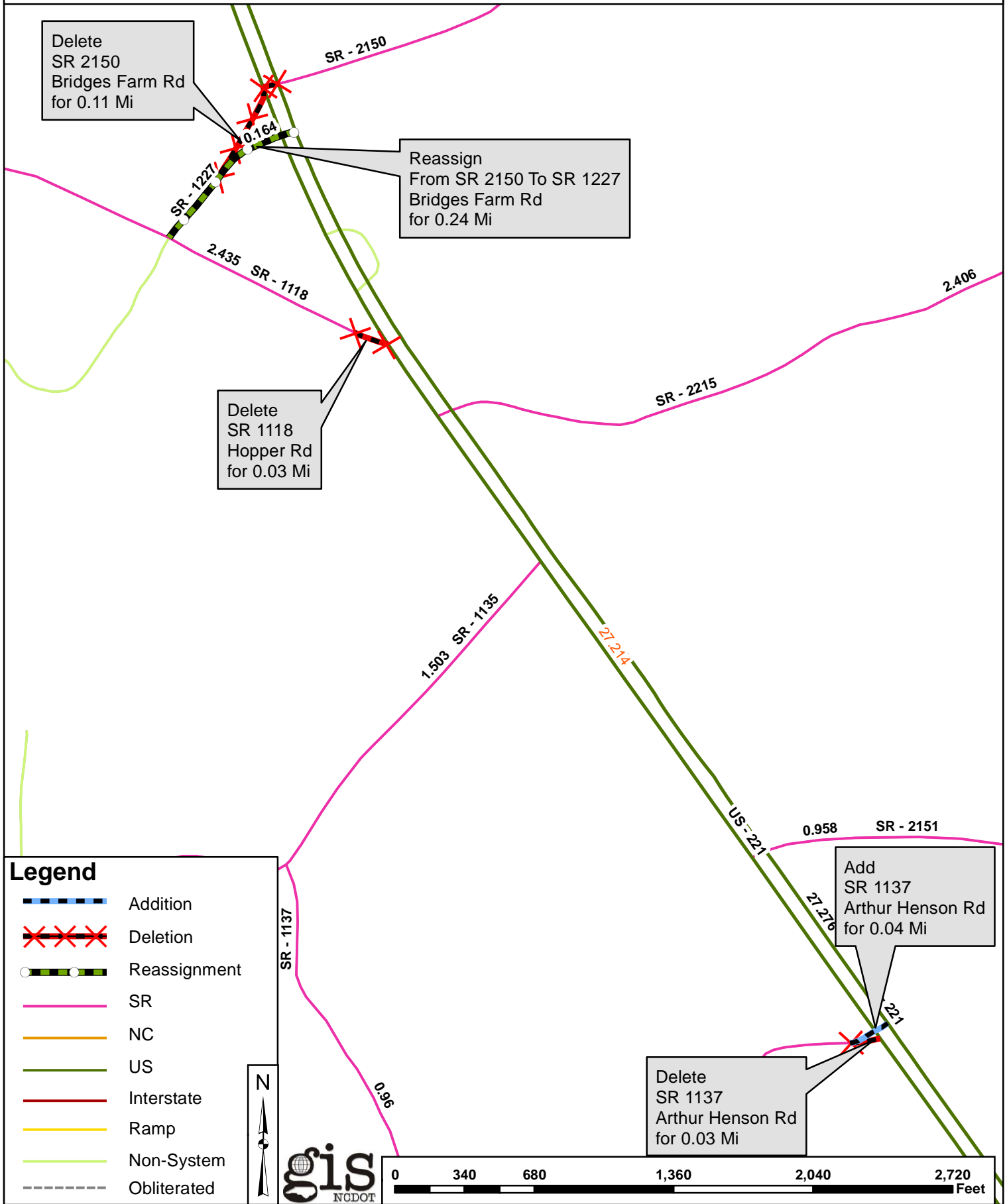

Legend

- Addition
- Deletion
- Reassignment
- SR
- NC
- US
- Interstate
- Ramp
- Non-System
- Obliterated

gis NGDOT

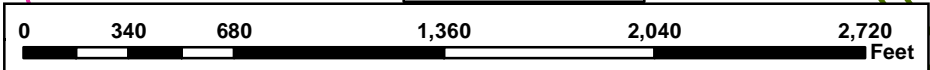

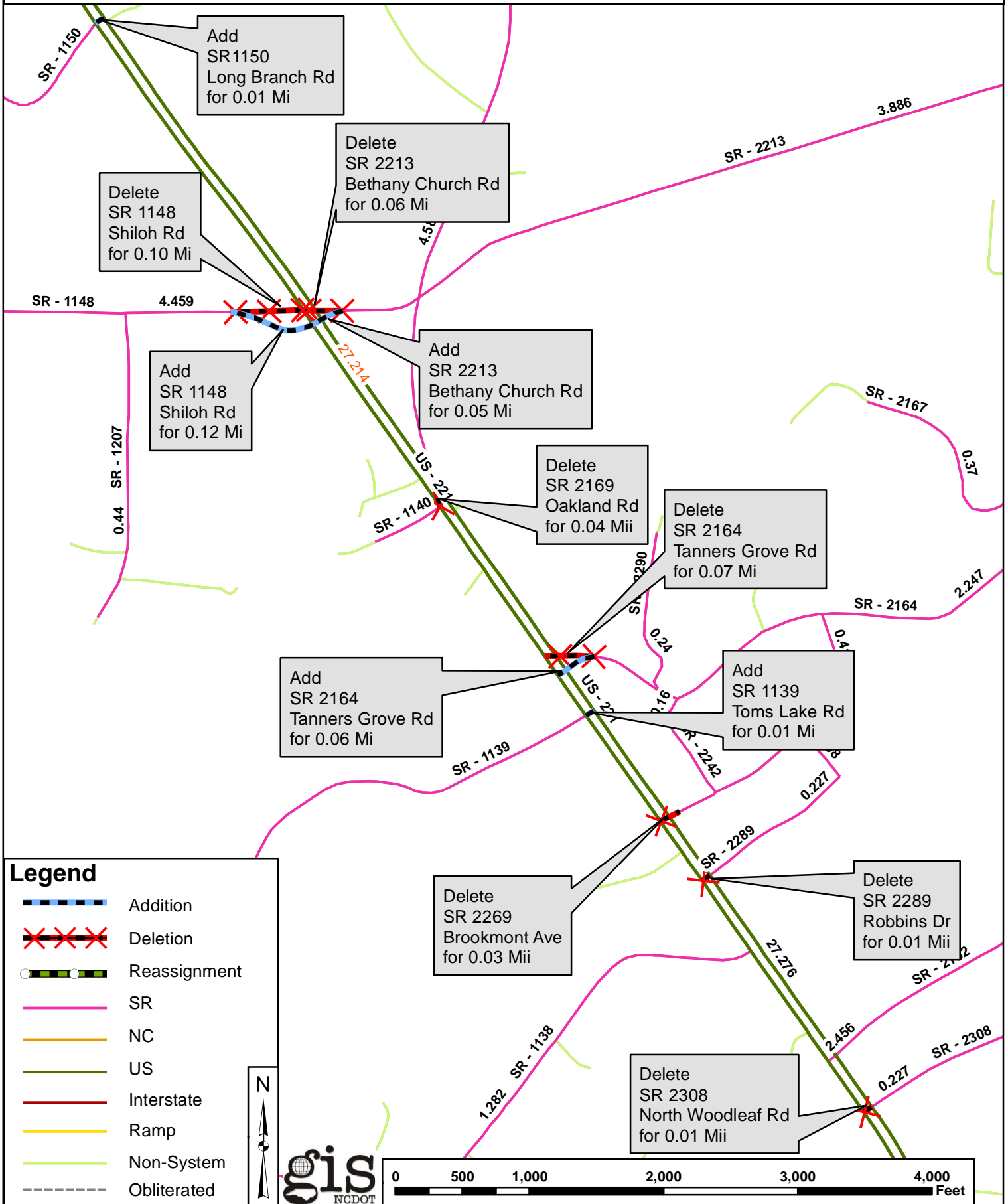

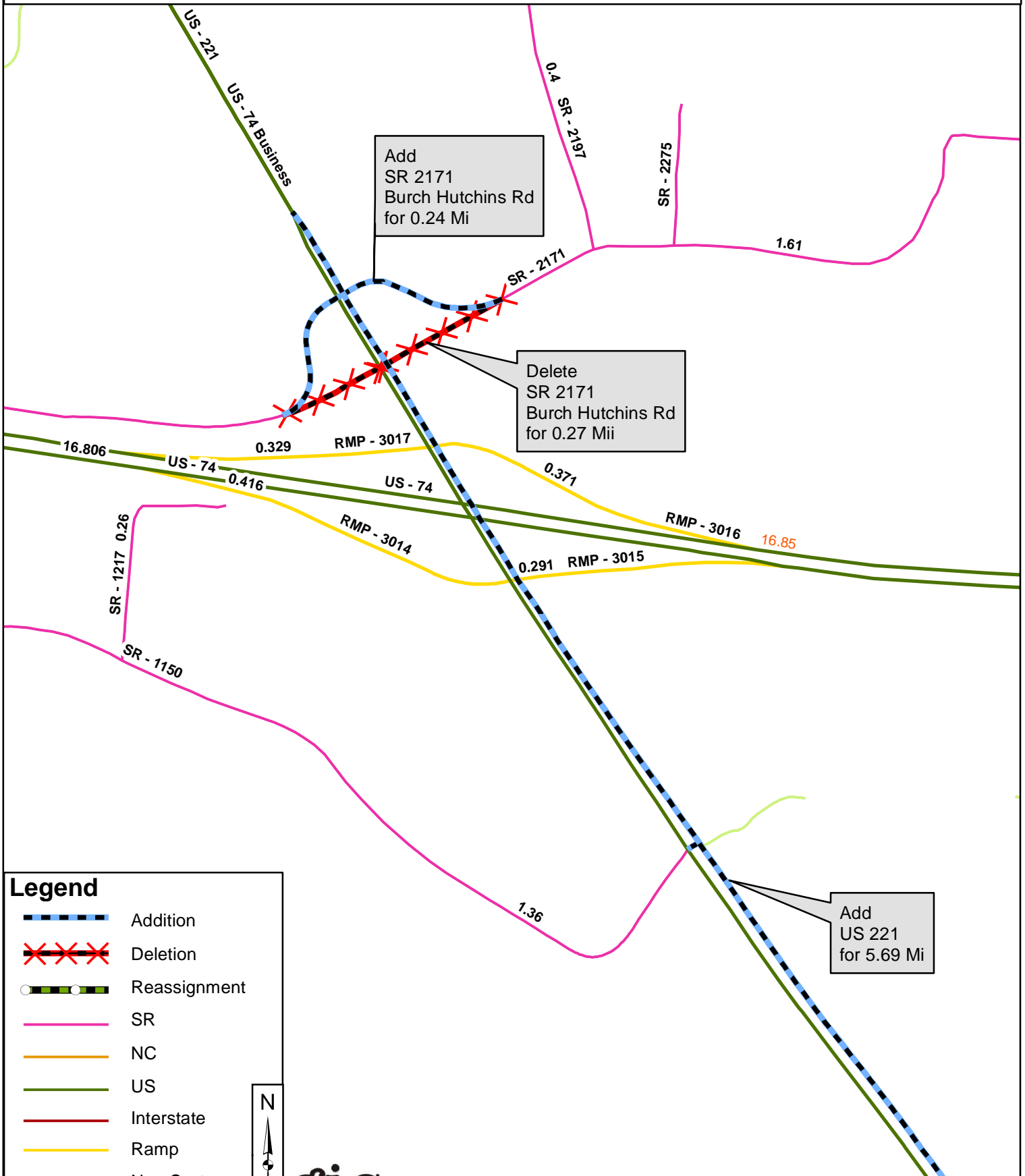

Legend

-  Addition
-  Deletion
-  Reassignment
-  SR
-  NC
-  US
-  Interstate
-  Ramp
-  Non-System
-  Obliterated

