



STATE OF NORTH CAROLINA  
DEPARTMENT OF TRANSPORTATION

PATRICK MCCRORY  
GOVERNOR

Monday, July 27, 2015

ANTHONY TATA  
SECRETARY

**MEMORANDUM TO:** Mr. Louis Mitchell, PE  
Division Engineer  
Division 10

**FROM:** John C. Farley, Manager  
Geographic Information Systems Unit

**SUBJECT:** 2015 District 3 Road System Changes

The Data Conversion Group has been authorized to make the following changes to the state road system as indicated below. We request that you make similar changes to the related maps and files in your Division and District offices, and install appropriate road number signs if necessary. We have updated our records accordingly. If our system changes do not conform to the actual conditions in the field, please return this memorandum with recommendations.

MUNICIPAL	County	Approval Date
STALLINGS	UNION	7/9/2015

Inquiries about changes should be referred to the GIS Help Desk at GISHelp@ncdot.gov. Thank you for your assistance.

JCF

- cc: BSIP
- Bridge Maintenance
- Division Right of Way
- IMG
- Pavement Management
- Permit Unit
- State Road Maintenance
- Traffic Engineering
- Traffic Surveys



# 2015 ROAD SYSTEM CHANGES

MUNICIPAL	COUNTY	APPROVAL DATE	ROUTE NUMBER	PORTION REASSIGNED TO	STREET NAME	LENGTH (miles)	TYPE OF CHANGE	REMARKS (See Attached Map)
STALLINGS	UNION	7/9/2015	SR 1401		COMMUNITY PARK DR	0.23	SYSTEM DELETION VIA MUNICIPAL	MAP A, SEGMENT
STALLINGS	UNION	7/9/2015	SR 1419		EAST CIRCLE	0.18	SYSTEM DELETION VIA MUNICIPAL	MAP A, SEGMENT
STALLINGS	UNION	7/9/2015	SR 1420		COMMUNITY PARK DR	0.04	SYSTEM DELETION VIA MUNICIPAL	MAP A, SEGMENT
STALLINGS	UNION	7/9/2015	SR 1422		WEST CIRCLE	0.07	SYSTEM DELETION VIA MUNICIPAL	MAP A, SEGMENT
STALLINGS	UNION	7/9/2015	SR 1437		FAIRFOREST DR	0.35	SYSTEM DELETION VIA MUNICIPAL	MAP B, SEGMENT
STALLINGS	UNION	7/9/2015	SR 1438		STONEHEDGE DR	0.13	SYSTEM DELETION VIA MUNICIPAL	MAP B, SEGMENT
STALLINGS	UNION	7/9/2015	SR 2305		GOLD CREST DR	0.63	SYSTEM DELETION VIA MUNICIPAL	MAP C, SEGMENT
STALLINGS	UNION	7/9/2015	SR 2306		DEEPWOOD PL	0.66	SYSTEM DELETION VIA MUNICIPAL	MAP C, SEGMENT
STALLINGS	UNION	7/9/2015	SR 2307		SHAFTWOOD PL	0.27	SYSTEM DELETION VIA MUNICIPAL	MAP C, SEGMENT
STALLINGS	UNION	7/9/2015	SR 2395		STALLINGSWOOD RD	0.25	SYSTEM DELETION VIA MUNICIPAL	MAP D, SEGMENT
STALLINGS	UNION	7/9/2015	SR 2396		SCARLET ST	0.26	SYSTEM DELETION VIA MUNICIPAL	MAP D, SEGMENT
STALLINGS	UNION	7/9/2015	SR 2397		CAROLYN LN	0.10	SYSTEM DELETION VIA MUNICIPAL	MAP D, SEGMENT
STALLINGS	UNION	7/9/2015	SR 2417		GOLD DUST LN	0.06	SYSTEM DELETION VIA MUNICIPAL	MAP C, SEGMENT

<b>MUNICIPAL</b>	<b>COUNTY</b>	<b>APPROVAL DATE</b>	<b>ROUTE NUMBER</b>	<b>PORTION REASSIGNED TO</b>	<b>STREET NAME</b>	<b>LENGTH (miles)</b>	<b>TYPE OF CHANGE</b>	<b>REMARKS (See Attached Map)</b>
STALLINGS	UNION	7/9/2015	SR 2474		EAGLECREST DR	0.21	SYSTEM DELETION VIA MUNICIPAL	MAP E, SEGMENT
STALLINGS	UNION	7/9/2015	SR 2475		FALCONS RIDGE	0.11	SYSTEM DELETION VIA MUNICIPAL	MAP E, SEGMENT
STALLINGS	UNION	7/9/2015	SR 2476		HAWKSNEST CT	0.05	SYSTEM DELETION VIA MUNICIPAL	MAP E, SEGMENT
STALLINGS	UNION	7/9/2015	SR 3081		LAWRENCE DANIEL DR	0.59	SYSTEM DELETION VIA MUNICIPAL	MAP F, SEGMENT
STALLINGS	UNION	7/9/2015	SR 3082		STEVENS SCHULTZ LN	0.07	SYSTEM DELETION VIA MUNICIPAL	MAP F, SEGMENT
STALLINGS	UNION	7/9/2015	SR 3083		CREEK CT	0.02	SYSTEM DELETION VIA MUNICIPAL	MAP F, SEGMENT
STALLINGS	UNION	7/9/2015	SR 3084		BROOK PATH LN	0.04	SYSTEM DELETION VIA MUNICIPAL	MAP F, SEGMENT
STALLINGS	UNION	7/9/2015	SR 3712		COBBLERS DR	0.09	SYSTEM DELETION VIA MUNICIPAL	MAP G, SEGMENT
STALLINGS	UNION	7/9/2015	SR 3713		BUTTERNUT LN	0.21	SYSTEM DELETION VIA MUNICIPAL	MAP G, SEGMENT

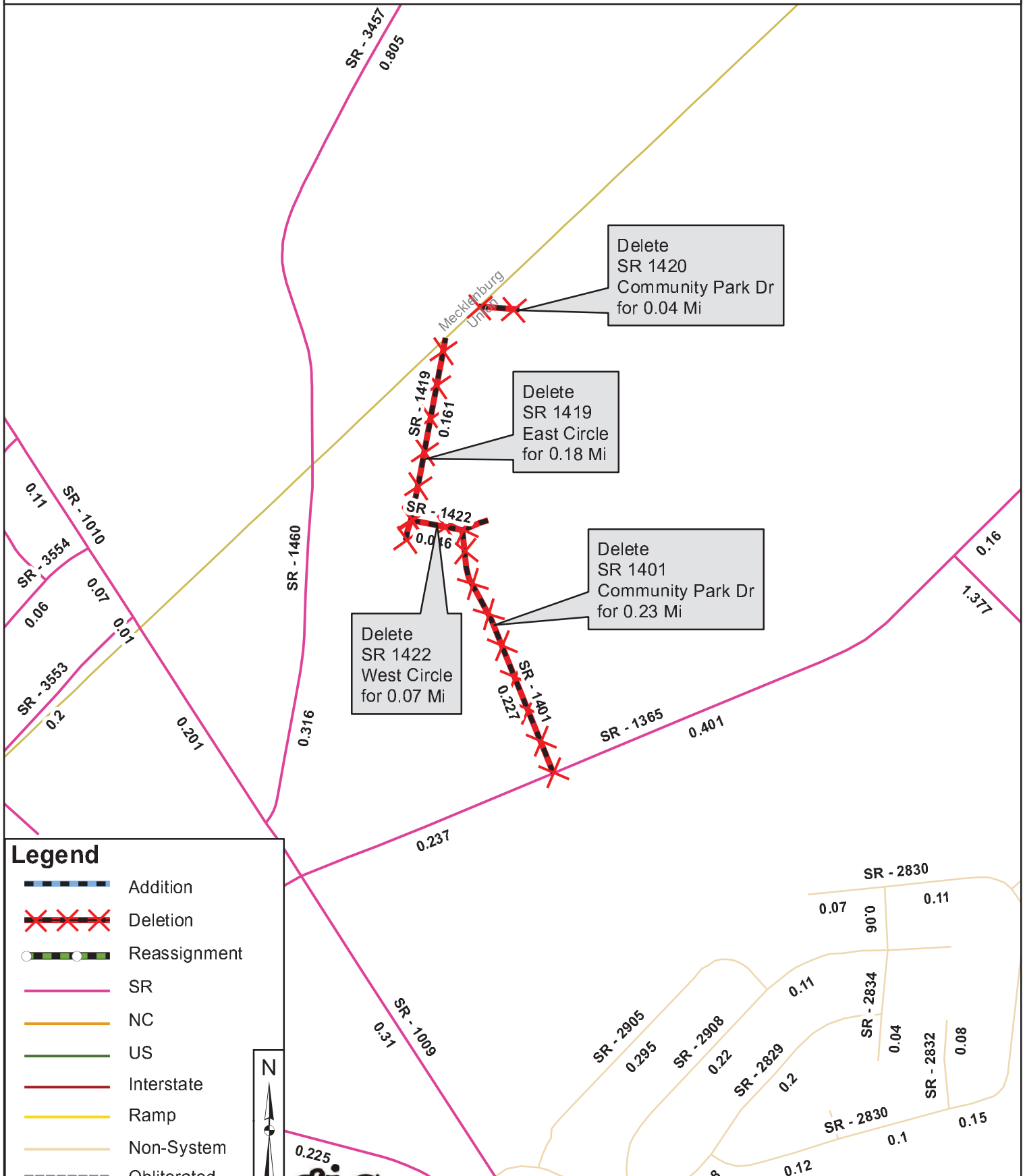

Delete  
SR 1420  
Community Park Dr  
for 0.04 Mi

Delete  
SR 1419  
East Circle  
for 0.18 Mi

Delete  
SR 1401  
Community Park Dr  
for 0.23 Mi

Delete  
SR 1422  
West Circle  
for 0.07 Mi

**Legend**

- Addition
- Deletion
- Reassignment
- SR
- NC
- US
- Interstate
- Ramp
- Non-System
- Obliterated
- County Boundary

gis  
NCDOT



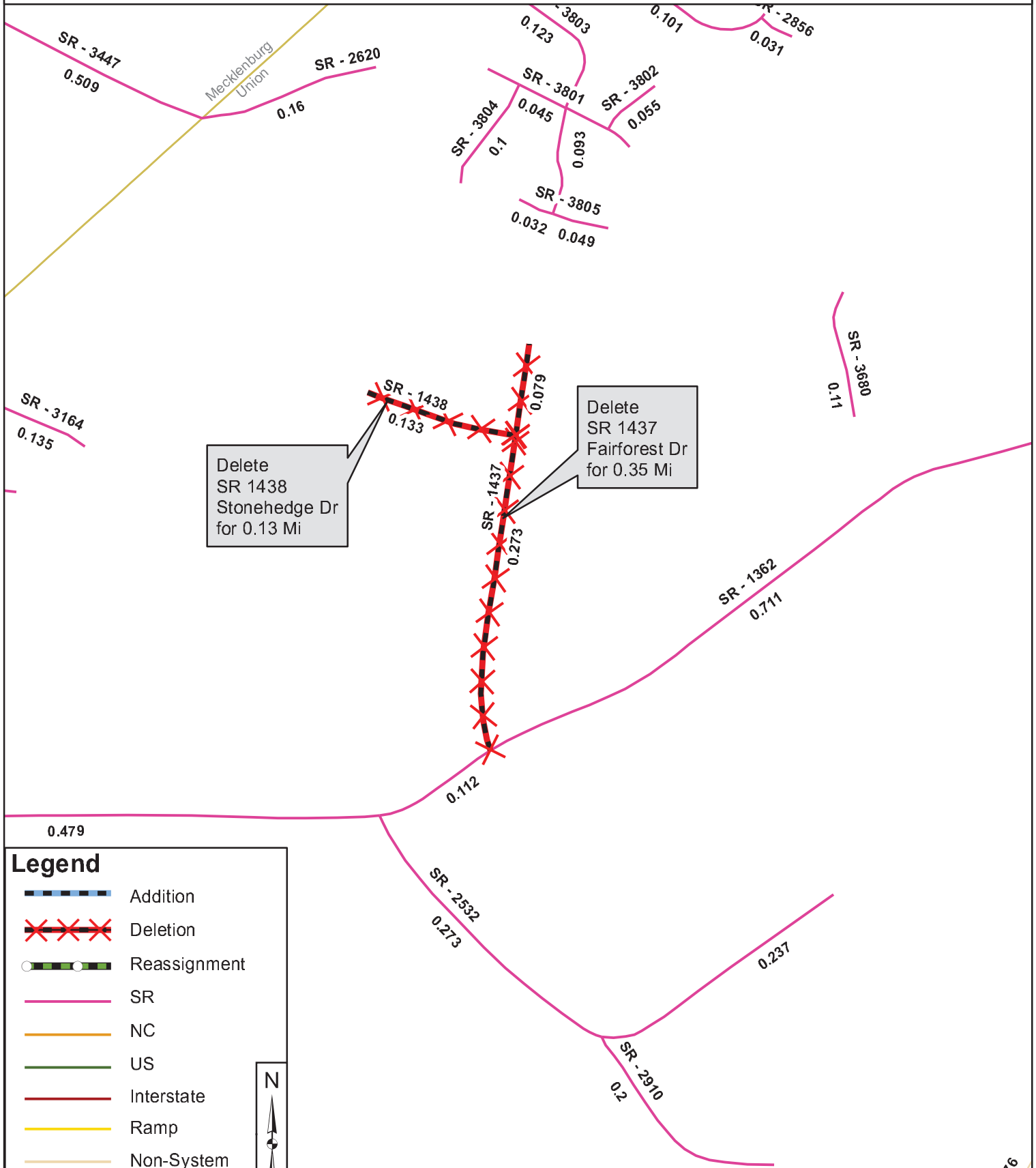











Delete  
SR 1438  
Stonehedge Dr  
for 0.13 Mi

Delete  
SR 1437  
Fairforest Dr  
for 0.35 Mi

**Legend**

-  Addition
-  Deletion
-  Reassignment
-  SR
-  NC
-  US
-  Interstate
-  Ramp
-  Non-System
-  Obliterated
-  County Boundary



3476

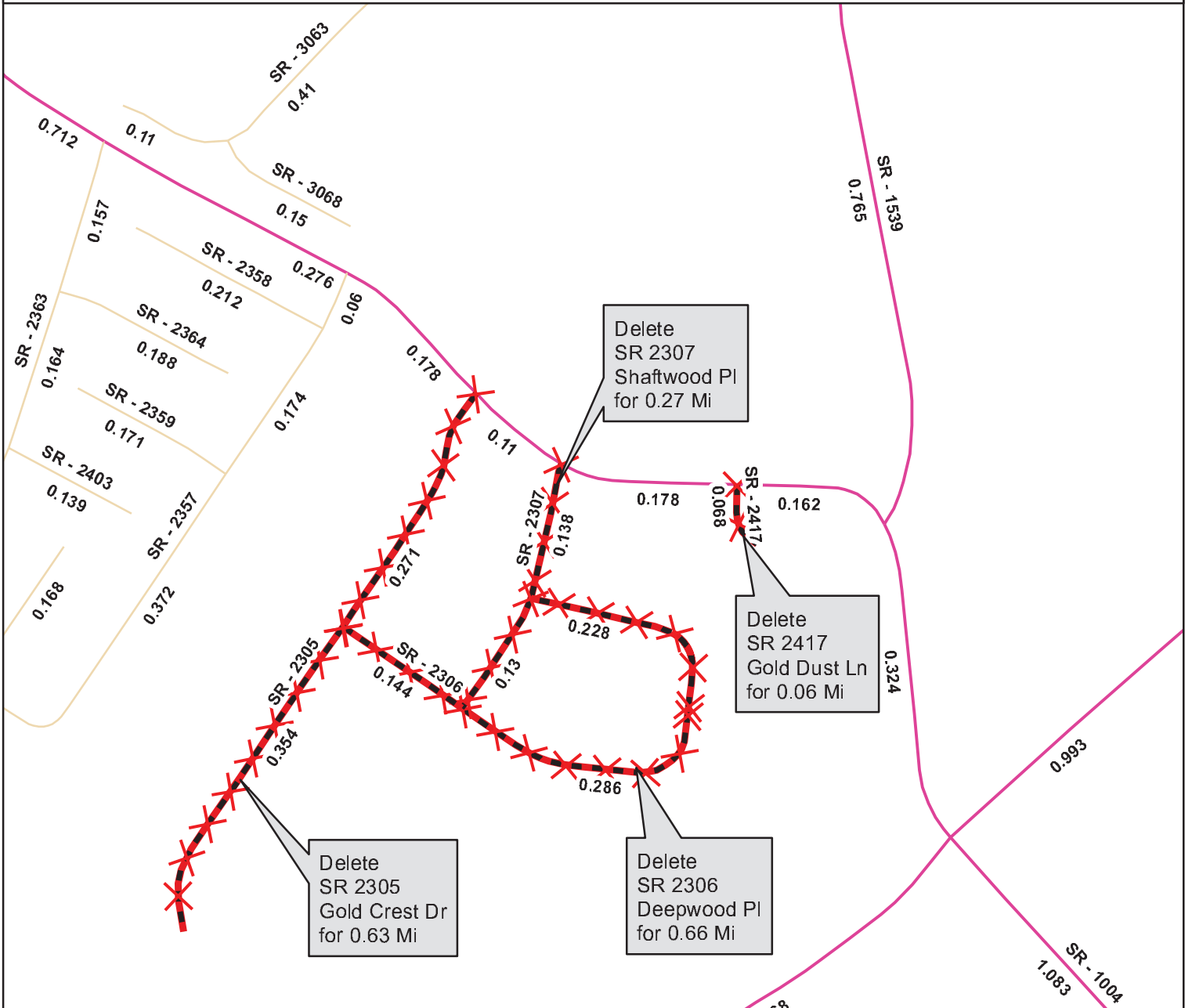

**Legend**

- Addition
- Deletion
- Reassignment
- SR
- NC
- US
- Interstate
- Ramp
- Non-System
- Obliterated

gis  
NCDOT

0 435 870 1,740 2,610 3,480 Feet

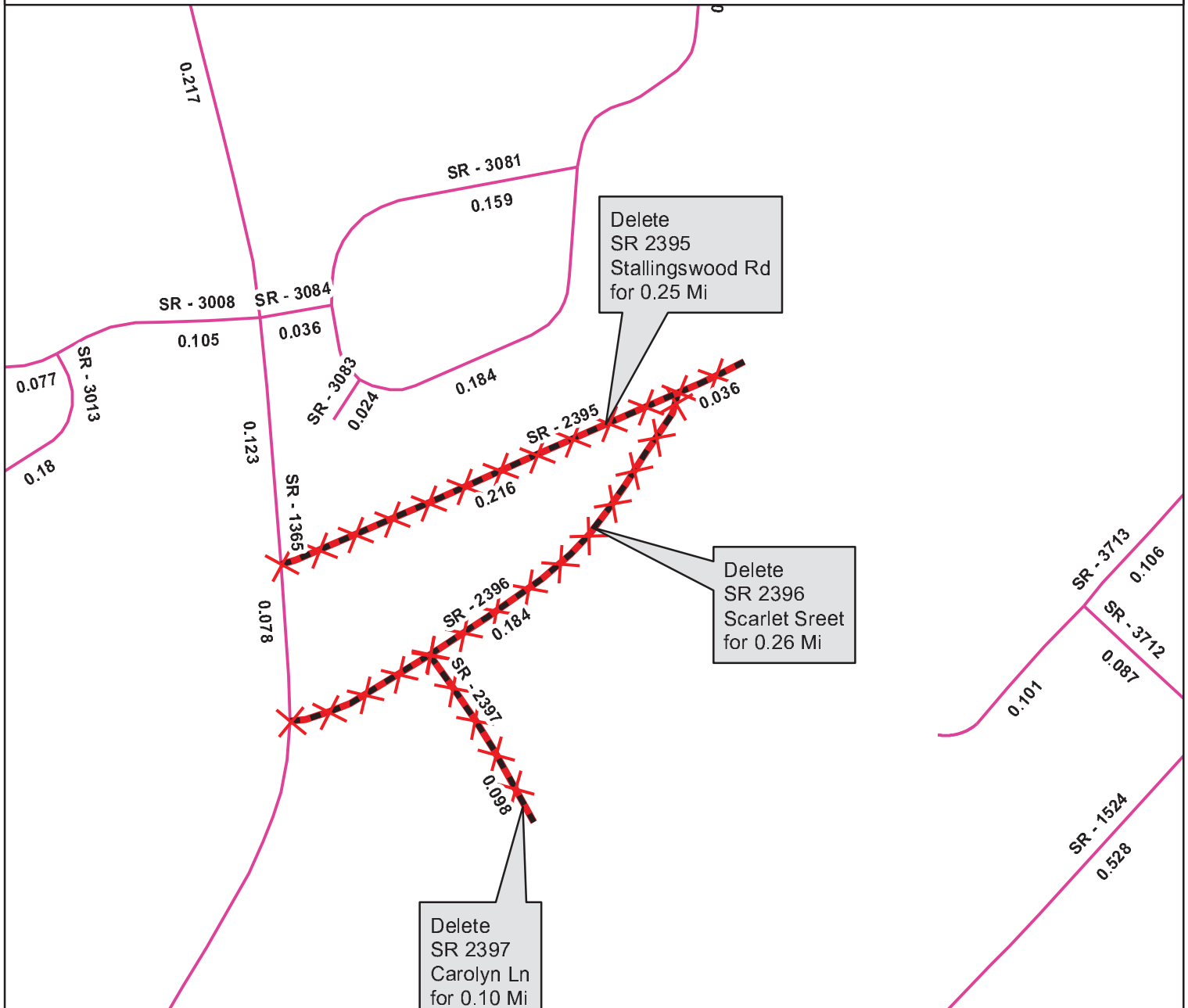

**Legend**

- Addition
- Deletion
- Reassignment
- SR
- NC
- US
- Interstate
- Ramp
- Non-System
- Obliterated

523  
gis  
NGDOT

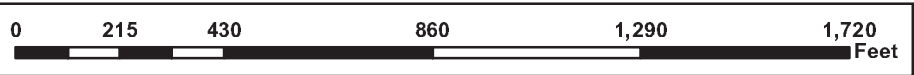

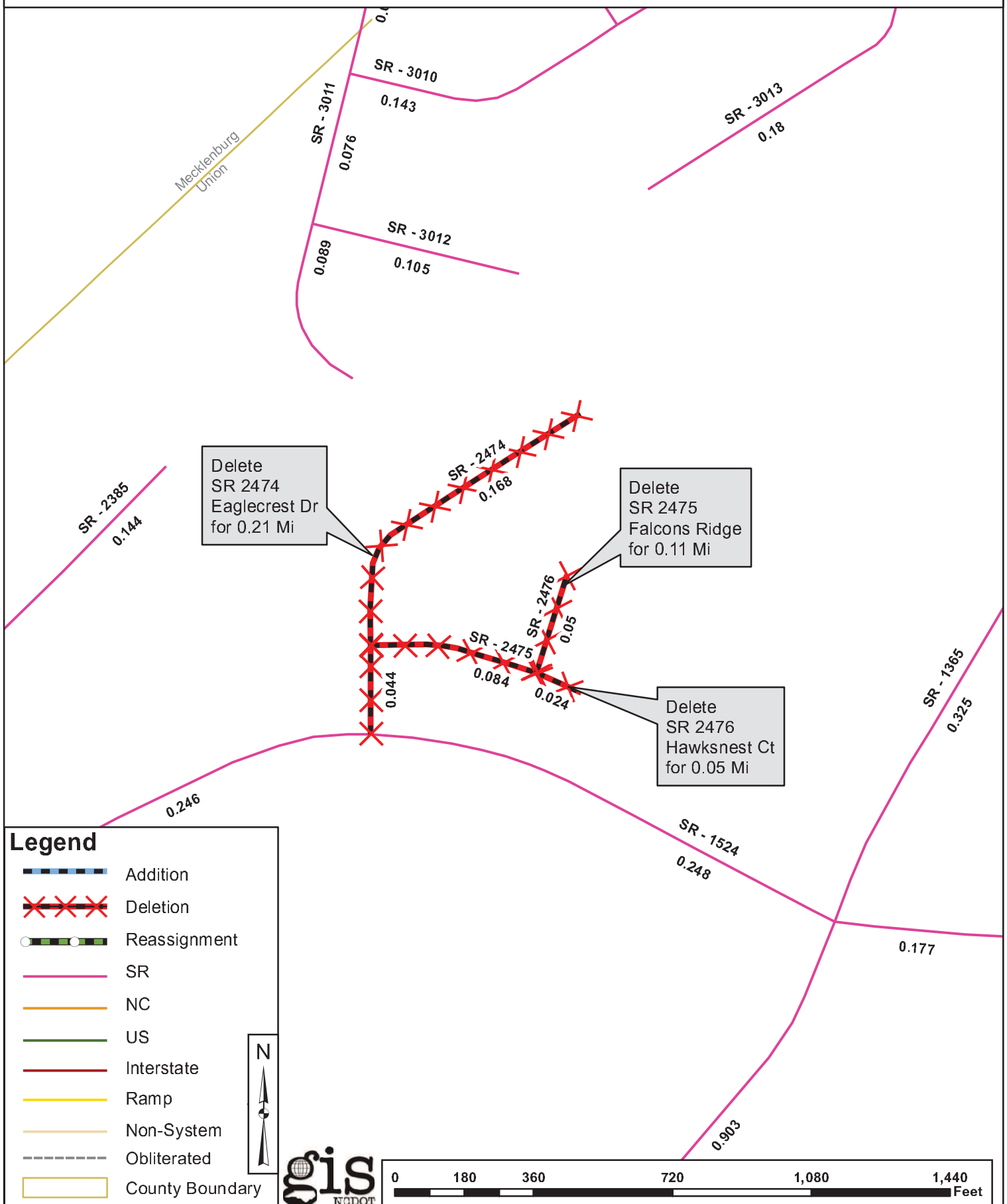



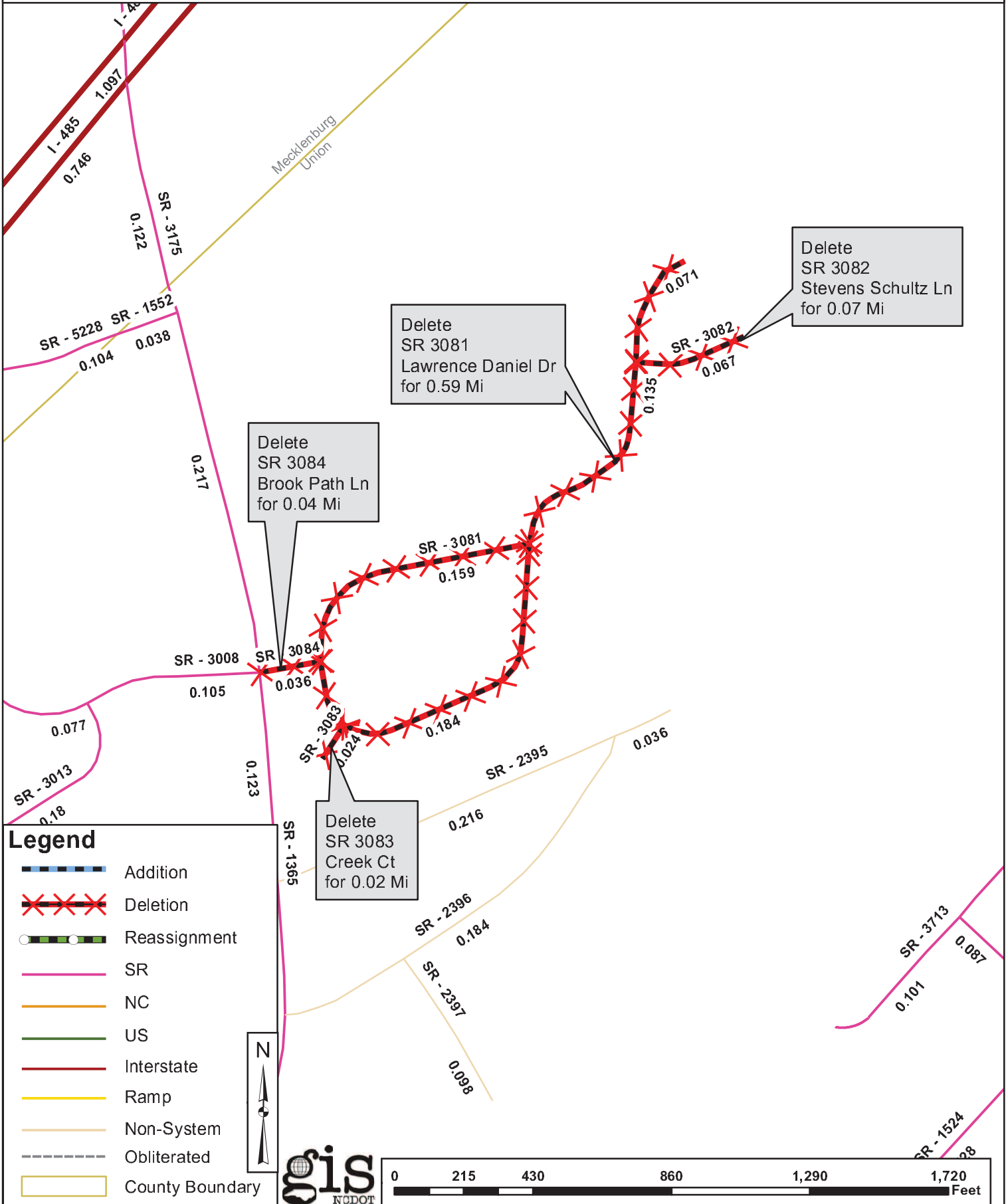

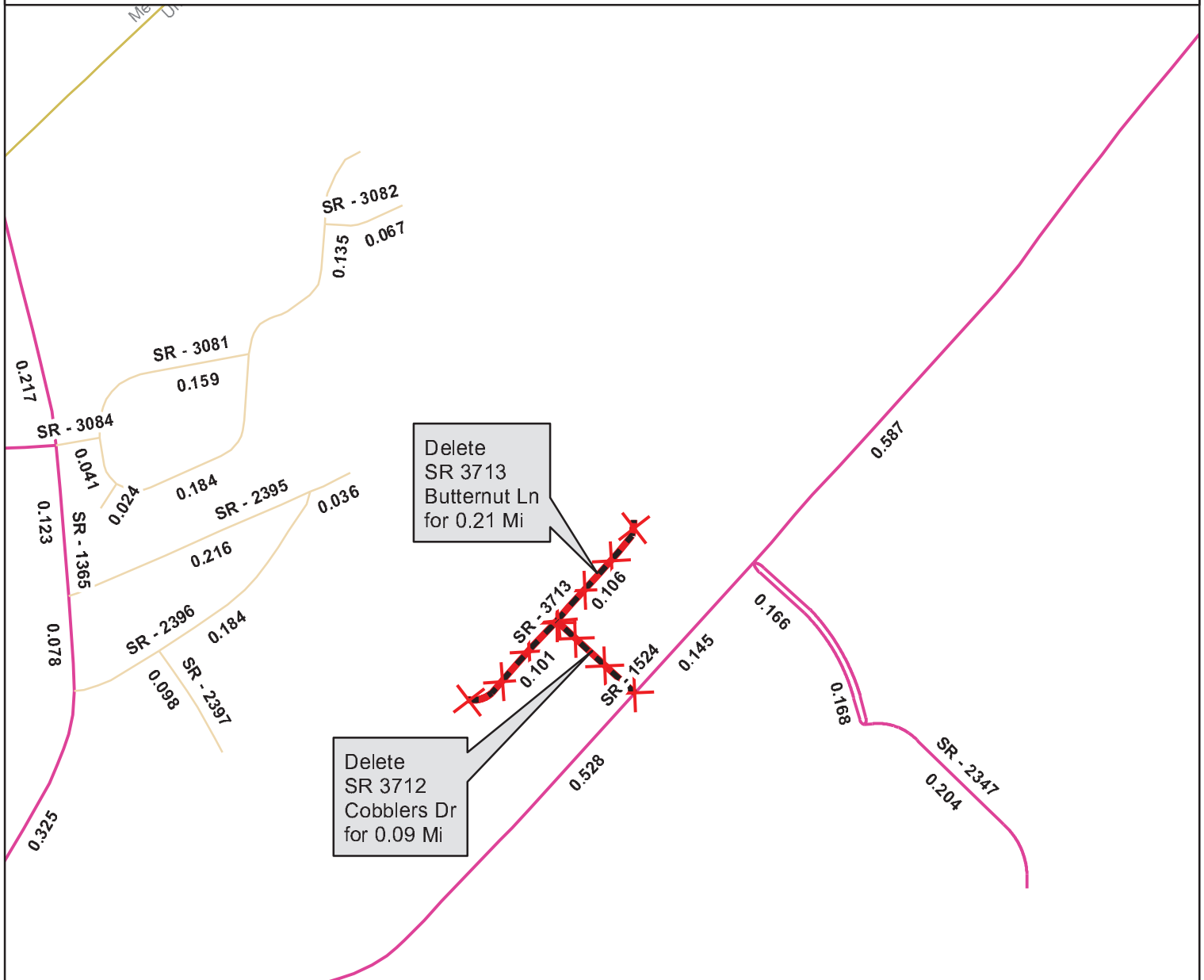

**Legend**

- Addition
- Deletion
- Reassignment
- SR
- NC
- US
- Interstate
- Ramp
- Non-System
- Obliterated
- County Boundary

