



STATE OF NORTH CAROLINA
DEPARTMENT OF TRANSPORTATION

PATRICK MCCRORY
GOVERNOR

Monday, July 20, 2015

ANTHONY TATA
SECRETARY

MEMORANDUM TO: Mrs. Karen E.Collette, PE
Division Engineer
Division 3

FROM: John C. Farley, Manager
Geographic Information Systems Unit

SUBJECT: 2015 District 3 Road System Changes

The Data Conversion Group has been authorized to make the following changes to the state road system as indicated below. We request that you make similar changes to the related maps and files in your Division and District offices, and install appropriate road number signs if necessary. We have updated our records accordingly. If our system changes do not conform to the actual conditions in the field, please return this memorandum with recommendations.

PETITION	County	Approval Date
NEW HANOVER_2015_07_50818	NEW HANOVER	7/9/2015

Inquiries about changes should be referred to the GIS Help Desk at GISHelp@ncdot.gov.
Thank you for your assistance.

JCF

- cc: BSIP
- Bridge Maintenance
- Division Right of Way
- IMG
- Pavement Management
- Permit Unit
- State Road Maintenance
- Traffic Engineering
- Traffic Surveys



2015 ROAD SYSTEM CHANGES

PETITION	COUNTY	APPROVAL DATE	ROUTE NUMBER	PORTION REASSIGNED	STREET NAME	LENGTH (miles)	TYPE OF CHANGE	REMARKS (See Attached Map)
NEW HANOVER_2015_07_50818	NEW HANOVER	7/9/2015	SR 2213		ALBEMARLE RD	0.29	SYSTEM ADDITION VIA PETITION	
NEW HANOVER_2015_07_50818	NEW HANOVER	7/9/2015	SR 2132		STURBRIDGE DR	0.04	SYSTEM ADDITION VIA PETITION	

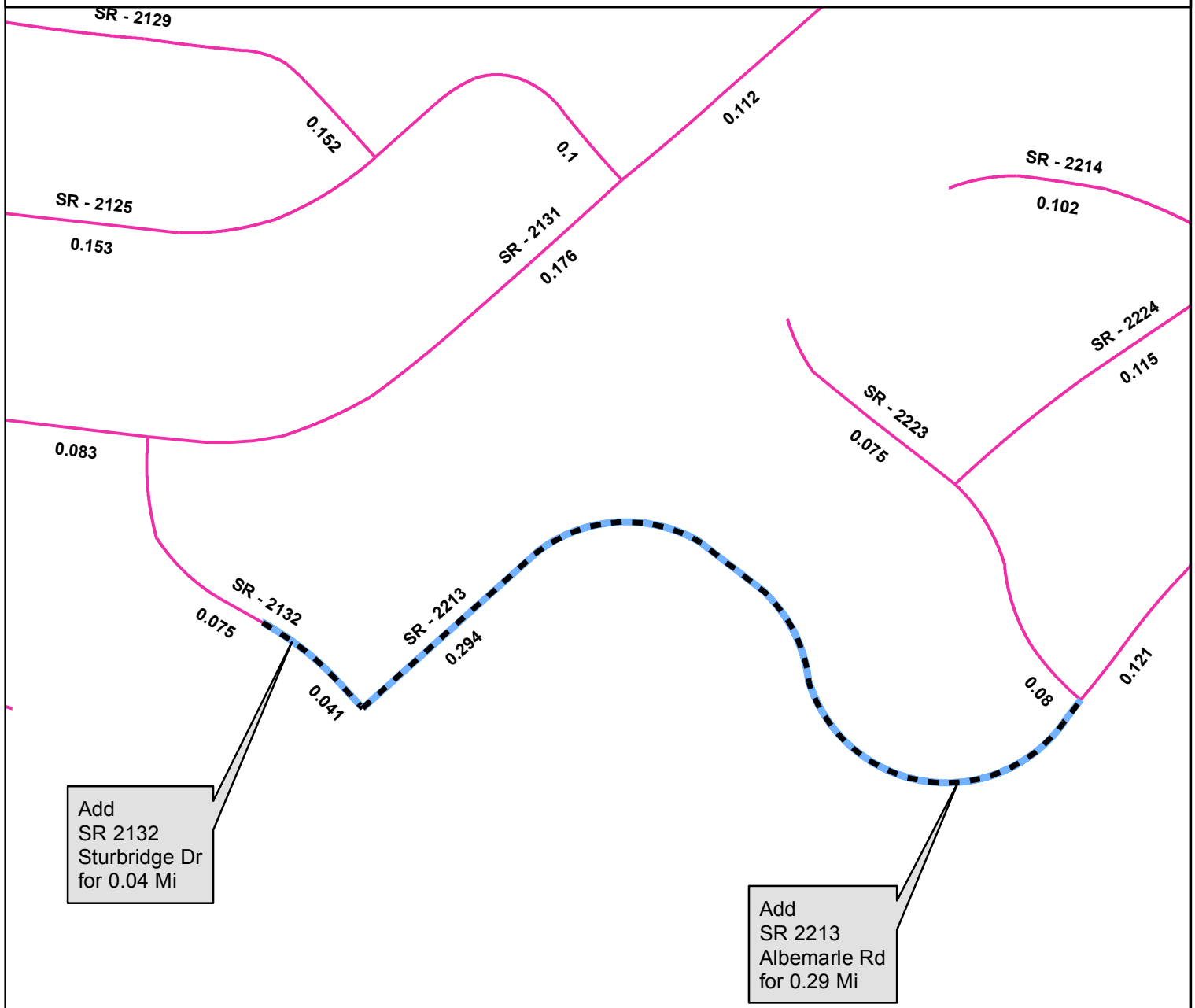

Add
SR 2132
Sturbridge Dr
for 0.04 Mi

Add
SR 2213
Albemarle Rd
for 0.29 Mi

Legend

- Addition
- Deletion
- Reassignment
- SR
- NC
- US
- Interstate
- Ramp
- Non-System
- Obliterated

N

