



STATE OF NORTH CAROLINA  
DEPARTMENT OF TRANSPORTATION

PATRICK MCCRORY  
GOVERNOR

Friday, November 21, 2014

ANTHONY TATA  
SECRETARY

**MEMORANDUM TO:** Mr. Gregory W. Burns, PE  
Division Engineer  
Division 6

**FROM:** John C. Farley, Manager  
Geographic Information Systems Unit

**SUBJECT:** 2014 District 2 Road System Changes

The Data Conversion Group has been authorized to make the following changes to the state road system as indicated below. We request that you make similar changes to the related maps and files in your Division and District offices, and install appropriate road number signs if necessary. We have updated our records accordingly. If our system changes do not conform to the actual conditions in the field, please return this memorandum with recommendations.

PETITION	County	Approval Date
CUMBERLAND_2014_11_50625	CUMBERLAND	11/6/2014

Inquiries about changes should be referred to the GIS Help Desk at (919) 707-2152.  
Thank you for your assistance.

JCF

- cc: BSIP
- Bridge Maintenance
- Division Right of Way
- IMG
- Pavement Management
- Permit Unit
- State Road Maintenance
- Traffic Engineering
- Traffic Surveys



# 2014 ROAD SYSTEM CHANGES

<b>PETITION</b>	<b>COUNTY</b>	<b>APPROVAL DATE</b>	<b>ROUTE NUMBER</b>	<b>PORTION REASSIGNED</b>	<b>STREET NAME</b>	<b>LENGTH (miles)</b>	<b>TYPE OF CHANGE</b>	<b>REMARKS (See Attached Map)</b>
CUMBERLAND_2014_11_50 625	CUMBERLAND	11/6/2014	SR 4533		CARRIAGE CROSSING RD	0.41	SYSTEM ADDITION VIA PETITION	
CUMBERLAND_2014_11_50 625	CUMBERLAND	11/6/2014	SR 4532		MORNING MIST CT	0.06	SYSTEM ADDITION VIA PETITION	
CUMBERLAND_2014_11_50 625	CUMBERLAND	11/6/2014	SR 4531		PLANTERS ROW DR	0.20	SYSTEM ADDITION VIA PETITION	
CUMBERLAND_2014_11_50 625	CUMBERLAND	11/6/2014	SR 4530		PECAN GROVE LOOP	0.33	SYSTEM ADDITION VIA PETITION	
CUMBERLAND_2014_11_50 625	CUMBERLAND	11/6/2014	SR 4529		RUNNING FOX RD	0.38	SYSTEM ADDITION VIA PETITION	

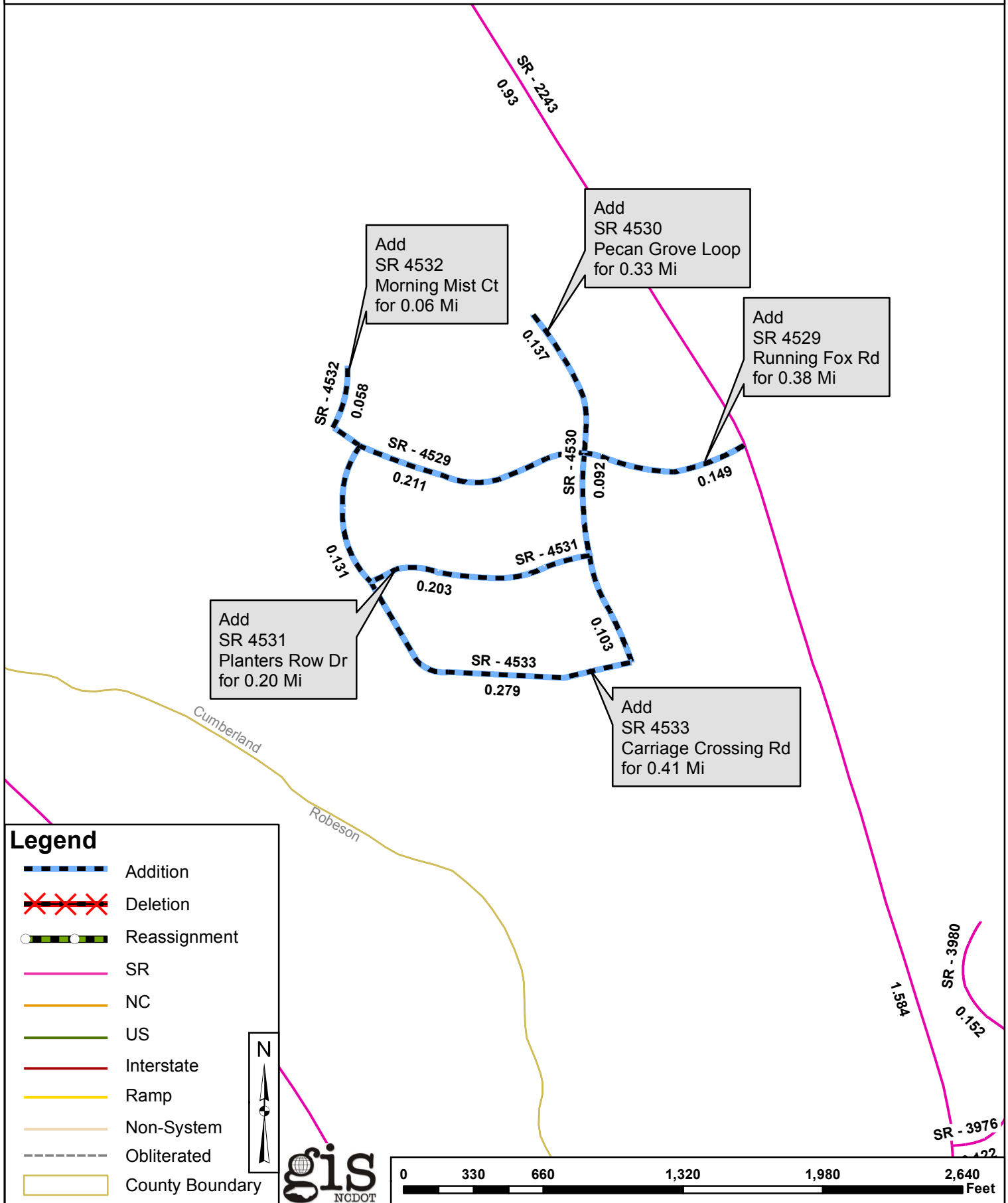

**Legend**

- Addition
- Deletion
- Reassignment
- SR
- NC
- US
- Interstate
- Ramp
- Non-System
- Obliterated
- County Boundary

gis  
NCDOT

