



STATE OF NORTH CAROLINA  
DEPARTMENT OF TRANSPORTATION

PATRICK MCCRORY  
GOVERNOR

November 04, 2016

NICHOLAS J. TENNYSON  
SECRETARY

**MEMORANDUM TO:** Mr. Louis Mitchell, PE  
Division Engineer  
Division 10

**FROM:** Mr. John C. Farley, GISP, CPM  
Manager  
Geographic Information Systems Unit

**SUBJECT:** 2016 District 2 Road System Changes

The GIS Unit's Data Conversion Group has been authorized to make the changes indicated below to the state road system. We request that you update the related maps and files in your offices and install appropriate road number signs, if necessary. If our system changes do not conform to the actual conditions in the field, please return this memorandum with recommendations.

Document Number	County	Approval Date
R-2123CE	MECKLENBURG	10/31/2014

Questions or comments about changes should be referred to the GIS Help Desk at [GISHelp@ncdot.gov](mailto:GISHelp@ncdot.gov).  
Thank you for your assistance.

JCF

cc: BSIP  
Bridge Maintenance  
Division Right of Way  
IMG  
Pavement Management  
Permit Unit  
State Road Maintenance  
Traffic Engineering  
Traffic Surveys

**MAILING ADDRESS:**  
NC DEPARTMENT OF TRANSPORTATION  
GEOGRAPHIC INFORMATION SYSTEMS  
1521 MAIL SERVICE CENTER  
RALEIGH, NC 27699-1521



**DELIVERY ADDRESS:**  
4101 CAPITAL BLVD.  
RALEIGH, NC 27604  
FAX: (919) 707-2214

# 2016 ROAD SYSTEM CHANGES

TIP	COUNTY	APPROVAL DATE	NEW ROUTE	EXISTING ROUTE	STREET NAME	LENGTH (miles)	TYPE OF CHANGE	REMARKS (See Attached Map)
R-2123CE	MECKLENBURG	10/31/2014		I- 485		0.31	SYSTEM ADDITION - EXISTING VIA TIP	MAP , SEGMENT
R-2123CE	MECKLENBURG	10/31/2014		SR 2467		0.55	SYSTEM ADDITION - EXISTING VIA TIP	MAP , SEGMENT
R-2123CE	MECKLENBURG	10/31/2014		I- 485		0.33	SYSTEM DELETION VIA TIP	MAP , SEGMENT
R-2123CE	MECKLENBURG	10/31/2014		SR 2670		0.08	SYSTEM DELETION VIA TIP	MAP , SEGMENT
R-2123CE	MECKLENBURG	10/31/2014		SR 2469		0.03	SYSTEM DELETION VIA TIP	MAP , SEGMENT
R-2123CE	MECKLENBURG	10/31/2014		SR 2467		0.51	SYSTEM DELETION VIA TIP	MAP , SEGMENT

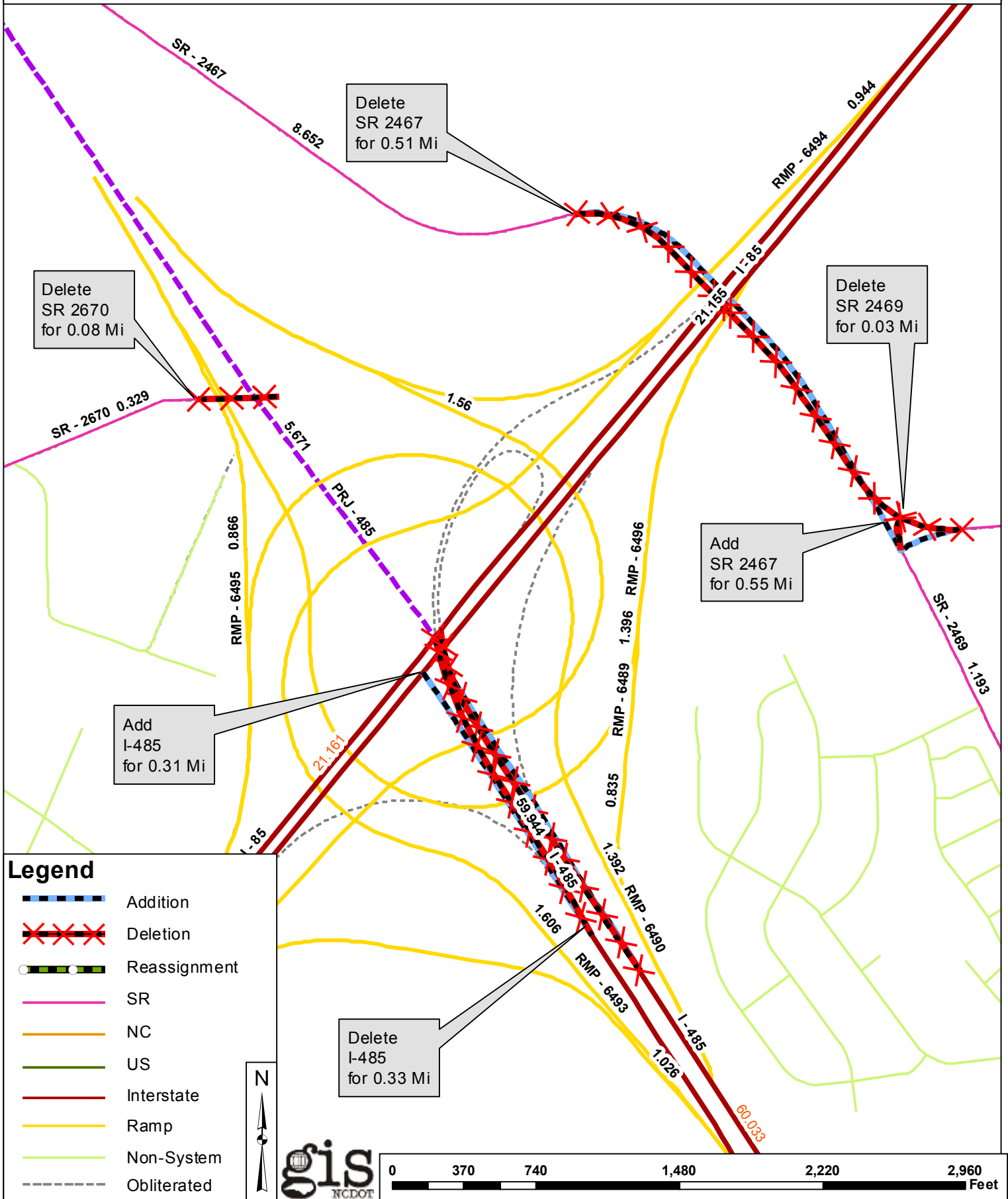

**Legend**

-  Addition
-  Deletion
-  Reassignment
-  SR
-  NC
-  US
-  Interstate
-  Ramp
-  Non-System
-  Obliterated

