



STATE OF NORTH CAROLINA
DEPARTMENT OF TRANSPORTATION

ROY COOPER
GOVERNOR

JAMES H. TROGDON, III
SECRETARY

DATE: January 23, 2019
TO: Mr. Timothy Johnson, PE
 Division Engineer
 Division 8
FROM: John C. Farley
 Manager
 Geographic Information Systems Unit
SUBJECT: 2019 District 2 Road System Changes

The GIS Unit's Data Conversion Group has been authorized to make the changes indicated below to the state road system. We request that you update the related maps and files in your offices and install appropriate road number signs, if necessary. If our system changes do not conform to the actual conditions in the field, please return this memorandum with recommendations.

| Document Number | County | Approval Date |
|-----------------|--------|---------------|
| U-3324 | MOORE | 10/24/2014 |

Questions or comments about changes should be referred to the GIS Help Desk at GISHelp@ncdot.gov.

Thank you for your assistance.

JCF

cc: BSIP
 Bridge Maintenance
 Division Right of Way
 IMG
 Pavement Management
 Permit Unit
 State Road Maintenance
 Traffic Engineering
 Traffic Surveys

MAILING ADDRESS:
 NC DEPARTMENT OF TRANSPORTATION
 GEOGRAPHIC INFORMATION SYSTEMS UNIT
 1521 MAIL SERVICE CENTER
 RALEIGH, NC 27699-1521

Telephone: (919) 707-2165
 FAX: 919-707-2210
 Customer Service: 1-877-368-4968
 Website: www.ncdot.gov

LOCATION:
 4101 CAPITAL BLVD.
 RALEIGH, NC 27604

2019 Road System Changes

TIP Name: U-3324
Date: 10/24/2014
County: MOORE

Additions

| Route | Street Name | Mileage | Map |
|--------------|--------------------|----------------|------------|
| SR 2053 | | 0.12 | A |
| SR 2132 | | 0.01 | A |
| SR 2190 | | 0.07 | A |
| SR 2207 | | 0.01 | A |
| SR 1873 | | 0.1 | A |
| SR 2093 | | 0.01 | C |

Deletions

| Route | Street Name | Mileage | Map |
|--------------|--------------------|----------------|------------|
| SR 1873 | | 0.11 | B |
| SR 2053 | | 0.07 | B |
| SR 2132 | | 0.03 | B |
| SR 2190 | | 0.02 | B |
| SR 2207 | | 0.03 | B |
| SR 1872 | | 0.15 | C |
| SR 1873 | | 0.11 | C |
| SR 2093 | | 0.05 | C |

Reassignments

| Existing Route | New Route | Street Name | Mileage | Map |
|-----------------------|------------------|--------------------|----------------|------------|
| SR 2053 | SR 2207 | | 0.09 | A |

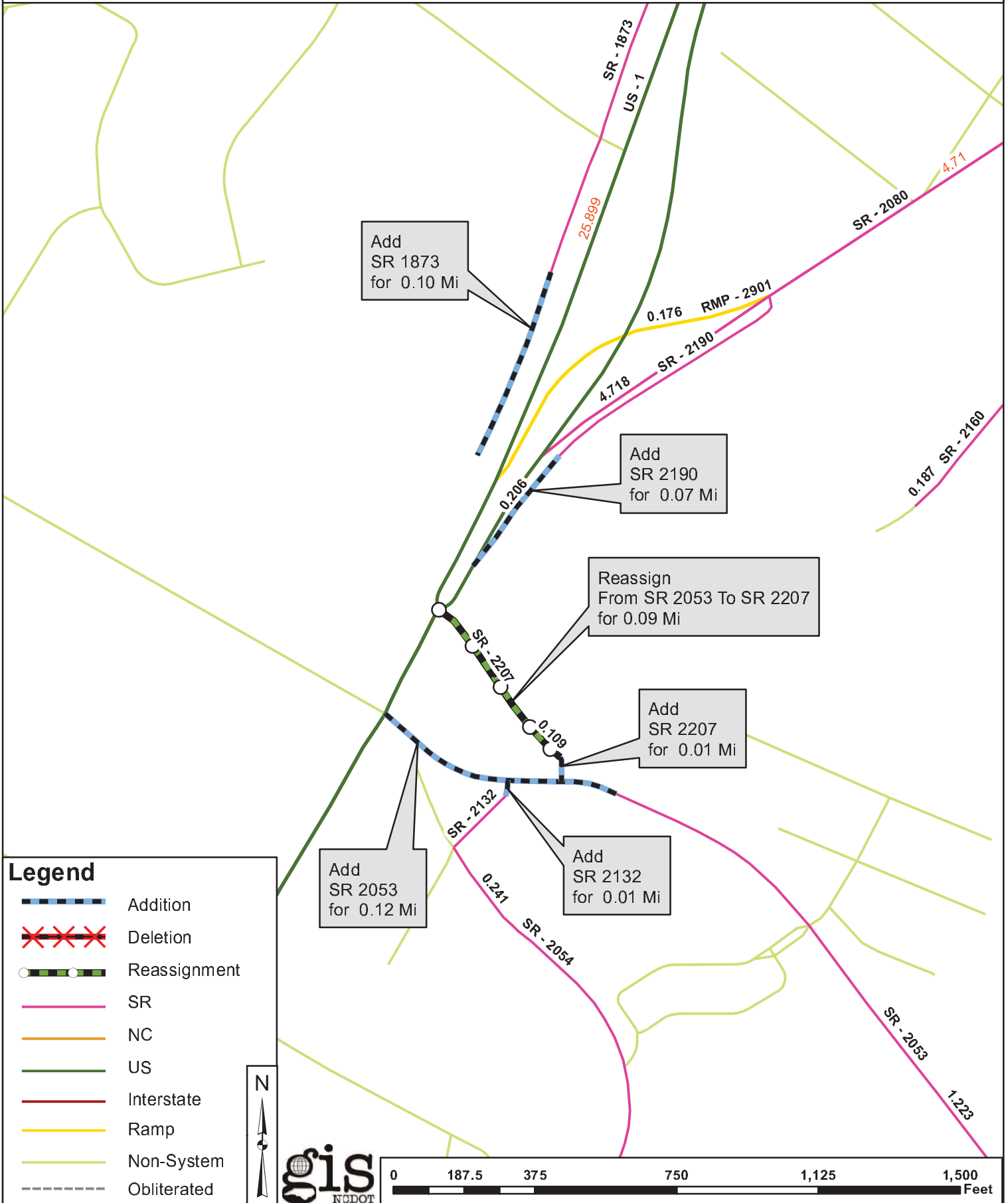

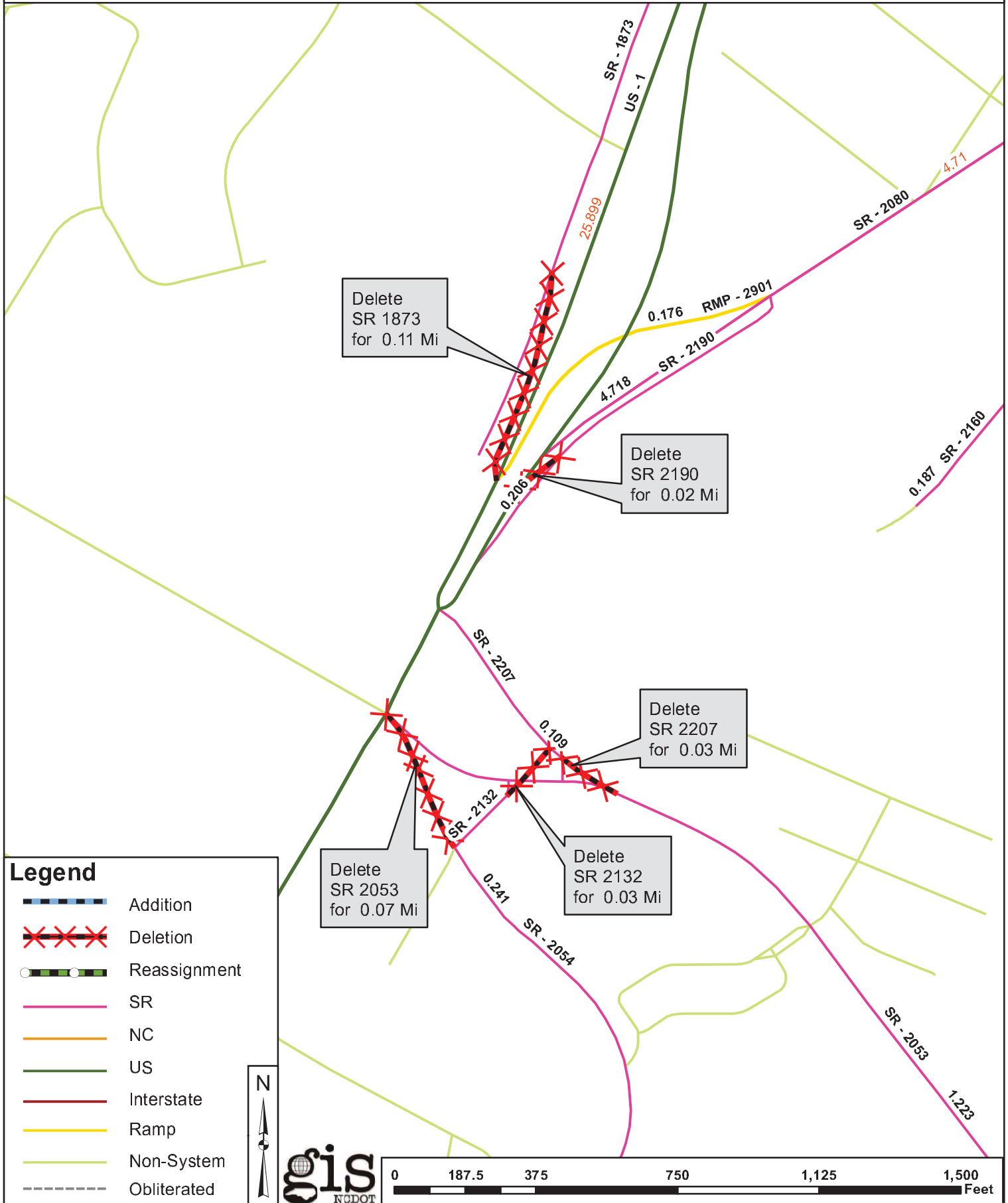

Legend

- Addition
- Deletion
- Reassignment
- SR
- NC
- US
- Interstate
- Ramp
- Non-System
- Obliterated

gis
NGDOT

0 187.5 375 750 1,125 1,500 Feet

