



STATE OF NORTH CAROLINA  
DEPARTMENT OF TRANSPORTATION

PATRICK MCCRORY  
GOVERNOR

Wednesday, August 20, 2014

ANTHONY TATA  
SECRETARY

**MEMORANDUM TO:** Mr. Tim Little, PE  
Division Engineer  
Division 4

**FROM:** John C. Farley, Manager  
Geographic Information Systems Unit

**SUBJECT:** 2014 District 3 Road System Changes

The Data Conversion Group has been authorized to make the following changes to the state road system as indicated below. We request that you make similar changes to the related maps and files in your Division and District offices, and install appropriate road number signs if necessary. We have updated our records accordingly. If our system changes do not conform to the actual conditions in the field, please return this memorandum with recommendations.

PETITION	County	Approval Date
JOHNSTON_2014_08_50554	JOHNSTON	8/7/2014

Inquiries about changes should be referred to the GIS Help Desk at (919) 707-2152.  
Thank you for your assistance.

JCF

cc: BSIP  
Bridge Maintenance  
Division Right of Way  
IMG  
Pavement Management  
Permit Unit  
State Road Maintenance  
Traffic Engineering  
Traffic Surveys

**MAILING ADDRESS:**  
NC DEPARTMENT OF TRANSPORTATION  
GEOGRAPHIC INFORMATION SYSTEMS  
1521 MAIL SERVICE CENTER  
RALEIGH, NC 27699-1521



**DELIVERY ADDRESS:**  
4101 CAPITAL BLVD.  
RALEIGH, NC 27604  
PHONE: (919) 707-2152  
FAX: (919) 707-2214

# 2014 ROAD SYSTEM CHANGES

<b>PETITION</b>	<b>COUNTY</b>	<b>APPROVAL DATE</b>	<b>ROUTE NUMBER</b>	<b>PORTION REASSIGNED TO</b>	<b>STREET NAME</b>	<b>LENGTH (miles)</b>	<b>TYPE OF CHANGE</b>	<b>REMARKS (See Attached I</b>
JOHNSTON_2014_08_50554	JOHNSTON	8/7/2014	SR 3355		TIA PL	0.13	SYSTEM ADDITION VIA PETITION	
JOHNSTON_2014_08_50554	JOHNSTON	8/7/2014	SR 3354		CARSON DR	0.20	SYSTEM ADDITION VIA PETITION	
JOHNSTON_2014_08_50554	JOHNSTON	8/7/2014	SR 3353		LARS LN	0.24	SYSTEM ADDITION VIA PETITION	
JOHNSTON_2014_08_50554	JOHNSTON	8/7/2014	SR 3352		ADELAIDE DR	0.26	SYSTEM ADDITION VIA PETITION	

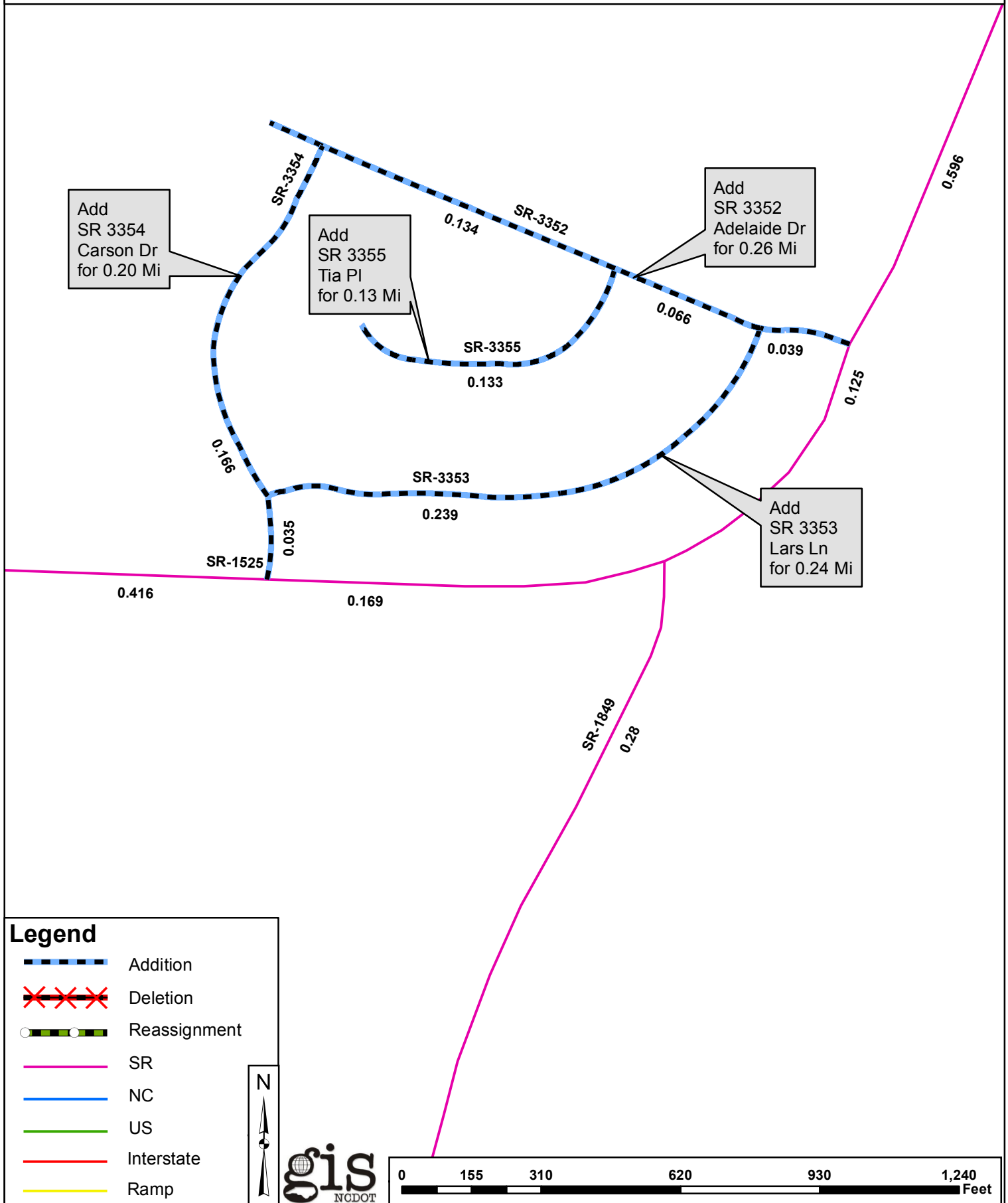

**Legend**

-  Addition
-  Deletion
-  Reassignment
-  SR
-  NC
-  US
-  Interstate
-  Ramp

