



STATE OF NORTH CAROLINA
DEPARTMENT OF TRANSPORTATION

ROY COOPER
GOVERNOR

JAMES H. TROGDON, III
SECRETARY

DATE: December 15, 2017
TO: Mr. Jay Swain, PE
Division Engineer
Division 13
FROM: Mr. John C. Farley, GISP, CPM
Manager
Geographic Information Systems Unit
SUBJECT: 2017 District 1 Road System Changes

The GIS Unit's Data Conversion Group has been authorized to make the changes indicated below to the state road system. We request that you update the related maps and files in your offices and install appropriate road number signs, if necessary. If our system changes do not conform to the actual conditions in the field, please return this memorandum with recommendations.

Document Number	County	Approval Date
R-2233AA	RUTHERFORD	6/1/2014

Questions or comments about changes should be referred to the GIS Help Desk at GISHelp@ncdot.gov.
Thank you for your assistance.

JCF

cc: BSIP
Bridge Maintenance
Division Right of Way
IMG
Pavement Management
Permit Unit
State Road Maintenance
Traffic Engineering
Traffic Surveys

Mailing Address:
NC DEPARTMENT OF TRANSPORTATION
GEOGRAPHIC INFORMATION SYSTEMS
1521 MAIL SERVICE CENTER
RALEIGH, NC 27699-1521

Telephone: (919) 707-2165
Fax: (919) 707-2210
Customer Service: 1-877-368-4968
Website: www.ncdot.gov

Location:
4101 CAPITAL BLVD.
RALEIGH, NC 27604
FAX: (919) 707-2214

2017 ROAD SYSTEM CHANGES

TIP	COUNTY	APPROVAL DATE	NEW ROUTE	EXISTING ROUTE	STREET NAME	LENGTH (miles)	TYPE OF CHANGE	REMARKS (See Attached Map)
R-2233AA	RUTHERFORD	6/1/2014	SR 2314	SR 2105	STATE LINE RD	0.09	REASSIGNMENT VIA TIP	MAP A, SEGMENT
R-2233AA	RUTHERFORD	6/1/2014		SR 1223	SOUTH RIVER RD	0.10	SYSTEM ADDITION - EXISTING VIA TIP	MAP A, SEGMENT
R-2233AA	RUTHERFORD	6/1/2014		US 221		4.93	SYSTEM ADDITION - EXISTING VIA TIP	MAP A, SEGMENT
R-2233AA	RUTHERFORD	6/1/2014		SR 2105	STATE LINE RD	0.10	SYSTEM ADDITION - EXISTING VIA TIP	MAP A, SEGMENT
R-2233AA	RUTHERFORD	6/1/2014		SR 2210	CHASE HIGH RD	0.07	SYSTEM ADDITION - EXISTING VIA TIP	MAP B, SEGMENT
R-2233AA	RUTHERFORD	6/1/2014		SR 1117	HARRILL RD	0.07	SYSTEM ADDITION - EXISTING VIA TIP	MAP B, SEGMENT
R-2233AA	RUTHERFORD	6/1/2014		SR 2109	ISLAND FORD RD	0.17	SYSTEM ADDITION - EXISTING VIA TIP	MAP B, SEGMENT
R-2233AA	RUTHERFORD	6/1/2014		SR 2125	HARRIS HENRIETTA RD	0.16	SYSTEM ADDITION - EXISTING VIA TIP	MAP C, SEGMENT
R-2233AA	RUTHERFORD	6/1/2014		SR 2230	NEW JERUSALEM CHURCH RD	0.04	SYSTEM ADDITION - EXISTING VIA TIP	MAP C, SEGMENT
R-2233AA	RUTHERFORD	6/1/2014		SR 1223	SOUTH RIVER RD	0.09	SYSTEM DELETION VIA TIP	MAP A, SEGMENT

TIP	COUNTY	APPROVAL DATE	NEW ROUTE	EXISTING ROUTE	STREET NAME	LENGTH (miles)	TYPE OF CHANGE	REMARKS (See Attached Map)
R-2233AA	RUTHERFORD	6/1/2014		US 221		0.08	SYSTEM DELETION VIA TIP	MAP A, SEGMENT
R-2233AA	RUTHERFORD	6/1/2014		SR 2105	STATELINE RD	0.08	SYSTEM DELETION VIA TIP	MAP A, SEGMENT
R-2233AA	RUTHERFORD	6/1/2014		SR 1117	HARRILL RD	0.10	SYSTEM DELETION VIA TIP	MAP B, SEGMENT
R-2233AA	RUTHERFORD	6/1/2014		SR 2109	ISLAND FORD RD	0.22	SYSTEM DELETION VIA TIP	MAP B, SEGMENT
R-2233AA	RUTHERFORD	6/1/2014		SR 2210	CHASE HIGH RD	0.09	SYSTEM DELETION VIA TIP	MAP B, SEGMENT
R-2233AA	RUTHERFORD	6/1/2014		SR 2269	DAVIS LAKE RD	0.01	SYSTEM DELETION VIA TIP	MAP B, SEGMENT
R-2233AA	RUTHERFORD	6/1/2014		SR 2230	NEW JERUSALEM CHURCH RD	0.08	SYSTEM DELETION VIA TIP	MAP C, SEGMENT
R-2233AA	RUTHERFORD	6/1/2014		SR 2125	HARRIS HENRIETTA RD	0.17	SYSTEM DELETION VIA TIP	MAP C, SEGMENT

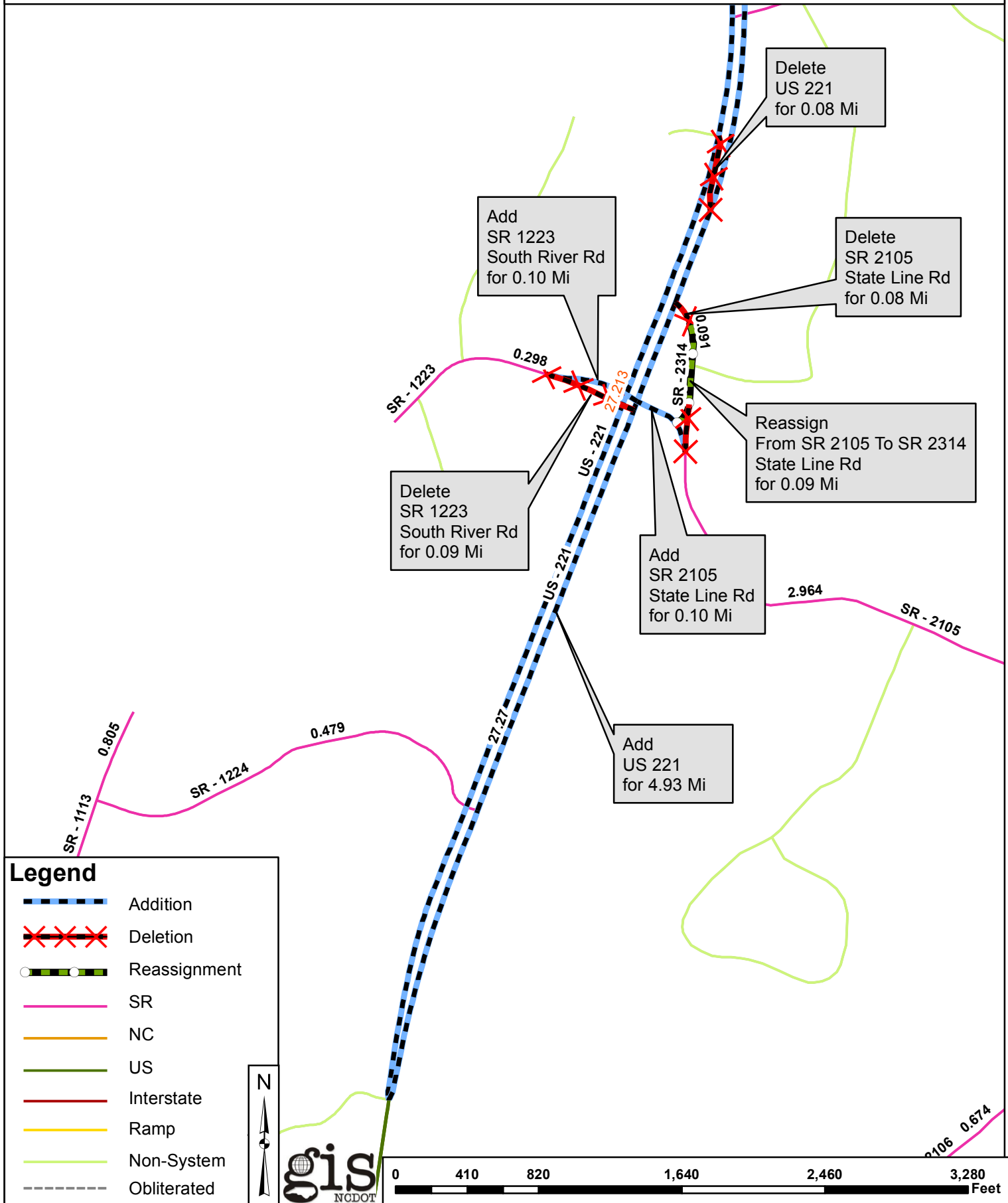

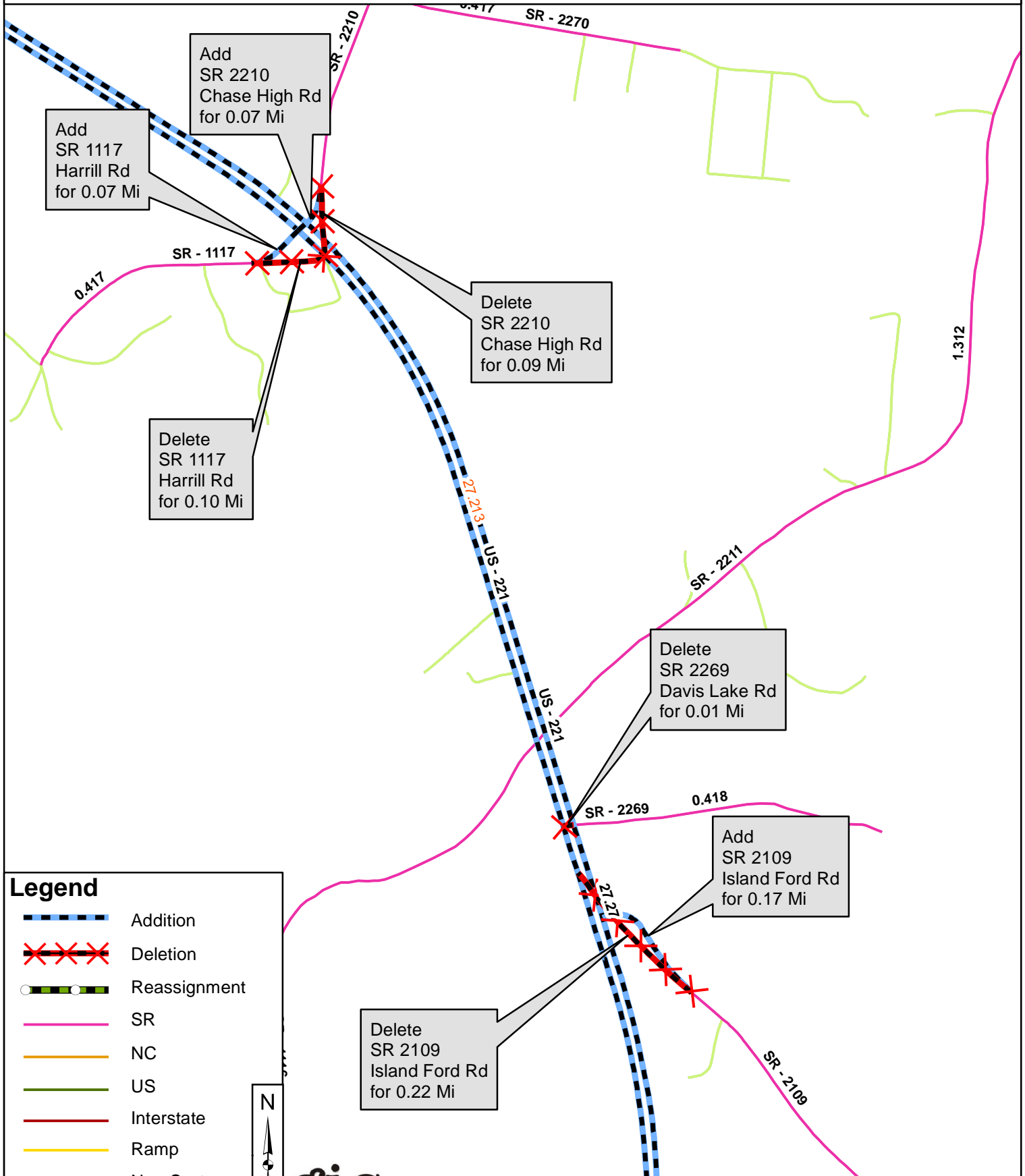

Legend

- Addition
- Deletion
- Reassignment
- SR
- NC
- US
- Interstate
- Ramp
- Non-System
- Obliterated

N

0 500 1,000 2,000 3,000 4,000 Feet

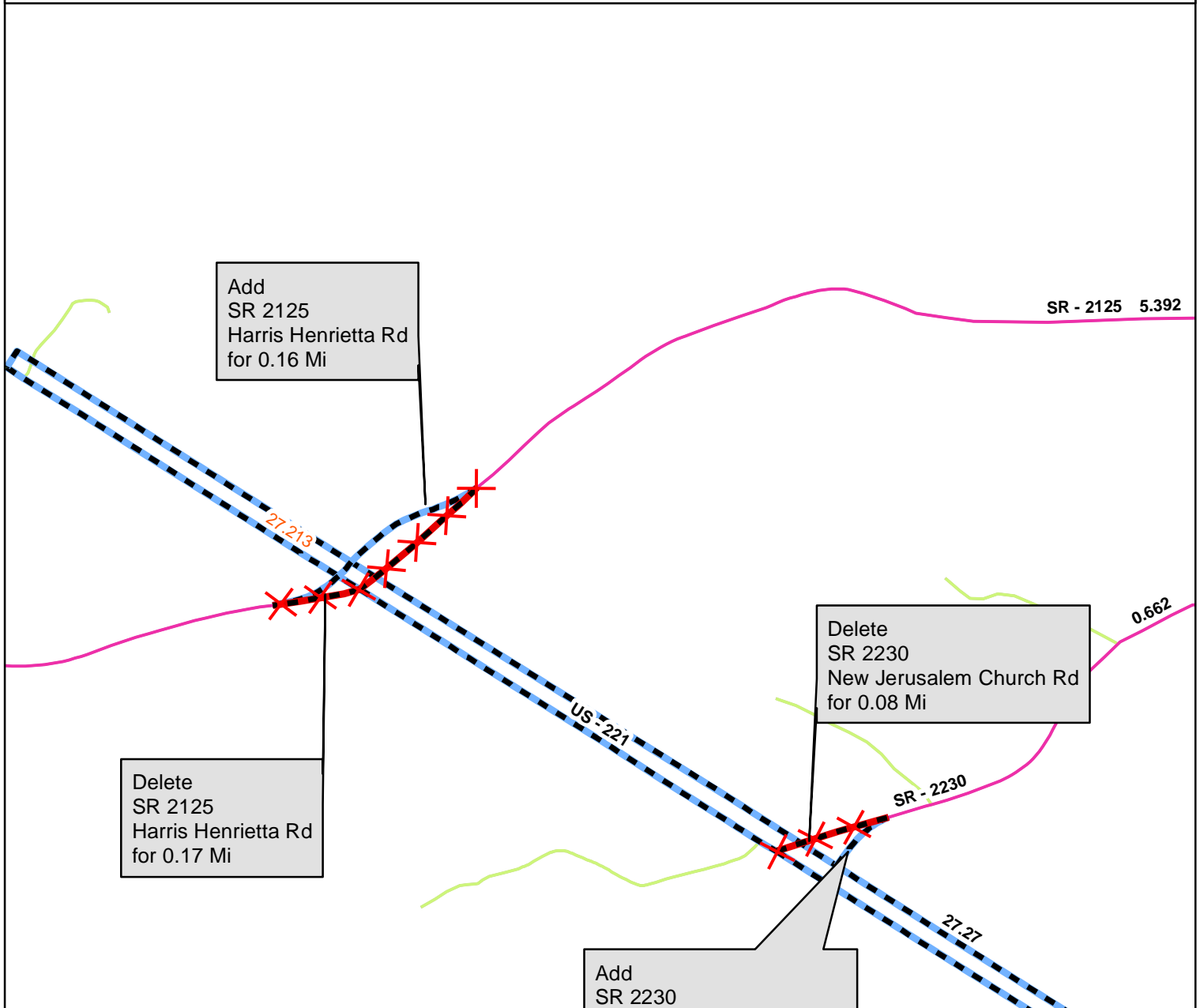

Legend

- Addition
- Deletion
- Reassignment
- SR
- NC
- US
- Interstate
- Ramp
- Non-System
- Obliterated

N

