



STATE OF NORTH CAROLINA  
DEPARTMENT OF TRANSPORTATION

PATRICK MCCRORY  
GOVERNOR

Monday, March 10, 2014

ANTHONY TATA  
SECRETARY

**MEMORANDUM TO:** Mr. Jay Swain, PE  
Division Engineer  
Division 13

**FROM:** John C. Farley, Manager  
Geographic Information Systems Unit

**SUBJECT:** 2014 District 2 Road System Changes

The Data Conversion Group has been authorized to make the following changes to the state road system as indicated below. We request that you make similar changes to the related maps and files in your Division and District offices, and install appropriate road number signs if necessary. We have updated our records accordingly. If our system changes do not conform to the actual conditions in the field, please return this memorandum with recommendations.

PETITION	County	Approval Date
BUNCOMBE_2014_03_50463	BUNCOMBE	3/6/2014

Inquiries about changes should be referred to the GIS Help Desk at (919) 707-2152.  
Thank you for your assistance.

JCF

- cc: BSIP
- Bridge Maintenance
- Division Right of Way
- IMG
- Pavement Management
- Permit Unit
- State Road Maintenance
- Traffic Engineering
- Traffic Surveys

**MAILING ADDRESS:**  
NC DEPARTMENT OF TRANSPORTATION  
GEOGRAPHIC INFORMATION SYSTEMS  
1521 MAIL SERVICE CENTER  
RALEIGH, NC 27699-1521



**DELIVERY ADDRESS:**  
4101 CAPITAL BLVD.  
RALEIGH, NC 27604  
PHONE: (919) 707-2152  
FAX: (919) 707-2214

---

# 2014 ROAD SYSTEM CHANGES







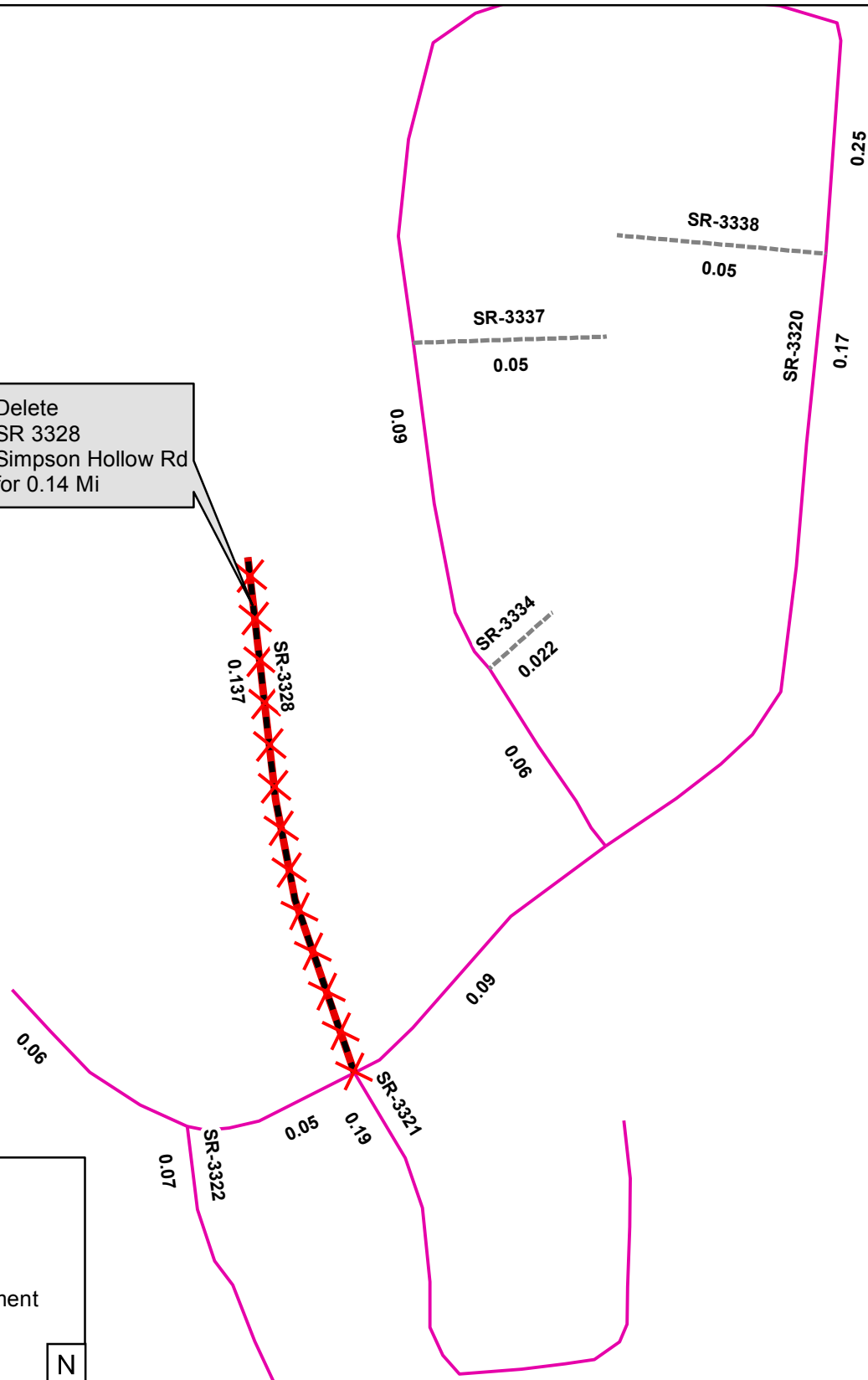

---

<b>PETITION</b>	<b>COUNTY</b>	<b>APPROVAL DATE</b>	<b>ROUTE NUMBER</b>	<b>PORTION REASSIGNED TO</b>	<b>STREET NAME</b>	<b>LENGTH (miles)</b>	<b>TYPE OF CHANGE</b>	<b>REMARKS (See Attached Map)</b>
BUNCOMBE_2014_03_5046 3	BUNCOMBE	3/6/2014	SR 3328		SIMPSON HOLLOW RD	0.14	SYSTEM DELETION VIA PETITION	

Delete  
SR 3328  
Simpson Hollow Rd  
for 0.14 Mi



**Legend**

-  Addition
-  Deletion
-  Reassignment
-  SR
-  NC
-  US
-  Interstate
-  Ramp

