



STATE OF NORTH CAROLINA
DEPARTMENT OF TRANSPORTATION

PATRICK MCCRORY
GOVERNOR

Monday, January 27, 2014

ANTHONY TATA
SECRETARY

MEMORANDUM TO: Mr. S. Pat Ivey, PE
Division Engineer
Division 9

FROM: John C. Farley, Manager
Geographic Information Systems Unit

SUBJECT: 2014 District 1 Road System Changes

The Data Conversion Group has been authorized to make the following changes to the state road system as indicated below. We request that you make similar changes to the related maps and files in your Division and District offices, and install appropriate road number signs if necessary. We have updated our records accordingly. If our system changes do not conform to the actual conditions in the field, please return this memorandum with recommendations.

Hwy. Ordinance #	County	Approval Date
HTO_28_01-14	DAVIDSON	1/9/2014

Inquiries about changes should be referred to the GIS Help Desk at (919) 707-2152.
Thank you for your assistance.

JCF

- cc: BSIP
- Bridge Maintenance
- Division Right of Way
- IMG
- Pavement Management
- Permit Unit
- State Road Maintenance
- Traffic Engineering
- Traffic Surveys

MAILING ADDRESS:
NC DEPARTMENT OF TRANSPORTATION
GEOGRAPHIC INFORMATION SYSTEMS
1521 MAIL SERVICE CENTER
RALEIGH, NC 27699-1521



DELIVERY ADDRESS:
4101 CAPITAL BLVD.
RALEIGH, NC 27604
PHONE: (919) 707-2152
FAX: (919) 707-2214

2014 ROAD SYSTEM CHANGES

HTO	COUNTY	APPROVAL DATE	NEW ROUTE	EXISTING ROUTE	STREET NAME	LENGTH (miles)	TYPE OF CHANGE	REMARKS (See Attached Maps)
HTO_28_01-14	DAVIDSON	1/9/2014	SR 3508	SR 1285		0.11	REASSIGNMENT VIA HTO	MAP A, SEGME
HTO_28_01-14	DAVIDSON	1/9/2014	SR 3507	SR 1285		0.12	REASSIGNMENT VIA HTO	MAP A, SEGME
HTO_28_01-14	DAVIDSON	1/9/2014	I- 85 US 52	I- 85 US 29 US 52 US 70		0.12	REASSIGNMENT VIA HTO	MAP D, SEGME
HTO_28_01-14	DAVIDSON	1/9/2014		I- 85 US 52		1.03	SYSTEM ADDITION - EXISTING VIA HTO	MAP A, SEGME
HTO_28_01-14	DAVIDSON	1/9/2014		NC 150		0.17	SYSTEM ADDITION - EXISTING VIA HTO	MAP B, SEGME
HTO_28_01-14	DAVIDSON	1/9/2014		US 29 US 70 NC 150		0.83	SYSTEM ADDITION - EXISTING VIA HTO	MAP C, SEGME
HTO_28_01-14	DAVIDSON	1/9/2014		SR 1139		0.09	SYSTEM ADDITION - EXISTING VIA HTO	MAP D, SEGME
HTO_28_01-14	DAVIDSON	1/9/2014		SR 1285		0.50	SYSTEM ADDITION - EXISTING VIA HTO	MAP F, SEGME
HTO_28_01-14	DAVIDSON	1/9/2014		SR 1136		0.03	SYSTEM ADDITION - EXISTING VIA HTO	MAP G, SEGME
HTO_28_01-14	DAVIDSON	1/9/2014	SR 3508			0.71	SYSTEM ADDITION - NEW VIA HTO	MAP E, SEGME

HTO	COUNTY	APPROVAL DATE	NEW ROUTE	EXISTING ROUTE	STREET NAME	LENGTH (miles)	TYPE OF CHANGE	REMARKS (See Attached Maps)
HTO_28_01-14	DAVIDSON	1/9/2014	SR 3507			0.12	SYSTEM ADDITION - NEW VIA HTO	MAP E, SEGME
HTO_28_01-14	DAVIDSON	1/9/2014		I- 85 US 52		0.39	SYSTEM DELETION VIA HTO	MAP A, SEGME
HTO_28_01-14	DAVIDSON	1/9/2014		NC 150		0.77	SYSTEM DELETION VIA HTO	MAP B, SEGME
HTO_28_01-14	DAVIDSON	1/9/2014		I- 85 US 52 US 29 US 70 NC 150		0.63	SYSTEM DELETION VIA HTO	MAP C, SEGME
HTO_28_01-14	DAVIDSON	1/9/2014		US 29 US 70 NC 150		0.04	SYSTEM DELETION VIA HTO	MAP C, SEGME
HTO_28_01-14	DAVIDSON	1/9/2014		SR 1290		0.34	SYSTEM DELETION VIA HTO	MAP D, SEGME
HTO_28_01-14	DAVIDSON	1/9/2014		SR 1285		0.79	SYSTEM DELETION VIA HTO	MAP F, SEGME
HTO_28_01-14	DAVIDSON	1/9/2014		SR 1295		0.15	SYSTEM DELETION VIA HTO	MAP G, SEGME
HTO_28_01-14	DAVIDSON	1/9/2014		SR 1136		0.04	SYSTEM DELETION VIA HTO	MAP G, SEGME

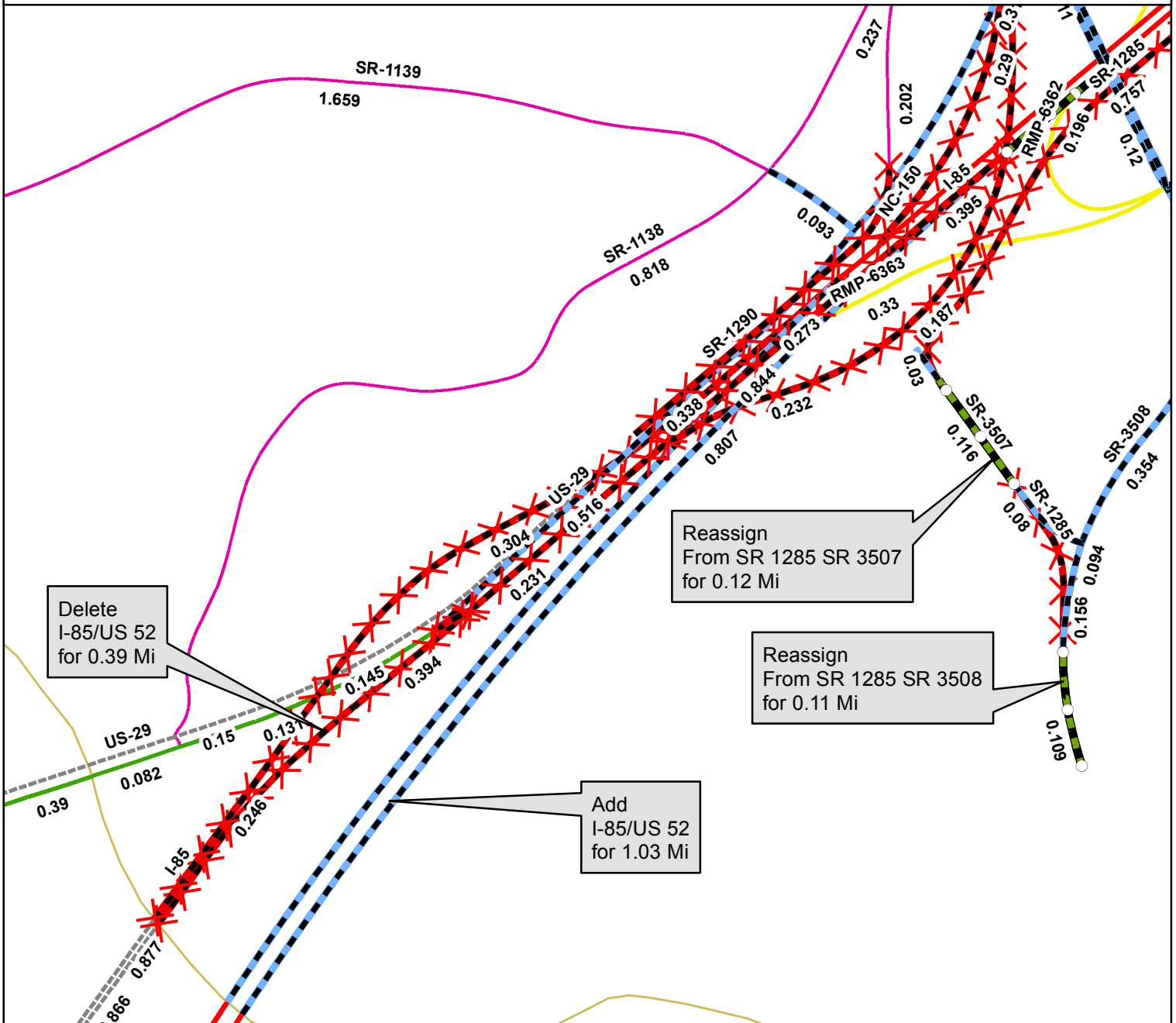

Legend

- Addition
- Deletion
- Reassignment
- SR
- NC
- US
- Interstate
- Ramp
- County Boundary

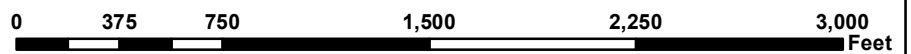

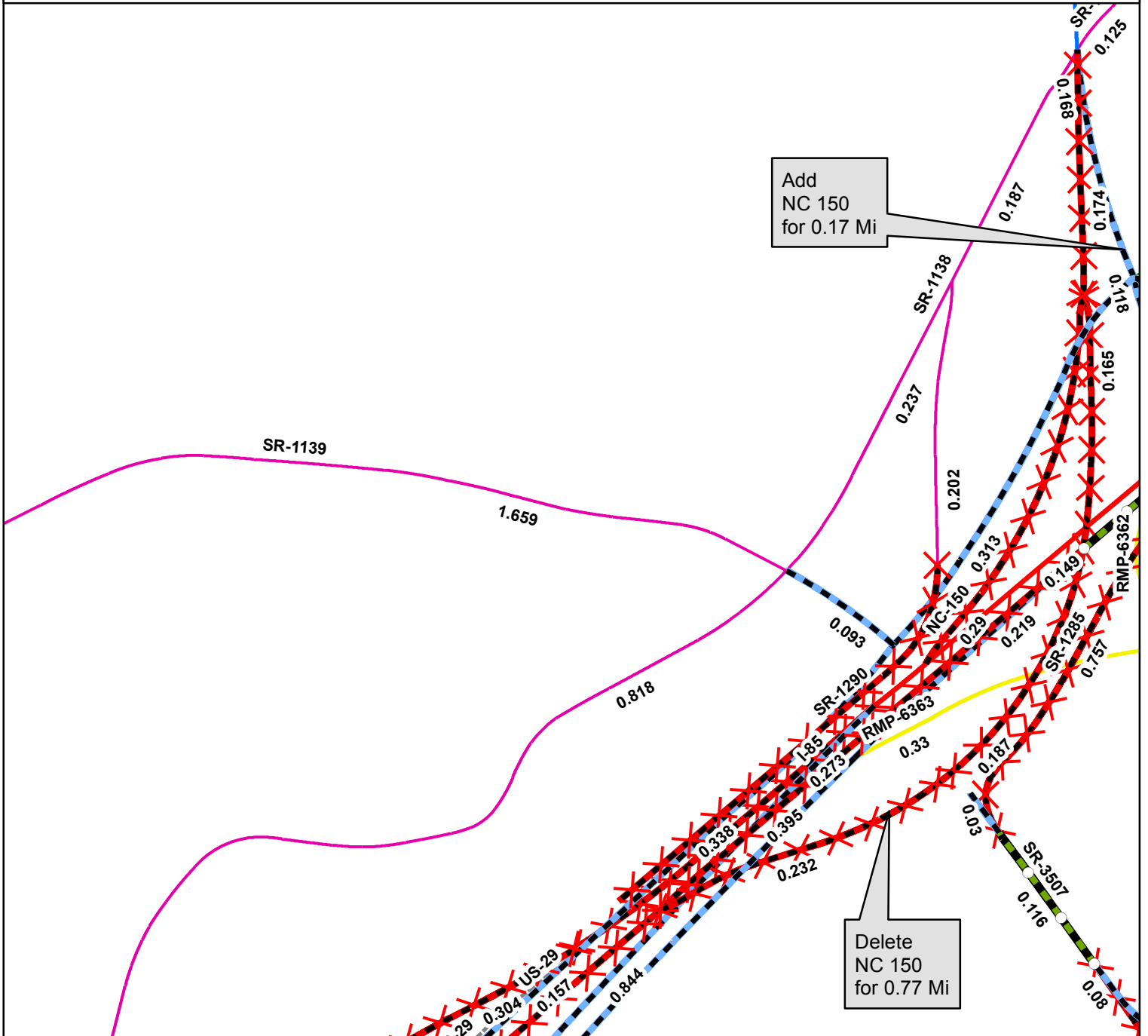



Add
NC 150
for 0.17 Mi

Delete
NC 150
for 0.77 Mi

Legend

- Addition
- Deletion
- Reassignment
- SR
- NC
- US
- Interstate
- Ramp

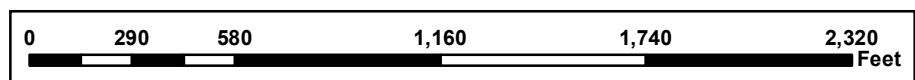

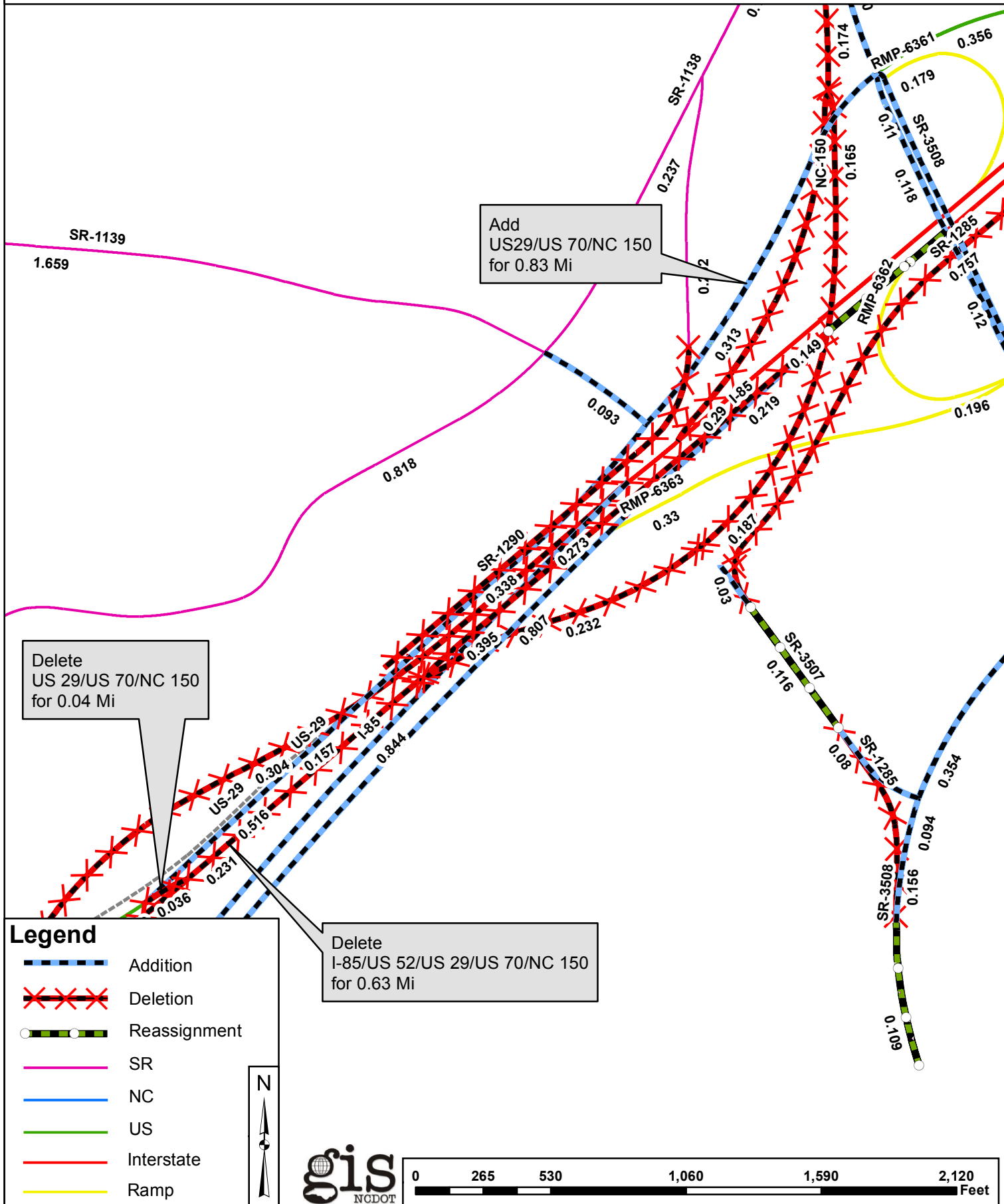

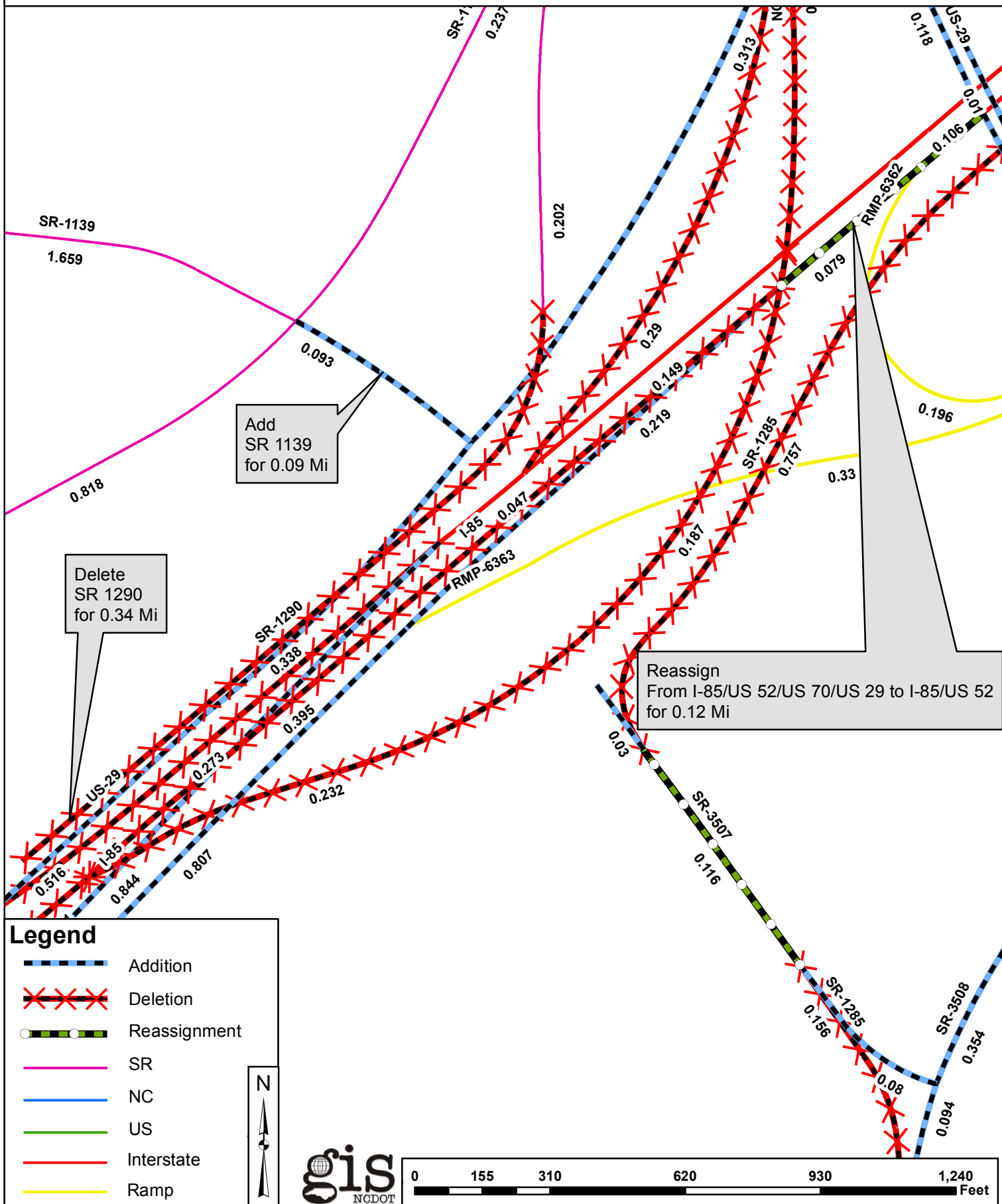

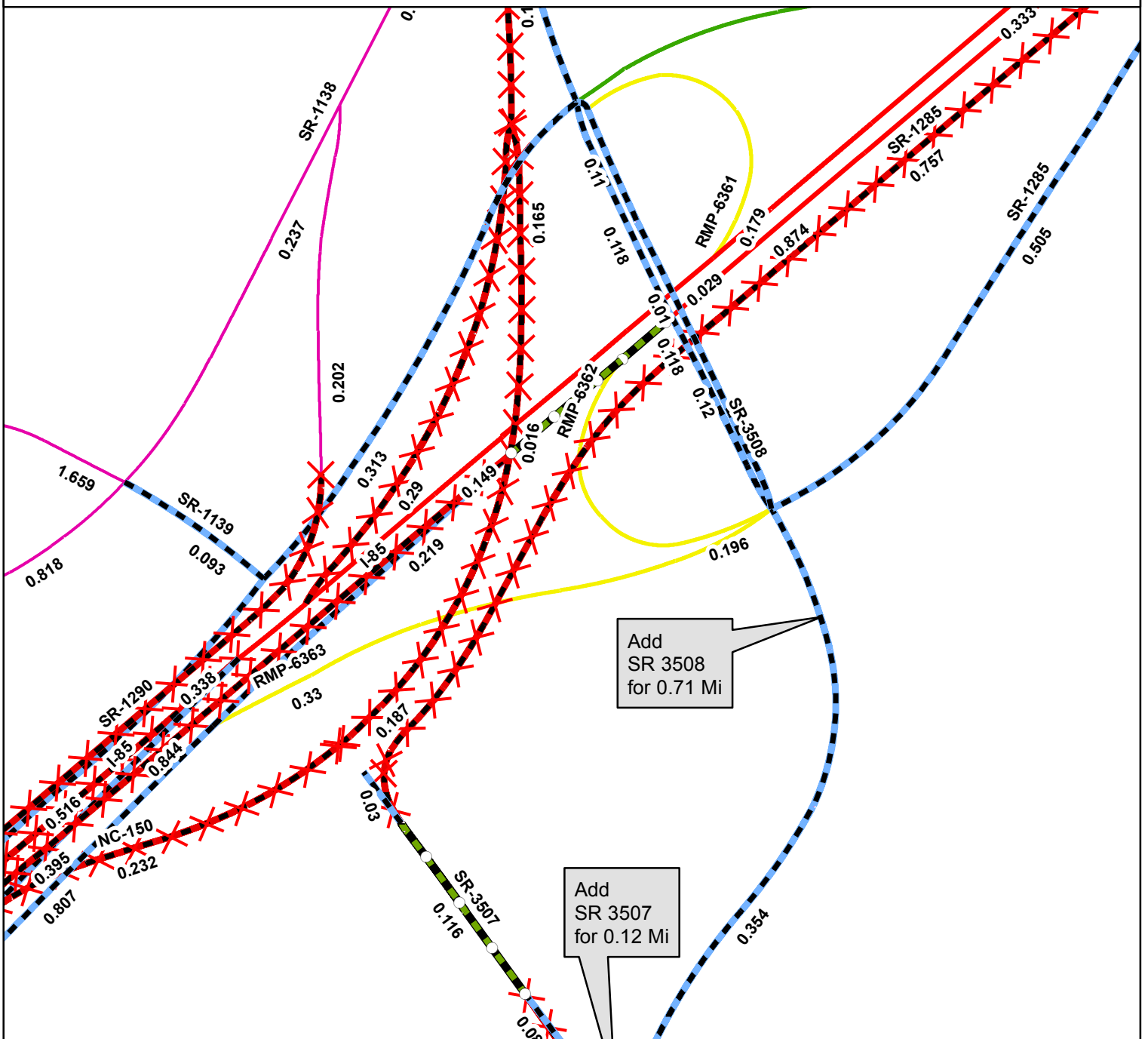
Legend

-  Addition
 -  Deletion
 -  Reassignment
 -  SR
 -  NC
 -  US
 -  Interstate
 -  Ramp
- Legend also includes a North arrow pointing up and the text "N".

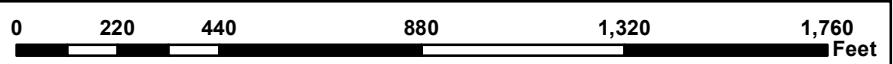

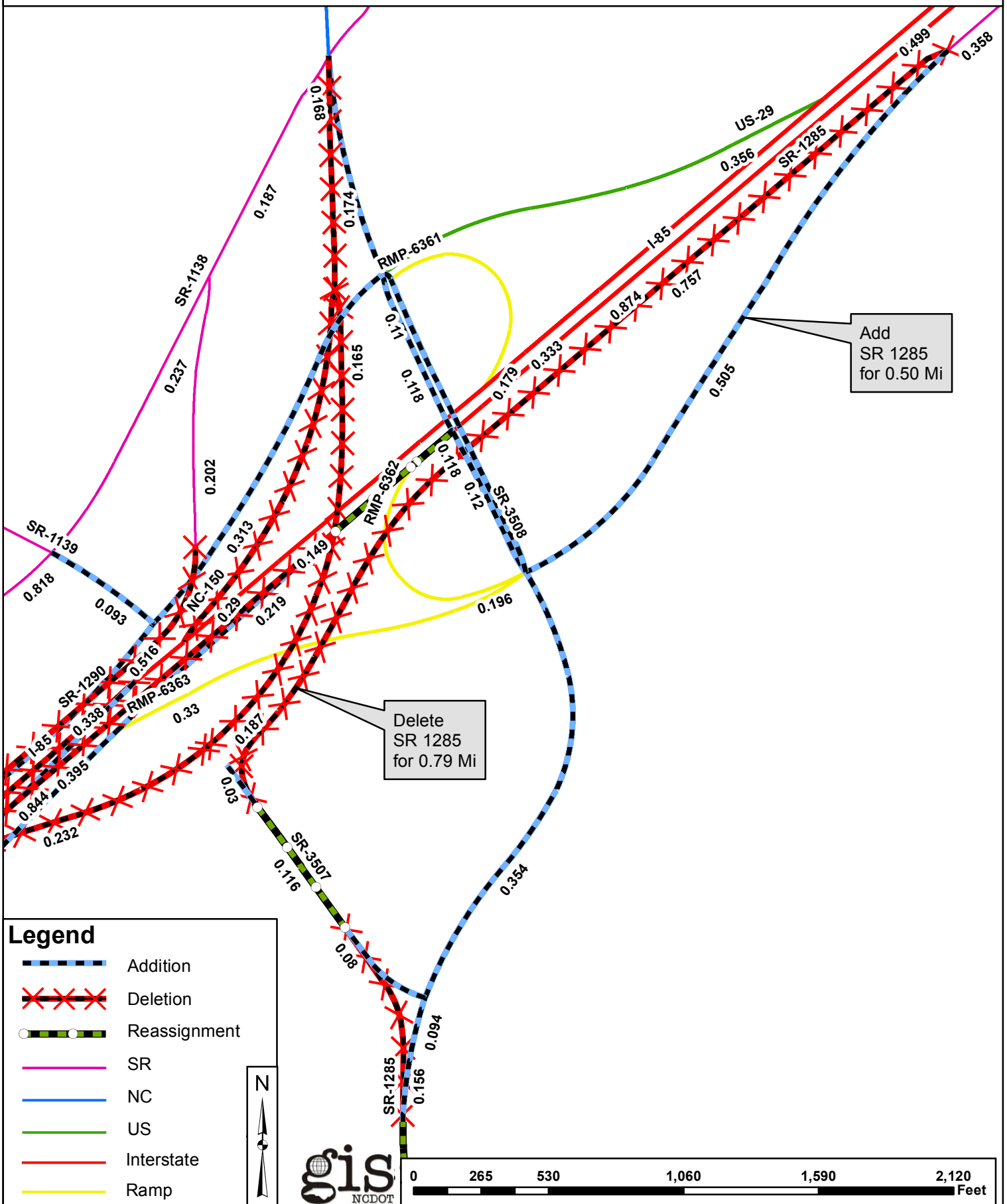

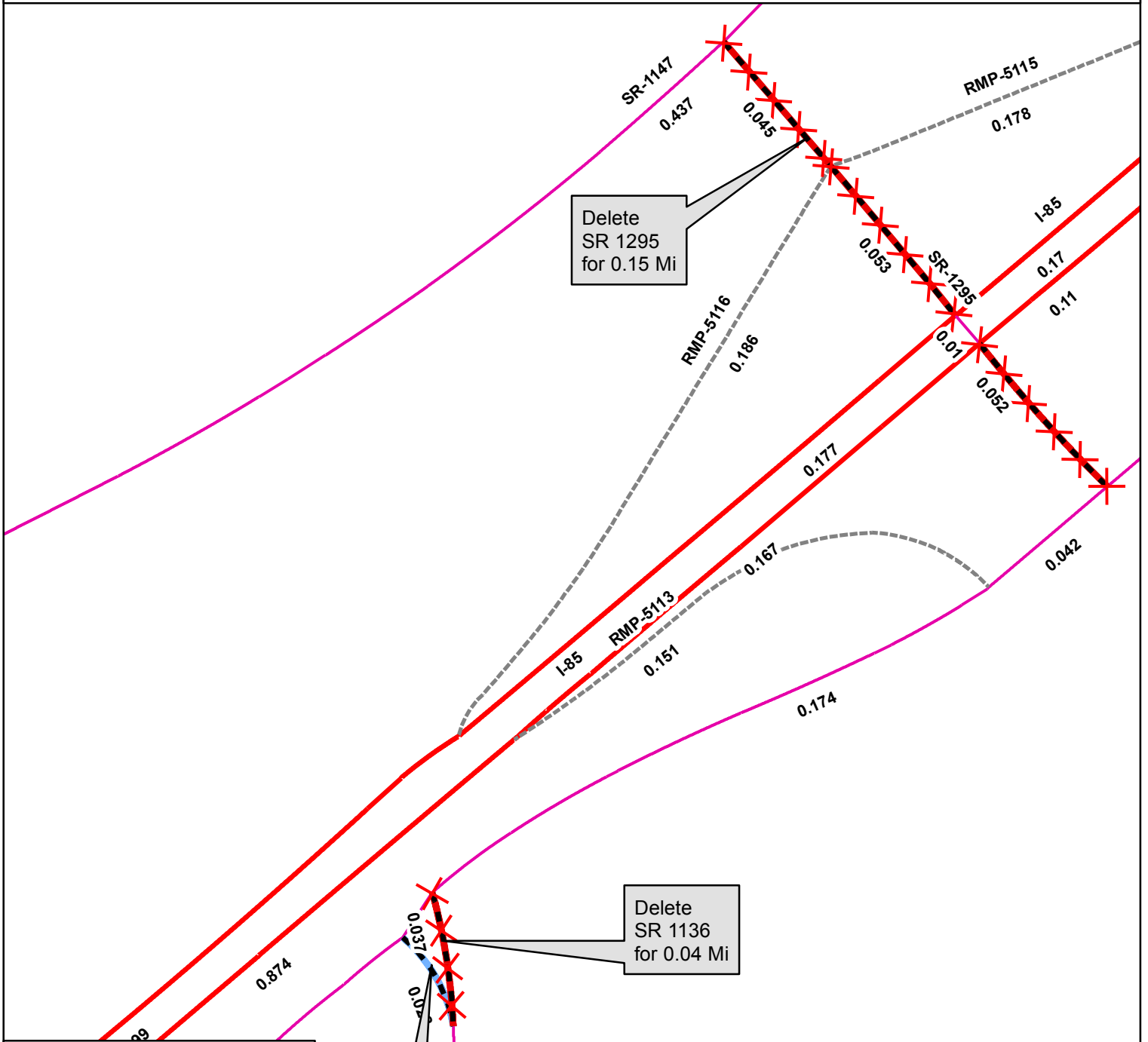

Legend

- Addition
- Deletion
- Reassignment
- SR
- NC
- US
- Interstate
- Ramp

Add
SR 1136
for 0.03 Mi

Delete
SR 1136
for 0.04 Mi

Delete
SR 1295
for 0.15 Mi

