



STATE OF NORTH CAROLINA
DEPARTMENT OF TRANSPORTATION

ROY COOPER
GOVERNOR

JAMES H. TROGDON, III
SECRETARY

DATE: August 14, 2019
TO: Mr. C.E. Lassiter, PE
Division Engineer
Division 2
FROM: John C. Farley
Manager
Geographic Information Systems Unit
SUBJECT: 2019 District 1 Road System Changes

The GIS Unit's Data Conversion Group has been authorized to make the changes indicated below to the state road system. We request that you update the related maps and files in your offices and install appropriate road number signs, if necessary. If our system changes do not conform to the actual conditions in the field, please return this memorandum with recommendations.

Document Number	County	Approval Date
R-2510C	BEAUFORT	01/03/2014

Questions or comments about changes should be referred to the GIS Help Desk at GISHelp@ncdot.gov.

Thank you for your assistance.

JCF

cc: BSIP
Bridge Maintenance
Division Right of Way
IMG
Pavement Management
Permit Unit
State Road Maintenance
Traffic Engineering
Traffic Surveys

MAILING ADDRESS:
NC DEPARTMENT OF TRANSPORTATION
GEOGRAPHIC INFORMATION SYSTEMS UNIT
1521 MAIL SERVICE CENTER
RALEIGH, NC 27699-1521

Telephone: (919) 707-2165
FAX: 919-707-2210
Customer Service: 1-877-368-4968
Website: www.ncdot.gov

LOCATION:
4101 CAPITAL BLVD.
RALEIGH, NC 27604

2019 Road System Changes

TIP Name: R-2510C
Date: 01/03/2014
County: BEAUFORT

Additions

Route	Street Name	Mileage	Map
US 17	US 17 HWY N	3.1	B
US 17		1.2	C
NC 171	NC 171 HWY	0.05	C
SR 1409	WHARTON STATION RD	0.05	C

Deletions

Route	Street Name	Mileage	Map
US 17	US 17 HWY N	0.08	A
US 17		0.12	C
NC 171	NC 171 HWY	0.06	C
SR 1409	WHARTON STATION RD	0.06	C

Reassignments

Existing Route	New Route	Street Name	Mileage	Map
None				

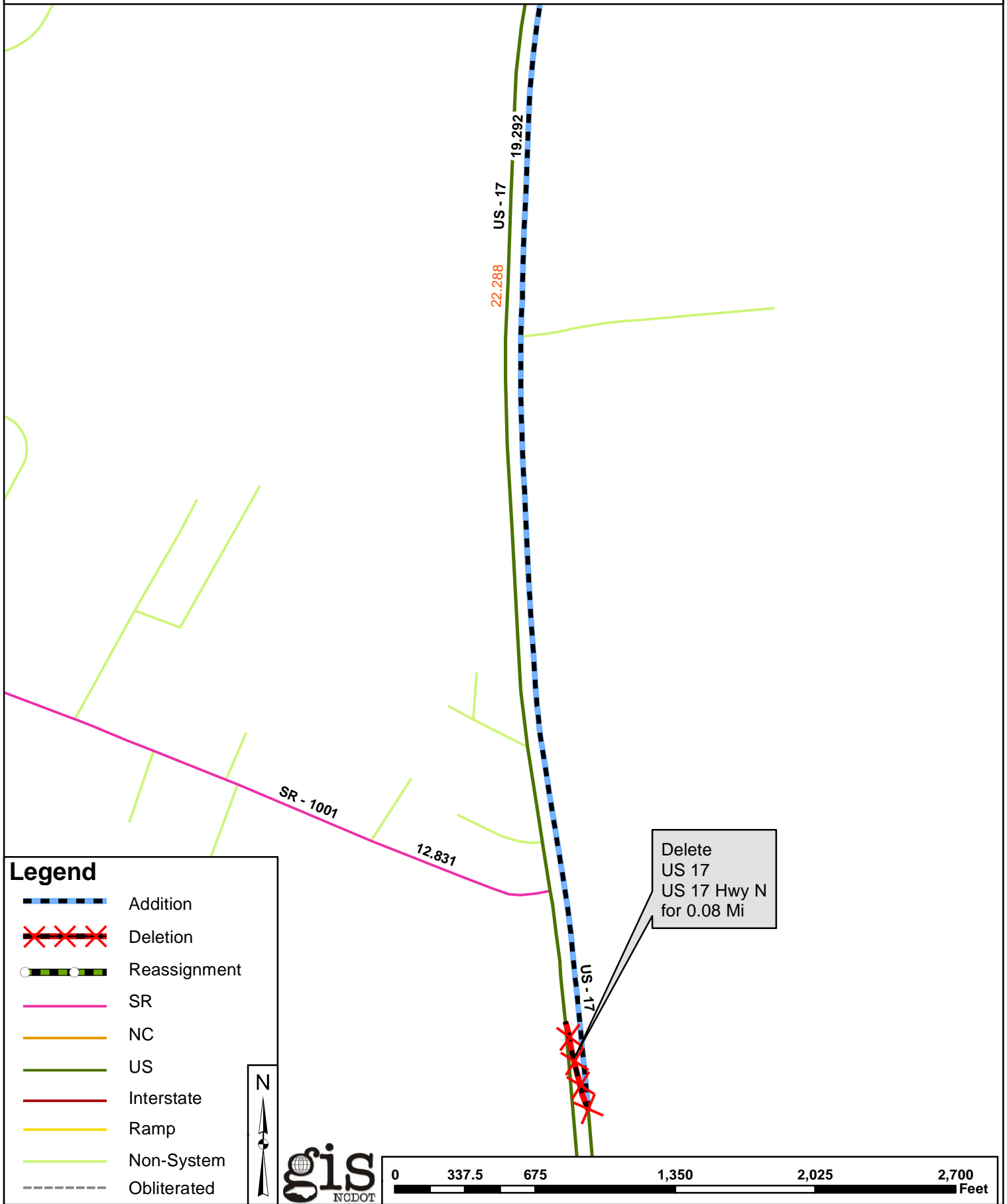

Legend

-  Addition
-  Deletion
-  Reassignment
-  SR
-  NC
-  US
-  Interstate
-  Ramp
-  Non-System
-  Obliterated

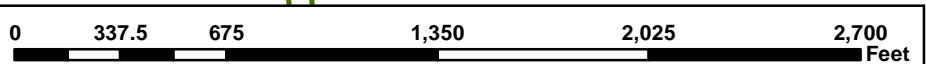

Delete
US 17
US 17 Hwy N
for 0.08 Mi

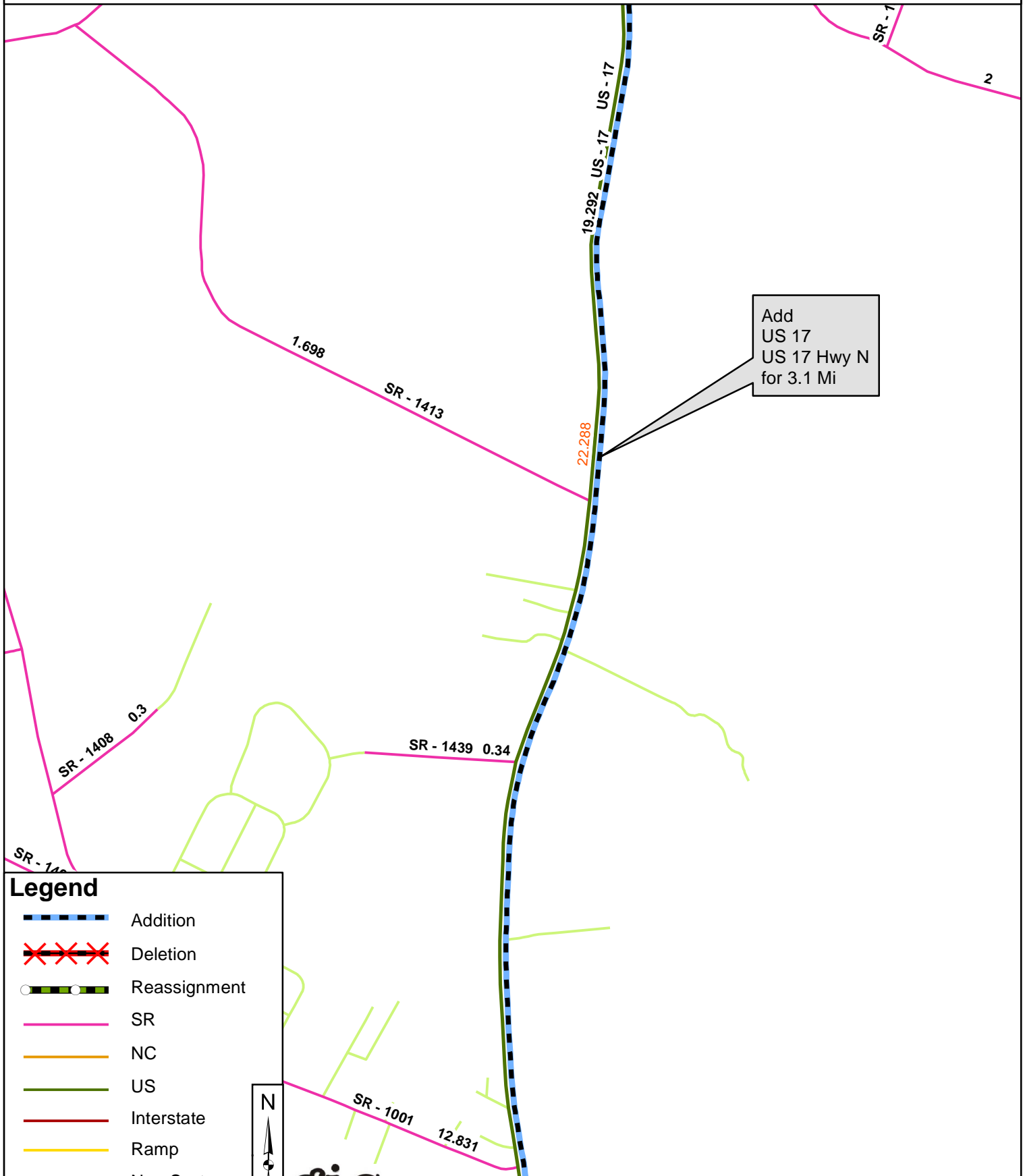

Add
US 17
US 17 Hwy N
for 3.1 Mi

Legend

-  Addition
-  Deletion
-  Reassignment
-  SR
-  NC
-  US
-  Interstate
-  Ramp
-  Non-System
-  Obliterated

