



STATE OF NORTH CAROLINA
DEPARTMENT OF TRANSPORTATION

PATRICK MCCRORY
GOVERNOR

Monday, June 10, 2013

ANTHONY TATA
SECRETARY

MEMORANDUM TO: Mr. S. Pat Ivey, PE
Division Engineer
Division 9

FROM: John C. Farley, Manager
Geographic Information Systems Unit

SUBJECT: 2013 District 2 Road System Changes

The Data Conversion Group has been authorized to make the following changes to the state road system as indicated below. We request that you make similar changes to the related maps and files in your Division and District offices, and install appropriate road number signs if necessary. We have updated our records accordingly. If our system changes do not conform to the actual conditions in the field, please return this memorandum with recommendations.

PETITION	County	Approval Date
FORSYTH_2013_06_50259	FORSYTH	6/6/2013

Inquiries about changes should be referred to the GIS Help Desk at (919) 707-2152.
Thank you for your assistance.

JCF

- cc: BSIP
- Bridge Maintenance
- Division Right of Way
- IMG
- Pavement Management
- Permit Unit
- State Road Maintenance
- Traffic Engineering
- Traffic Surveys

2013 ROAD SYSTEM CHANGES

PETITION	COUNTY	APPROVAL DATE	ROUTE NUMBER	PORTION REASSIGNED	STREET NAME	LENGTH (miles)	TYPE OF CHANGE	REMARKS (See Attached Map)
FORSYTH_2013_06_50259	FORSYTH	6/6/2013	SR 4601		BARNSDALE RIDGE CT	0.08	SYSTEM ADDITION VIA PETITION	
FORSYTH_2013_06_50259	FORSYTH	6/6/2013	SR 4600		WATER MILL CT	0.07	SYSTEM ADDITION VIA PETITION	
FORSYTH_2013_06_50259	FORSYTH	6/6/2013	SR 4399		OVERBROOK MEADOW CT	0.10	SYSTEM ADDITION VIA PETITION	
FORSYTH_2013_06_50259	FORSYTH	6/6/2013	SR 4398		BARNSDALE RIDGE RD	0.37	SYSTEM ADDITION VIA PETITION	
FORSYTH_2013_06_50259	FORSYTH	6/6/2013	SR 4397		WATER MILL RD	0.64	SYSTEM ADDITION VIA PETITION	

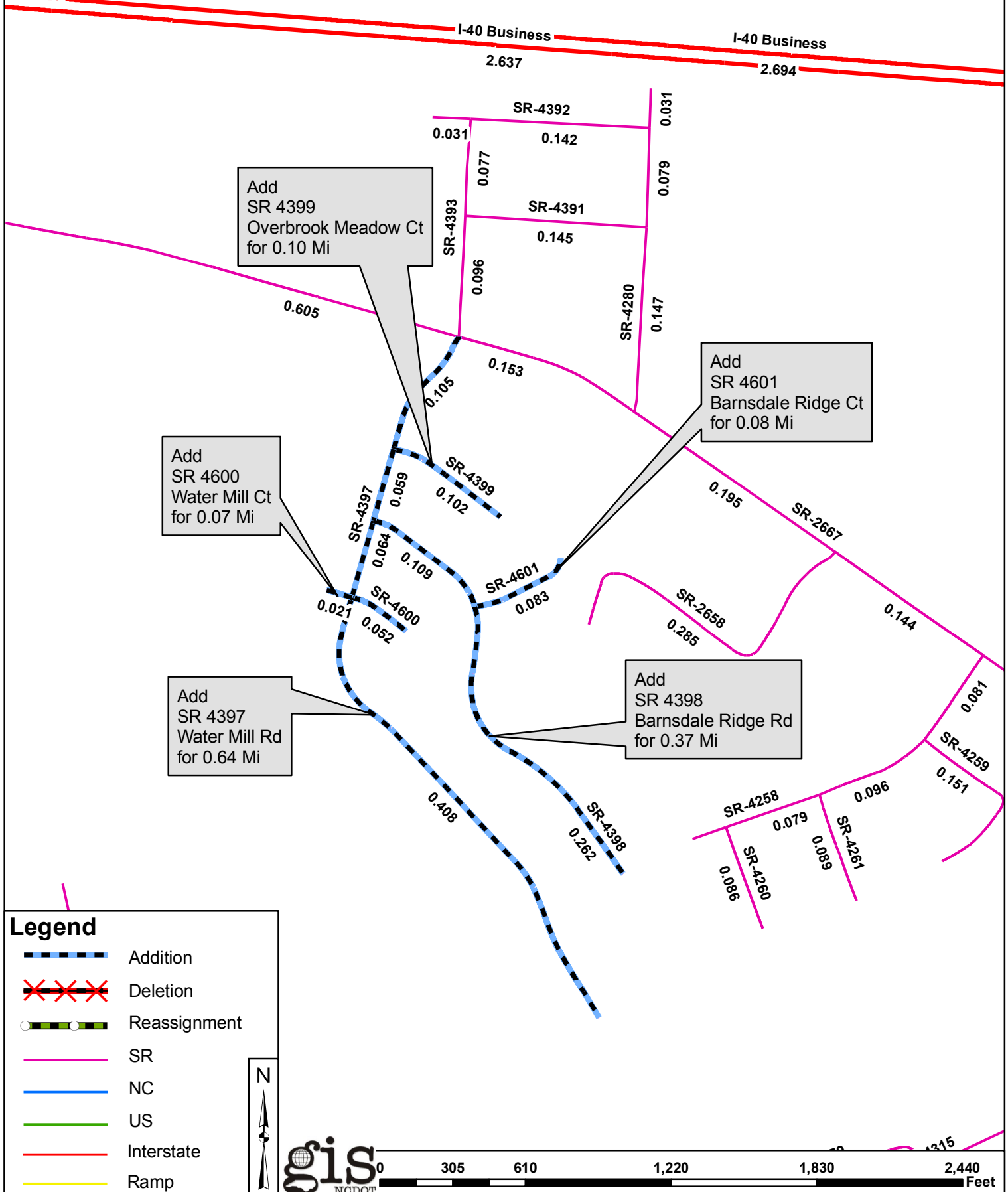

Add
SR 4399
Overbrook Meadow Ct
for 0.10 Mi

Add
SR 4601
Barnsdale Ridge Ct
for 0.08 Mi

Add
SR 4600
Water Mill Ct
for 0.07 Mi

Add
SR 4397
Water Mill Rd
for 0.64 Mi

Add
SR 4398
Barnsdale Ridge Rd
for 0.37 Mi

Legend

- Addition
- Deletion
- Reassignment
- SR
- NC
- US
- Interstate
- Ramp

N

gis NCDOT

0 305 610 1,220 1,830 2,440 Feet