



STATE OF NORTH CAROLINA  
DEPARTMENT OF TRANSPORTATION

PATRICK MCCRORY  
GOVERNOR

Monday, April 08, 2013

ANTHONY TATA  
SECRETARY

**MEMORANDUM TO:** Mr. Jay Swain, PE  
Division Engineer  
Division 13

**FROM:** John C. Farley, Manager  
Geographic Information Systems Unit

**SUBJECT:** 2013 District 1 Road System Changes

The Data Conversion Group has been authorized to make the following changes to the state road system as indicated below. We request that you make similar changes to the related maps and files in your Division and District offices, and install appropriate road number signs if necessary. We have updated our records accordingly. If our system changes do not conform to the actual conditions in the field, please return this memorandum with recommendations.

PETITION	County	Approval Date
BURKE_2013_04_50225	BURKE	4/4/2013

Inquiries about changes should be referred to the GIS Help Desk at (919) 707-2152.  
Thank you for your assistance.

JCF

- cc: BSIP
- Bridge Maintenance
- Division Right of Way
- IMG
- Pavement Management
- Permit Unit
- State Road Maintenance
- Traffic Engineering
- Traffic Surveys



# 2013 ROAD SYSTEM CHANGES

<b>PETITION</b>	<b>COUNTY</b>	<b>APPROVAL DATE</b>	<b>ROUTE NUMBER</b>	<b>PORTION REASSIGNED</b>	<b>STREET NAME</b>	<b>LENGTH (miles)</b>	<b>TYPE OF CHANGE</b>	<b>REMARKS (See Attached Map)</b>
BURKE_2013_04_50225	BURKE	4/4/2013	SR 2144		BENTLEY DR	0.09	SYSTEM ADDITION VIA PETITION	
BURKE_2013_04_50225	BURKE	4/4/2013	SR 2100		BEDFORD DR EXT	0.06	SYSTEM ADDITION VIA PETITION	

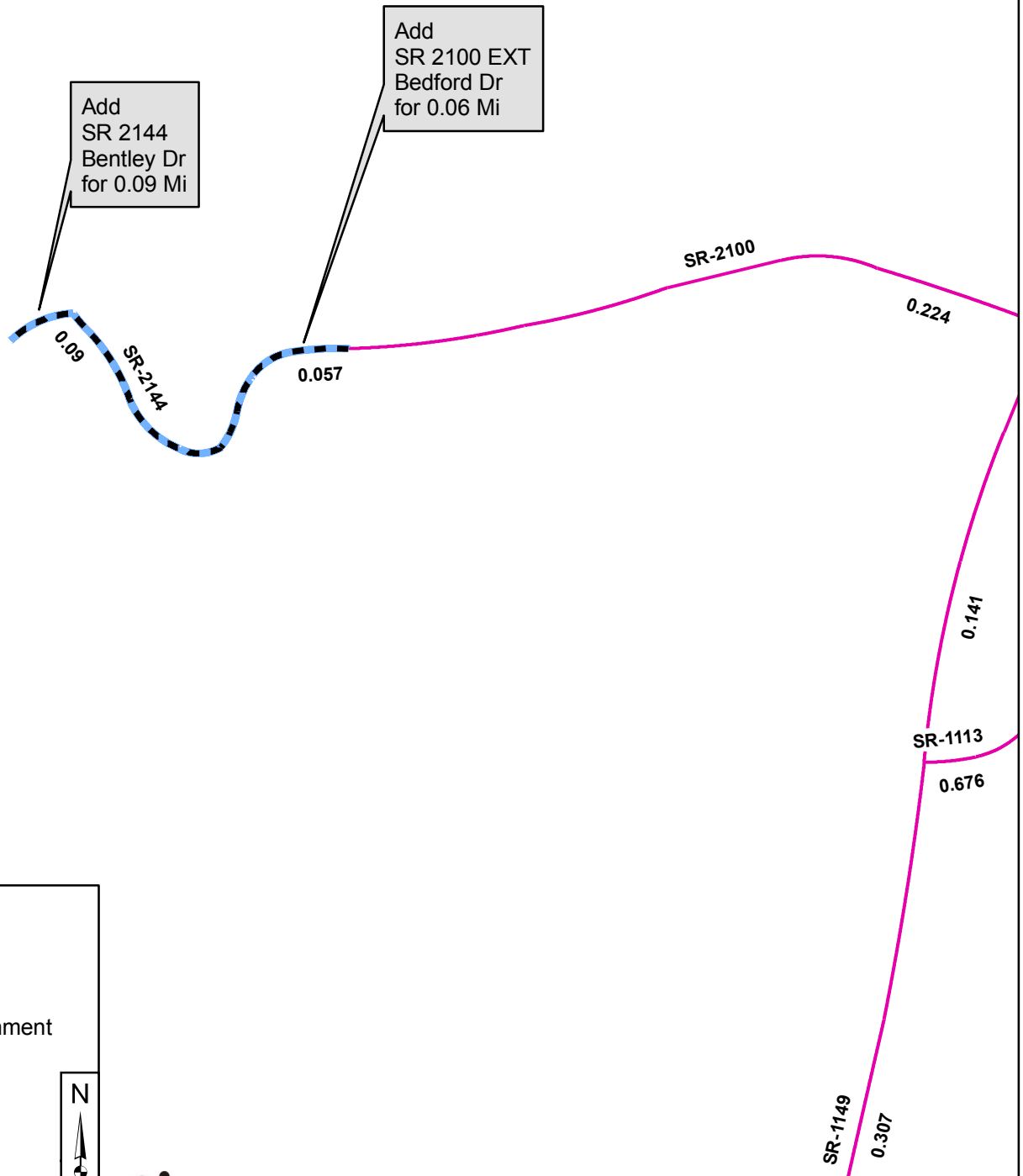

**Legend**

-  Addition
-  Deletion
-  Reassignment
-  SR
-  NC
-  US
-  Interstate
-  Ramp

