



STATE OF NORTH CAROLINA
DEPARTMENT OF TRANSPORTATION

PATRICK MCCRORY
GOVERNOR

Thursday, April 11, 2013

ANTHONY TATA
SECRETARY

MEMORANDUM TO: Mr. Louis Mitchell, PE
Division Engineer
Division 10

FROM: John C. Farley, Manager
Geographic Information Systems Unit

SUBJECT: 2013 District 3 Road System Changes

The Data Conversion Group has been authorized to make the following changes to the state road system as indicated below. We request that you make similar changes to the related maps and files in your Division and District offices, and install appropriate road number signs if necessary. We have updated our records accordingly. If our system changes do not conform to the actual conditions in the field, please return this memorandum with recommendations.

PETITION	County	Approval Date
UNION_2013_04_50218	UNION	4/4/2013

Inquiries about changes should be referred to the GIS Help Desk at (919) 707-2152.
Thank you for your assistance.

JCF

- cc: BSIP
- Bridge Maintenance
- Division Right of Way
- IMG
- Pavement Management
- Permit Unit
- State Road Maintenance
- Traffic Engineering
- Traffic Surveys



2013 ROAD SYSTEM CHANGES







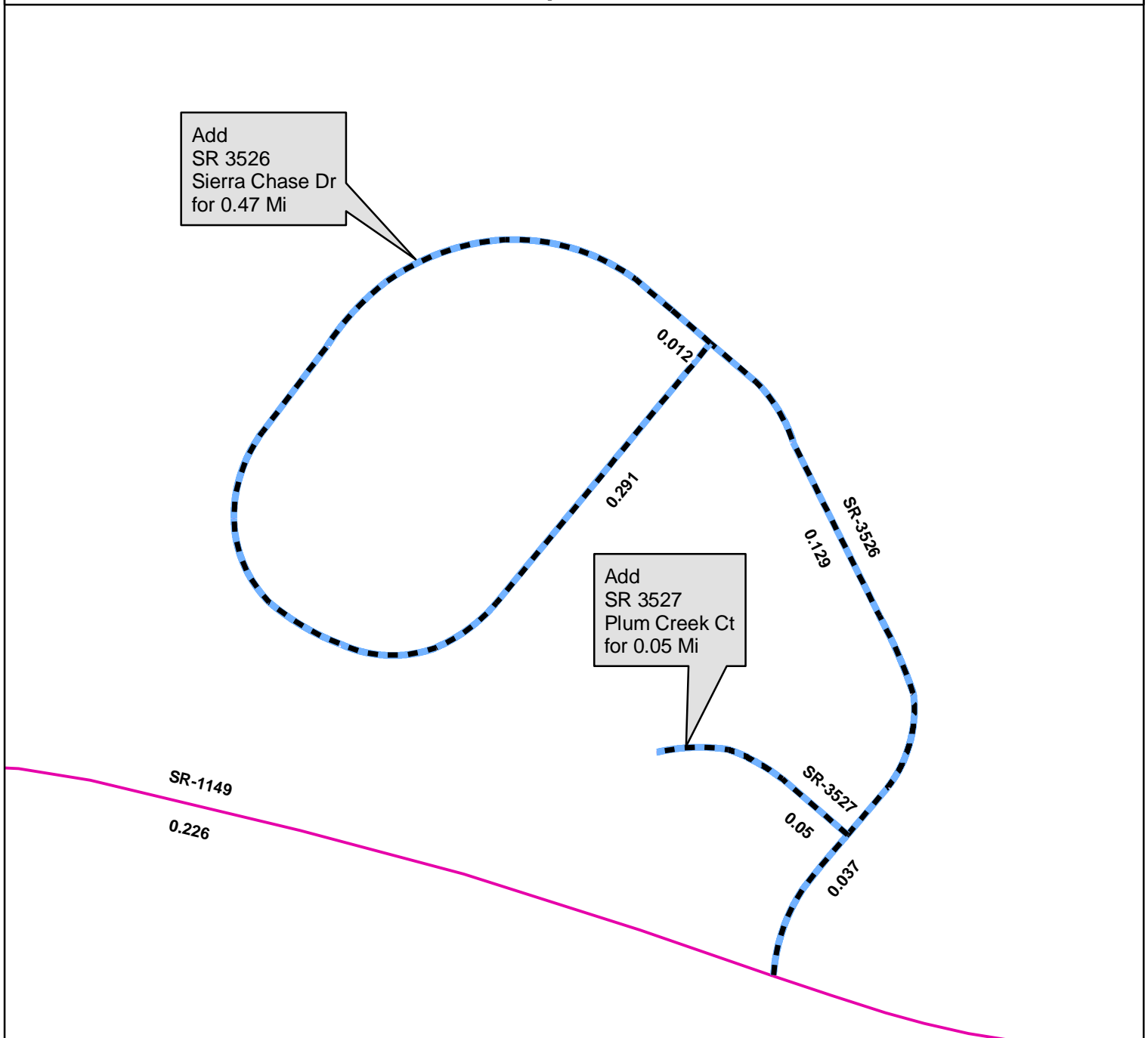

PETITION	COUNTY	APPROVAL DATE	ROUTE NUMBER	PORTION REASSIGNED	STREET NAME	LENGTH (miles)	TYPE OF CHANGE	REMARKS (See Attached Map)
UNION_2013_04_50218	UNION	4/4/2013	SR 3529		OLD COURSE RD	0.19	SYSTEM ADDITION VIA PETITION	
UNION_2013_04_50218	UNION	4/4/2013	SR 3528		OUT OF BOUNDS DR	0.40	SYSTEM ADDITION VIA PETITION	
UNION_2013_04_50218	UNION	4/4/2013	SR 3527		PLUM CREEK CT	0.05	SYSTEM ADDITION VIA PETITION	
UNION_2013_04_50218	UNION	4/4/2013	SR 3526		SIERRA CHASE DR	0.47	SYSTEM ADDITION VIA PETITION	

Add
SR 3526
Sierra Chase Dr
for 0.47 Mi

Add
SR 3527
Plum Creek Ct
for 0.05 Mi



Legend





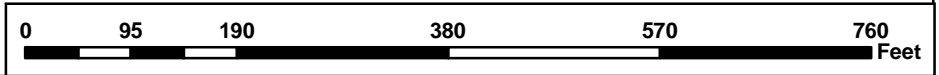

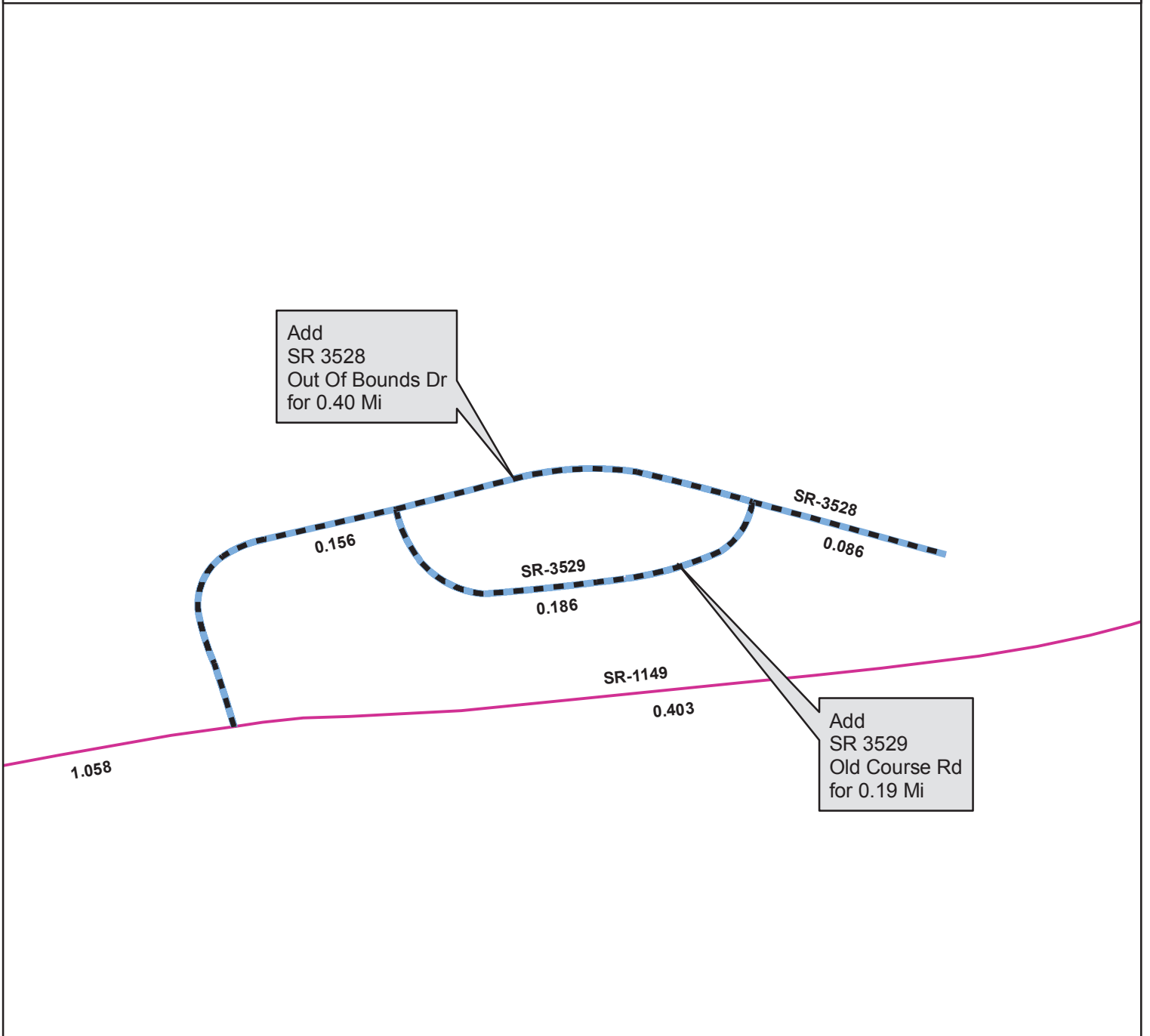

-  Addition
-  Deletion
-  Reassignment
-  SR
-  NC
-  US
-  Interstate
-  Ramp

N
↑





Legend

-  Addition
-  Deletion
-  Reassignment
-  SR
-  NC
-  US
-  Interstate
-  Ramp

N
↑

