



STATE OF NORTH CAROLINA
DEPARTMENT OF TRANSPORTATION

PATRICK MCCRORY
GOVERNOR

Thursday, April 11, 2013

ANTHONY TATA
SECRETARY

MEMORANDUM TO: Mr. Louis Mitchell, PE
Division Engineer
Division 10

FROM: John C. Farley, Manager
Geographic Information Systems Unit

SUBJECT: 2013 District 3 Road System Changes

The Data Conversion Group has been authorized to make the following changes to the state road system as indicated below. We request that you make similar changes to the related maps and files in your Division and District offices, and install appropriate road number signs if necessary. We have updated our records accordingly. If our system changes do not conform to the actual conditions in the field, please return this memorandum with recommendations.

| PETITION | County | Approval Date |
|---------------------|--------|---------------|
| UNION_2013_04_50217 | UNION | 4/4/2013 |

Inquiries about changes should be referred to the GIS Help Desk at (919) 707-2152.
Thank you for your assistance.

JCF

- cc: BSIP
- Bridge Maintenance
- Division Right of Way
- IMG
- Pavement Management
- Permit Unit
- State Road Maintenance
- Traffic Engineering
- Traffic Surveys







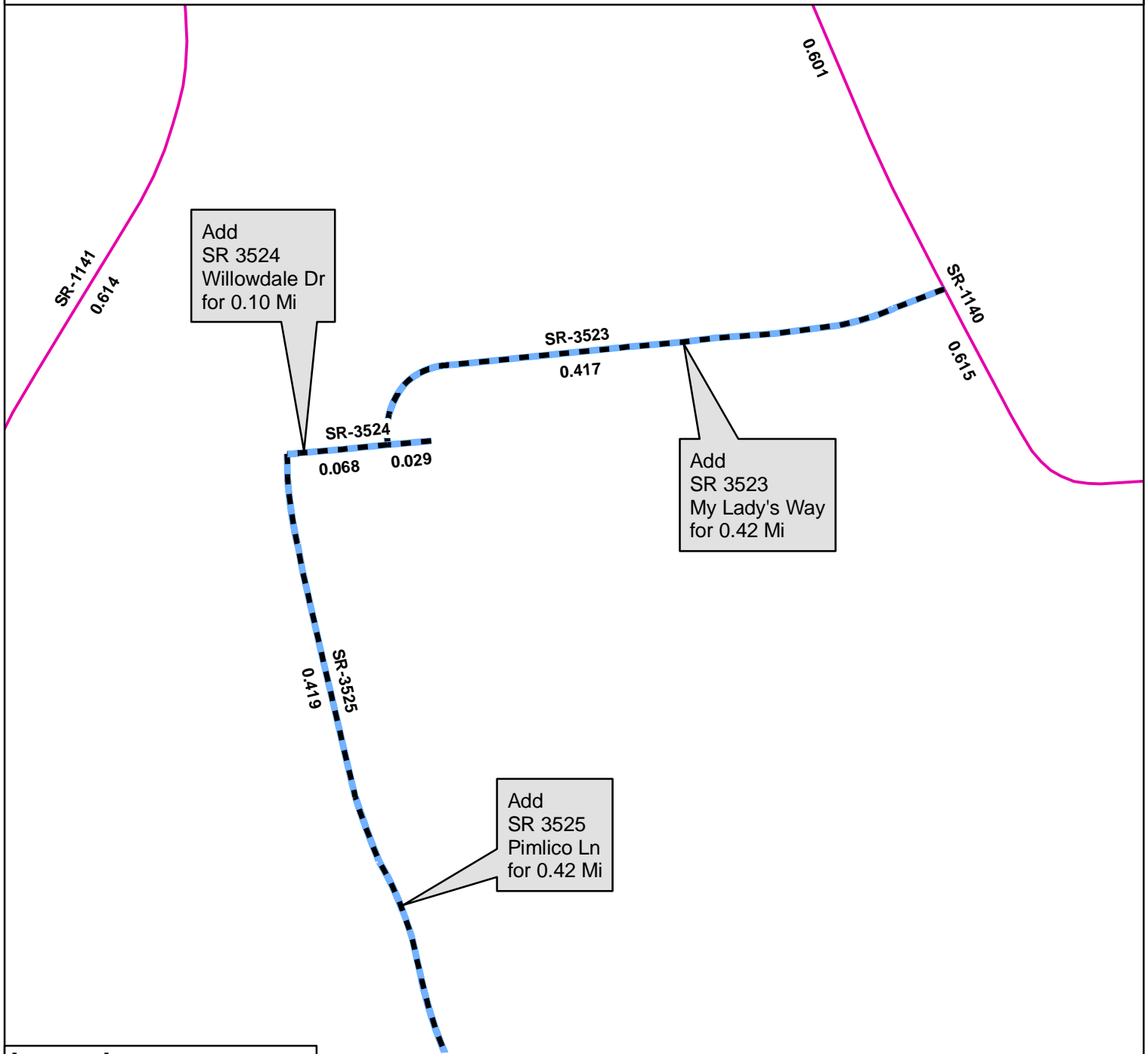



2013 ROAD SYSTEM CHANGES

| PETITION | COUNTY | APPROVAL DATE | ROUTE NUMBER | PORTION REASSIGNED | STREET NAME | LENGTH (miles) | TYPE OF CHANGE | REMARKS (See Attached Map) |
|---------------------|---------------|--------------------------|-------------------------|-------------------------------|------------------------|---------------------------|------------------------------------|---------------------------------------|
| UNION_2013_04_50217 | UNION | 4/4/2013 | SR 3525 | | PIMLICO LN | 0.42 | SYSTEM ADDITION VIA PETITION | |
| UNION_2013_04_50217 | UNION | 4/4/2013 | SR 3524 | | WILLOWDALE DR | 0.10 | SYSTEM ADDITION VIA PETITION | |
| UNION_2013_04_50217 | UNION | 4/4/2013 | SR 3523 | | MY LADY'S WAY | 0.42 | SYSTEM ADDITION VIA PETITION | |



Legend

-  Addition
-  Deletion
-  Reassignment
-  SR
-  NC
-  US
-  Interstate
-  Ramp

