



STATE OF NORTH CAROLINA
DEPARTMENT OF TRANSPORTATION

PATRICK MCCRORY
GOVERNOR

Monday, February 25, 2013

ANTHONY TATA
SECRETARY

MEMORANDUM TO: Mr. Robert W. Lewis, PE
Division Engineer
Division 4

FROM: John C. Farley, Manager
Geographic Information Systems Unit

SUBJECT: 2013 District 1 Road System Changes

The Data Conversion Group has been authorized to make the following changes to the state road system as indicated below. We request that you make similar changes to the related maps and files in your Division and District offices, and install appropriate road number signs if necessary. we have updated our records accordingly. If our system changes do not conform to the actual conditions in the field, please return this memorandum with recommendations.

PETITION	County	Approval Date
EDGECOMBE_2013_02_50184	EDGECOMBE	2/7/2013

Inquiries about changes should be referred to the GIS Help Desk at (919) 707-2152.
Thank you for your assistance.

JCF

- cc: BSIP
- Bridge Maintenance
- Division Right of Way
- IMG
- Pavement Management
- Permit Unit
- State Road Maintenance
- Traffic Engineering
- Traffic Surveys

2013 ROAD SYSTEM CHANGES



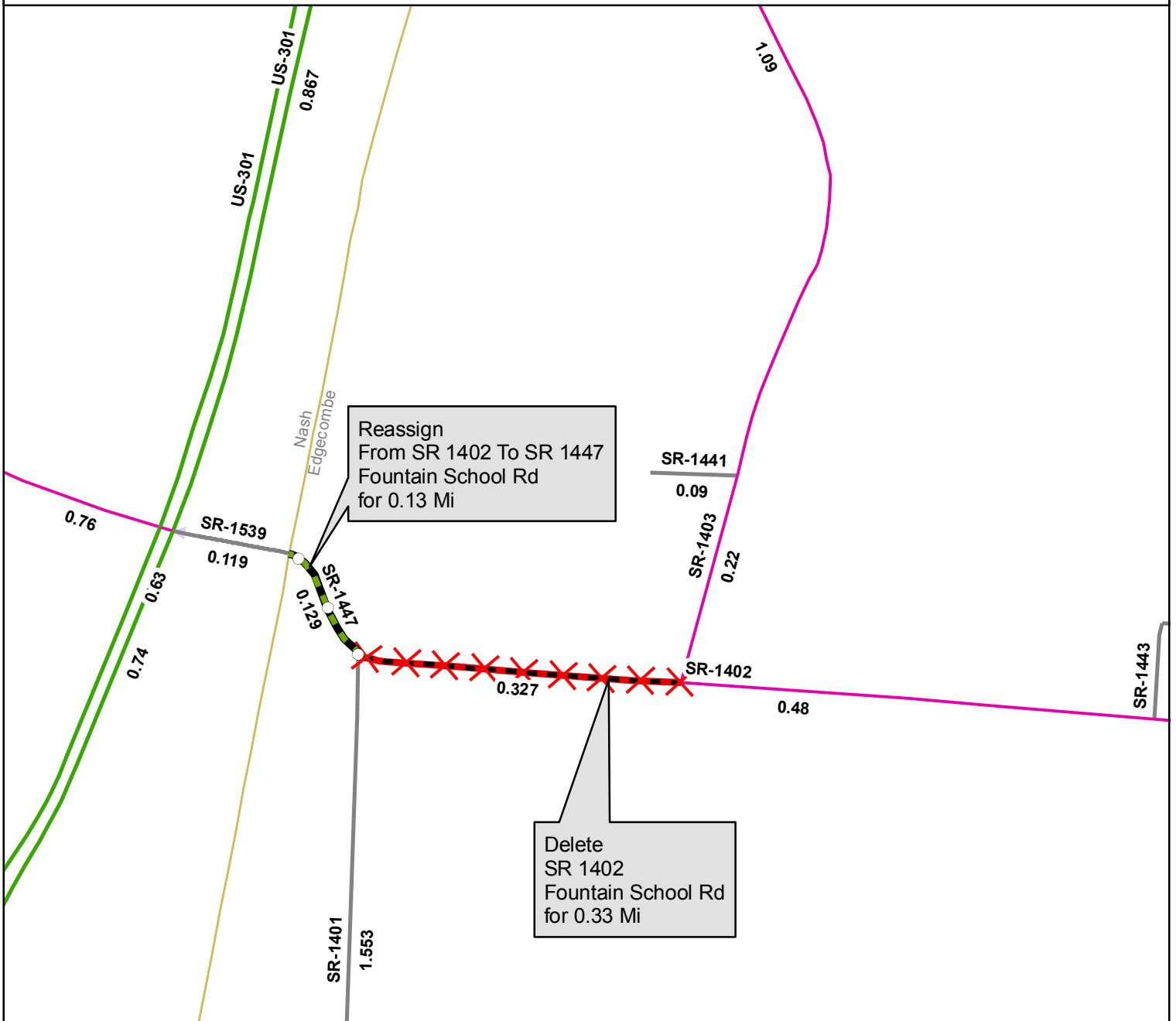





PETITION	COUNTY	APPROVAL DATE	ROUTE NUMBER	PORTION REASSIGNED	STREET NAME	LENGTH (miles)	TYPE OF CHANGE	REMARKS (See Attached Map)
EDGECOMBE_2013_02_501 84	EDGECOMBE	2/7/2013	SR 1402	SR 1447	FOUNTAIN SCHOOL RD	0.13	NUMBER REASSIGNMENT VIA PETITION	
EDGECOMBE_2013_02_501 84	EDGECOMBE	2/7/2013	SR 1402		FOUNTAIN SCHOOL RD	0.33	SYSTEM DELETION VIA PETITION	



Reassign
From SR 1402 To SR 1447
Fountain School Rd
for 0.13 Mi

Delete
SR 1402
Fountain School Rd
for 0.33 Mi

Legend

-  Addition
-  Deletion
-  Reassignment
-  SR
-  NC
-  US
-  Interstate
-  Ramp
-  County Boundary

