



STATE OF NORTH CAROLINA
DEPARTMENT OF TRANSPORTATION

PATRICK MCCRORY
GOVERNOR

Tuesday, January 22, 2013

ANTHONY TATA
SECRETARY

MEMORANDUM TO: Ms. Karen E. Fussell, PE
Division Engineer
Division 3

FROM: John C. Farley, Manager
Geographic Information Systems Unit

SUBJECT: 2013 District 2 Road System Changes

The Data Conversion Group has been authorized to make the following changes to the state road system as indicated below. We request that you make similar changes to the related maps and files in your Division and District offices, and install appropriate road number signs if necessary. we have updated our records accordingly. If our system changes do not conform to the actual conditions in the field, please return this memorandum with recommendations.

PETITION	County	Approval Date
DUPLIN_2013_01_50143	DUPLIN	1/10/2013

Inquiries about changes should be referred to the GIS Help Desk at (919) 707-2152.
Thank you for your assistance.

JCF

- cc: BSIP
- Bridge Maintenance
- Division Right of Way
- IMG
- Pavement Management
- Permit Unit
- State Road Maintenance
- Traffic Engineering
- Traffic Surveys

2013 ROAD SYSTEM CHANGES

PETITION	COUNTY	APPROVAL DATE	ROUTE NUMBER	PORTION REASSIGNED	STREET NAME	LENGTH (miles)	TYPE OF CHANGE	REMARKS (See Attached Map)
DUPLIN_2013_01_50143	DUPLIN	1/10/2013	SR 1423		S. COUNTRY CLUB DR	0.64	SYSTEM ADDITION VIA PETITION	
DUPLIN_2013_01_50143	DUPLIN	1/10/2013	SR 1422		N. COUNTRY CLUB DR	0.64	SYSTEM ADDITION VIA PETITION	
DUPLIN_2013_01_50143	DUPLIN	1/10/2013	SR 1421		CARLTON DR	0.26	SYSTEM ADDITION VIA PETITION	

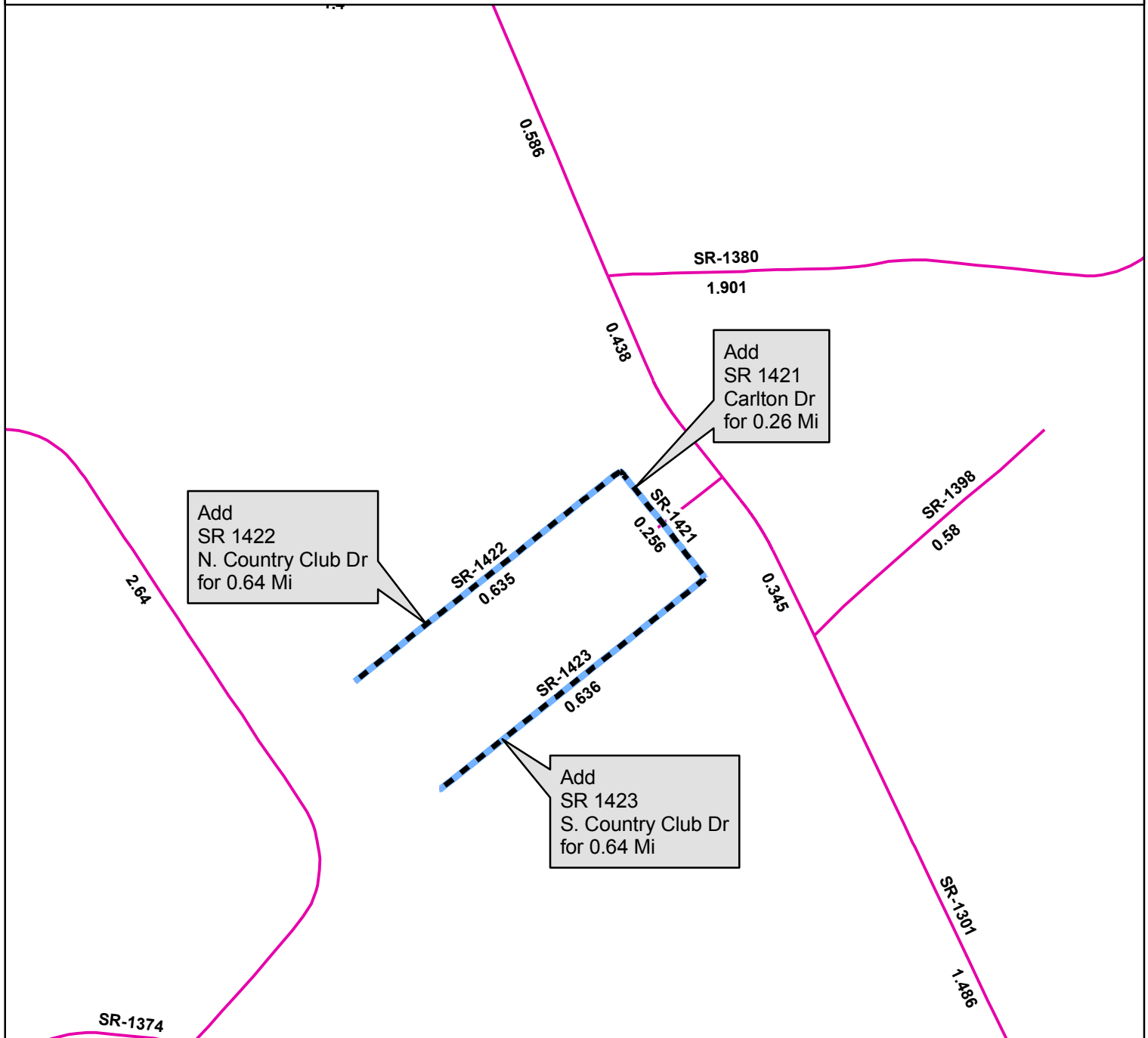









Add
SR 1422
N. Country Club Dr
for 0.64 Mi

Add
SR 1421
Carlton Dr
for 0.26 Mi

Add
SR 1423
S. Country Club Dr
for 0.64 Mi

Legend

-  Addition
-  Deletion
-  Reassignment
-  SR
-  NC
-  US
-  Interstate
-  Ramp

