



STATE OF NORTH CAROLINA  
DEPARTMENT OF TRANSPORTATION

BEVERLY EAVES PERDUE  
GOVERNOR

Tuesday, September 11, 2012

EUGENE A. CONTI, JR.  
SECRETARY

**MEMORANDUM TO:** Mr. H. Allen Pope, PE  
Division Engineer  
Division 3

**FROM:** John C. Farley, Manager  
Geographic Information Systems Unit

**SUBJECT:** 2012 District 1 Road System Changes

The Data Conversion Group has been authorized to make the following changes to the state road system as indicated below. We request that you make similar changes to the related maps and files in your Division and District offices, and install appropriate road number signs if necessary. we have updated our records accordingly. If our system changes do not conform to the actual conditions in the field, please return this memorandum with recommendations.

PETITION	County	Approval Date
ONSLOW_2012_09_50074	ONSLOW	9/6/2012

Inquiries about changes should be referred to the GIS Help Desk at (919) 707-2152.  
Thank you for your assistance.

JCF

- cc: BSIP
- Bridge Maintenance
- Division Right of Way
- IMG
- Pavement Management
- Permit Unit
- State Road Maintenance
- Traffic Engineering
- Traffic Surveys

# 2012 ROAD SYSTEM CHANGES

<b>PETITION</b>	<b>COUNTY</b>	<b>APPROVAL DATE</b>	<b>ROUTE NUMBER</b>	<b>PORTION REASSIGNED</b>	<b>STREET NAME</b>	<b>LENGTH (miles)</b>	<b>TYPE OF CHANGE</b>	<b>REMARKS (See Attached Map)</b>
ONSLOW_2012_09_50074	ONSLOW	9/6/2012	SR 2453		FARMSTEAD PL	0.19	SYSTEM ADDITION VIA PETITION	
ONSLOW_2012_09_50074	ONSLOW	9/6/2012	SR 2452		MEADOWLAND CIRCLE	0.25	SYSTEM ADDITION VIA PETITION	
ONSLOW_2012_09_50074	ONSLOW	9/6/2012	SR 2451		WEDGEWOOD CIRCLE	0.27	SYSTEM ADDITION VIA PETITION	
ONSLOW_2012_09_50074	ONSLOW	9/6/2012	SR 2450		SOUTHWEST PLANTATION DR	1.14	SYSTEM ADDITION VIA PETITION	

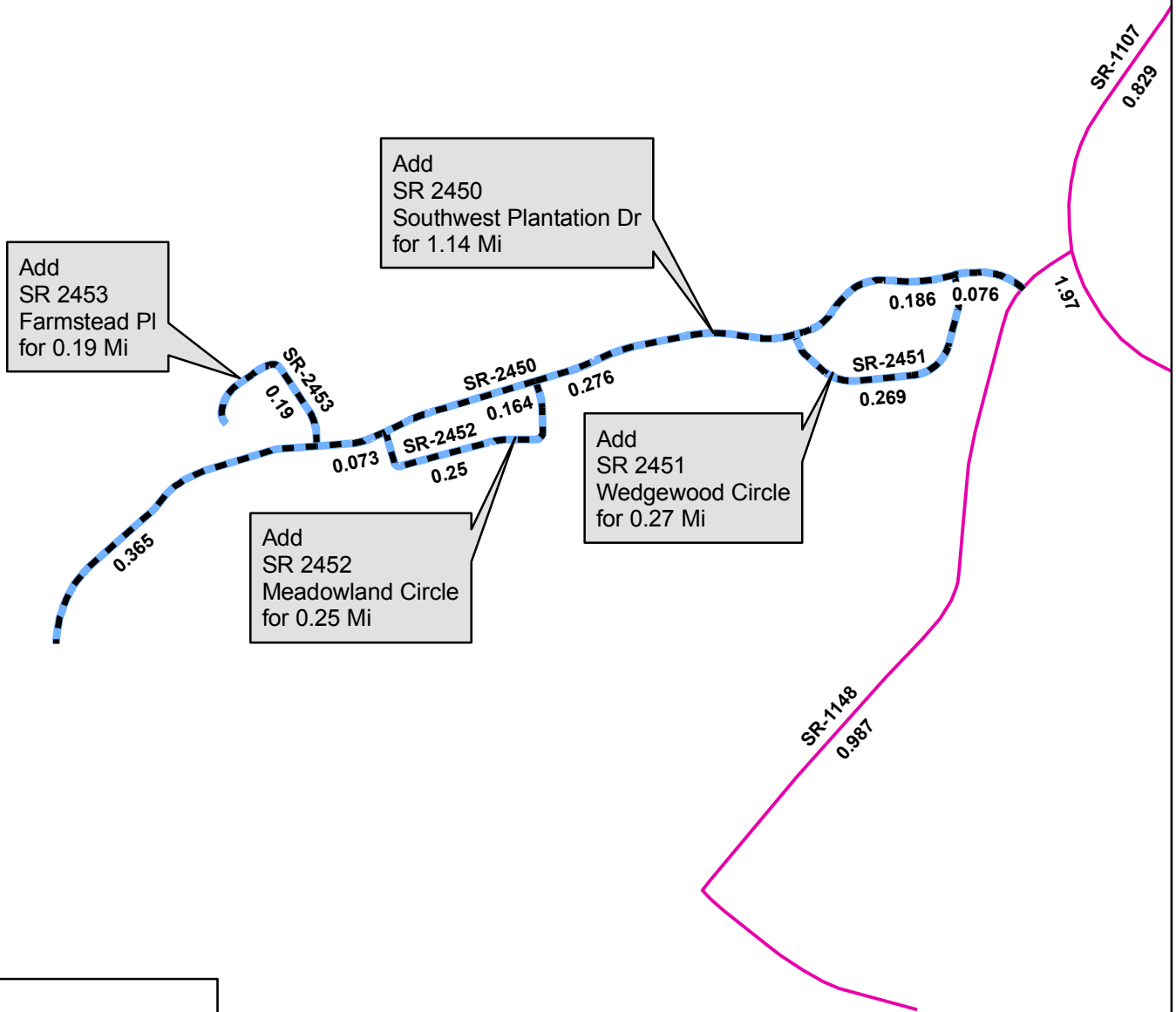

**Legend**

- Addition
- Deletion
- Reassignment
- SR
- NC
- US
- Interstate
- Ramp

