



STATE OF NORTH CAROLINA
DEPARTMENT OF TRANSPORTATION

BEVERLY EAVES PERDUE
GOVERNOR

Friday, July 20, 2012

EUGENE A. CONTI, JR.
SECRETARY

MEMORANDUM TO: Mr. H. Allen Pope, PE
Division Engineer
Division 3

FROM: John C. Farley, Manager
Geographic Information Systems Unit

SUBJECT: 2012 District 1 Road System Changes

The Data Conversion Group has been authorized to make the following changes to the state road system as indicated below. We request that you make similar changes to the related maps and files in your Division and District offices, and install appropriate road number signs if necessary. we have updated our records accordingly. If our system changes do not conform to the actual conditions in the field, please return this memorandum with recommendations.

PETITION	County	Approval Date
PENDER_2012_07_50037	PENDER	7/12/2012

Inquiries about changes should be referred to the GIS Help Desk at (919) 707-2152.
Thank you for your assistance.

JCF

- cc: BSIP
- Bridge Maintenance
- Division Right of Way
- IMG
- Pavement Management
- Permit Unit
- State Road Maintenance
- Traffic Engineering
- Traffic Surveys

2012 ROAD SYSTEM CHANGES

PETITION	COUNTY	APPROVAL DATE	ROUTE NUMBER	PORTION REASSIGNED	STREET NAME	LENGTH (miles)	TYPE OF CHANGE	REMARKS (See Attached Map)
PENDER_2012_07_50037	PENDER	7/12/2012	SR 1762		WEST WINDWARD LANDING PL	0.22	SYSTEM ADDITION VIA PETITION	
PENDER_2012_07_50037	PENDER	7/12/2012	SR 1761		FRAN'S PATH	0.08	SYSTEM ADDITION VIA PETITION	
PENDER_2012_07_50037	PENDER	7/12/2012	SR 1760		BATES RETREAT	0.21	SYSTEM ADDITION VIA PETITION	
PENDER_2012_07_50037	PENDER	7/12/2012	SR 1759		MIDDLE POINT RD	0.46	SYSTEM ADDITION VIA PETITION	

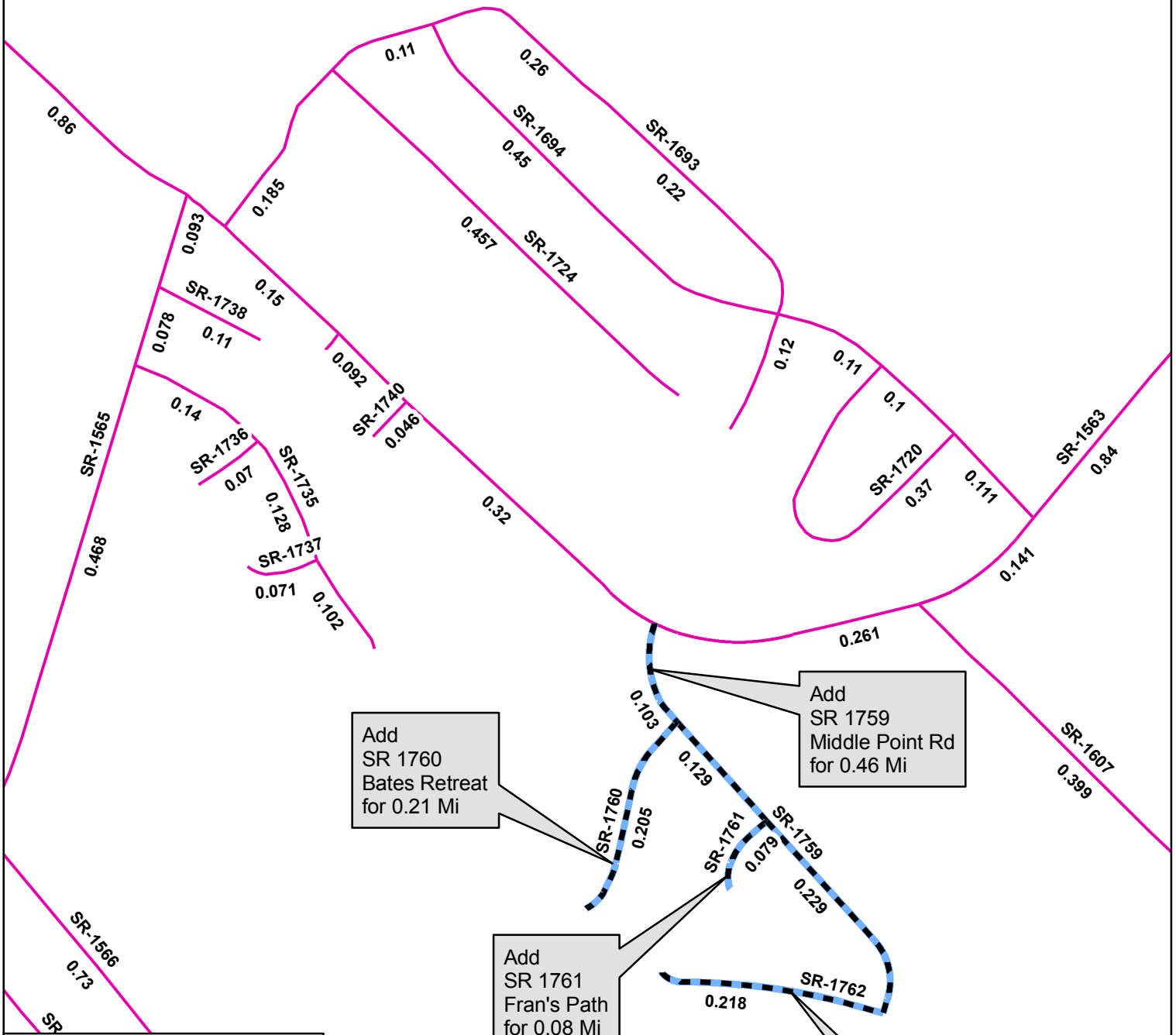







Add
SR 1760
Bates Retreat
for 0.21 Mi

Add
SR 1759
Middle Point Rd
for 0.46 Mi

Add
SR 1761
Fran's Path
for 0.08 Mi

Add
SR 1762
West Windward Landing PI
for 0.22 Mi

Legend

-  Addition
-  Deletion
-  Reassignment
-  SR
-  NC
-  US
-  Interstate
-  Ramp

