



STATE OF NORTH CAROLINA  
DEPARTMENT OF TRANSPORTATION

BEVERLY EAVES PERDUE  
GOVERNOR

Thursday, June 14, 2012

EUGENE A. CONTI, JR.  
SECRETARY

**MEMORANDUM TO:** Mr. Michael L. Holder, PE  
Division Engineer  
Division 12

**FROM:** John C. Farley, Manager  
Geographic Information Systems Unit

**SUBJECT:** 2012 District 2 Road System Changes

The Data Conversion Group has been authorized to make the following changes to the state road system as indicated below. We request that you make similar changes to the related maps and files in your Division and District offices, and install appropriate road number signs if necessary. we have updated our records accordingly. If our system changes do not conform to the actual conditions in the field, please return this memorandum with recommendations.

| PETITION              | County  | Approval Date |
|-----------------------|---------|---------------|
| IREDELL_2012_06_50023 | IREDELL | 6/7/2012      |

Inquiries about changes should be referred to the GIS Help Desk at (919) 707-2152.  
Thank you for your assistance.

JCF





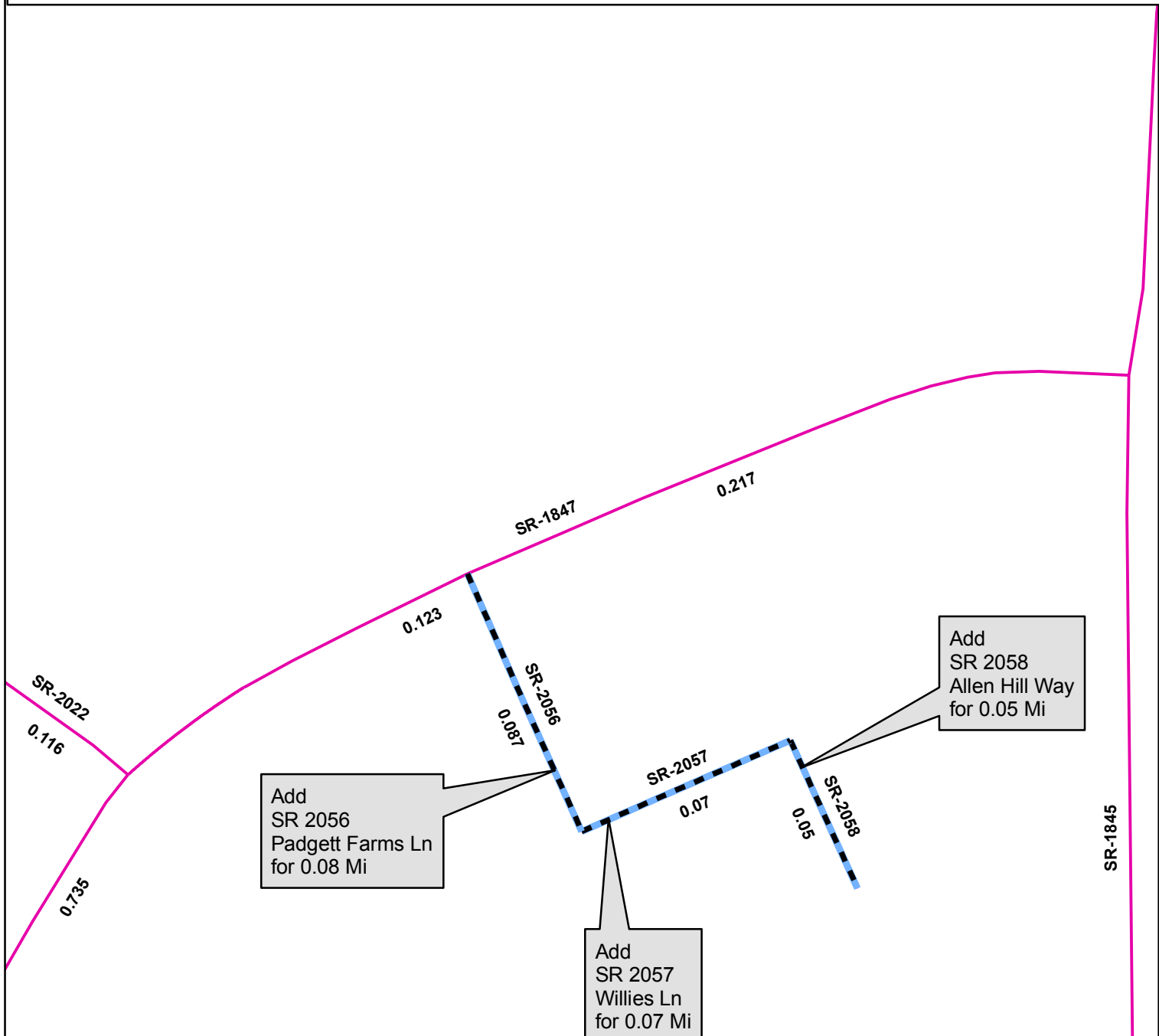

- cc: BSIP
- Bridge Maintenance
- Division Right of Way
- IMG
- Pavement Management
- Permit Unit
- State Road Maintenance
- Traffic Engineering
- Traffic Surveys

# 2012 ROAD SYSTEM CHANGES

| <b>PETITION</b>       | <b>COUNTY</b> | <b>APPROVAL<br/>DATE</b> | <b>ROUTE<br/>NUMBER</b> | <b>PORTION<br/>REASSIGNED</b> | <b>STREET<br/>NAME</b> | <b>LENGTH<br/>(miles)</b> | <b>TYPE OF CHANGE</b>              | <b>REMARKS<br/>(See Attached Map)</b> |
|-----------------------|---------------|--------------------------|-------------------------|-------------------------------|------------------------|---------------------------|------------------------------------|---------------------------------------|
| IREDELL_2012_06_50023 | IREDELL       | 6/7/2012                 | SR 2058                 |                               | ALLEN HILL WAY         | 0.05                      | SYSTEM ADDITION<br>VIA<br>PETITION |                                       |
| IREDELL_2012_06_50023 | IREDELL       | 6/7/2012                 | SR 2057                 |                               | WILLIES LN             | 0.07                      | SYSTEM ADDITION<br>VIA<br>PETITION |                                       |
| IREDELL_2012_06_50023 | IREDELL       | 6/7/2012                 | SR 2056                 |                               | PADGETT FARMS LN       | 0.08                      | SYSTEM ADDITION<br>VIA<br>PETITION |                                       |



**Legend**

-  Addition
-  Deletion
-  Reassignment
-  SR
-  NC
-  US
-  Interstate
-  Ramp

