



STATE OF NORTH CAROLINA  
DEPARTMENT OF TRANSPORTATION

BEVERLY EAVES PERDUE  
GOVERNOR

Tuesday, May 15, 2012

EUGENE A. CONTI, JR.  
SECRETARY

**MEMORANDUM TO:** Mr. Mike Mills, PE  
Division Engineer  
Division 7

**FROM:** John C. Farley, Manager  
Geographic Information Systems Unit

**SUBJECT:** 2012 District 2 Road System Changes

The Data Conversion Group has been authorized to make the following changes to the state road system as indicated below. We request that you make similar changes to the related maps and files in your Division and District offices, and install appropriate road number signs if necessary. we have updated our records accordingly. If our system changes do not conform to the actual conditions in the field, please return this memorandum with recommendations.

PETITION	County	Approval Date
GUILFORD_2012_05_49985	GUILFORD	5/3/2012

Inquiries about changes should be referred to the GIS Help Desk at (919) 707-2152.  
Thank you for your assistance.

JCF

- cc: BSIP
- Bridge Maintenance
- Division Right of Way
- IMG
- Pavement Management
- Permit Unit
- State Road Maintenance
- Traffic Engineering
- Traffic Surveys

---







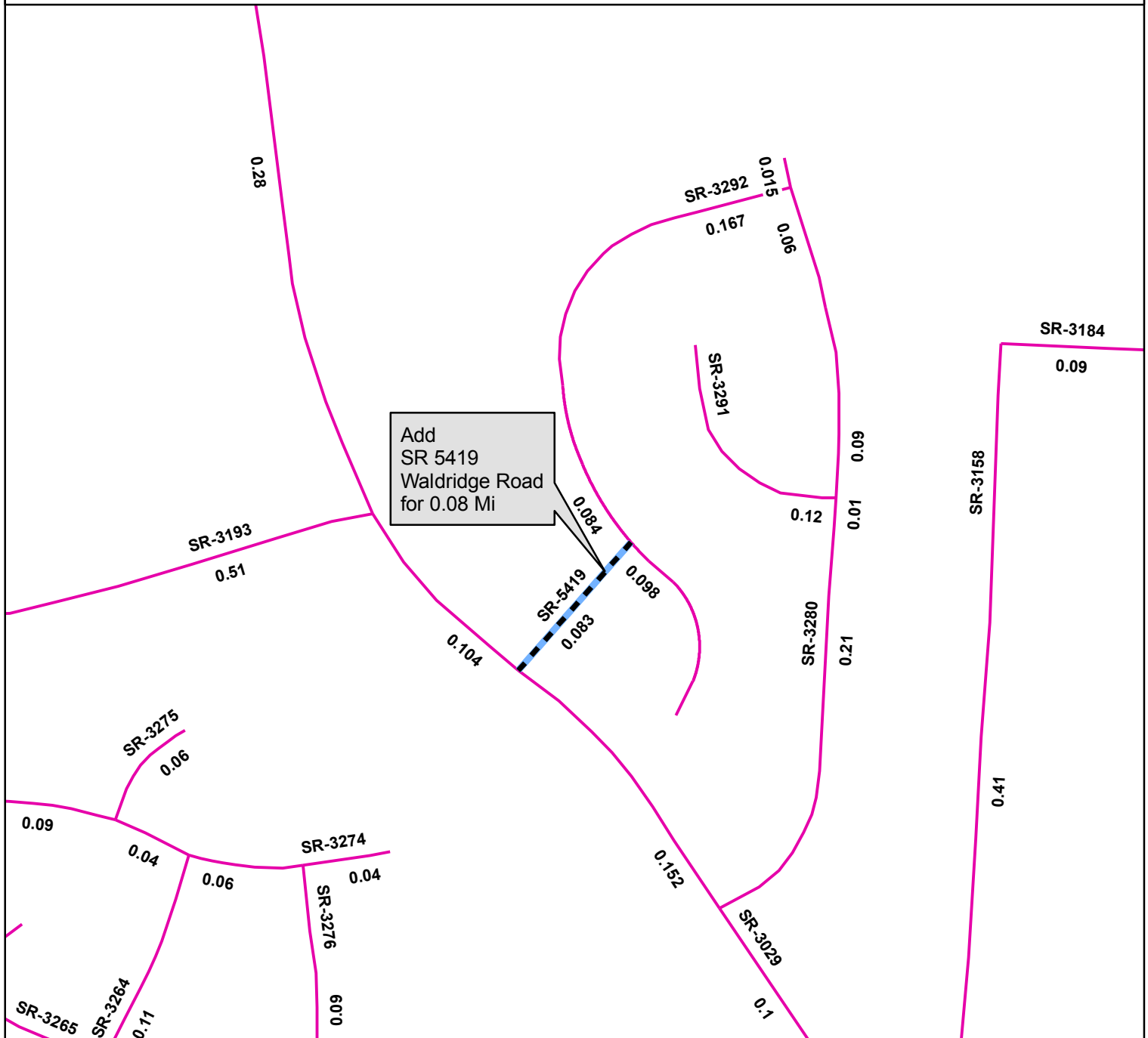

# 2012 ROAD SYSTEM CHANGES

---

<b>PETITION</b>	<b>COUNTY</b>	<b>APPROVAL DATE</b>	<b>ROUTE NUMBER</b>	<b>PORTION REASSIGNED</b>	<b>STREET NAME</b>	<b>LENGTH (miles)</b>	<b>TYPE OF CHANGE</b>	<b>REMARKS (See Attached Map)</b>
GUILFORD_2012_05_49985	GUILFORD	5/3/2012	SR 5419		WALDRIDGE RD	0.08	SYSTEM ADDITION VIA PETITION	



**Legend**

-  Addition
-  Deletion
-  Reassignment
-  SR
-  NC
-  US
-  Interstate
-  Ramp

