



STATE OF NORTH CAROLINA  
DEPARTMENT OF TRANSPORTATION

BEVERLY EAVES PERDUE  
GOVERNOR

Wednesday, April 25, 2012

EUGENE A. CONTI, JR.  
SECRETARY

**MEMORANDUM TO:** Mr. Barry Moose, PE  
Division Engineer  
Division 10

**FROM:** John C. Farley, Manager  
Geographic Information Systems Unit

**SUBJECT:** 2012 District 3 Road Sytem Changes

The Data Conversion Group has been authorized to make the following changes to the state road system as indicated below. We request that you make similar changes to the related maps and files in your Division and District offices, and install appropriate road number signs if necessary. we have updated our records accordingly. If our system changes do not conform to the actual conditions in the field, please return this memorandum with recommendations.

Correction Number	County	Approval Date
COR_89_04-12_1	UNION	4/5/2012

Inquiries about changes should be referred to the GIS Help Desk at (919) 707-2152.  
Thank you for your assistance.

JCF

- cc: BSIP
- Bridge Maintenance
- Division Right of Way
- IMG
- Pavement Management
- Permit Unit
- State Road Maintenance
- Traffic Engineering
- Traffic Surveys







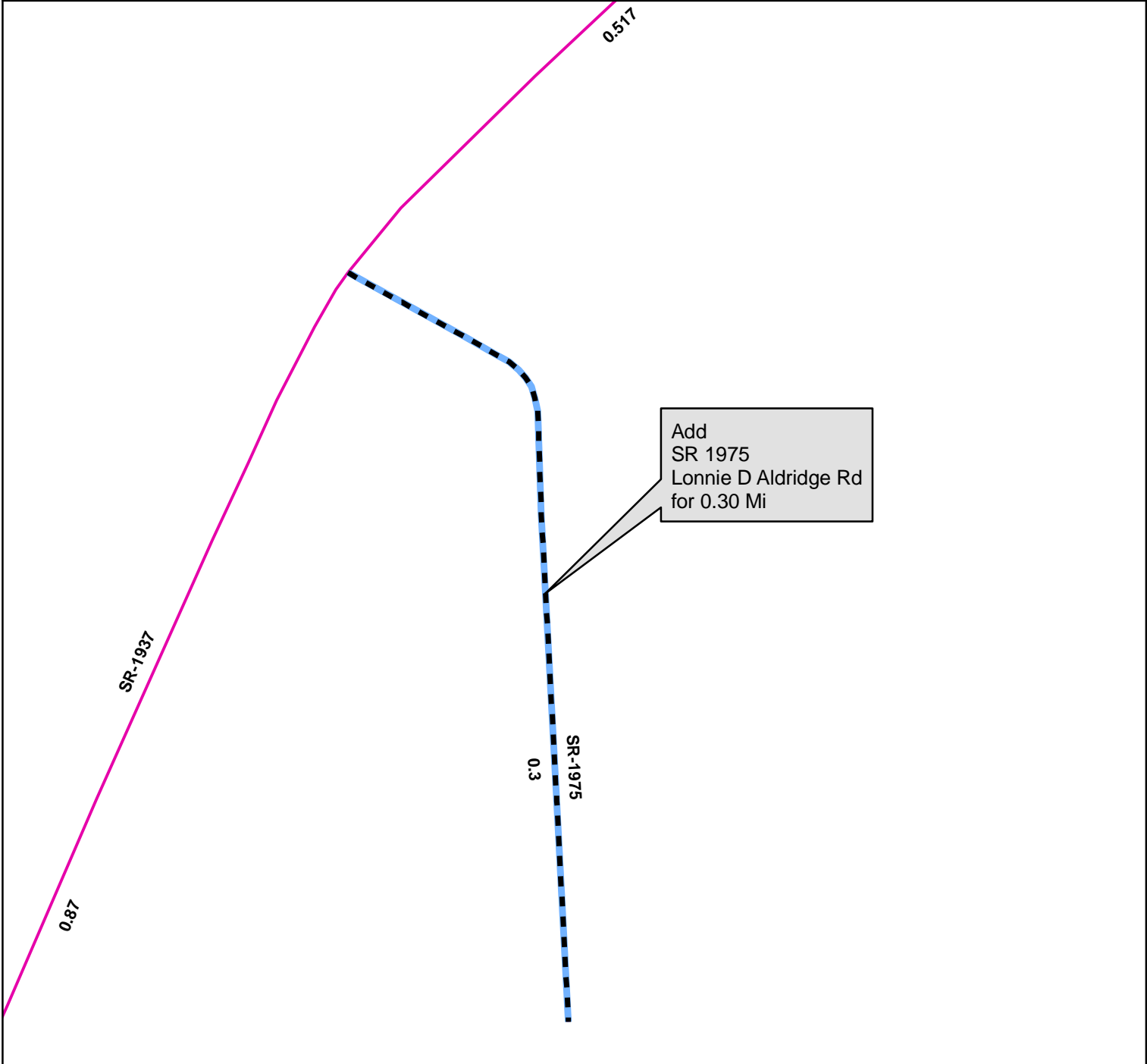

# 2012 ROAD SYSTEM CHANGES

<b>CORRECTION REQUEST</b>	<b>COUNTY</b>	<b>APPROVAL DATE</b>	<b>NEW ROUTE</b>	<b>EXISTING ROUTE</b>	<b>STREET NAME</b>	<b>LENGTH (miles)</b>	<b>TYPE OF CHANGE</b>	<b>REMARKS (See Attached Map)</b>
COR_89_04-12_1	UNION	4/5/2012		SR 1975	LONNIE D ALDRIDGE RD	0.30	SYSTEM ADDITION - EXISTING VIA CORRECTION REQUEST	MAP A, SEGMENT
COR_89_04-12_1	UNION	4/5/2012		SR 3228	ALDRIDGE CT	0.06	SYSTEM DELETION VIA CORRECTION REQUEST	MAP B, SEGMENT

Map: A



**Legend**





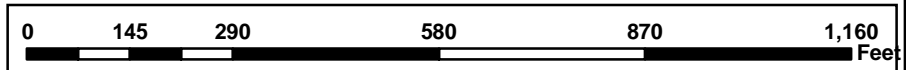

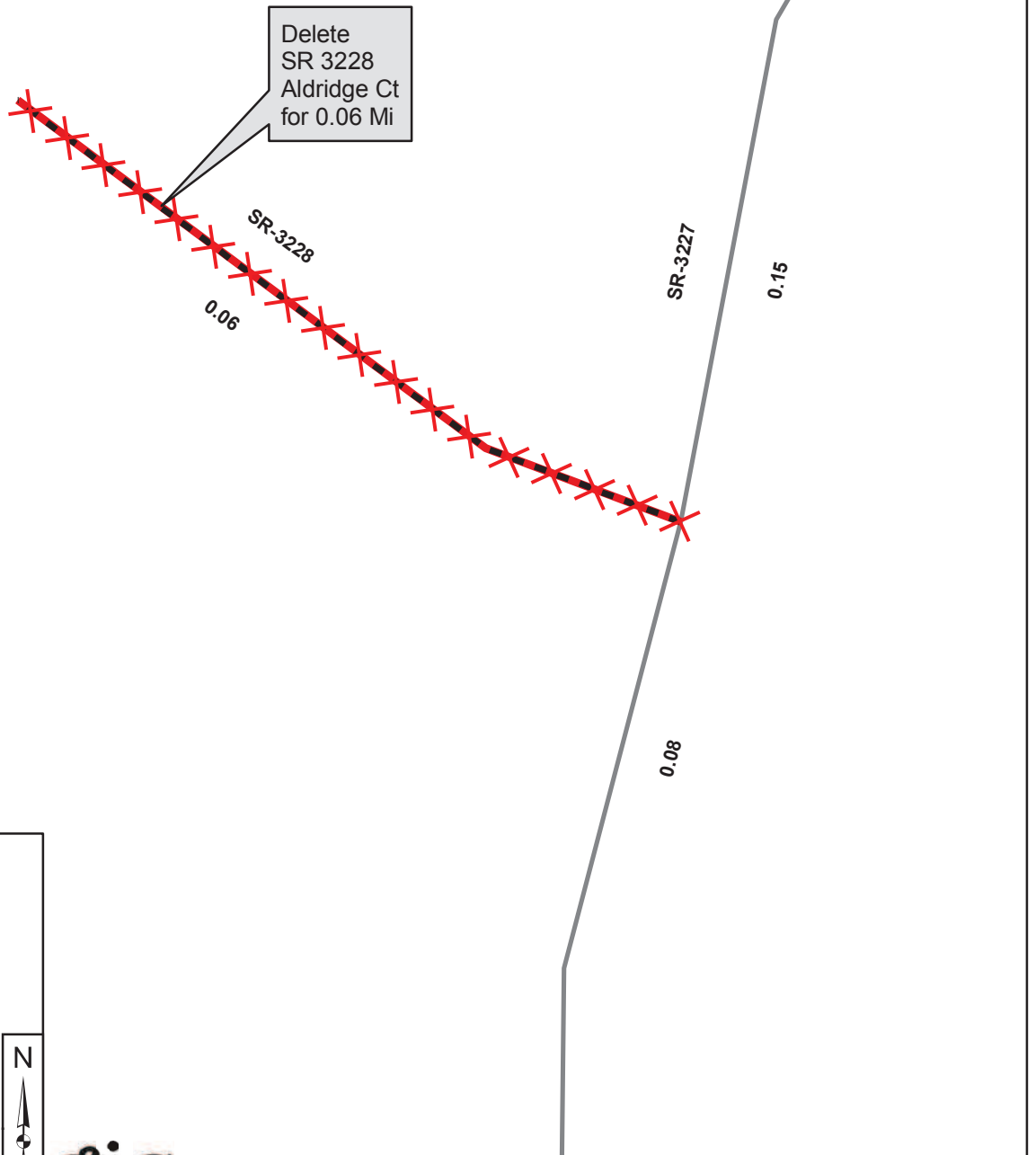
-  Addition
-  Deletion
-  Reassignment
-  SR
-  NC
-  US
-  Interstate
-  Ramp

N  
↑





**Legend**

-  Addition
-  Deletion
-  Reassignment
-  SR
-  NC
-  US
-  Interstate
-  Ramp

