



STATE OF NORTH CAROLINA
DEPARTMENT OF TRANSPORTATION

BEVERLY EAVES PERDUE
GOVERNOR

Tuesday, April 24, 2012

EUGENE A. CONTI, JR.
SECRETARY

MEMORANDUM TO: Mr. J. Wally Bowman, PE
Division Engineer
Division 5

FROM: John C. Farley, Manager
Geographic Information Systems Unit

SUBJECT: 2012 District 2 Road System Changes

The Data Conversion Group has been authorized to make the following changes to the state road system as indicated below. We request that you make similar changes to the related maps and files in your Division and District offices, and install appropriate road number signs if necessary. we have updated our records accordingly. If our system changes do not conform to the actual conditions in the field, please return this memorandum with recommendations.

PETITION	County	Approval Date
49954	GRANVILLE	4/5/2012

Inquiries about changes should be referred to the GIS Help Desk at (919) 707-2152.
Thank you for your assistance.

JCF

- cc: BSIP
- Bridge Maintenance
- Division Right of Way
- IMG
- Pavement Management
- Permit Unit
- State Road Maintenance
- Traffic Engineering
- Traffic Surveys

2012 ROAD SYSTEM CHANGES

PETITION	COUNTY	APPROVAL DATE	ROUTE NUMBER	PORTION REASSIGNED	STREET NAME	LENGTH (miles)	TYPE OF CHANGE	REMARKS (See Attached Map)
49954	GRANVILLE	4/5/2012	SR 1808		JASMINE CT	0.13	SYSTEM ADDITION VIA PETITION	
49954	GRANVILLE	4/5/2012	SR 1807		WISTERIA CT	0.11	SYSTEM ADDITION VIA PETITION	
49954	GRANVILLE	4/5/2012	SR 1755		WOODLAND CHURCH RD EXT	0.20	SYSTEM ADDITION VIA PETITION	

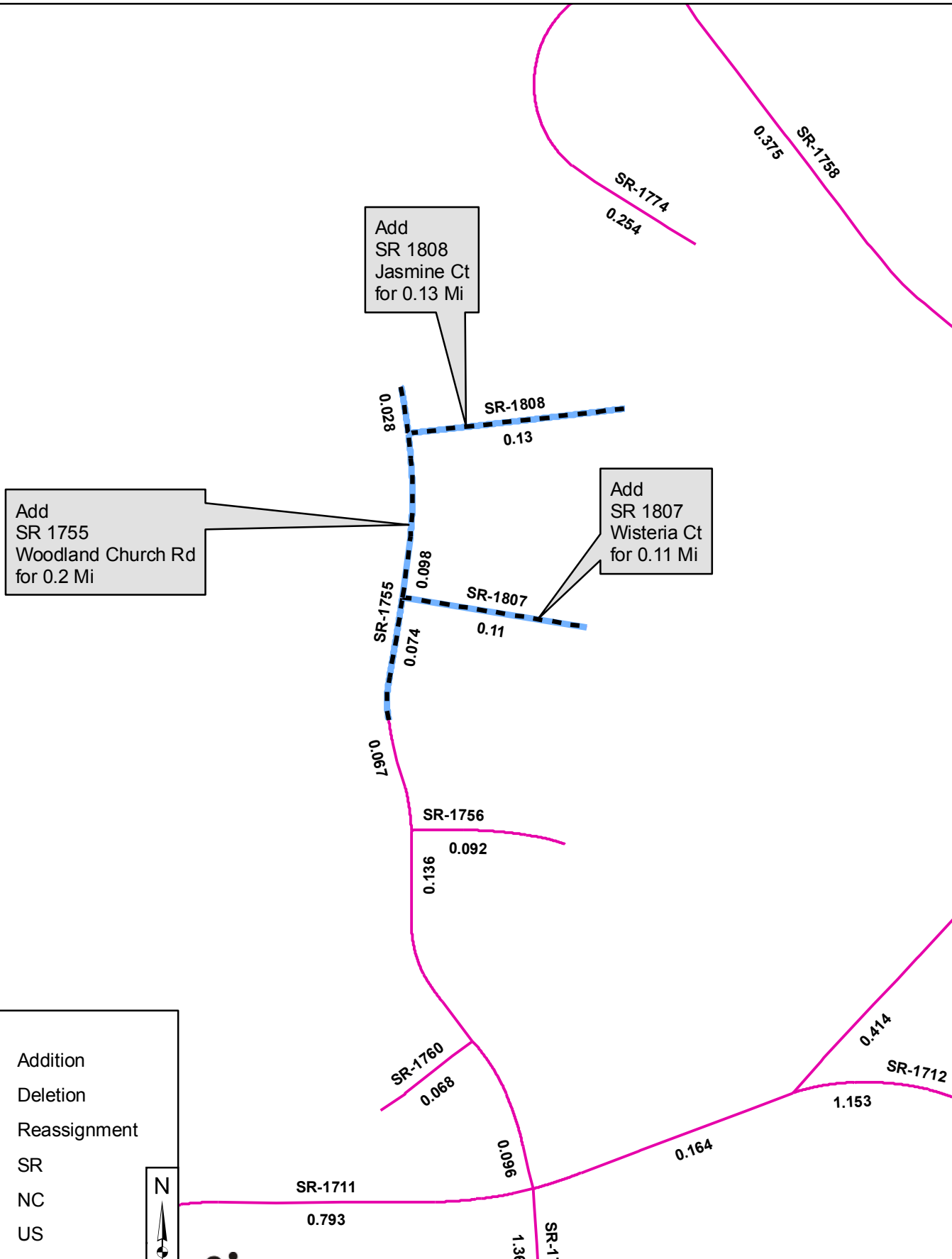

Add
SR 1808
Jasmine Ct
for 0.13 Mi

Add
SR 1755
Woodland Church Rd
for 0.2 Mi

Add
SR 1807
Wisteria Ct
for 0.11 Mi

Legend

-  Addition
-  Deletion
-  Reassignment
-  SR
-  NC
-  US
-  Interstate
-  Ramp

