



STATE OF NORTH CAROLINA
DEPARTMENT OF TRANSPORTATION

BEVERLY EAVES PERDUE
GOVERNOR

Thursday, June 07, 2012

EUGENE A. CONTI, JR.
SECRETARY

MEMORANDUM TO: Mr. J. Wally Bowman, PE
Division Engineer
Division 5

FROM: John C. Farley, Manager
Geographic Information Systems Unit

SUBJECT: 2012 District 1 Road System Changes **-REVISED**

The Data Conversion Group has been authorized to make the following changes to the state road system as indicated below. We request that you make similar changes to the related maps and files in your Division and District offices, and install appropriate road number signs if necessary. we have updated our records accordingly. If our system changes do not conform to the actual conditions in the field, please return this memorandum with recommendations.

PETITION	County	Approval Date
49931	WAKE	3/8/2012

Inquiries about changes should be referred to the GIS Help Desk at (919) 707-2152.
Thank you for your assistance.

JCF

- cc: BSIP
- Bridge Maintenance
- Division Right of Way
- IMG
- Pavement Management
- Permit Unit
- State Road Maintenance
- Traffic Engineering
- Traffic Surveys

2012 ROAD SYSTEM CHANGES

PETITION	COUNTY	APPROVAL DATE	ROUTE NUMBER	PORTION REASSIGNED	STREET NAME	LENGTH (miles)	TYPE OF CHANGE	REMARKS (See Attached Map)
49931	WAKE	3/8/2012	SR 1617	SR 3128		0.48	NUMBER REASSIGNMENT VIA PETITION	MAP C, SEGMENT
49931	WAKE	3/8/2012	SR 3127		MCCRIMMON PKWY	1.32	SYSTEM ADDITION VIA PETITION	MAP B, SEGMENT
49931	WAKE	3/8/2012	SR 3126		AIRPORT BLVD	0.64	SYSTEM ADDITION VIA PETITION	MAP A, SEGMENT
49931	WAKE	3/8/2012	SR 3060		MORRISVILLE PKWY EXT	1.45	SYSTEM ADDITION VIA PETITION	MAP C, SEGMENT
49931	WAKE	3/8/2012	SR 1617			0.01	SYSTEM DELETION VIA PETITION	MAP C, SEGMENT

Map A

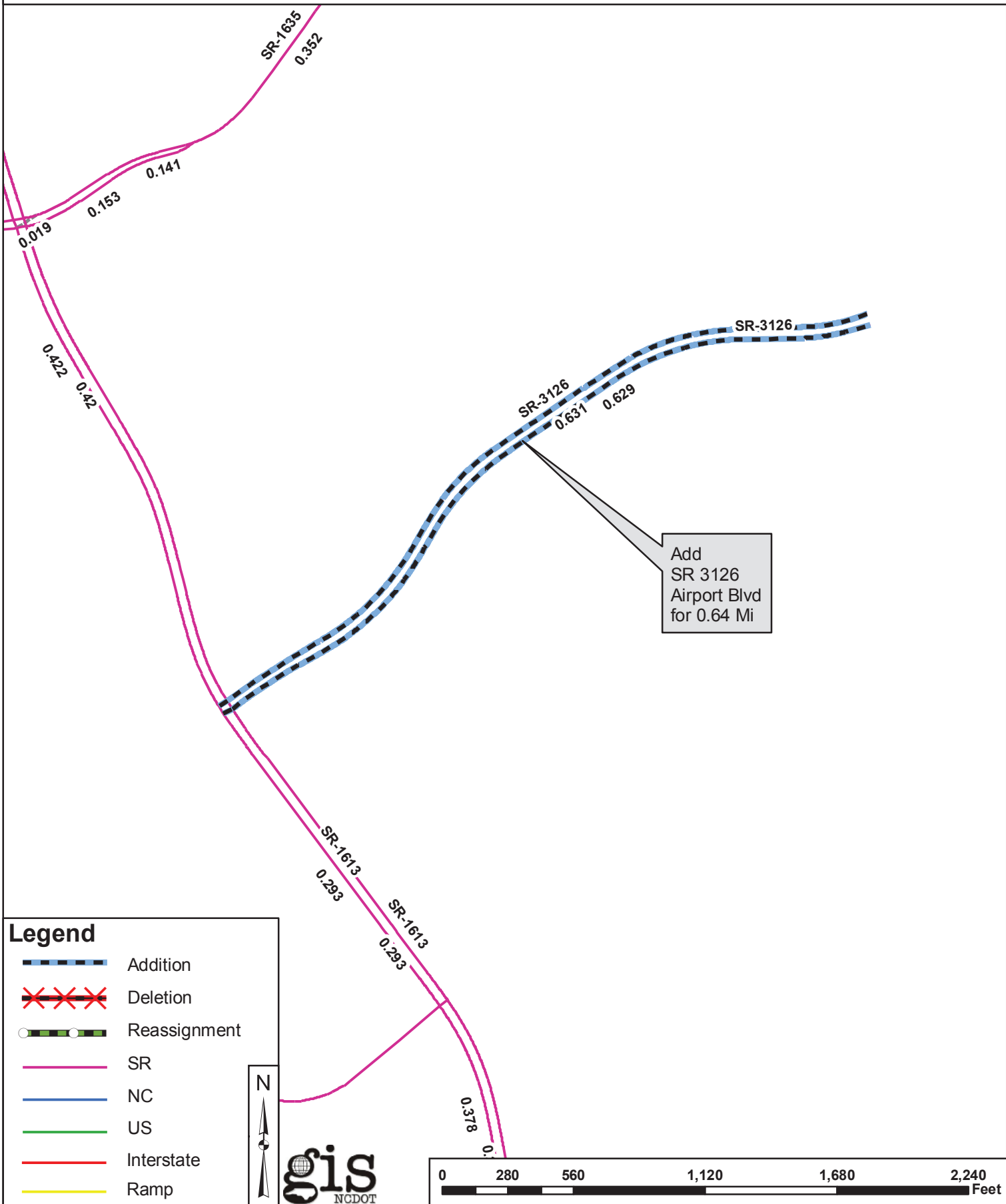

Map B

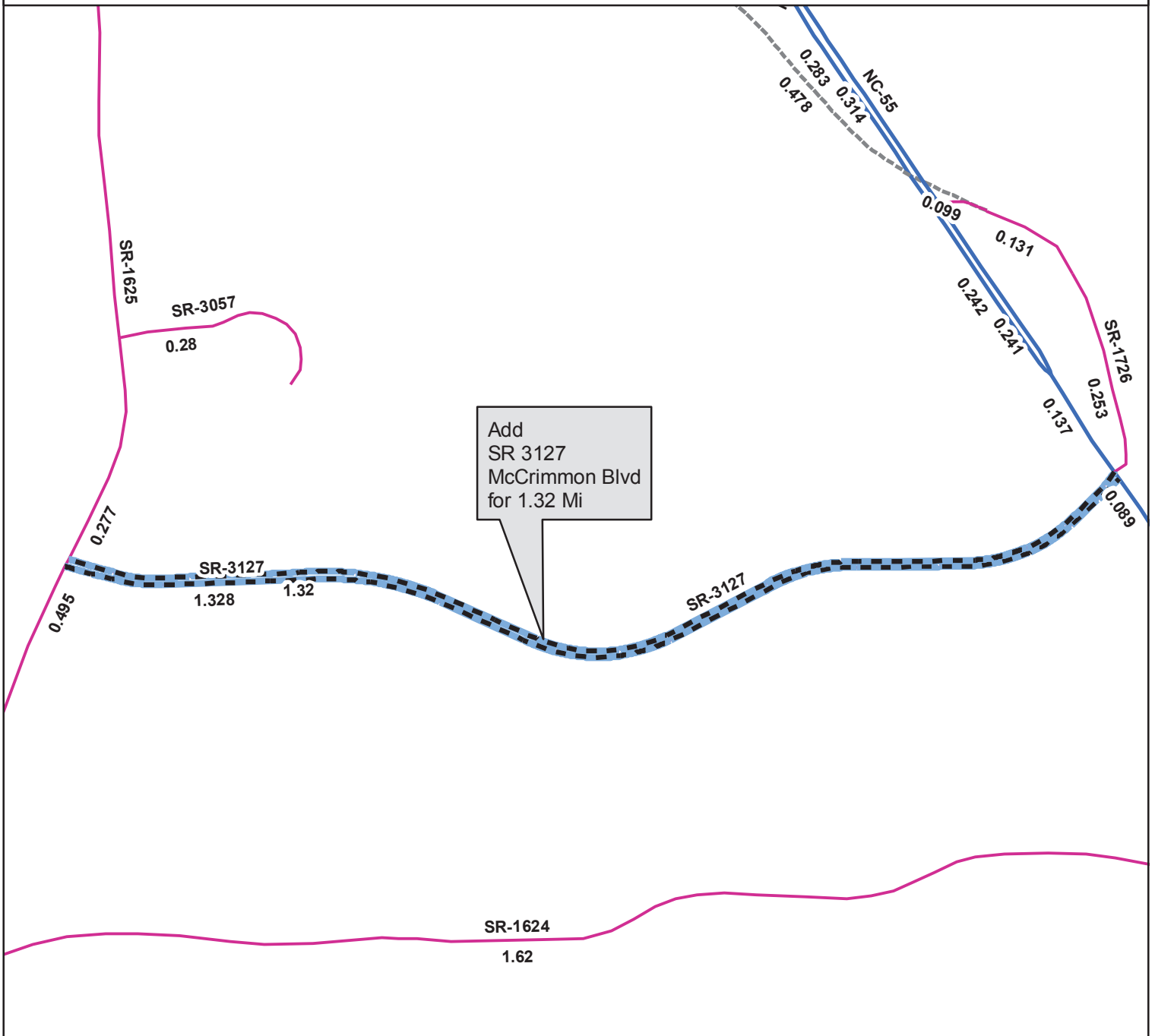

Add
SR 3127
McCrimmon Blvd
for 1.32 Mi

Legend

- Addition
- Deletion
- Reassignment
- SR
- NC
- US
- Interstate
- Ramp

N



Map C

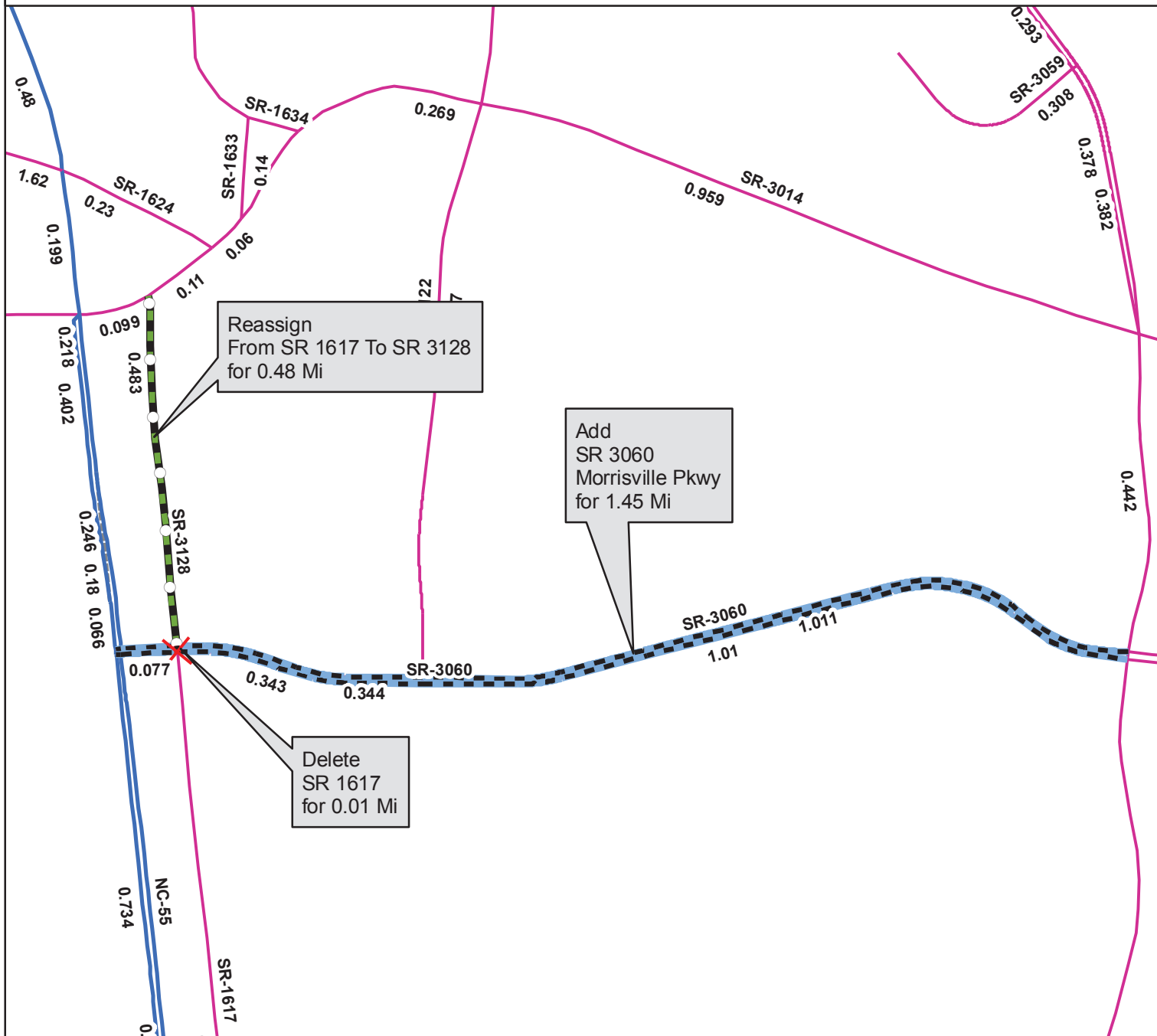









Reassign
From SR 1617 To SR 3128
for 0.48 Mi

Add
SR 3060
Morrisville Pkwy
for 1.45 Mi

Delete
SR 1617
for 0.01 Mi

Legend

-  Addition
-  Deletion
-  Reassignment
-  SR
-  NC
-  US
-  Interstate
-  Ramp

