



STATE OF NORTH CAROLINA  
DEPARTMENT OF TRANSPORTATION

BEVERLY EAVES PERDUE  
GOVERNOR

Monday, January 23, 2012

EUGENE A. CONTI, JR.  
SECRETARY

**MEMORANDUM TO:** Mr. H. Allen Pope, PE  
Division Engineer  
Division 3

**FROM:** John C. Farley, Manager  
Geographic Information Systems Unit

**SUBJECT:** 2012 District 1 Road System Changes

The Data Conversion Group has been authorized to make the following changes to the state road system as indicated below. We request that you make similar changes to the related maps and files in your Division and District offices, and install appropriate road number signs if necessary. we have updated our records accordingly. If our system changes do not conform to the actual conditions in the field, please return this memorandum with recommendations.

PETITION	County	Approval Date
49895	ONSLow	1/5/2012

Inquiries about changes should be referred to the GIS Help Desk at (919) 707-2152.  
Thank you for your assistance.

JCF

- cc: BSIP  
Bridge Maintenance  
Division Right of Way  
IMG  
Pavement Management  
Permit Unit  
State Road Maintenance  
Traffic Engineering  
Traffic Surveys

---

# 2012 ROAD SYSTEM CHANGES

---



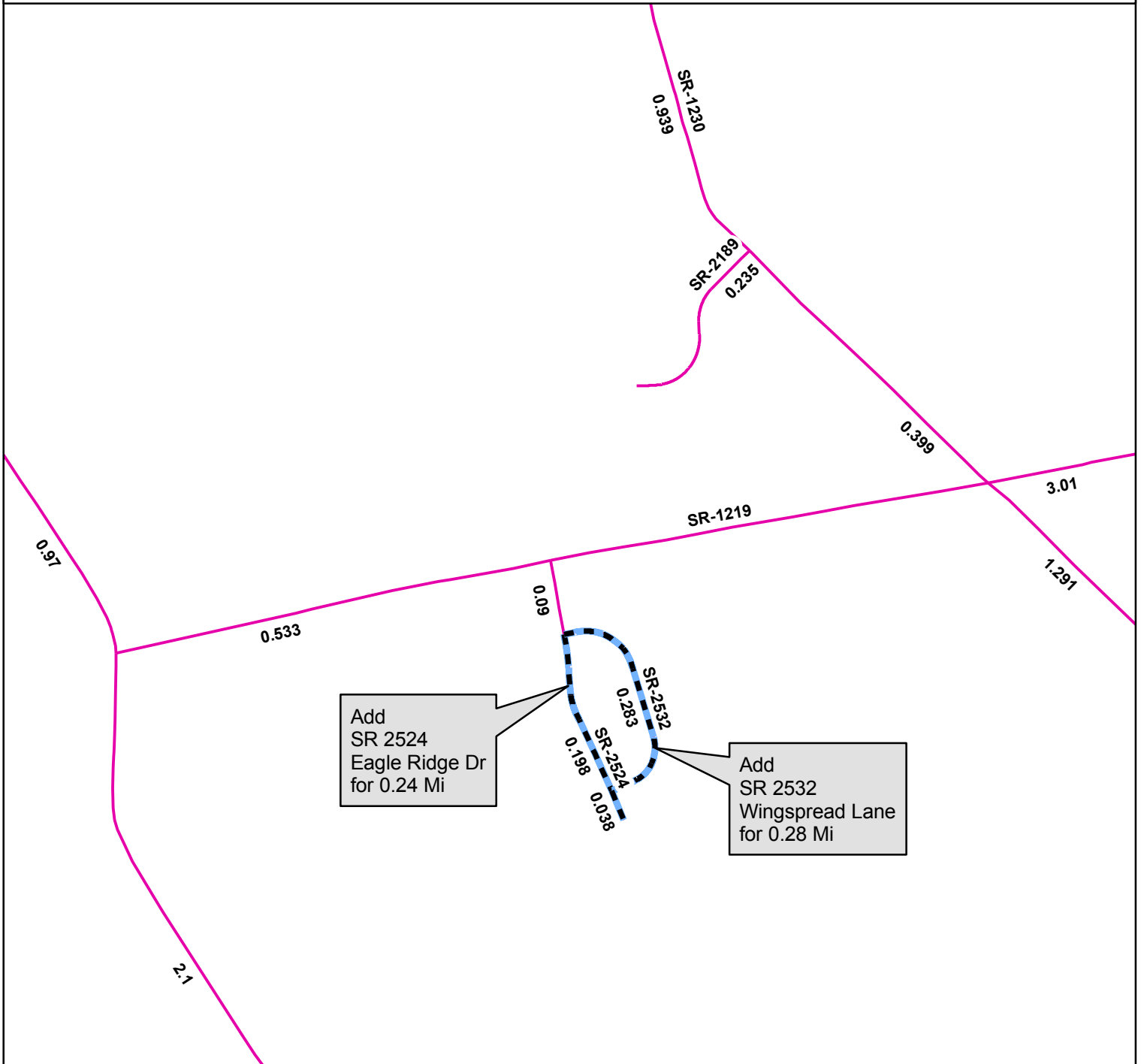





<b>PETITION</b>	<b>COUNTY</b>	<b>APPROVAL DATE</b>	<b>ROUTE NUMBER</b>	<b>PORTION REASSIGNED</b>	<b>STREET NAME</b>	<b>LENGTH (miles)</b>	<b>TYPE OF CHANGE</b>	<b>REMARKS (See Attached Map)</b>
49895	ONSLOW	1/5/2012	SR 2532		WINGSPREAD LANE	0.28	SYSTEM ADDITION VIA PETITION	
49895	ONSLOW	1/5/2012	SR 2524		EAGLE RIDGE EXT	0.24	SYSTEM ADDITION VIA PETITION	



Add  
SR 2524  
Eagle Ridge Dr  
for 0.24 Mi

Add  
SR 2532  
Wingspread Lane  
for 0.28 Mi

**Legend**

-  Addition
-  Deletion
-  Reassignment
-  SR
-  NC
-  US
-  Interstate
-  Ramp



SR-1218

