



STATE OF NORTH CAROLINA
DEPARTMENT OF TRANSPORTATION

BEVERLY EAVES PERDUE
GOVERNOR

Monday, January 23, 2012

EUGENE A. CONTI, JR.
SECRETARY

MEMORANDUM TO: Mr. J.D. Jennings, PE (acting)
Division Engineer
Division 1

FROM: John C. Farley, Manager
Geographic Information Systems Unit

SUBJECT: 2012 District 1 Road System Changes

The Data Conversion Group has been authorized to make the following changes to the state road system as indicated below. We request that you make similar changes to the related maps and files in your Division and District offices, and install appropriate road number signs if necessary. we have updated our records accordingly. If our system changes do not conform to the actual conditions in the field, please return this memorandum with recommendations.

PETITION	County	Approval Date
49892	CAMDEN	1/5/2012

Inquiries about changes should be referred to the GIS Help Desk at (919) 707-2152.
Thank you for your assistance.

JCF

- cc: BSIP
- Bridge Maintenance
- Division Right of Way
- IMG
- Pavement Management
- Permit Unit
- State Road Maintenance
- Traffic Engineering
- Traffic Surveys

MAILING ADDRESS:
NC DEPARTMENT OF TRANSPORTATION
GEOGRAPHIC INFORMATION SYSTEMS
1521 MAIL SERVICE CENTER
RALEIGH NC 27699-1521



Delivery Address:
41 01 CAPITAL BLVD.
RALEIGH, NC 27604
PHONE: (919) 707-2152
FAX: (919) 707-2214

2012 ROAD SYSTEM CHANGES



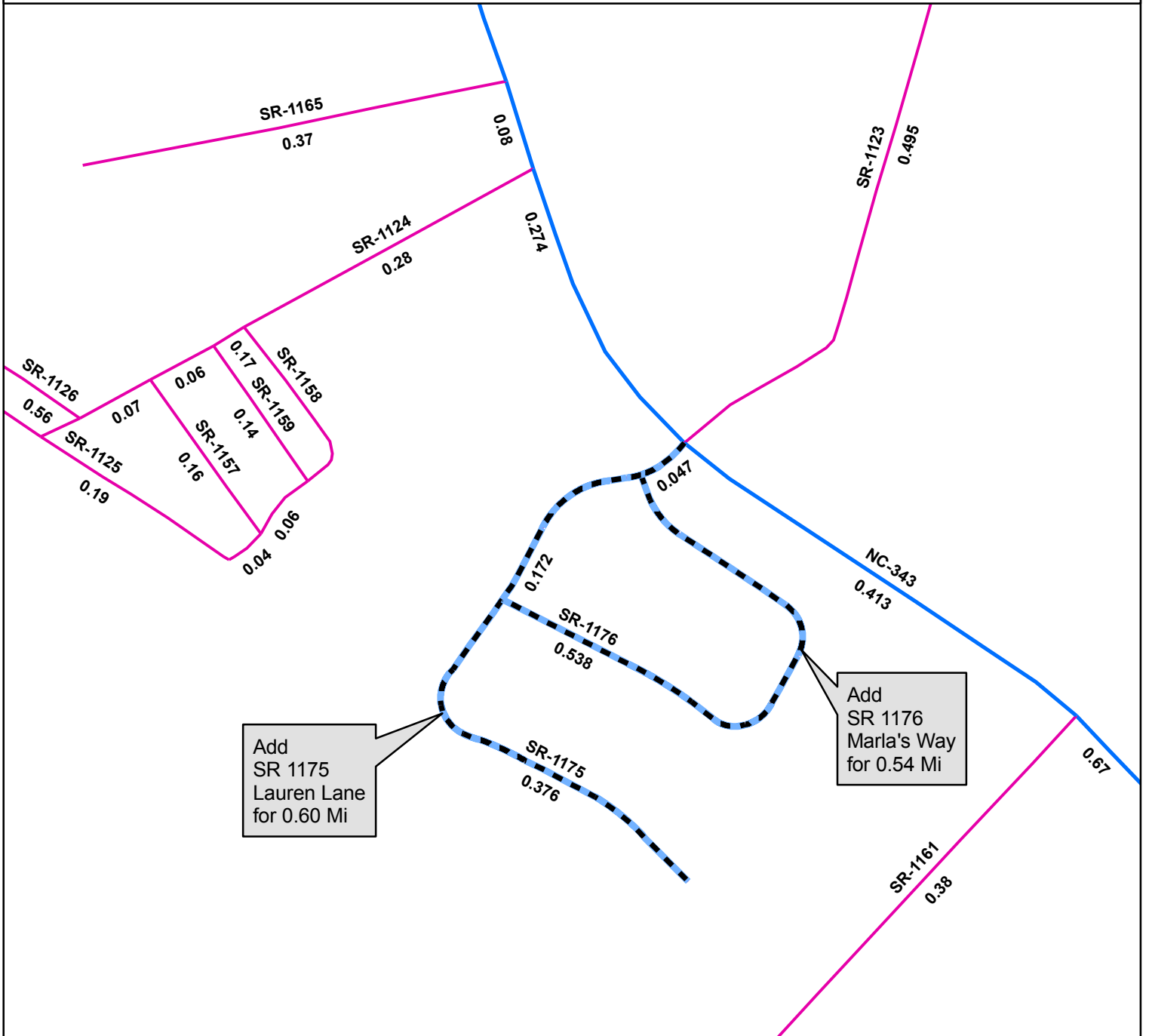

PETITION	COUNTY	APPROVAL DATE	ROUTE NUMBER	PORTION REASSIGNED	STREET NAME	LENGTH (miles)	TYPE OF CHANGE	REMARKS (See Attached Map)
49892	CAMDEN	1/5/2012	SR 1176		MARLA'S WAY	0.54	SYSTEM ADDITION VIA PETITION	
49892	CAMDEN	1/5/2012	SR 1175		LAUREN LANE	0.60	SYSTEM ADDITION VIA PETITION	



Add
SR 1175
Lauren Lane
for 0.60 Mi

Add
SR 1176
Marla's Way
for 0.54 Mi

Legend

-  Addition
-  Deletion
-  Reassignment
-  SR
-  NC
-  US
-  Interstate
-  Ramp

