



STATE OF NORTH CAROLINA
DEPARTMENT OF TRANSPORTATION

BEVERLY EAVES PERDUE
GOVERNOR

Monday, February 13, 2012

EUGENE A. CONTI, JR.
SECRETARY

MEMORANDUM TO: Mr. Michael A. Pettyjohn, PE
Division Engineer
Division 11

FROM: John C. Farley, Manager
Geographic Information Systems Unit

SUBJECT: 2012 District 1 Road System Changes

The Data Conversion Group has been authorized to make the following changes to the state road system as indicated below. We request that you make similar changes to the related maps and files in your Division and District offices, and install appropriate road number signs if necessary. We have updated our records accordingly. If our system changes do not conform to the actual conditions in the field, please return this memorandum with recommendations.

Document Number	County	Approval Date
B-4820_85	SURRY	12/31/2011

Inquiries about changes should be referred to the GIS Help Desk at (919) 707-2152.
Thank you for your assistance.

JCF

cc: BSIP
Bridge Maintenance
Division Right of Way
IMG
Pavement Management
Permit Unit
State Road Maintenance
Traffic Engineering
Traffic Surveys

2012 ROAD SYSTEM CHANGES

TIP	COUNTY	APPROVAL DATE	NEW ROUTE	EXISTING ROUTE	STREET NAME	LENGTH (miles)	TYPE OF CHANGE	REMARKS (See Attached Map)
B-4820_85	SURRY	12/31/2011		SR 1190	GWYN AVE	0.25	SYSTEM DELETION VIA TIP	MAP , SEGMENT

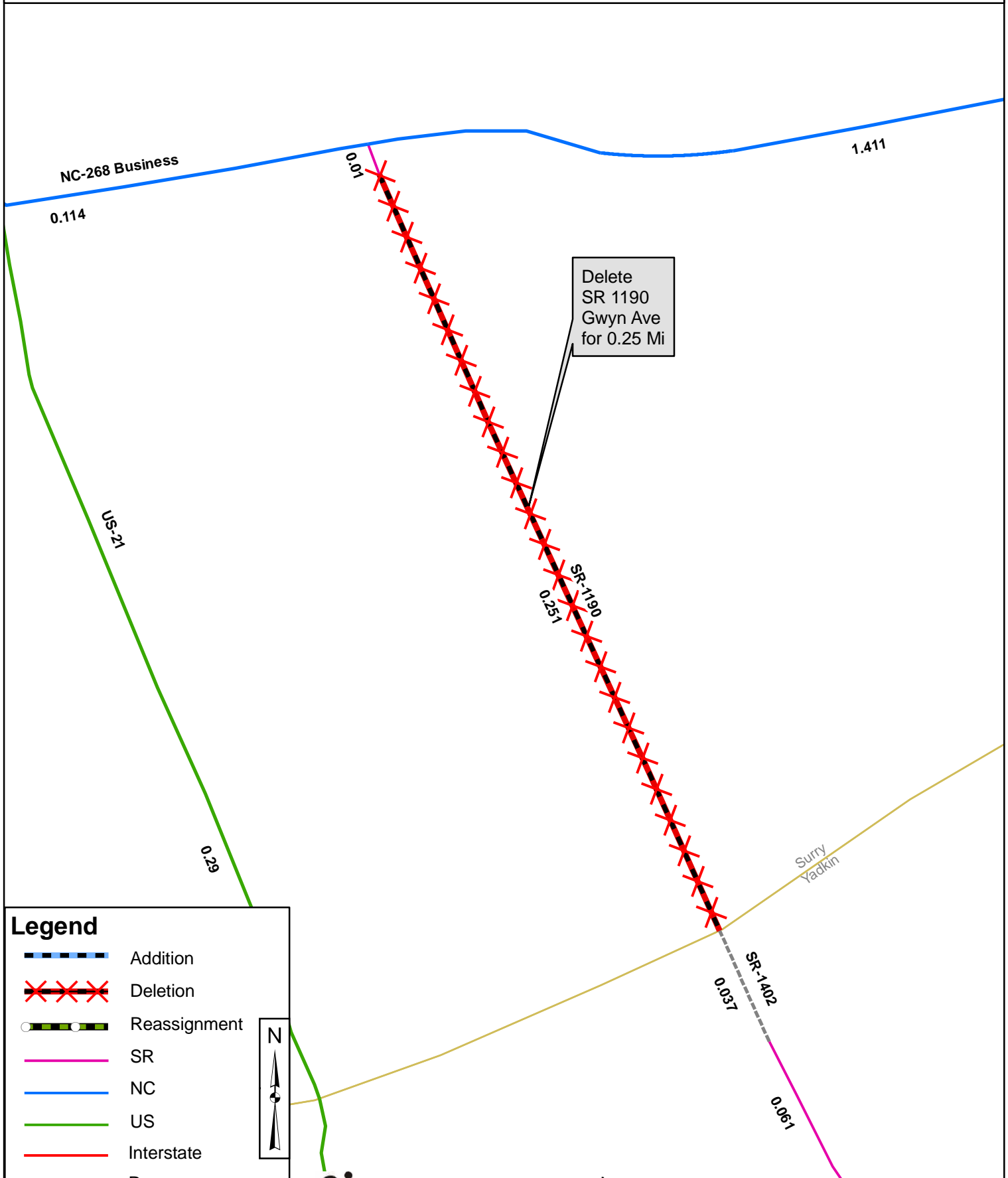

Delete
SR 1190
Gwyn Ave
for 0.25 Mi

Legend

- Addition
- Deletion
- Reassignment
- SR
- NC
- US
- Interstate
- Ramp
- County Boundary

