



STATE OF NORTH CAROLINA  
DEPARTMENT OF TRANSPORTATION

PATRICK MCCRORY  
GOVERNOR

Tuesday, April 22, 2014

ANTHONY TATA  
SECRETARY

**MEMORANDUM TO:** Mr. Louis Mitchell, PE  
Division Engineer  
Division 10

**FROM:** John C. Farley, Manager  
Geographic Information Systems Unit

**SUBJECT:** 2014 District 2 Road System Changes

The Data Conversion Group has been authorized to make the following changes to the state road system as indicated below. We request that you make similar changes to the related maps and files in your Division and District offices, and install appropriate road number signs if necessary. We have updated our records accordingly. If our system changes do not conform to the actual conditions in the field, please return this memorandum with recommendations.

LRS Change	County	Approval Date
LRS_6802_04-14	MECKLENBURG	9/1/2011

Inquiries about changes should be referred to the GIS Help Desk at (919) 707-2152.  
Thank you for your assistance.

JCF

- cc: BSIP
- Bridge Maintenance
- Division Right of Way
- IMG
- Pavement Management
- Permit Unit
- State Road Maintenance
- Traffic Engineering
- Traffic Surveys

**MAILING ADDRESS:**  
NC DEPARTMENT OF TRANSPORTATION  
GEOGRAPHIC INFORMATION SYSTEMS  
1521 MAIL SERVICE CENTER  
RALEIGH, NC 27699-1521



**DELIVERY ADDRESS:**  
4101 CAPITAL BLVD.  
RALEIGH, NC 27604  
PHONE: (919) 707-2152  
FAX: (919) 707-2214

# 2014 ROAD SYSTEM CHANGES

LRS	COUNTY	APPROVAL DATE	NEW ROUTE	EXISTING ROUTE	STREET NAME	LENGTH (miles)	TYPE OF CHANGE	REMARKS (See Attached M:
LRS_6802_04-14	MECKLENBURG	9/1/2011		SR 2667		0.06	SYSTEM ADDITION - EXISTING VIA LRS CHANGE	MAP , SEGMENT
LRS_6802_04-14	MECKLENBURG	9/1/2011		SR 2458	EVERETTE KEITH RD	0.04	SYSTEM ADDITION - EXISTING VIA LRS CHANGE	MAP , SEGMENT
LRS_6802_04-14	MECKLENBURG	9/1/2011		SR 2667		0.05	SYSTEM DELETION VIA LRS CHANGE	MAP , SEGMENT
LRS_6802_04-14	MECKLENBURG	9/1/2011		SR 2458	EVERETTE KEITH RD	0.04	SYSTEM DELETION VIA LRS CHANGE	MAP , SEGMENT

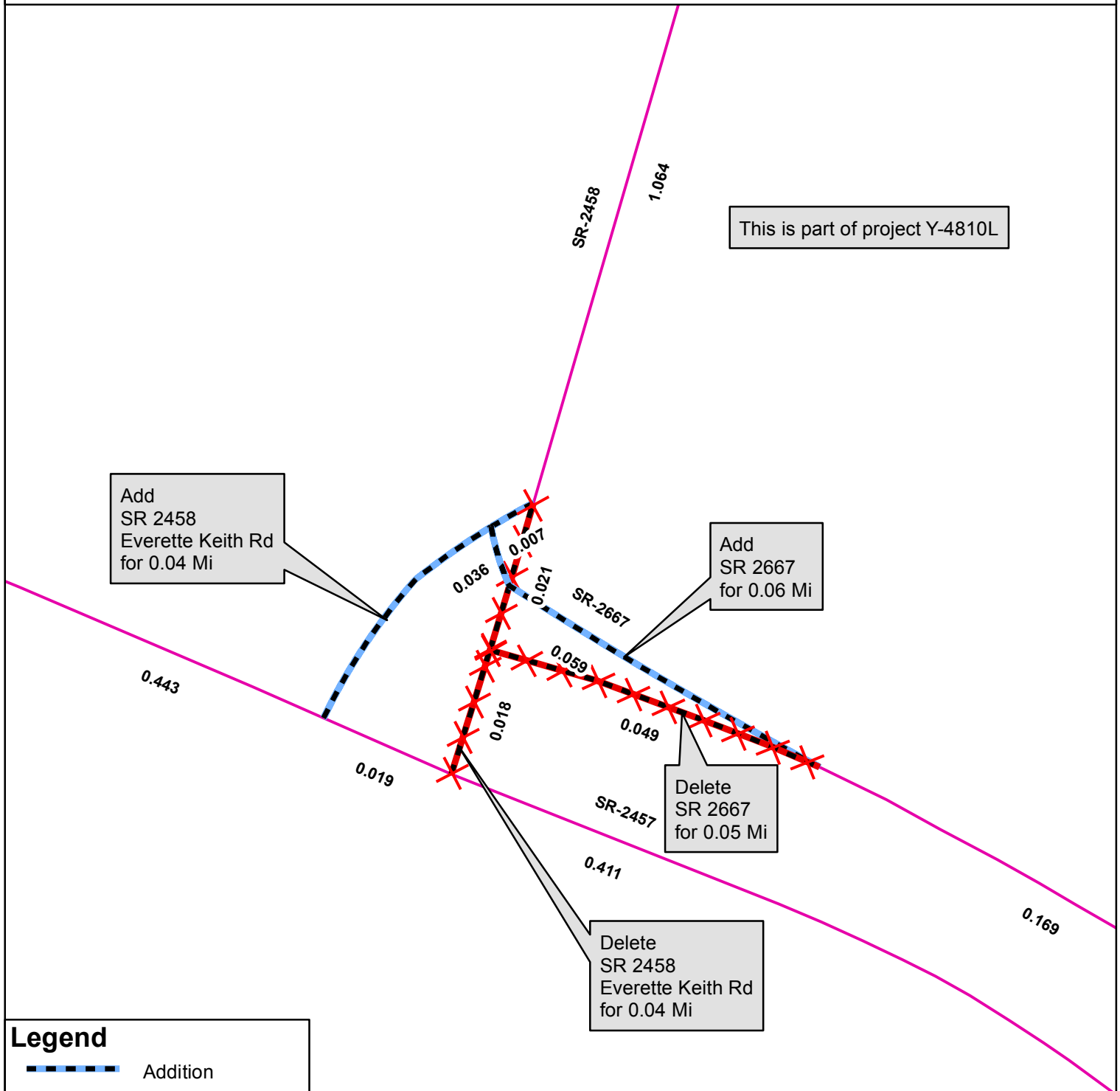

This is part of project Y-4810L





Add  
SR 2458  
Everette Keith Rd  
for 0.04 Mi

Add  
SR 2667  
for 0.06 Mi

Delete  
SR 2667  
for 0.05 Mi

Delete  
SR 2458  
Everette Keith Rd  
for 0.04 Mi

**Legend**

-  Addition
-  Deletion
-  Reassignment
-  SR
-  NC
-  US
-  Interstate
-  Ramp

