



STATE OF NORTH CAROLINA
DEPARTMENT OF TRANSPORTATION

BEVERLY EAVES PERDUE
GOVERNOR

Wednesday, July 13, 2011

EUGENE A. CONTI, JR.
SECRETARY

MEMORANDUM TO: Mr. Gregory W. Burns, PE
Division Engineer
Division 6

FROM: John C. Farley, Manager
Geographic Information Systems Unit

SUBJECT: 2011 District 2 Road System Changes

The Data Conversion Group has been authorized to make the following changes to the state road system as indicated below. We request that you make similar changes to the related maps and files in your Division and District offices, and install appropriate road number signs if necessary. we have updated our records accordingly. If our system changes do not conform to the actual conditions in the field, please return this memorandum with recommendations.

PETITION	County	Approval Date
49772	CUMBERLAND	7/7/2011

Inquiries about changes should be referred to the GIS Help Desk at (919) 707-2152.
Thank you for your assistance.

JCF



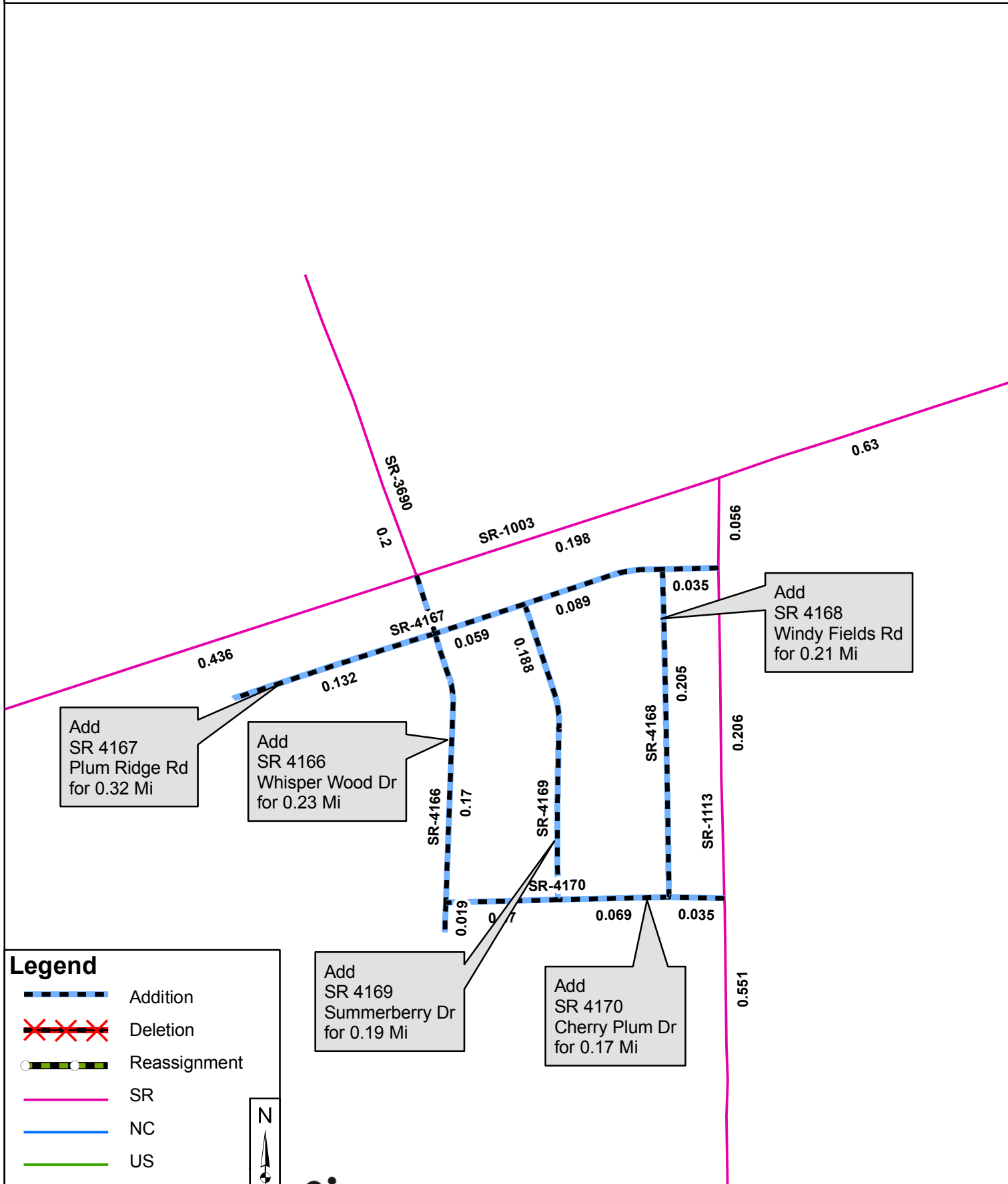

- cc: BSIP
- Bridge Maintenance
- Division Right of Way
- IMG
- Pavement Management
- Permit Unit
- State Road Maintenance
- Traffic Engineering
- Traffic Surveys

2011 ROAD SYSTEM CHANGES

PETITION	COUNTY	APPROVAL DATE	ROUTE NUMBER	PORTION REASSIGNED	STREET NAME	LENGTH (miles)	TYPE OF CHANGE	REMARKS (See Attached Map)
49772	CUMBERLAND	7/7/2011	SR 4170		CHERRY PLUM DR	0.17	SYSTEM ADDITION VIA PETITION	
49772	CUMBERLAND	7/7/2011	SR 4169		SUMMERBERRY DR	0.19	SYSTEM ADDITION VIA PETITION	
49772	CUMBERLAND	7/7/2011	SR 4168		WINDY FIELDS DR	0.21	SYSTEM ADDITION VIA PETITION	
49772	CUMBERLAND	7/7/2011	SR 4167		PLUM RIDGE RD	0.32	SYSTEM ADDITION VIA PETITION	
49772	CUMBERLAND	7/7/2011	SR 4166		WHISPER WOOD DR	0.23	SYSTEM ADDITION VIA PETITION	

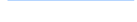

Legend

-  Addition
-  Deletion
-  Reassignment
-  SR
-  NC
-  US
-  Interstate
-  Ramp

