



STATE OF NORTH CAROLINA
DEPARTMENT OF TRANSPORTATION

BEVERLY EAVES PERDUE
GOVERNOR

Monday, October 03, 2011

EUGENE A. CONTI, JR.
SECRETARY

MEMORANDUM TO: Mr. Barry Moose, PE
Division Engineer
Division 10

FROM: John C. Farley, Manager
Geographic Information Systems Unit

SUBJECT: 2011 District 3 Road System Changes

The Data Conversion Group has been authorized to make the following changes to the state road system as indicated below. We request that you make similar changes to the related maps and files in your Division and District offices, and install appropriate road number signs if necessary. we have updated our records accordingly. If our system changes do not conform to the actual conditions in the field, please return this memorandum with recommendations.

MUNICIPAL	County	Approval Date
INDIAN TRAIL	UNION	6/30/2011

Inquiries about changes should be referred to the GIS Help Desk at (919) 707-2152.
Thank you for your assistance.

JCF

- cc: BSIP
- Bridge Maintenance
- Division Right of Way
- IMG
- Pavement Management
- Permit Unit
- State Road Maintenance
- Traffic Engineering
- Traffic Surveys

2011 ROAD SYSTEM CHANGES

MUNICIPAL	COUNTY	APPROVAL DATE	ROUTE NUMBER	PORTION REASSIGNED TO	STREET NAME	LENGTH (miles)	TYPE OF CHANGE	REMARKS (See Attached Map)
INDIAN TRAIL	UNION	6/30/2011	SR 1372		PARK RD	0.47	SYSTEM DELETION VIA MUNICIPAL	MAP G, SEGMENT
INDIAN TRAIL	UNION	6/30/2011	SR 1518		FAITH CHURCH RD	0.05	SYSTEM DELETION VIA MUNICIPAL	MAP G, SEGMENT
INDIAN TRAIL	UNION	6/30/2011	SR 1557		THIRD AVE	0.50	SYSTEM DELETION VIA MUNICIPAL	MAP E, SEGMENT
INDIAN TRAIL	UNION	6/30/2011	SR 1566		THIRD AVE	0.50	SYSTEM DELETION VIA MUNICIPAL	MAP E, SEGMENT
INDIAN TRAIL	UNION	6/30/2011	SR 1576		CAROL AVE	0.22	SYSTEM DELETION VIA MUNICIPAL	MAP E, SEGMENT
INDIAN TRAIL	UNION	6/30/2011	SR 3014		FAITH CHURCH RD	0.21	SYSTEM DELETION VIA MUNICIPAL	MAP G, SEGMENT
INDIAN TRAIL	UNION	6/30/2011	SR 3138		DEWDROP CT	0.06	SYSTEM DELETION VIA MUNICIPAL	MAP F, SEGMENT
INDIAN TRAIL	UNION	6/30/2011	SR 3139		SUNSHOWER CT	0.06	SYSTEM DELETION VIA MUNICIPAL	MAP F, SEGMENT
INDIAN TRAIL	UNION	6/30/2011	SR 3140		CATTAIL COVE	0.04	SYSTEM DELETION VIA MUNICIPAL	MAP F, SEGMENT
INDIAN TRAIL	UNION	6/30/2011	SR 3169		AINSDALE DR	0.16	SYSTEM DELETION VIA MUNICIPAL	MAP A , SEGMENT
INDIAN TRAIL	UNION	6/30/2011	SR 3170		RUSSET GLEN LN	0.12	SYSTEM DELETION VIA MUNICIPAL	MAP A, SEGMENT
INDIAN TRAIL	UNION	6/30/2011	SR 3292		BROOK VALLEY RUN	0.74	SYSTEM DELETION VIA MUNICIPAL	MAP B, SEGMENT
INDIAN TRAIL	UNION	6/30/2011	SR 3293		INLET WAY	0.06	SYSTEM DELETION VIA MUNICIPAL	MAP B, SEGMENT

MUNICIPAL	COUNTY	APPROVAL DATE	ROUTE NUMBER	PORTION REASSIGNED TO	STREET NAME	LENGTH (miles)	TYPE OF CHANGE	REMARKS (See Attached Map)
INDIAN TRAIL	UNION	6/30/2011	SR 3294		TOQUIMA TRL	0.06	SYSTEM DELETION VIA MUNICIPAL	MAP F, SEGMENT
INDIAN TRAIL	UNION	6/30/2011	SR 3295		PINE CONE LN	0.20	SYSTEM DELETION VIA MUNICIPAL	MAP B, SEGMENT
INDIAN TRAIL	UNION	6/30/2011	SR 3302		FORMOSA DR	0.07	SYSTEM DELETION VIA MUNICIPAL	MAP F, SEGMENT
INDIAN TRAIL	UNION	6/30/2011	SR 3468		CASTLEFORD BLVD	0.25	SYSTEM DELETION VIA MUNICIPAL	MAP D, SEGMENT
INDIAN TRAIL	UNION	6/30/2011	SR 3469		ELSMORE DR	0.23	SYSTEM DELETION VIA MUNICIPAL	MAP C, SEGMENT
INDIAN TRAIL	UNION	6/30/2011	SR 3470		FORBISHIRE DR	0.25	SYSTEM DELETION VIA MUNICIPAL	MAP C, SEGMENT
INDIAN TRAIL	UNION	6/30/2011	SR 3471		CAMROSE CROSSING	0.90	SYSTEM DELETION VIA MUNICIPAL	MAP C, SEGMENT
INDIAN TRAIL	UNION	6/30/2011	SR 3472		STANBURY DR	0.62	SYSTEM DELETION VIA MUNICIPAL	MAP D, SEGMENT
INDIAN TRAIL	UNION	6/30/2011	SR 3473		DOVERSTONE CT	0.06	SYSTEM DELETION VIA MUNICIPAL	MAP D, SEGMENT
INDIAN TRAIL	UNION	6/30/2011	SR 3474		DELACOURT LN	0.19	SYSTEM DELETION VIA MUNICIPAL	MAP C, SEGMENT
INDIAN TRAIL	UNION	6/30/2011	SR 3475		LYTTON LN	0.24	SYSTEM DELETION VIA MUNICIPAL	MAP C, SEGMENT
INDIAN TRAIL	UNION	6/30/2011	SR 3476		DELAMERE DR	0.91	SYSTEM DELETION VIA MUNICIPAL	MAP A, SEGMENT
INDIAN TRAIL	UNION	6/30/2011	SR 3477		DUMONT CT	0.03	SYSTEM DELETION VIA MUNICIPAL	MAP D, SEGMENT
INDIAN TRAIL	UNION	6/30/2011	SR 3478		THISTLEDOWN CT	0.07	SYSTEM DELETION VIA MUNICIPAL	MAP D, SEGMENT

Map: A

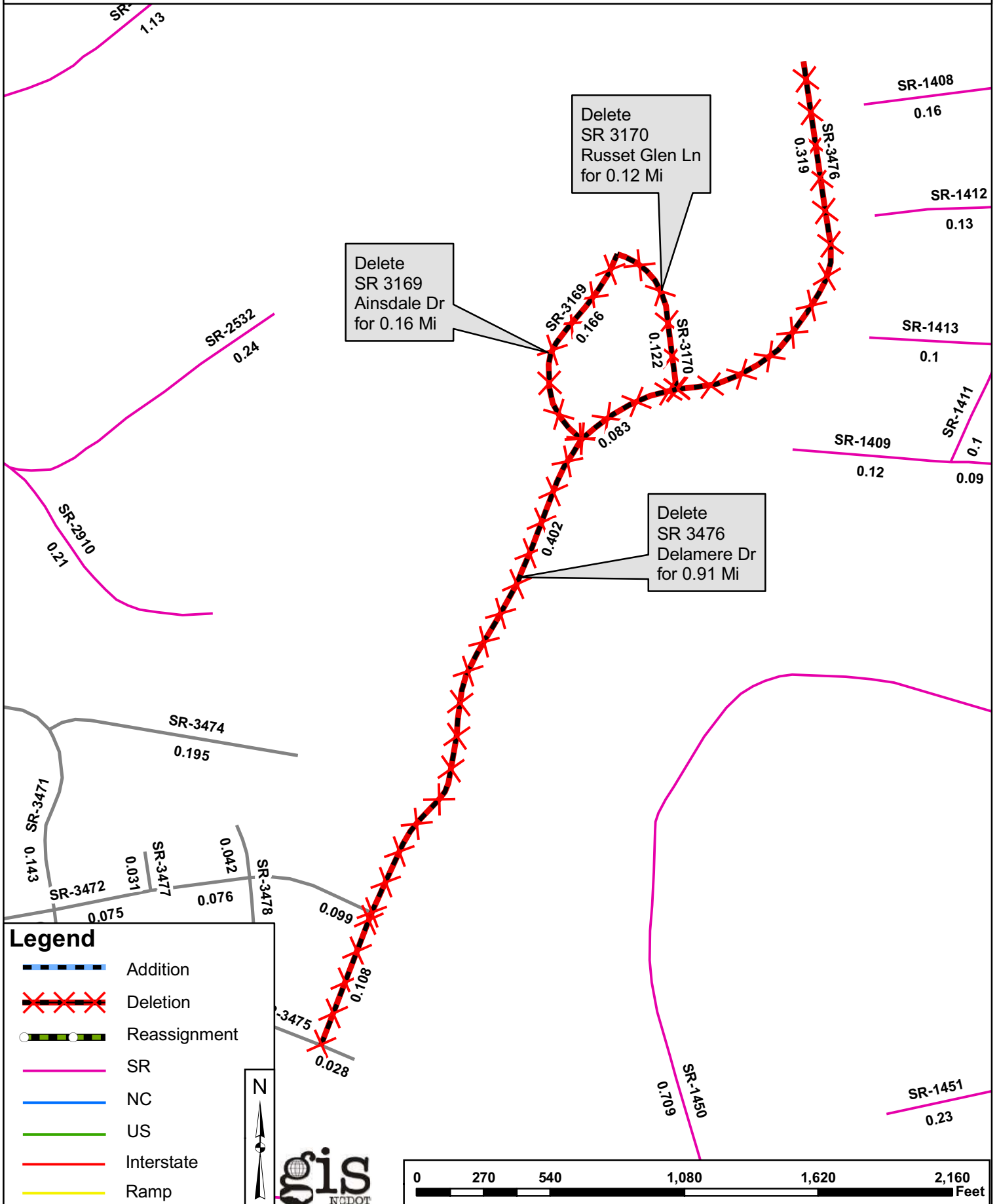

Map: B

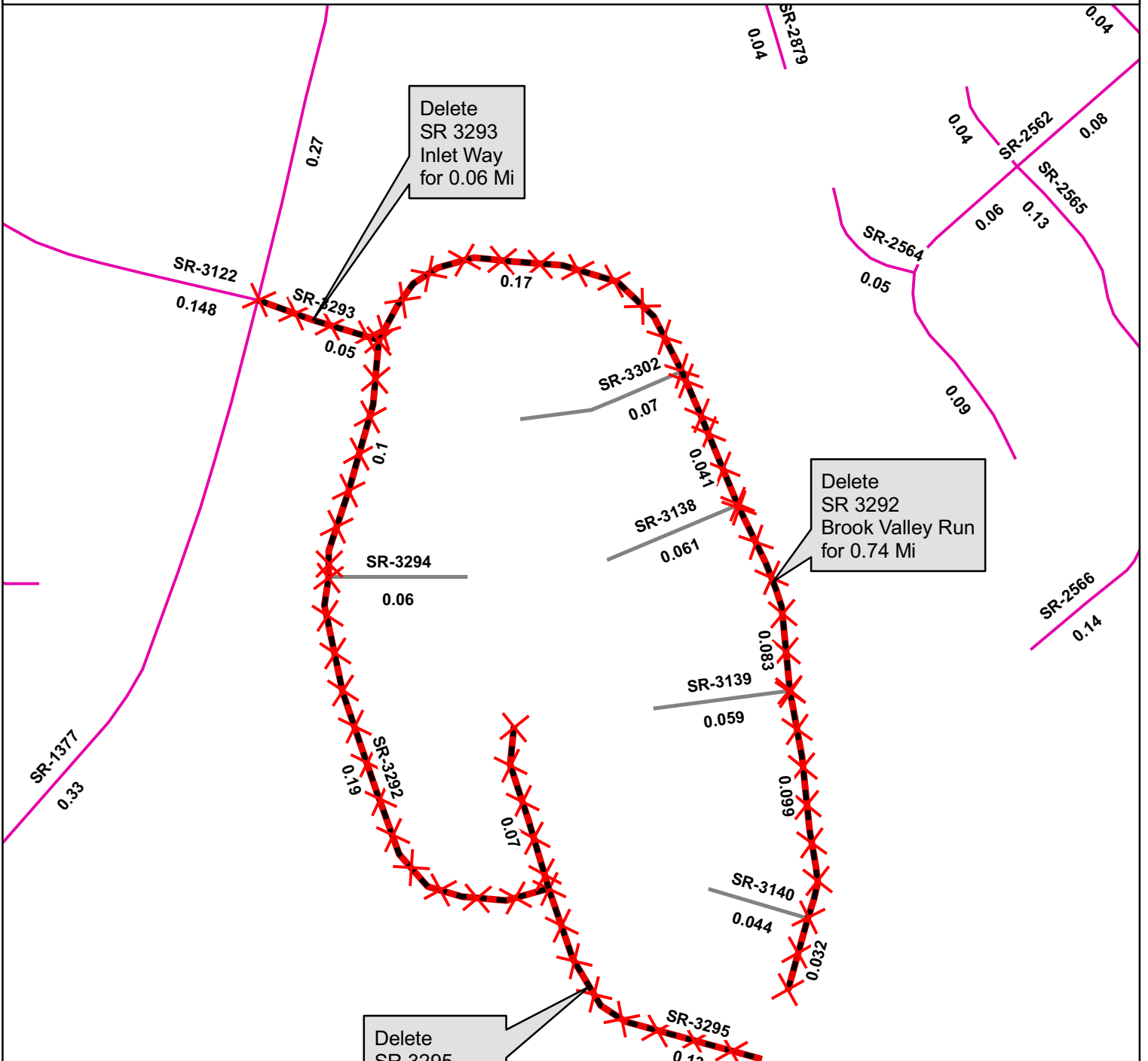

Legend

- Addition
- Deletion
- Reassignment
- SR
- NC
- US
- Interstate
- Ramp

N

Delete
SR 3295
Pine Cone Ln
for 0.20 Mi

Delete
SR 3293
Inlet Way
for 0.06 Mi

Delete
SR 3292
Brook Valley Run
for 0.74 Mi

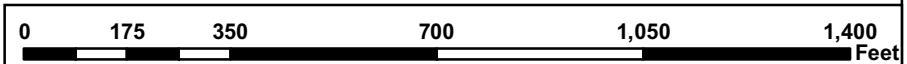

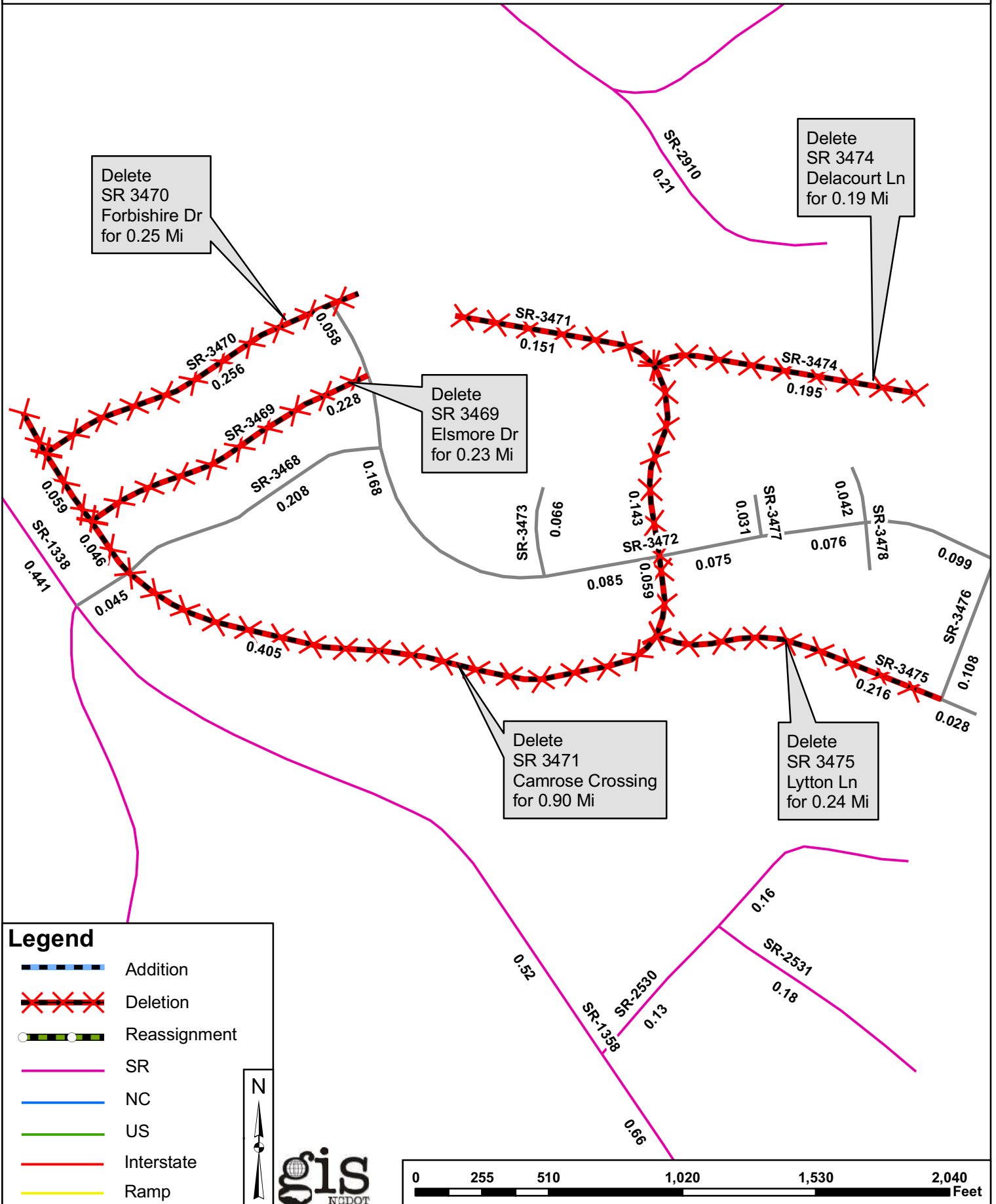

Map: D

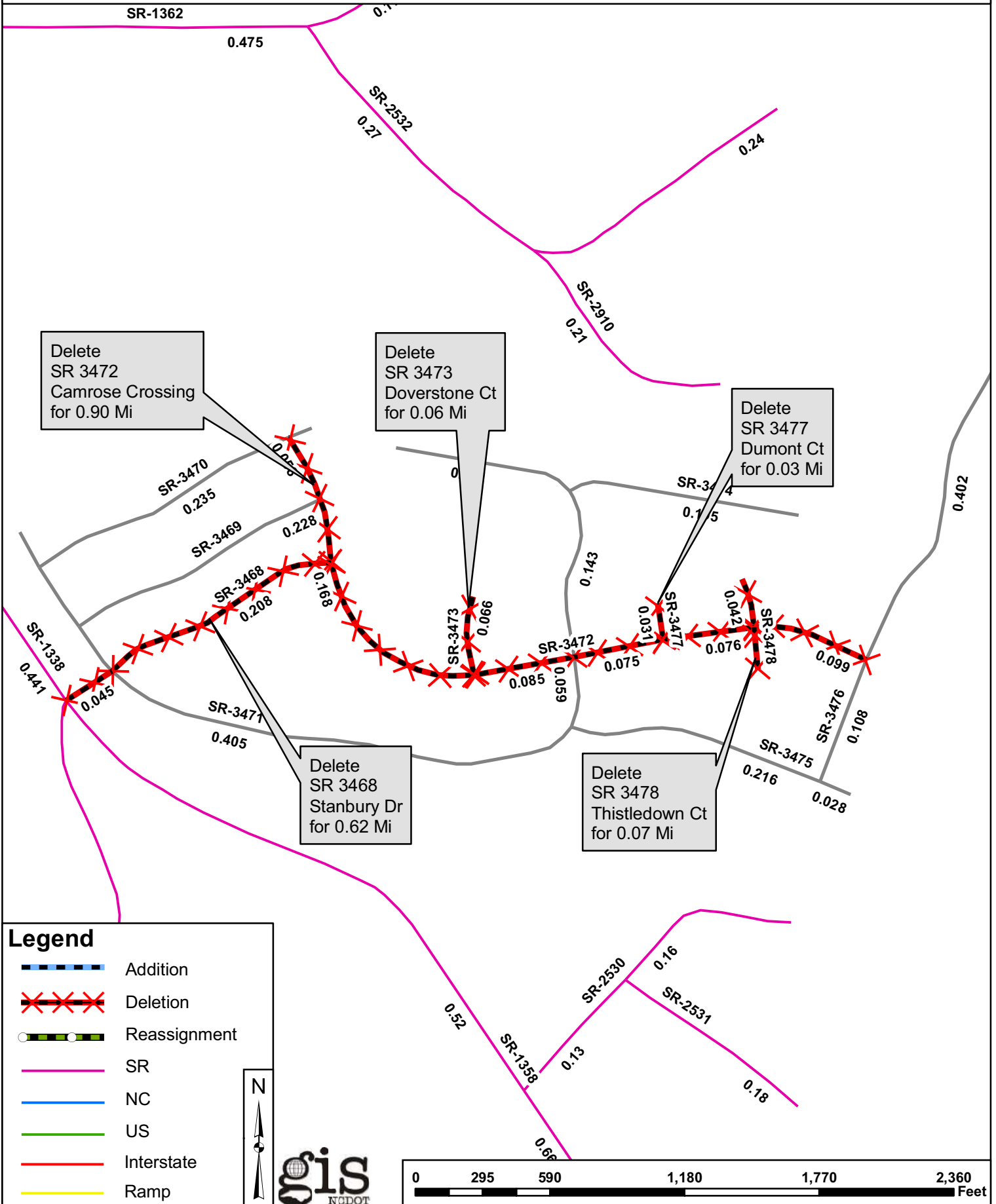

Map: E

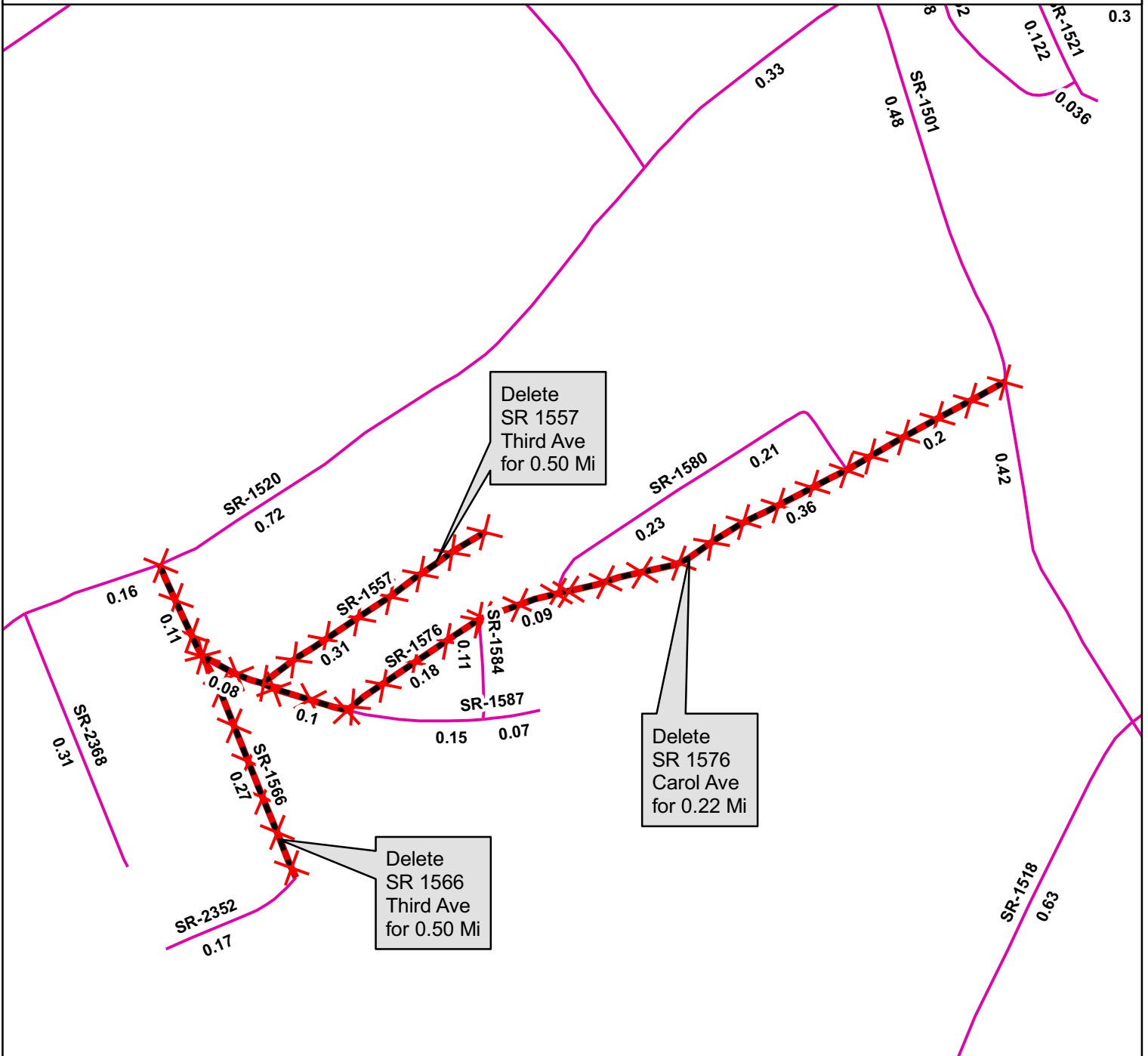

Legend

- Addition
- Deletion
- Reassignment
- SR
- NC
- US
- Interstate
- Ramp

N

gis
NCDOT

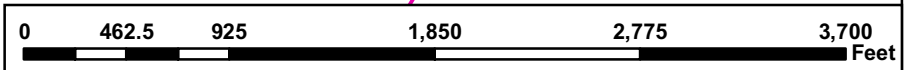

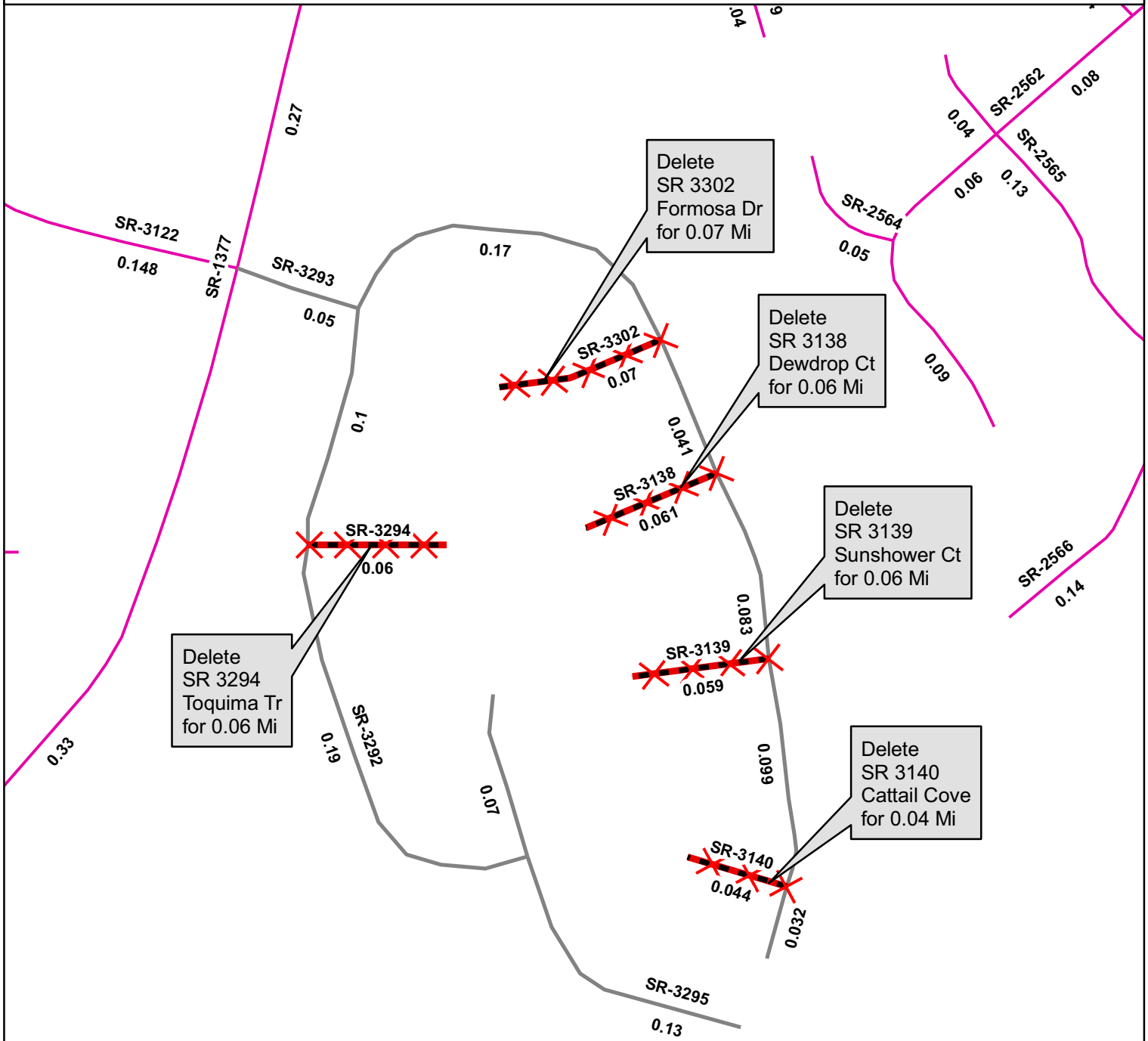

Legend

-  Addition
-  Deletion
-  Reassignment
-  SR
-  NC
-  US
-  Interstate
-  Ramp

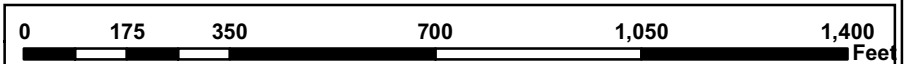

Map: G

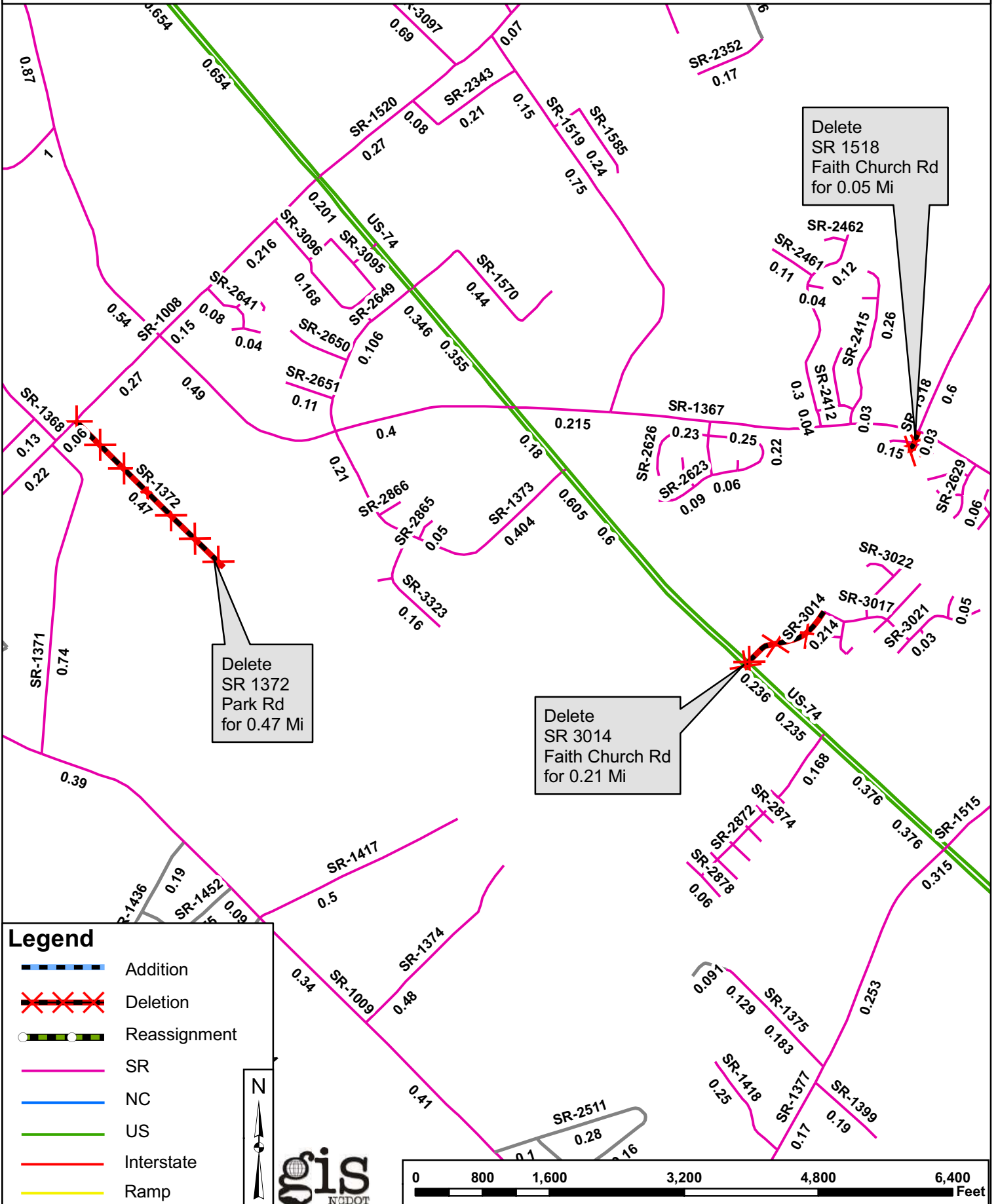

Legend

- Addition
- Deletion
- Reassignment
- SR
- NC
- US
- Interstate
- Ramp

