



STATE OF NORTH CAROLINA  
DEPARTMENT OF TRANSPORTATION

BEVERLY EAVES PERDUE  
GOVERNOR

Thursday, June 16, 2011

EUGENE A. CONTI, JR.  
SECRETARY

**MEMORANDUM TO:** Mr. Mike Mills, PE  
Division Engineer  
Division 7

**FROM:** John C. Farley, Manager  
Geographic Information Systems Unit

**SUBJECT:** 2011 District 1 Road System Changes

The Data Conversion Group has been authorized to make the following changes to the state road system as indicated below. We request that you make similar changes to the related maps and files in your Division and District offices, and install appropriate road number signs if necessary. we have updated our records accordingly. If our system changes do not conform to the actual conditions in the field, please return this memorandum with recommendations.

MUNICIPAL	County	Approval Date
CARRBORO	ORANGE	6/3/2011

Inquiries about changes should be referred to the GIS Help Desk at (919) 707-2152.  
Thank you for your assistance.

JCF

- cc: BSIP
- Bridge Maintenance
- Division Right of Way
- IMG
- Pavement Management
- Permit Unit
- State Road Maintenance
- Traffic Engineering
- Traffic Surveys

# 2011 ROAD SYSTEM CHANGES





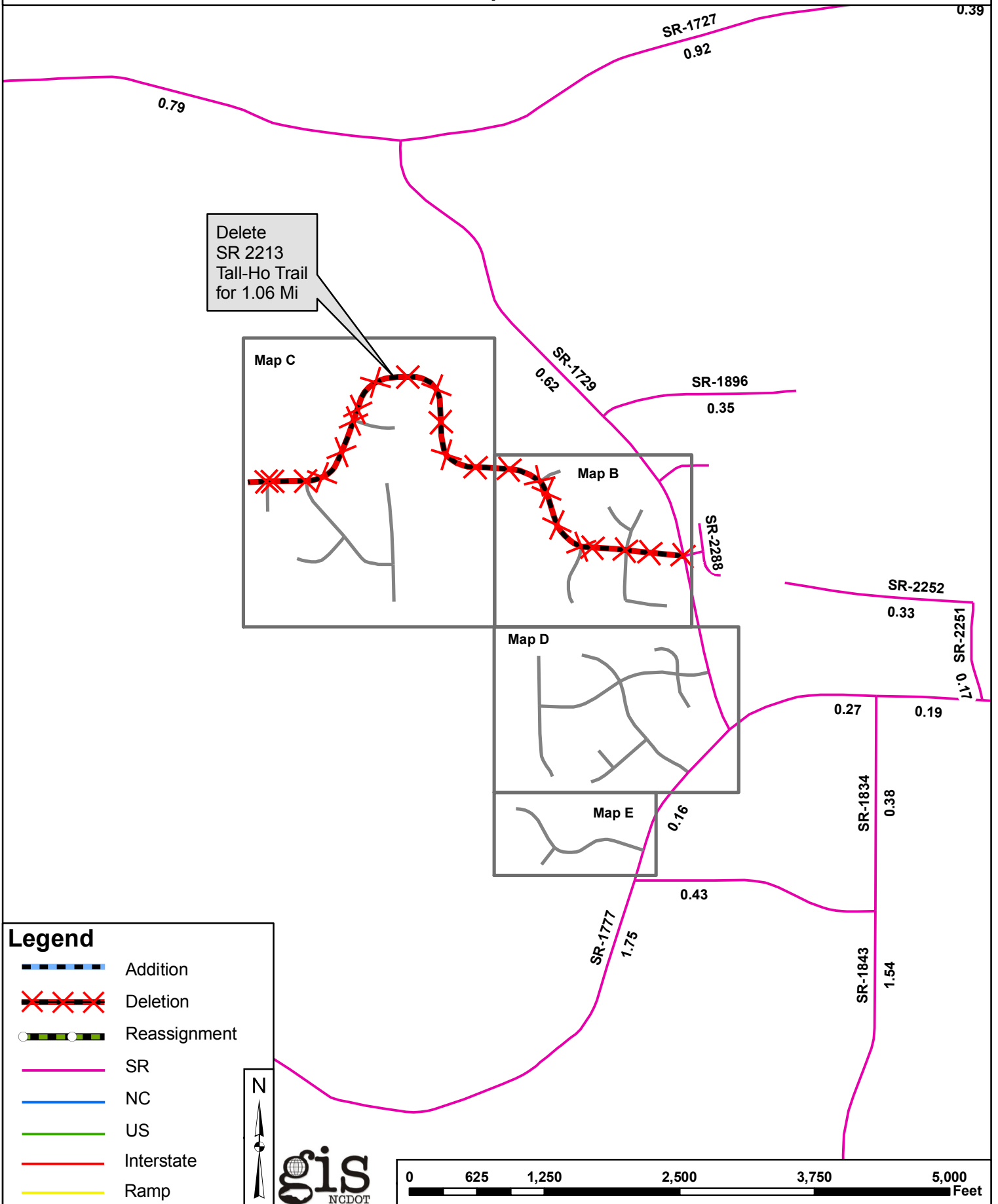

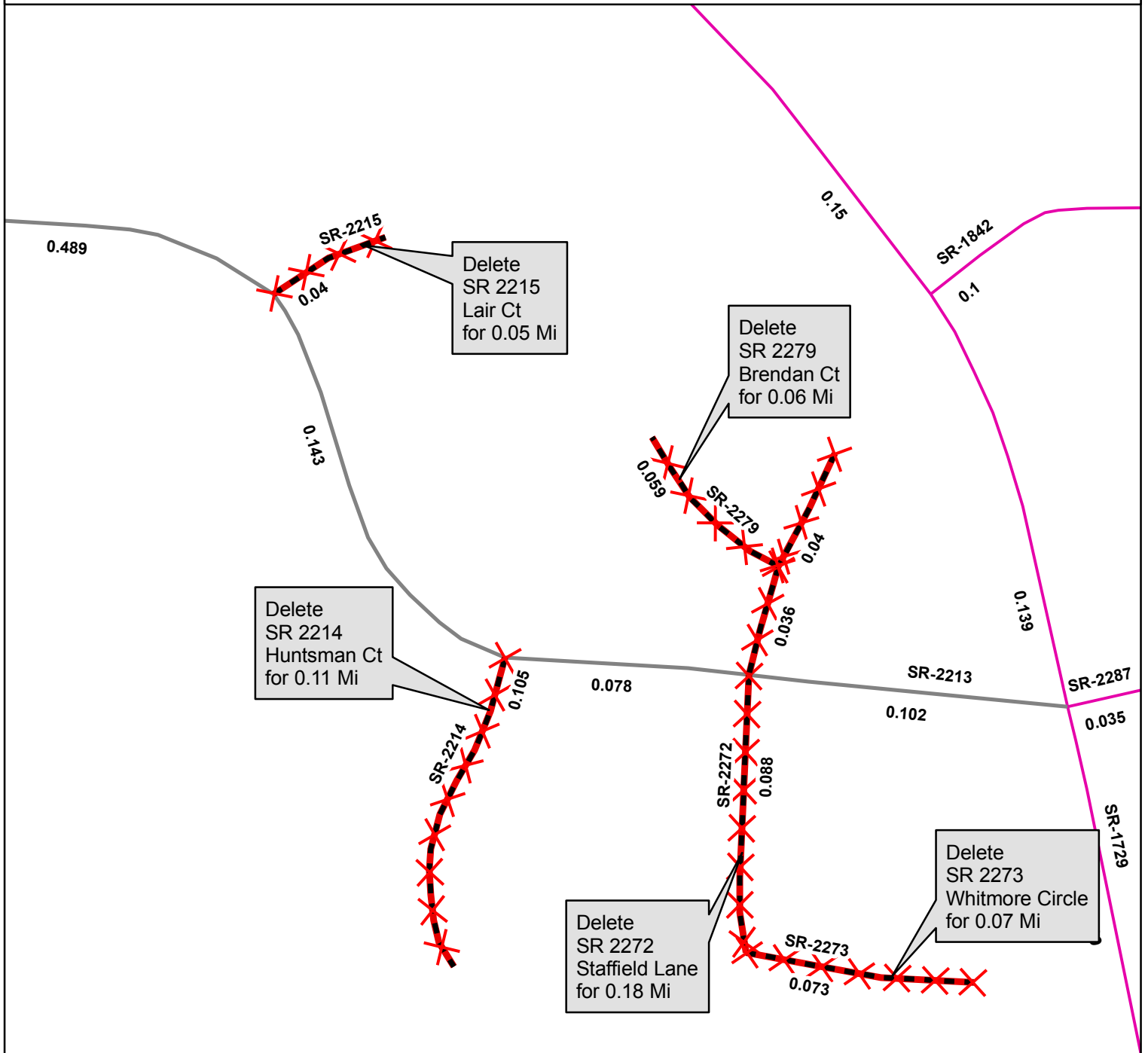
MUNICIPAL	COUNTY	APPROVAL DATE	ROUTE NUMBER	PORTION REASSIGNED TO	STREET NAME	LENGTH (miles)	TYPE OF CHANGE	REMARKS (See Attached Map)
CARRBORO	ORANGE	6/3/2011	SR 2213		TALL-HO TRAIL	1.06	SYSTEM DELETION VIA MUNICIPAL	MAP A, SEGMENT
CARRBORO	ORANGE	6/3/2011	SR 2214		HUNTSMAN CT.	0.11	SYSTEM DELETION VIA MUNICIPAL	MAP B, SEGMENT
CARRBORO	ORANGE	6/3/2011	SR 2215		LAIR CT.	0.05	SYSTEM DELETION VIA MUNICIPAL	MAP B, SEGMENT
CARRBORO	ORANGE	6/3/2011	SR 2242		BUGLE CT	0.07	SYSTEM DELETION VIA MUNICIPAL	MAP C, SEGMENT
CARRBORO	ORANGE	6/3/2011	SR 2246		STERLING BRIDGE RDRD/BURNS PLACE	0.30	SYSTEM DELETION VIA MUNICIPAL	MAP D, SEGMENT
CARRBORO	ORANGE	6/3/2011	SR 2247		SKYE DR.	0.14	SYSTEM DELETION VIA MUNICIPAL	MAP D, SEGMENT
CARRBORO	ORANGE	6/3/2011	SR 2248		BALMORAL PLACE	0.04	SYSTEM DELETION VIA MUNICIPAL	MAP D, SEGMENT
CARRBORO	ORANGE	6/3/2011	SR 2249		CLAYMORE ROAD	0.15	SYSTEM DELETION VIA MUNICIPAL	MAP D, SEGMENT
CARRBORO	ORANGE	6/3/2011	SR 2250		INVERNESS WAY/LOCH LAVEN LANE	0.23	SYSTEM DELETION VIA MUNICIPAL	MAP D, SEGMENT
CARRBORO	ORANGE	6/3/2011	SR 2253		CLAYMORE ROAD	0.16	SYSTEM DELETION VIA MUNICIPAL	MAP D, SEGMENT
CARRBORO	ORANGE	6/3/2011	SR 2254		NORTH HAYWICK CT/SOUTH HAYWICK	0.13	SYSTEM DELETION VIA MUNICIPAL	MAP D, SEGMENT
CARRBORO	ORANGE	6/3/2011	SR 2261		KIT LANE	0.05	SYSTEM DELETION VIA MUNICIPAL	MAP C, SEGMENT
CARRBORO	ORANGE	6/3/2011	SR 2262		REYNARD RD.	0.23	SYSTEM DELETION VIA MUNICIPAL	MAP C, SEGMENT

<b>MUNICIPAL</b>	<b>COUNTY</b>	<b>APPROVAL DATE</b>	<b>ROUTE NUMBER</b>	<b>PORTION REASSIGNED TO</b>	<b>STREET NAME</b>	<b>LENGTH (miles)</b>	<b>TYPE OF CHANGE</b>	<b>REMARKS (See Attached Map)</b>
CARRBORO	ORANGE	6/3/2011	SR 2263		BRACE LANE	0.10	SYSTEM DELETION VIA MUNICIPAL	MAP C, SEGMENT
CARRBORO	ORANGE	6/3/2011	SR 2264		NORTH HOUND CT.	0.15	SYSTEM DELETION VIA MUNICIPAL	MAP C, SEGMENT
CARRBORO	ORANGE	6/3/2011	SR 2265		SOUTH HOUND COURT	0.07	SYSTEM DELETION VIA MUNICIPAL	MAP C, SEGMENT
CARRBORO	ORANGE	6/3/2011	SR 2272		STAFFIELD LANE	0.18	SYSTEM DELETION VIA MUNICIPAL	MAP B, SEGMENT
CARRBORO	ORANGE	6/3/2011	SR 2273		WHITMORE CIRCLE	0.07	SYSTEM DELETION VIA MUNICIPAL	MAP B, SEGMENT
CARRBORO	ORANGE	6/3/2011	SR 2277		CAMDEN LANE	0.27	SYSTEM DELETION VIA MUNICIPAL	MAP E, SEGMENT
CARRBORO	ORANGE	6/3/2011	SR 2278		GLOUCESTER CT.	0.04	SYSTEM DELETION VIA MUNICIPAL	MAP E, SEGMENT
CARRBORO	ORANGE	6/3/2011	SR 2279		BRENDAN CT	0.06	SYSTEM DELETION VIA MUNICIPAL	MAP B, SEGMENT





**Legend**

-  Addition
-  Deletion
-  Reassignment
-  SR
-  NC
-  US
-  Interstate
-  Ramp

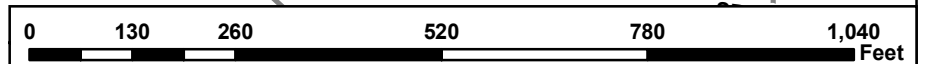

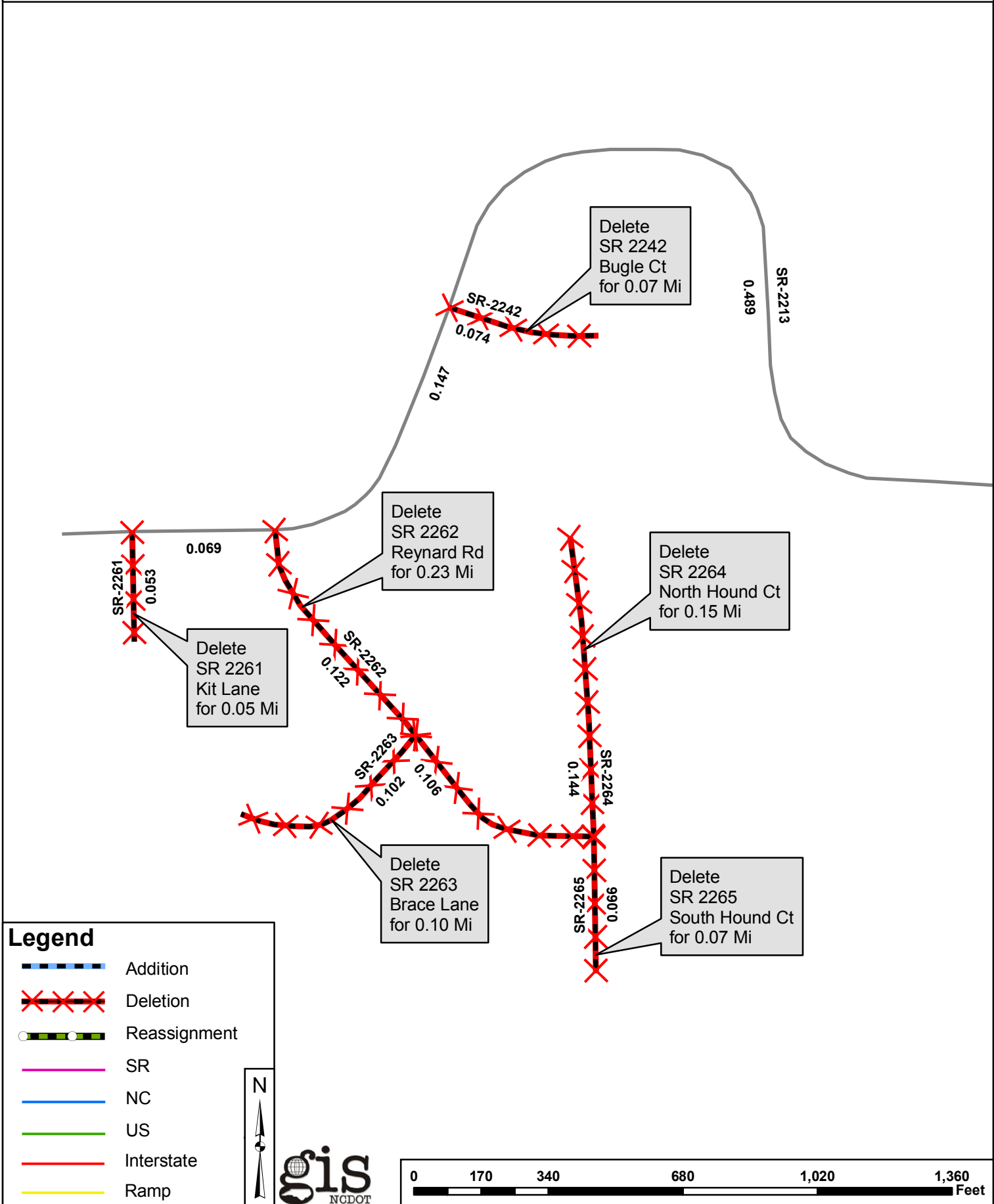



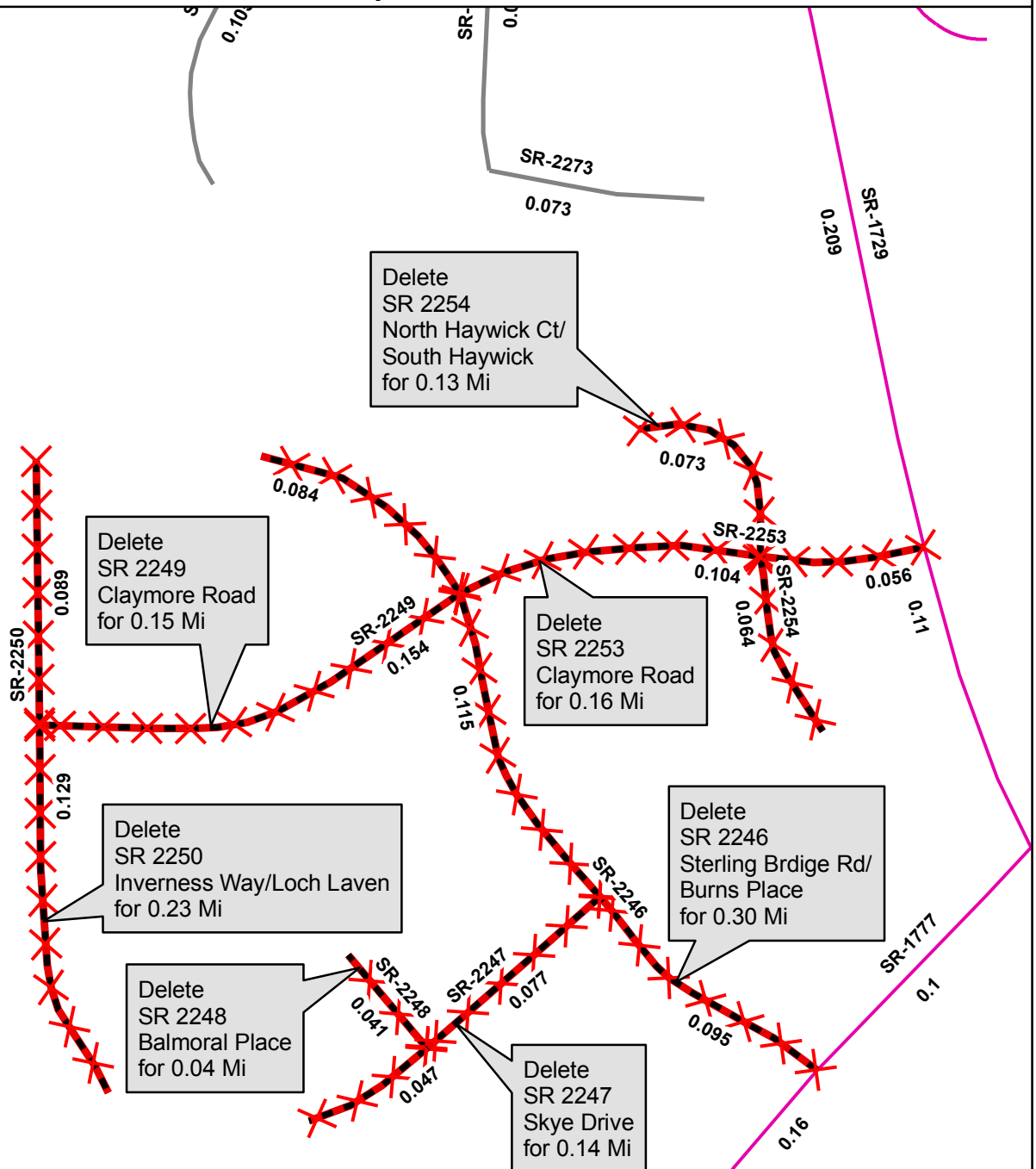

Map: D



Legend

-  Addition
-  Deletion
-  Reassignment
-  SR
-  NC
-  US
-  Interstate
-  Ramp

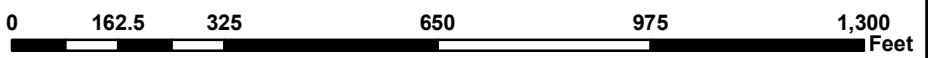

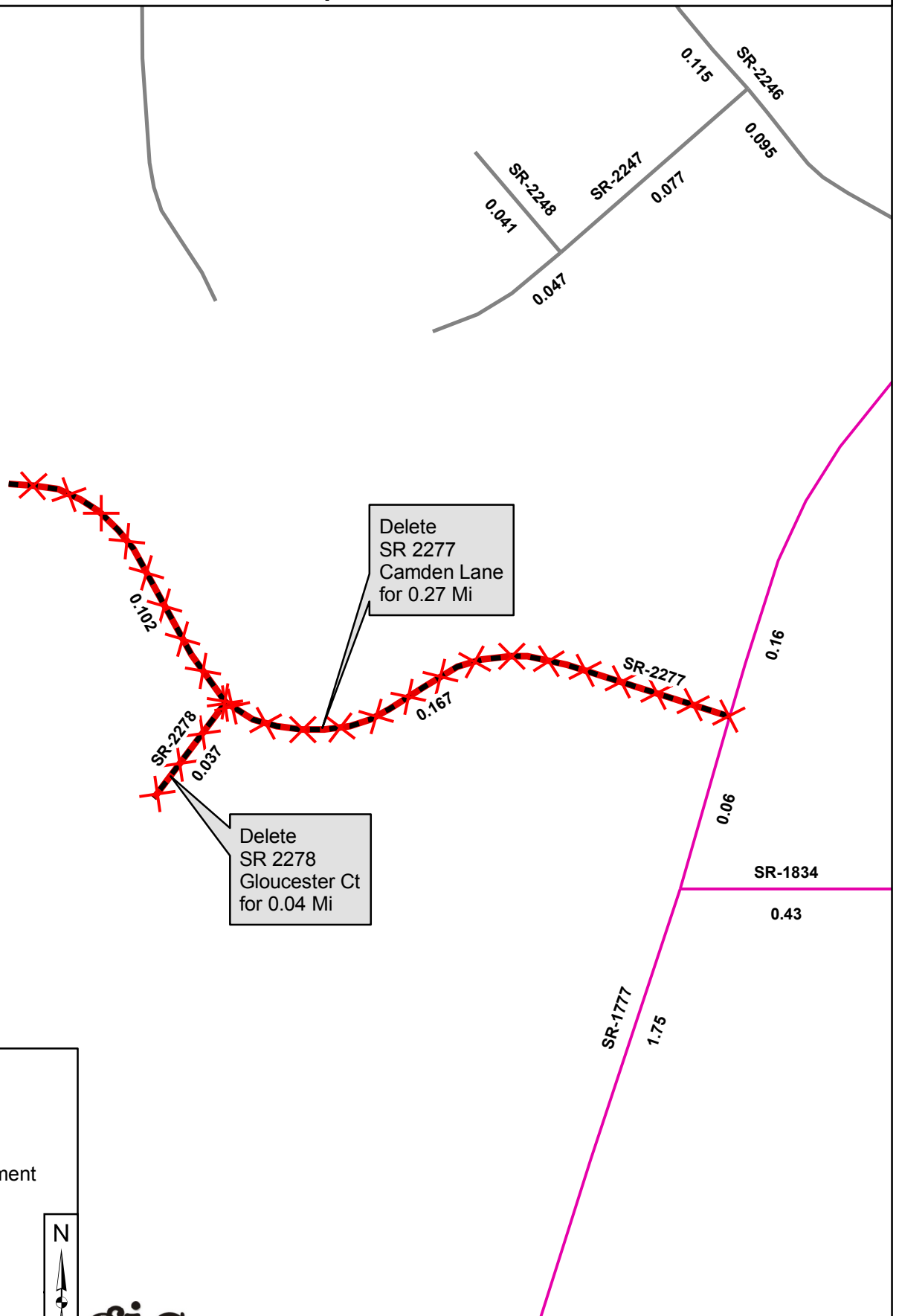

**Legend**

- Addition
- Deletion
- Reassignment
- SR
- NC
- US
- Interstate
- Ramp

N

