



STATE OF NORTH CAROLINA  
DEPARTMENT OF TRANSPORTATION

BEVERLY EAVES PERDUE  
GOVERNOR

Thursday, April 28, 2011

EUGENE A. CONTI, JR.  
SECRETARY

**MEMORANDUM TO:** Mr. Barry Moose, PE  
Division Engineer  
Division 10

**FROM:** John C. Farley, Manager  
Geographic Information Systems Unit

**SUBJECT:** 2011 District 3 Road System Changes

The Data Conversion Group has been authorized to make the following changes to the state road system as indicated below. We request that you make similar changes to the related maps and files in your Division and District offices, and install appropriate road number signs if necessary. we have updated our records accordingly. If our system changes do not conform to the actual conditions in the field, please return this memorandum with recommendations.

MUNICIPAL	County	Approval Date
STALLINGS	UNION	4/7/2011

Inquiries about changes should be referred to the GIS Help Desk at (919) 707-2152.  
Thank you for your assistance.

JCF

- cc: BSIP
- Bridge Maintenance
- Division Right of Way
- IMG
- Pavement Management
- Permit Unit
- State Road Maintenance
- Traffic Engineering
- Traffic Surveys

# 2011 ROAD SYSTEM CHANGES

MUNICIPAL	COUNTY	APPROVAL DATE	ROUTE NUMBER	PORTION REASSIGNED TO	STREET NAME	LENGTH (miles)	TYPE OF CHANGE	REMARKS (See Attached Map)
STALLINGS	UNION	4/7/2011	SR 1591		FAIRFIELD DR	0.48	SYSTEM DELETION VIA MUNICIPAL	MAP B , SEGMENT
STALLINGS	UNION	4/7/2011	SR 1593		BROOKGREEN TERRACE	0.22	SYSTEM DELETION VIA MUNICIPAL	MAP B , SEGMENT
STALLINGS	UNION	4/7/2011	SR 1594		EDGEFIELD CT	0.22	SYSTEM DELETION VIA MUNICIPAL	MAP B , SEGMENT
STALLINGS	UNION	4/7/2011	SR 1595		BRIARWOOD CT	0.08	SYSTEM DELETION VIA MUNICIPAL	MAP B , SEGMENT
STALLINGS	UNION	4/7/2011	SR 1596		LAWING CT	0.04	SYSTEM DELETION VIA MUNICIPAL	MAP B , SEGMENT
STALLINGS	UNION	4/7/2011	SR 1597		LAKE DRIVE	0.25	SYSTEM DELETION VIA MUNICIPAL	MAP B , SEGMENT
STALLINGS	UNION	4/7/2011	SR 1598		STONE RIDGE RD	0.55	SYSTEM DELETION VIA MUNICIPAL	MAP C , SEGMENT
STALLINGS	UNION	4/7/2011	SR 1599		FIELDSTONE DR.	0.13	SYSTEM DELETION VIA MUNICIPAL	MAP B , SEGMENT
STALLINGS	UNION	4/7/2011	SR 2302		PEACHTREE CT.	0.03	SYSTEM DELETION VIA MUNICIPAL	MAP C , SEGMENT
STALLINGS	UNION	4/7/2011	SR 2303		OLD FARM COURT	0.02	SYSTEM DELETION VIA MUNICIPAL	MAP C , SEGMENT
STALLINGS	UNION	4/7/2011	SR 2304		APPLE TREE COURT	0.04	SYSTEM DELETION VIA MUNICIPAL	MAP C , SEGMENT
STALLINGS	UNION	4/7/2011	SR 2324		GREENWAY DR.	0.06	SYSTEM DELETION VIA MUNICIPAL	MAP C , SEGMENT
STALLINGS	UNION	4/7/2011	SR 2325		HOLLY COURT	0.04	SYSTEM DELETION VIA MUNICIPAL	MAP C , SEGMENT

<b>MUNICIPAL</b>	<b>COUNTY</b>	<b>APPROVAL DATE</b>	<b>ROUTE NUMBER</b>	<b>PORTION REASSIGNED TO</b>	<b>STREET NAME</b>	<b>LENGTH (miles)</b>	<b>TYPE OF CHANGE</b>	<b>REMARKS (See Attached Map)</b>
STALLINGS	UNION	4/7/2011	SR 2357		REDWOOD DR.	0.63	SYSTEM DELETION VIA MUNICIPAL	MAP A , SEGMENT
STALLINGS	UNION	4/7/2011	SR 2358		BEECH COURT	0.21	SYSTEM DELETION VIA MUNICIPAL	MAP A , SEGMENT
STALLINGS	UNION	4/7/2011	SR 2359		CYPRUS COURT	0.17	SYSTEM DELETION VIA MUNICIPAL	MAP A , SEGMENT
STALLINGS	UNION	4/7/2011	SR 2363		HAWTHORNE DR.	0.88	SYSTEM DELETION VIA MUNICIPAL	MAP A , SEGMENT
STALLINGS	UNION	4/7/2011	SR 2364		BIRCH DR.	0.19	SYSTEM DELETION VIA MUNICIPAL	MAP A , SEGMENT
STALLINGS	UNION	4/7/2011	SR 2366		REDWOOD DR.	0.09	SYSTEM DELETION VIA MUNICIPAL	MAP A , SEGMENT
STALLINGS	UNION	4/7/2011	SR 2367		SCALEYBARK CT.	0.17	SYSTEM DELETION VIA MUNICIPAL	MAP A , SEGMENT
STALLINGS	UNION	4/7/2011	SR 2403		JUNIPER CT	0.14	SYSTEM DELETION VIA MUNICIPAL	MAP A , SEGMENT
STALLINGS	UNION	4/7/2011	SR 2426		SHADOW LAKE LN	0.28	SYSTEM DELETION VIA MUNICIPAL	MAP H , SEGMENT
STALLINGS	UNION	4/7/2011	SR 2456		ASPEN CT	0.11	SYSTEM DELETION VIA MUNICIPAL	MAP A , SEGMENT
STALLINGS	UNION	4/7/2011	SR 2457		LOCUST CT	0.05	SYSTEM DELETION VIA MUNICIPAL	MAP A , SEGMENT
STALLINGS	UNION	4/7/2011	SR 2458		QUINCE CT	0.06	SYSTEM DELETION VIA MUNICIPAL	MAP A , SEGMENT
STALLINGS	UNION	4/7/2011	SR 2477		WILD ROSE CT	0.11	SYSTEM DELETION VIA MUNICIPAL	MAP H , SEGMENT
STALLINGS	UNION	4/7/2011	SR 2829		KERRY GREENS DR	0.41	SYSTEM DELETION VIA MUNICIPAL	MAP D , SEGMENT

<b>MUNICIPAL</b>	<b>COUNTY</b>	<b>APPROVAL DATE</b>	<b>ROUTE NUMBER</b>	<b>PORTION REASSIGNED TO</b>	<b>STREET NAME</b>	<b>LENGTH (miles)</b>	<b>TYPE OF CHANGE</b>	<b>REMARKS (See Attached Map)</b>
STALLINGS	UNION	4/7/2011	SR 2830		COATESDALE LANE	0.43	SYSTEM DELETION VIA MUNICIPAL	MAP D , SEGMENT
STALLINGS	UNION	4/7/2011	SR 2831		HEISON COURT	0.03	SYSTEM DELETION VIA MUNICIPAL	MAP D , SEGMENT
STALLINGS	UNION	4/7/2011	SR 2832		COPELAND COURT	0.08	SYSTEM DELETION VIA MUNICIPAL	MAP D , SEGMENT
STALLINGS	UNION	4/7/2011	SR 2833		BRAD COURT	0.07	SYSTEM DELETION VIA MUNICIPAL	MAP D , SEGMENT
STALLINGS	UNION	4/7/2011	SR 2834		ASHIE AVE.	0.16	SYSTEM DELETION VIA MUNICIPAL	MAP E , SEGMENT
STALLINGS	UNION	4/7/2011	SR 2905		WYNTREE CT.	0.29	SYSTEM DELETION VIA MUNICIPAL	MAP E , SEGMENT
STALLINGS	UNION	4/7/2011	SR 2906		DREW COURT	0.05	SYSTEM DELETION VIA MUNICIPAL	MAP D , SEGMENT
STALLINGS	UNION	4/7/2011	SR 2907		SHECKLER LANE	0.13	SYSTEM DELETION VIA MUNICIPAL	MAP D , SEGMENT
STALLINGS	UNION	4/7/2011	SR 2908		SUTTLE PL	0.39	SYSTEM DELETION VIA MUNICIPAL	MAP E , SEGMENT
STALLINGS	UNION	4/7/2011	SR 3046		PECAN DR	0.12	SYSTEM DELETION VIA MUNICIPAL	MAP A , SEGMENT
STALLINGS	UNION	4/7/2011	SR 3047		HEMLOCK DR.	0.08	SYSTEM DELETION VIA MUNICIPAL	MAP A , SEGMENT
STALLINGS	UNION	4/7/2011	SR 3048		BLARNEY CT.	0.15	SYSTEM DELETION VIA MUNICIPAL	MAP G , SEGMENT
STALLINGS	UNION	4/7/2011	SR 3049		CLIFDEN DR.	0.25	SYSTEM DELETION VIA MUNICIPAL	MAP F , SEGMENT
STALLINGS	UNION	4/7/2011	SR 3050		CLONMEL DR.	0.51	SYSTEM DELETION VIA MUNICIPAL	MAP G , SEGMENT

<b>MUNICIPAL</b>	<b>COUNTY</b>	<b>APPROVAL DATE</b>	<b>ROUTE NUMBER</b>	<b>PORTION REASSIGNED TO</b>	<b>STREET NAME</b>	<b>LENGTH (miles)</b>	<b>TYPE OF CHANGE</b>	<b>REMARKS (See Attached Map)</b>
STALLINGS	UNION	4/7/2011	SR 3051		KILLIAN CT.	0.52	SYSTEM DELETION VIA MUNICIPAL	MAP F , SEGMENT
STALLINGS	UNION	4/7/2011	SR 3052		GREGAN CT.	0.04	SYSTEM DELETION VIA MUNICIPAL	MAP F , SEGMENT
STALLINGS	UNION	4/7/2011	SR 3053		DRUMCLIFF CT.	0.03	SYSTEM DELETION VIA MUNICIPAL	MAP F , SEGMENT
STALLINGS	UNION	4/7/2011	SR 3054		GALWAY CT.	0.03	SYSTEM DELETION VIA MUNICIPAL	MAP G , SEGMENT
STALLINGS	UNION	4/7/2011	SR 3055		ROSECREA CT.	0.06	SYSTEM DELETION VIA MUNICIPAL	MAP G , SEGMENT
STALLINGS	UNION	4/7/2011	SR 3056		TULLAMORE CT	0.03	SYSTEM DELETION VIA MUNICIPAL	MAP G , SEGMENT
STALLINGS	UNION	4/7/2011	SR 3057		ADARE COURT	0.03	SYSTEM DELETION VIA MUNICIPAL	MAP G , SEGMENT
STALLINGS	UNION	4/7/2011	SR 3058		BALLYMOTE CT.	0.38	SYSTEM DELETION VIA MUNICIPAL	MAP F , SEGMENT
STALLINGS	UNION	4/7/2011	SR 3059		LIMERICK DR	0.35	SYSTEM DELETION VIA MUNICIPAL	MAP F , SEGMENT
STALLINGS	UNION	4/7/2011	SR 3060		CASHEL CT.	0.03	SYSTEM DELETION VIA MUNICIPAL	MAP F , SEGMENT



Map: B

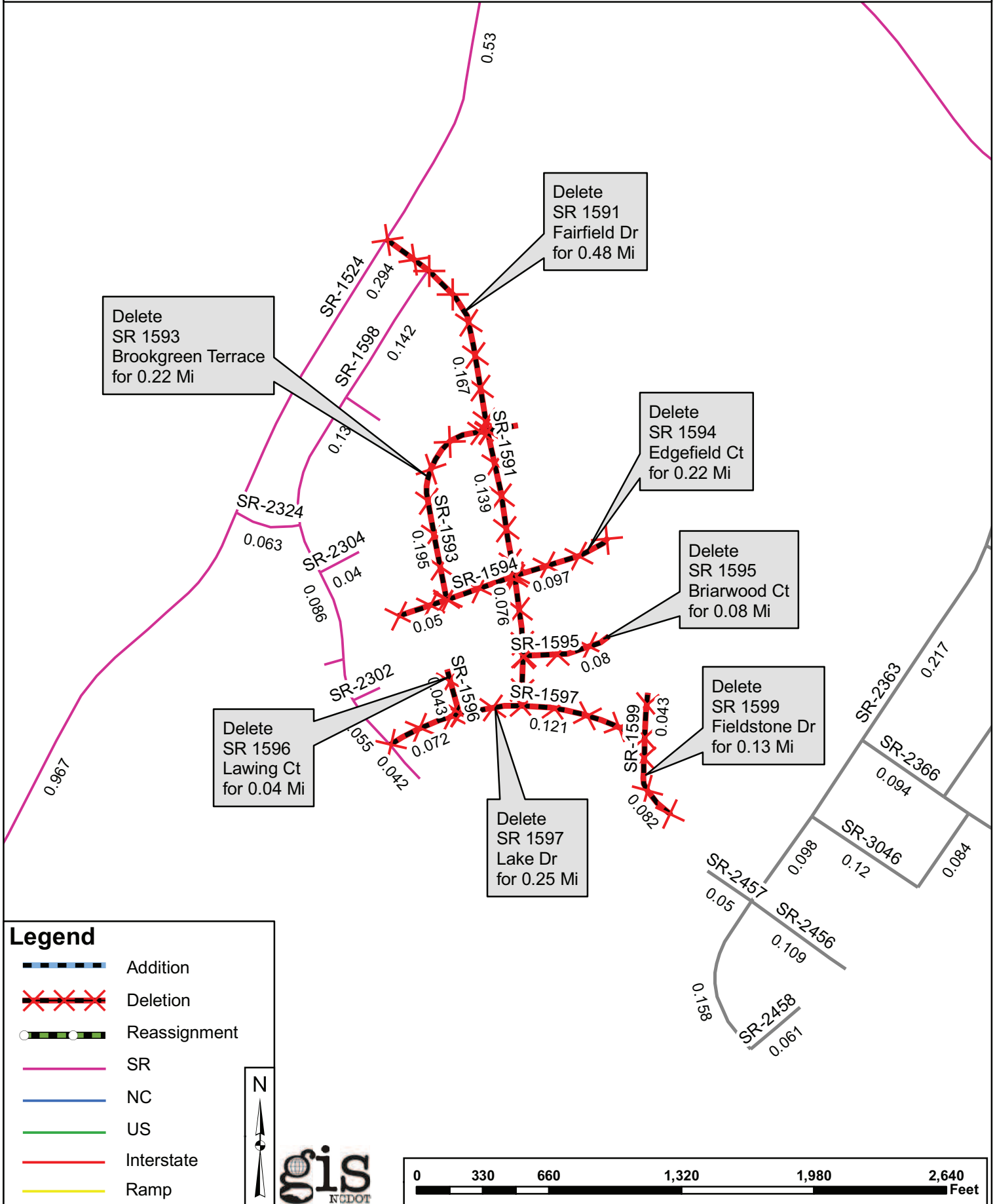

**Legend**

- Addition
- Deletion
- Reassignment
- SR
- NC
- US
- Interstate
- Ramp

gis  
NCDOT

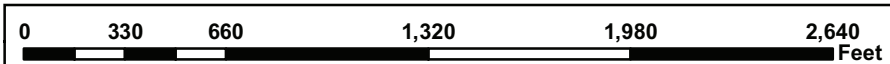

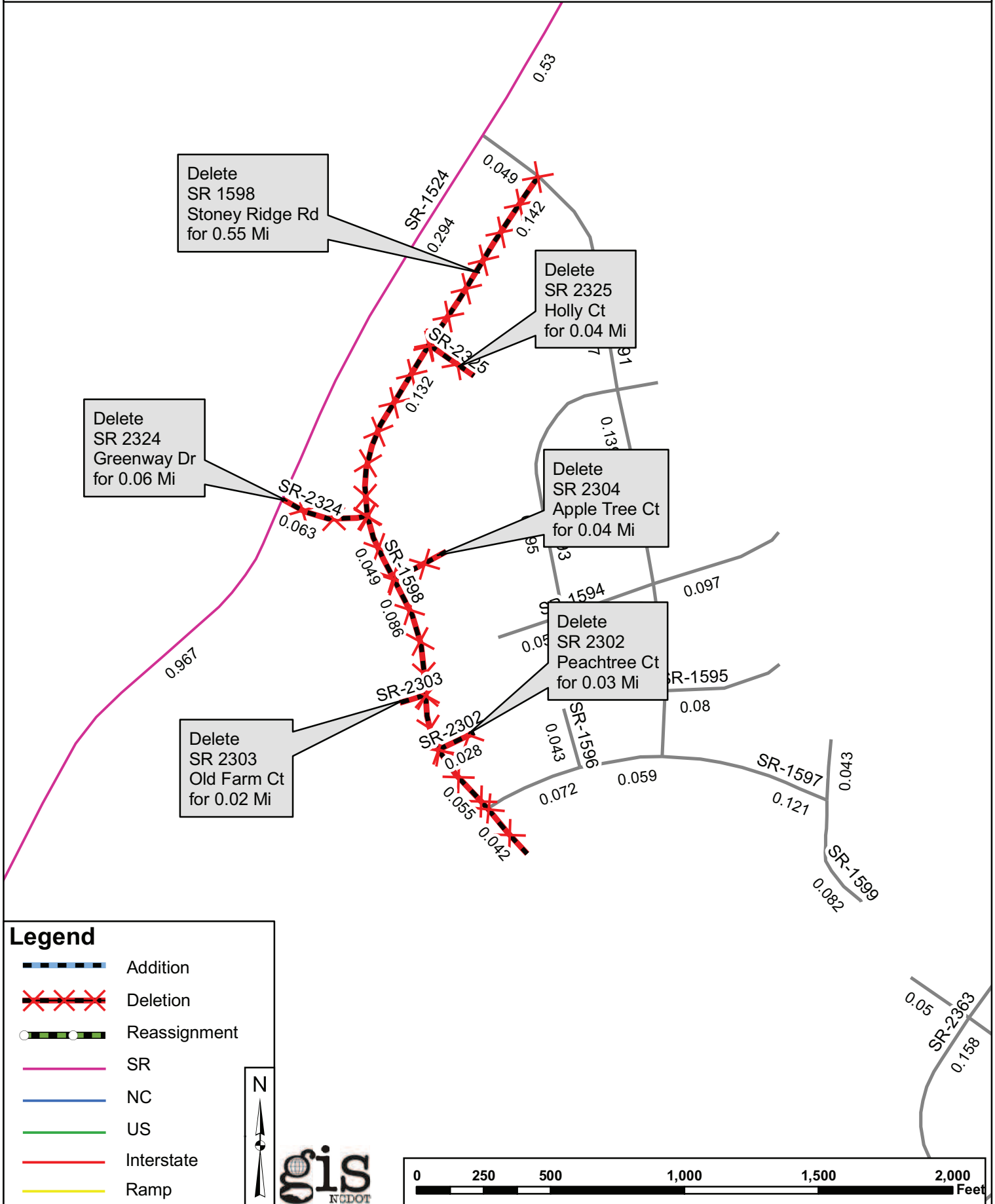

Delete  
SR 1598  
Stoney Ridge Rd  
for 0.55 Mi

Delete  
SR 2325  
Holly Ct  
for 0.04 Mi

Delete  
SR 2324  
Greenway Dr  
for 0.06 Mi

Delete  
SR 2304  
Apple Tree Ct  
for 0.04 Mi

Delete  
SR 2302  
Peachtree Ct  
for 0.03 Mi

Delete  
SR 2303  
Old Farm Ct  
for 0.02 Mi

**Legend**

-  Addition
-  Deletion
-  Reassignment
-  SR
-  NC
-  US
-  Interstate
-  Ramp

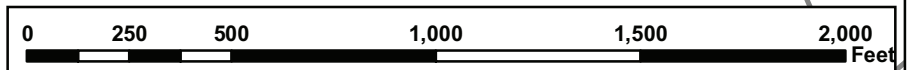



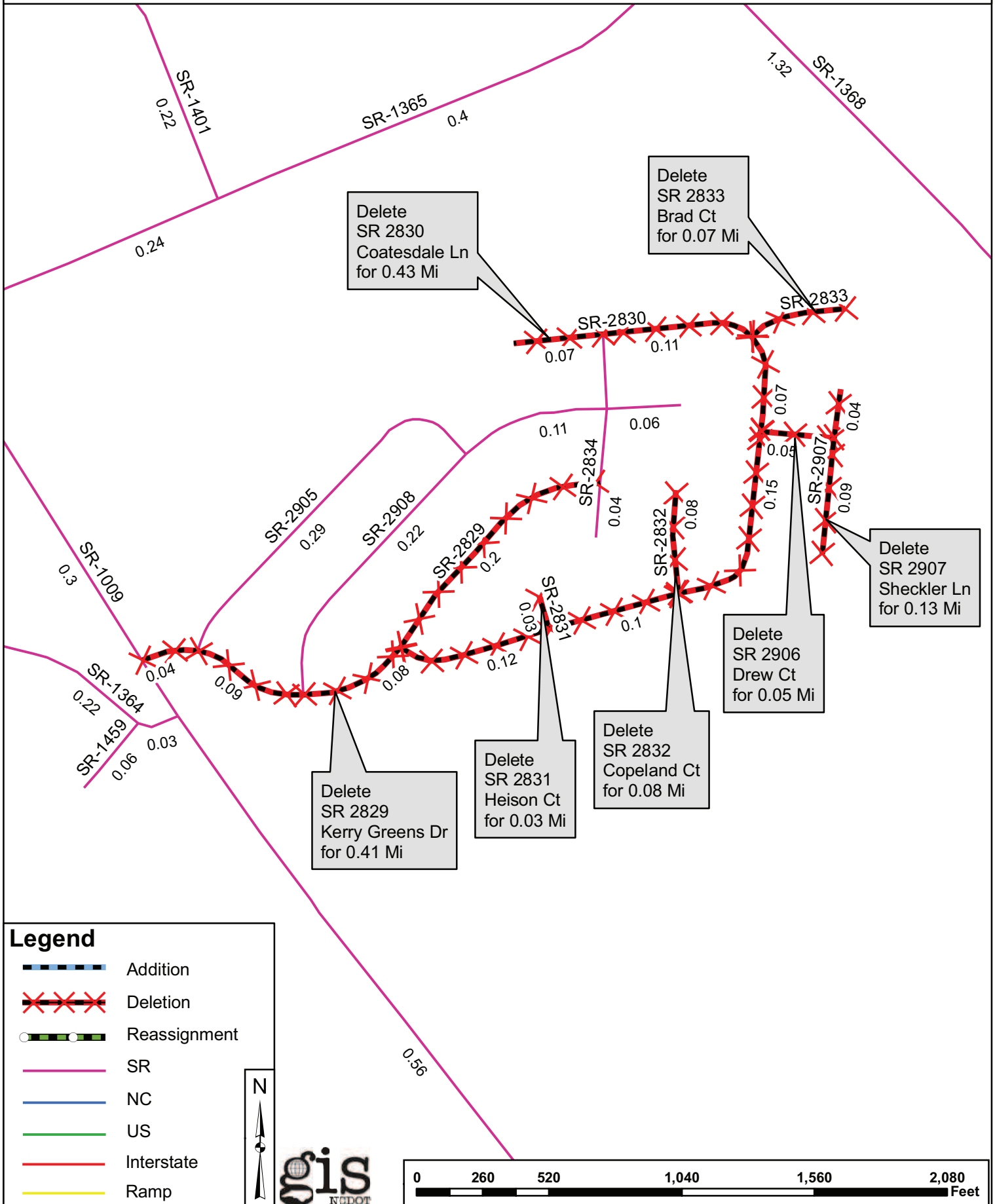



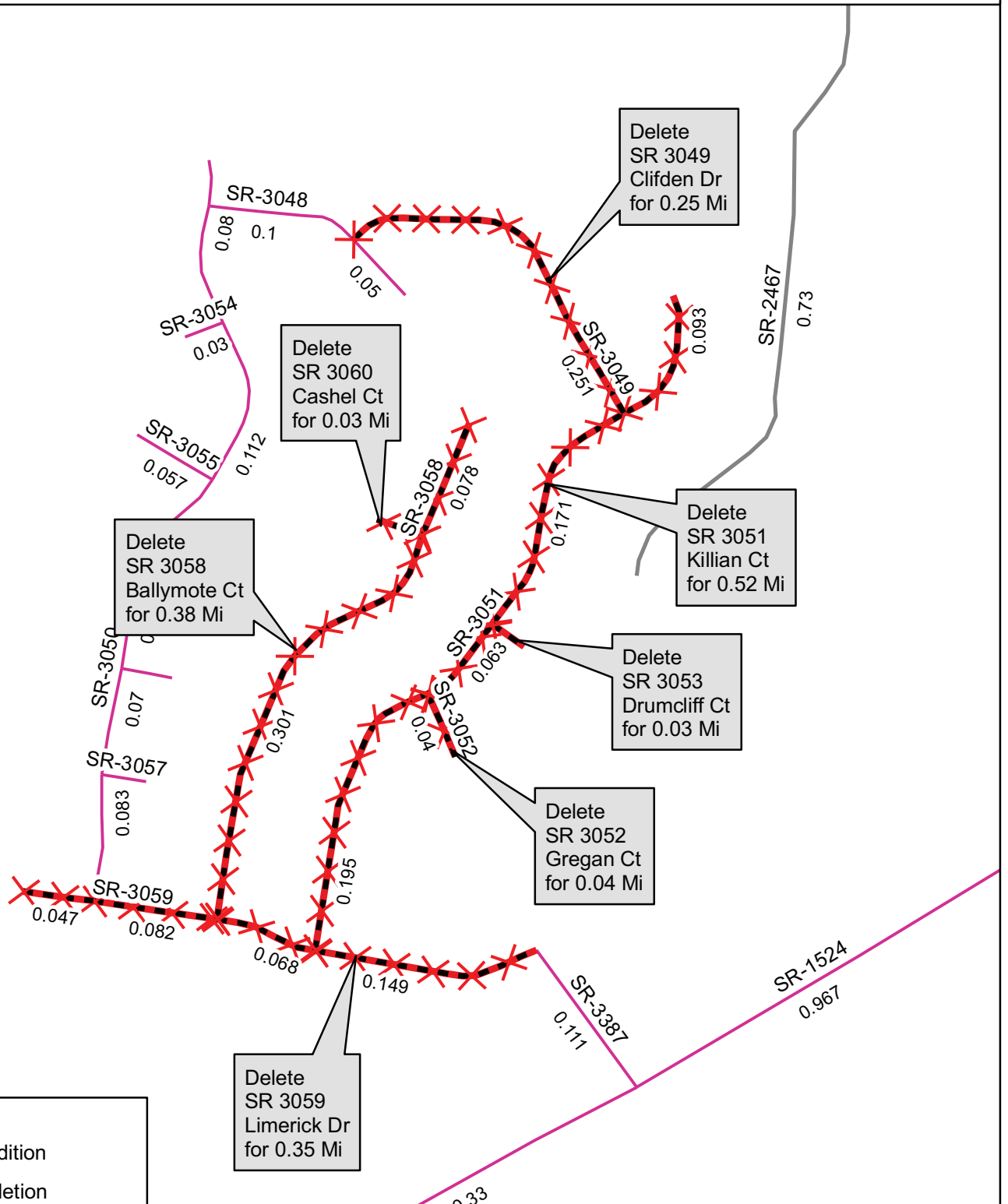

**Legend**



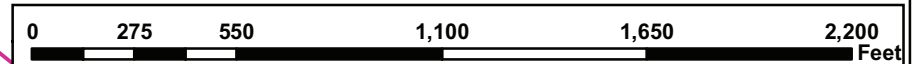

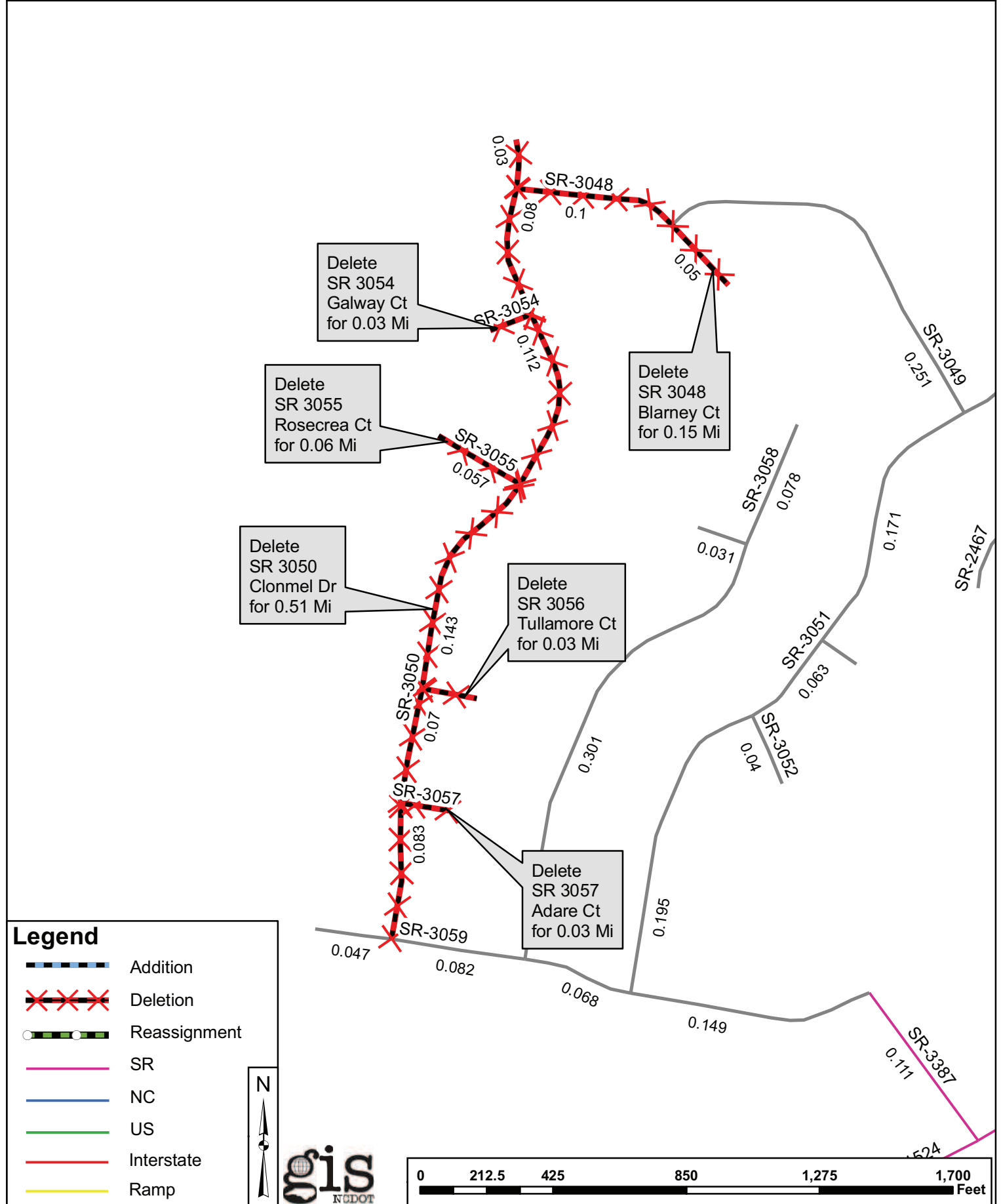

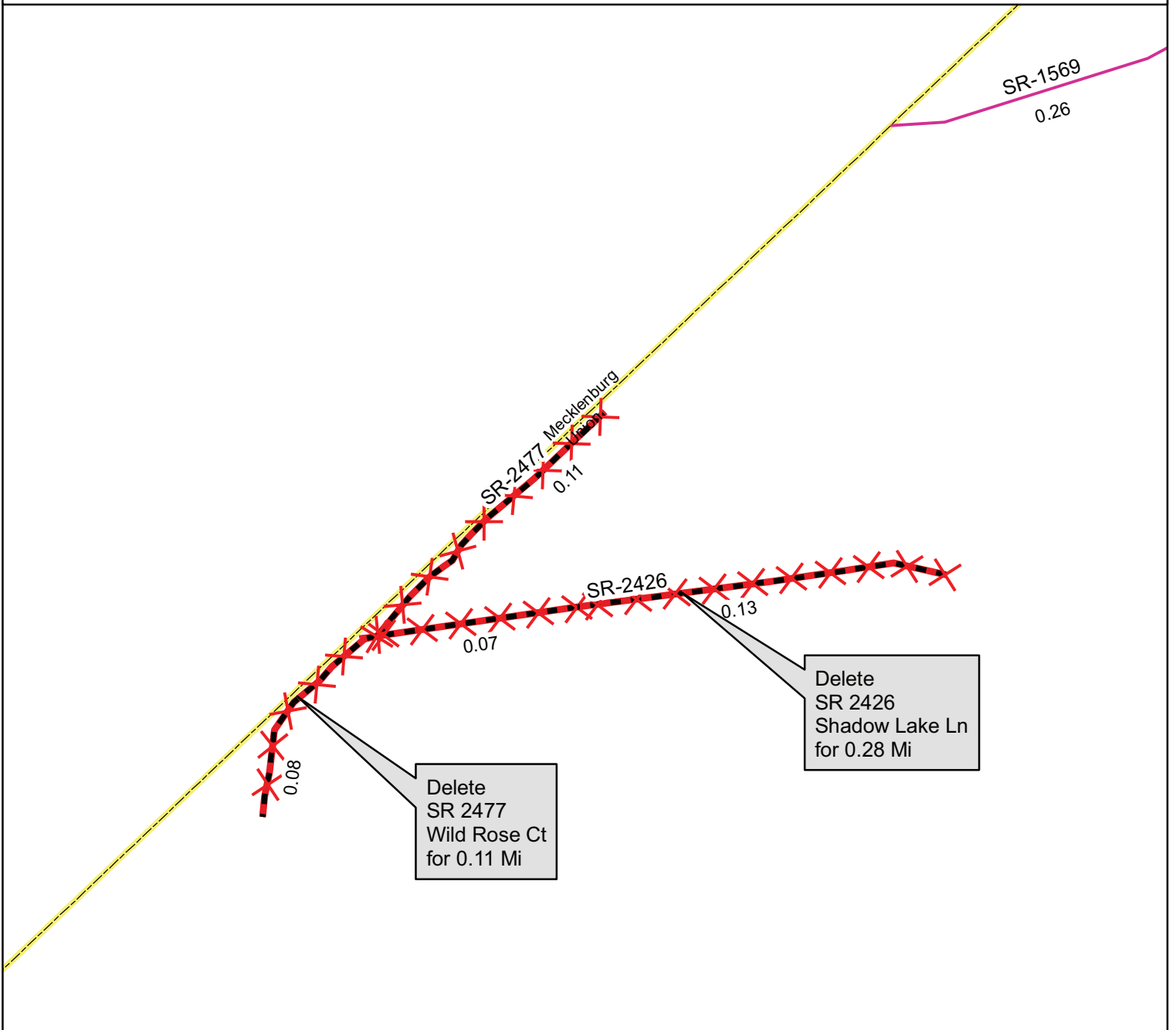

-  Addition
-  Deletion
-  Reassignment
-  SR
-  NC
-  US
-  Interstate
-  Ramp







**Legend**

-  Addition
-  Deletion
-  Reassignment
-  SR
-  NC
-  US
-  Interstate
-  Ramp
-  County Boundary

