



STATE OF NORTH CAROLINA
DEPARTMENT OF TRANSPORTATION

BEVERLY EAVES PERDUE
GOVERNOR

Tuesday, March 08, 2011

EUGENE A. CONTI, JR.
SECRETARY

MEMORANDUM TO: Mr. H. Allen Pope, PE
Division Engineer
Division 3

FROM: John C. Farley, Manager
Geographic Information Systems Unit

SUBJECT: 2011 District 1 Road System Changes

The Data Conversion Group has been authorized to make the following changes to the state road system as indicated below. We request that you make similar changes to the related maps and files in your Division and District offices, and install appropriate road number signs if necessary. we have updated our records accordingly. If our system changes do not conform to the actual conditions in the field, please return this memorandum with recommendations.

PETITION	County	Approval Date
49659	ONslow	3/3/2011

Inquiries about changes should be referred to the GIS Help Desk at (919) 707-2152.
Thank you for your assistance.

JCF

- cc: BSIP
- Bridge Maintenance
- Division Right of Way
- IMG
- Pavement Management
- Permit Unit
- State Road Maintenance
- Traffic Engineering
- Traffic Surveys

2011 ROAD SYSTEM CHANGES

PETITION	COUNTY	APPROVAL DATE	ROUTE NUMBER	PORTION REASSIGNED	STREET NAME	LENGTH (miles)	TYPE OF CHANGE	REMARKS (See Attached Map)
49659	ONSLOW	3/3/2011	SR 2194		CHERRY BLOSSOM DR	0.23	System Addition VIA PETITION	
49659	ONSLOW	3/3/2011	SR 2193		CHERRY BLOSSOM CT	0.03	System Addition VIA PETITION	
49659	ONSLOW	3/3/2011	SR 2192		CHERRY GROVE DR	0.37	System Addition VIA PETITION	

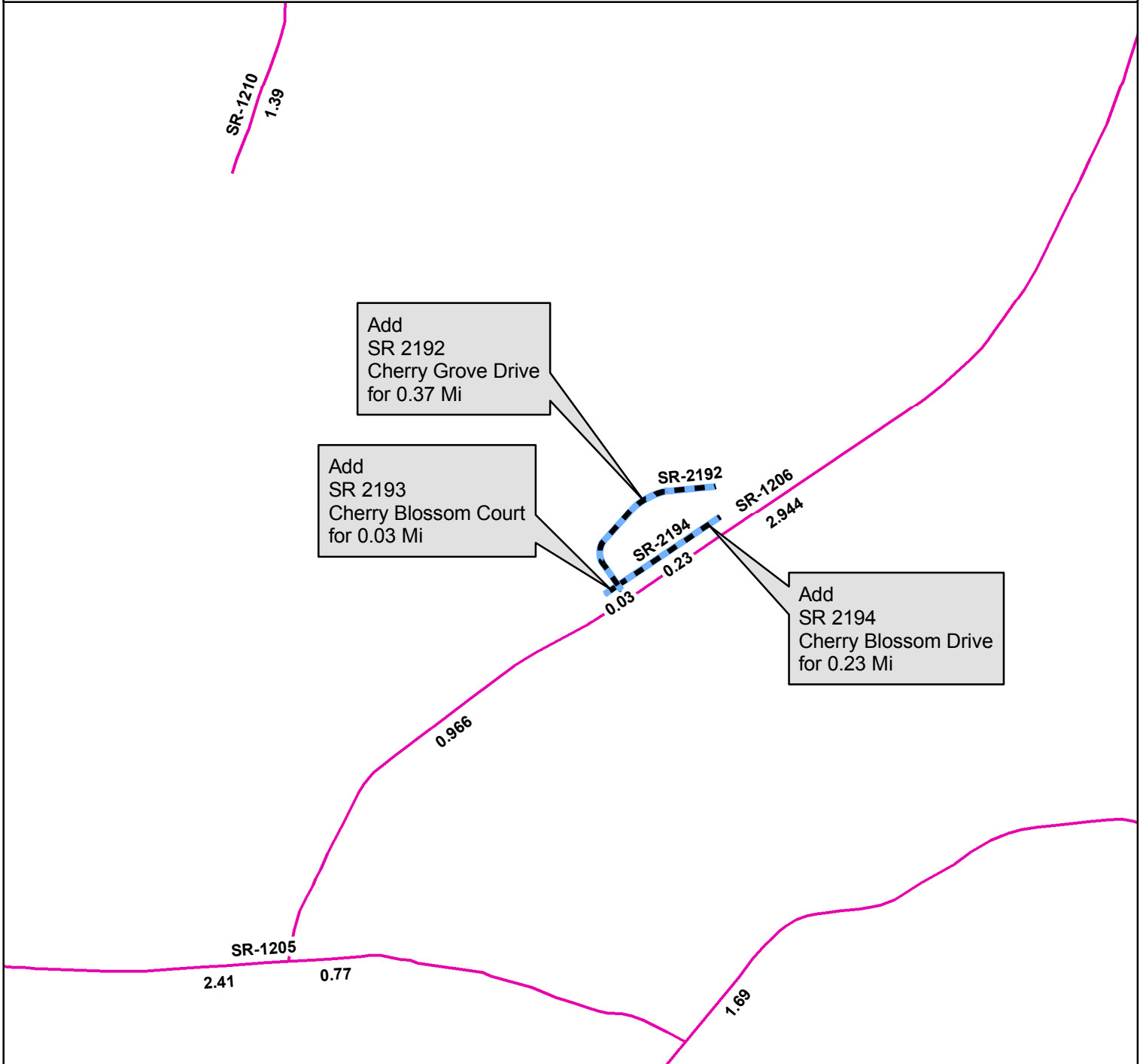









Add
SR 2192
Cherry Grove Drive
for 0.37 Mi

Add
SR 2193
Cherry Blossom Court
for 0.03 Mi

Add
SR 2194
Cherry Blossom Drive
for 0.23 Mi

Legend

-  Addition
-  Deletion
-  Reassignment
-  SR
-  NC
-  US
-  Interstate
-  Ramp

N
↑
gis
NCDOT

