



STATE OF NORTH CAROLINA
DEPARTMENT OF TRANSPORTATION

PATRICK MCCRORY
GOVERNOR

March 21, 2016

NICHOLAS J. TENNYSON
SECRETARY

MEMORANDUM TO: Mr. Mike Mills, PE
Division Engineer
Division 7

FROM: Mr. John C. Farley, GISP, CPM
Manager
Geographic Information Systems Unit

SUBJECT: 2010 District 2 Road System Changes **-REVISED**

The GIS Unit's Data Conversion Group has been authorized to make the changes indicated below to the state road system. We request that you update the related maps and files in your offices and install appropriate road number signs, if necessary. If our system changes do not conform to the actual conditions in the field, please return this memorandum with recommendations.

Petition	County	Approval Date
49591	GUILFORD	12/9/2010

Questions or comments about changes should be referred to the GIS Help Desk at GISHelp@ncdot.gov.
Thank you for your assistance.

JCF

- cc: BSIP
- Bridge Maintenance
- Division Right of Way
- IMG
- Pavement Management
- Permit Unit
- State Road Maintenance
- Traffic Engineering
- Traffic Surveys

MAILING ADDRESS:
NC DEPARTMENT OF TRANSPORTATION
GEOGRAPHIC INFORMATION SYSTEMS
1521 MAIL SERVICE CENTER
RALEIGH, NC 27699-1521



DELIVERY ADDRESS:
4101 CAPITAL BLVD.
RALEIGH, NC 27604
FAX: (919) 707-2214

2010 ROAD SYSTEM CHANGES

PETITION	COUNTY	APPROVAL DATE	ROUTE NUMBER	PORTION REASSIGNED	STREET NAME	LENGTH (miles)	TYPE OF CHANGE	REMARKS (See Attached Map)
49591	GUILFORD	12/9/2010	SR 5407		CHENAULT CT	.10	System Addition VIA PETITION	
49591	GUILFORD	12/9/2010	SR 5406		PAVILION CT	.29	System Addition VIA PETITION	
49591	GUILFORD	12/9/2010	SR 5405		TRANSON CT	.05	System Addition VIA PETITION	
49591	GUILFORD	12/9/2010	SR 5404		COLLONADE CT	.06	System Addition VIA PETITION	
49591	GUILFORD	12/9/2010	SR 5403		BUCKMINSTER DR	.18	System Addition VIA PETITION	
49591	GUILFORD	12/9/2010	SR 5402		RESERVE PRKWY	.49	System Addition VIA PETITION	
49591	GUILFORD	12/9/2010	SR 3098		ABERNATHY RD EXTENSION	.05	System Addition VIA PETITION	

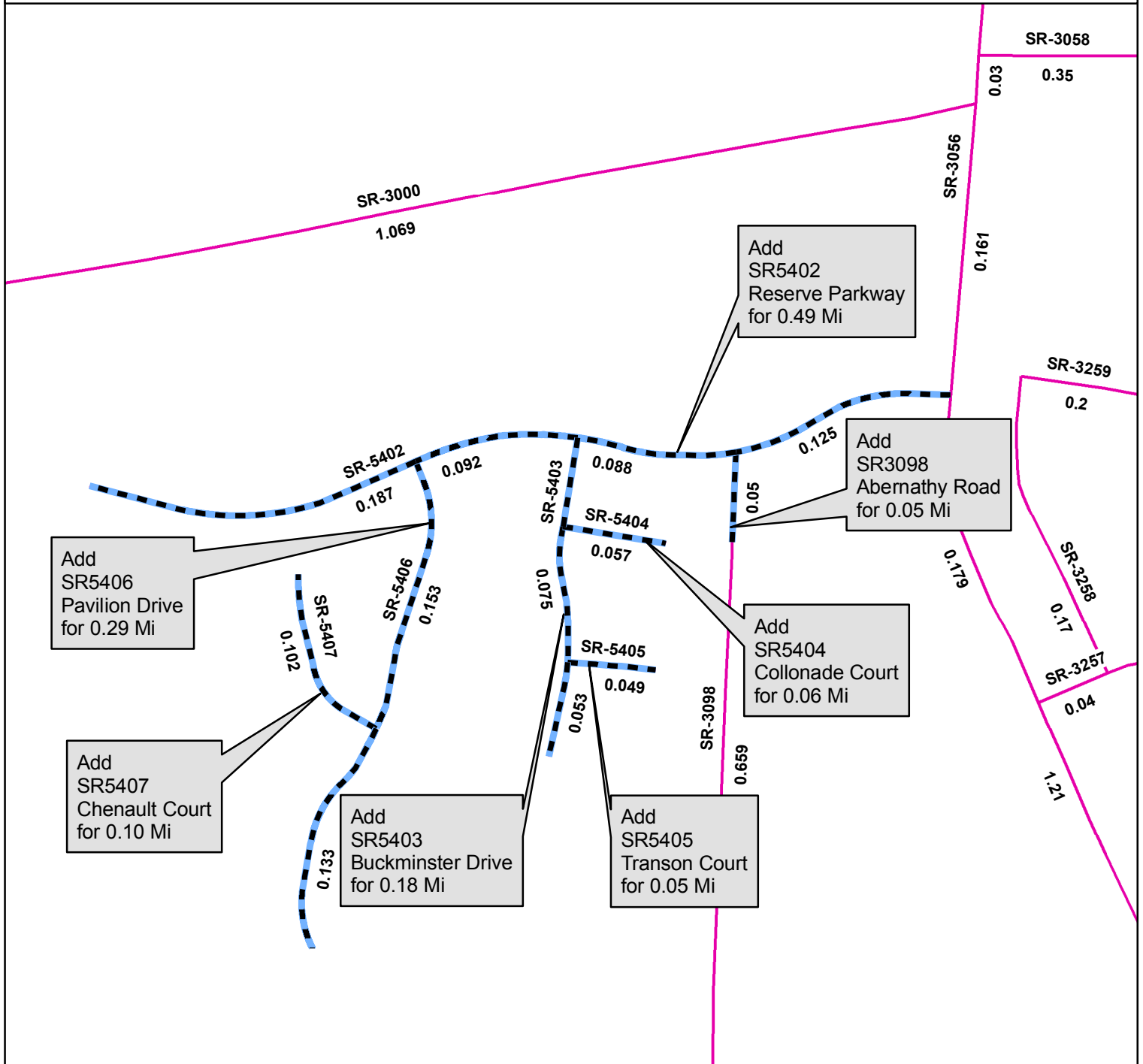

Legend

-  Addition
-  Deletion
-  Reassignment
-  SR
-  NC
-  US
-  Interstate
-  Ramp

