



STATE OF NORTH CAROLINA  
DEPARTMENT OF TRANSPORTATION

BEVERLY EAVES PERDUE  
GOVERNOR

Monday, November 08, 2010

EUGENE A. CONTI, JR.  
SECRETARY

**MEMORANDUM TO:** Mr. H. Allen Pope, PE  
Division Engineer  
Division 3

**FROM:** John C. Farley, Manager  
Geographic Information Systems Unit

**SUBJECT:** 2010 District 1 Road Sytem Changes

The Data Conversion Group has been authorized to make the following changes to the state road system as indicated below. We request that you make similar changes to the related maps and files in your Division and District offices, and install appropriate road number signs if necessary. we have updated our records accordingly. If our system changes do not conform to the actual conditions in the field, please return this memorandum with recommendations.

Correction Number	County	Approval Date
COR_70_11-10_1	PENDER	11/4/2010

Inquiries about changes should be referred to the GIS Help Desk at (919) 707-2152.  
Thank you for your assistance.

JCF

cc: BSIP  
Bridge Maintenance  
Division Right of Way  
IMG  
Pavement Management  
Permit Unit  
State Road Maintenance  
Traffic Engineering  
Traffic Surveys

**MAILING ADDRESS:**  
NC DEPARTMENT OF TRANSPORTATION  
GEOGRAPHIC INFORMATION SYSTEMS  
1521 MAIL SERVICE CENTER  
RALEIGH NC 27699-1521

**gis**  
NCDOT  
WWW.NCDOT.ORG/IT/GIS

**Delivery Address:**  
4101 CAPITAL BLVD.  
RALEIGH, NC 27604  
PHONE: (919) 707-2152  
FAX: (919) 707-2214

---

# 2010 ROAD SYSTEM CHANGES





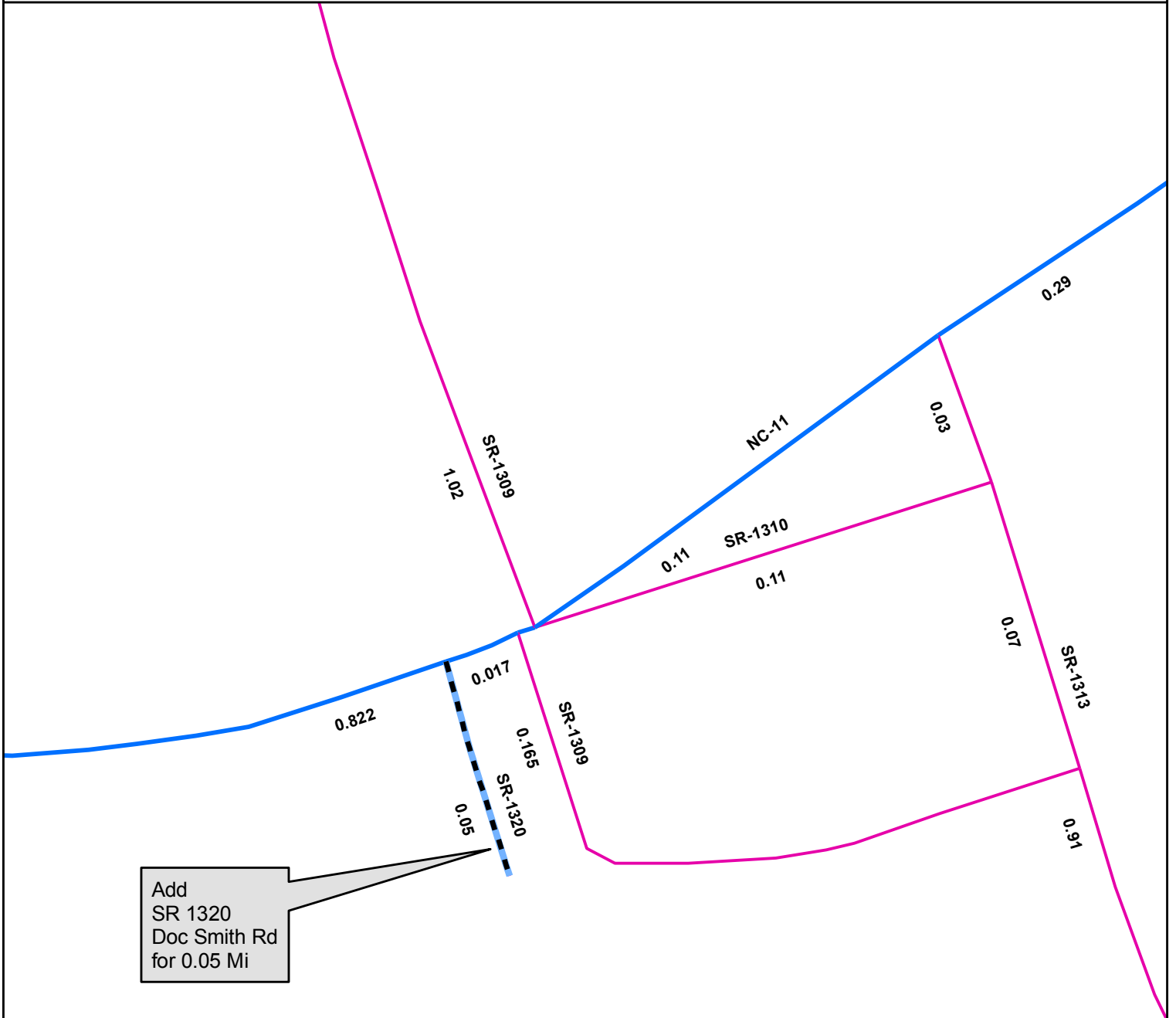

---

<b>CORRECTION NUMBER</b>	<b>COUNTY</b>	<b>APPROVAL DATE</b>	<b>NEW NUMBER</b>	<b>EXISTING NUMBER</b>	<b>STREET NAME</b>	<b>LENGTH (miles)</b>	<b>TYPE OF CHANGE</b>	<b>REMARKS (See Attached Map)</b>
COR_70_11-10_1	PENDER	11/4/2010		SR 1320	DOC SMITH RD	0.05	SYSTEM ADDITION - EXISTING VIA CORRECTION REQUEST	MAP , SEGMENT



Add  
SR 1320  
Doc Smith Rd  
for 0.05 Mi

### Legend

-  Addition
-  Deletion
-  Reassignment
-  SR
-  NC
-  US
-  Interstate
-  Ramp

