



STATE OF NORTH CAROLINA
DEPARTMENT OF TRANSPORTATION

BEVERLY EAVES PERDUE
GOVERNOR

Tuesday, September 07, 2010

EUGENE A. CONTI, JR.
SECRETARY

MEMORANDUM TO: Mr. Michael L. Holder, PE
Division Engineer
Division 12

FROM: John C. Farley, Manager
Geographic Information Systems Unit

SUBJECT: 2010 District 1 Road System Changes

The Data Conversion Group has been authorized to make the following changes to the state road system as indicated below. We request that you make similar changes to the related maps and files in your Division and District offices, and install appropriate road number signs if necessary. we have updated our records accordingly. If our system changes do not conform to the actual conditions in the field, please return this memorandum with recommendations.

PETITION	County	Approval Date
49521	CLEVELAND	9/2/2010

Inquiries about changes should be referred to the GIS Help Desk at (919) 707-2152.
Thank you for your assistance.

JCF

- cc: BSIP
- Bridge Maintenance
- Division Right of Way
- IMG
- Pavement Management
- Permit Unit
- State Road Maintenance
- Traffic Engineering
- Traffic Surveys

2010 ROAD SYSTEM CHANGES

PETITION	COUNTY	APPROVAL DATE	ROUTE NUMBER	PORTION REASSIGNED TO	STREET NAME	LENGTH (miles)	TYPE OF CHANGE	REMARKS (See Attached Map)
49521	CLEVELAND	9/2/2010	SR 2694		LAUREL RIDGE DR	.32	System Addition VIA PETITION	
49521	CLEVELAND	9/2/2010	SR 2693		RIDGE CT	.08	System Addition VIA PETITION	
49521	CLEVELAND	9/2/2010	SR 2692		LAUREL COVE CT	.05	System Addition VIA PETITION	
49521	CLEVELAND	9/2/2010	SR 2691		RIDGECREST DR	.35	System Addition VIA PETITION	
49521	CLEVELAND	9/2/2010	SR 2690		LAKEFIELD CT	.06	System Addition VIA PETITION	
49521	CLEVELAND	9/2/2010	SR 2689		POINTE COVE CT	.08	System Addition VIA PETITION	

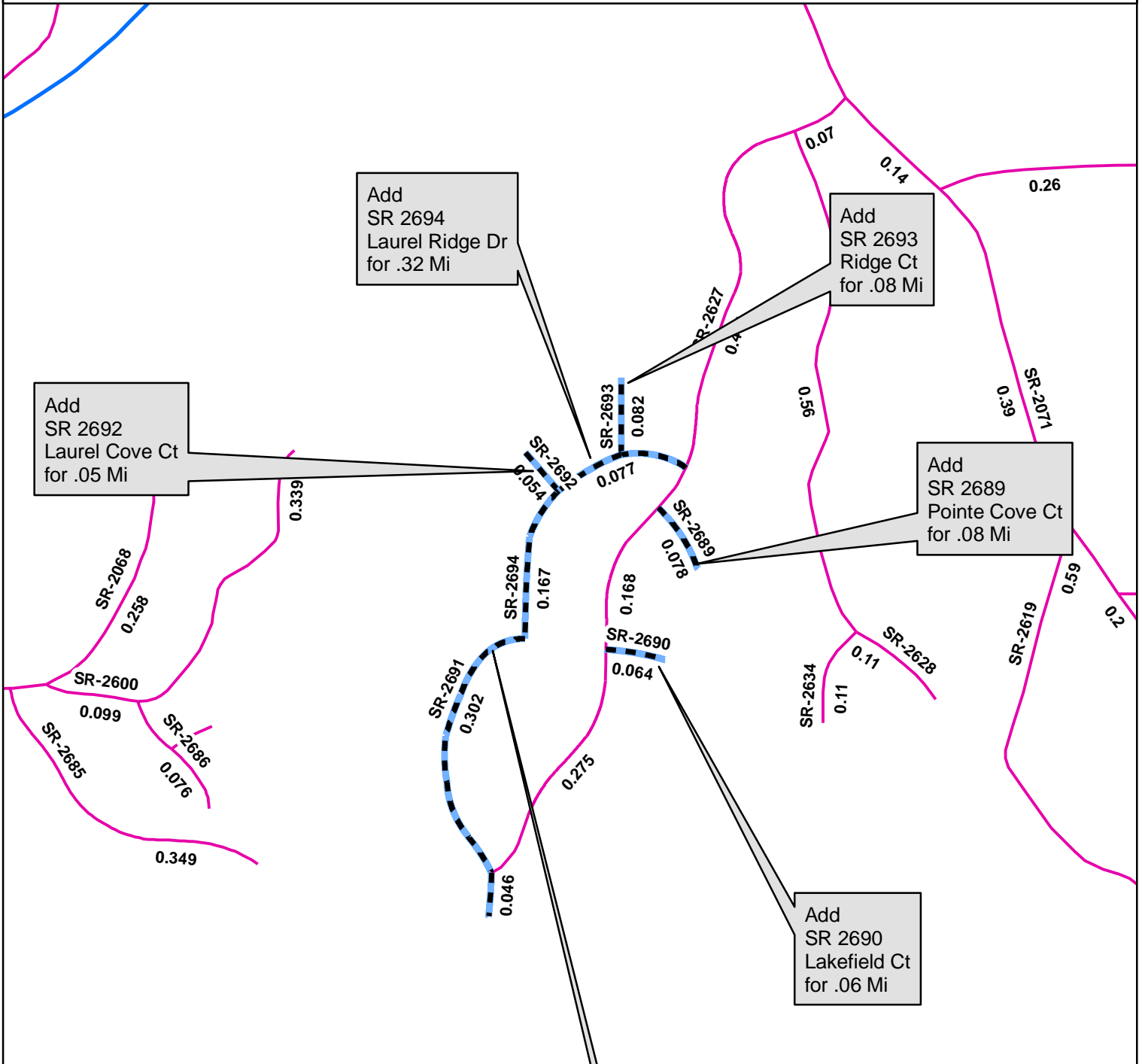

Legend

- Addition
- Deletion
- Reassignment
- SR
- NC
- US
- Interstate
- Ramp

N

gis
NCDOT

