



STATE OF NORTH CAROLINA  
DEPARTMENT OF TRANSPORTATION

BEVERLY EAVES PERDUE  
GOVERNOR

Friday, August 19, 2011

EUGENE A. CONTI, JR.  
SECRETARY

**MEMORANDUM TO:** Mr. Barry Moose, PE  
Division Engineer  
Division 10

**FROM:** John C. Farley, Manager  
Geographic Information Systems Unit

**SUBJECT:** 2011 District 1 Road System Changes

The Data Conversion Group has been authorized to make the following changes to the state road system as indicated below. We request that you make similar changes to the related maps and files in your Division and District offices, and install appropriate road number signs if necessary. We have updated our records accordingly. If our system changes do not conform to the actual conditions in the field, please return this memorandum with recommendations.

Document Number	County	Approval Date
U-3300B	STANLY	9/1/2010

Inquiries about changes should be referred to the GIS Help Desk at (919) 707-2152.  
Thank you for your assistance.

JCF

cc: BSIP  
Bridge Maintenance  
Division Right of Way  
IMG  
Pavement Management  
Permit Unit  
State Road Maintenance  
Traffic Engineering  
Traffic Surveys

**MAILING ADDRESS:**  
NC DEPARTMENT OF TRANSPORTATION  
GEOGRAPHIC INFORMATION SYSTEMS  
1521 MAIL SERVICE CENTER  
RALEIGH NC 27699-1521

**gis**  
NCDOT  
WWW.NC DOT.ORG/IT/GIS

**Delivery Address:**  
41 01 CAPITAL BLVD.  
RALEIGH, NC 27604  
PHONE: (919) 707-2152  
FAX: (919) 707-2214

# 2011 ROAD SYSTEM CHANGES

TIP	COUNTY	APPROVAL DATE	NEW ROUTE	EXISTING ROUTE	STREET NAME	LENGTH (miles)	TYPE OF CHANGE	REMARKS (See Attached Map)
U-3300B	STANLY	9/1/2010	SR 1656	SR 1542	GOOD RD	0.15	REASSIGNMENT VIA TIP	MAP , SEGMENT
U-3300B	STANLY	9/1/2010	SR 1655	SR 1542	RED BIRD RD	0.10	REASSIGNMENT VIA TIP	MAP , SEGMENT
U-3300B	STANLY	9/1/2010		SR 1549	AIRPORT RD	0.19	SYSTEM ADDITION - EXISTING VIA TIP	MAP , SEGMENT
U-3300B	STANLY	9/1/2010		SR 1542	RIDGE ST	1.12	SYSTEM ADDITION - EXISTING VIA TIP	MAP , SEGMENT
U-3300B	STANLY	9/1/2010	SR 1655		RED BIRD RD	0.05	SYSTEM ADDITION - NEW VIA TIP	MAP , SEGMENT
U-3300B	STANLY	9/1/2010		SR 1549	AIRPORT RD	0.18	SYSTEM DELETION VIA TIP	MAP , SEGMENT
U-3300B	STANLY	9/1/2010		SR 1542	RIDGE ST	0.14	SYSTEM DELETION VIA TIP	MAP , SEGMENT

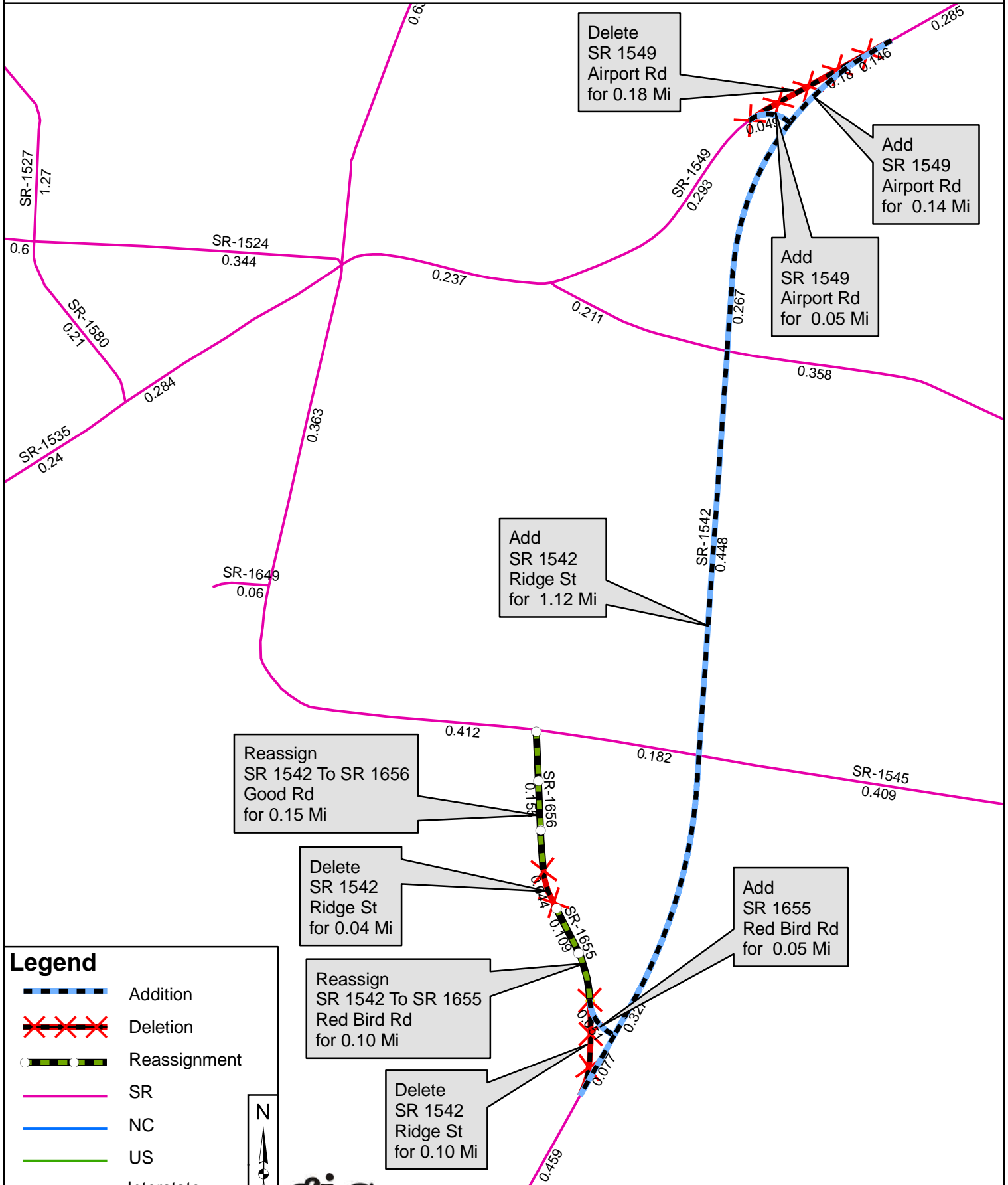

Delete SR 1549 Airport Rd for 0.18 Mi

Add SR 1549 Airport Rd for 0.14 Mi

Add SR 1549 Airport Rd for 0.05 Mi

Add SR 1542 Ridge St for 1.12 Mi

Reassign SR 1542 To SR 1656 Good Rd for 0.15 Mi

Delete SR 1542 Ridge St for 0.04 Mi

Add SR 1655 Red Bird Rd for 0.05 Mi

Reassign SR 1542 To SR 1655 Red Bird Rd for 0.10 Mi

Delete SR 1542 Ridge St for 0.10 Mi

**Legend**

- Addition
- Deletion
- Reassignment
- SR
- NC
- US
- Interstate
- Ramp

N

