



STATE OF NORTH CAROLINA  
DEPARTMENT OF TRANSPORTATION

BEVERLY EAVES PERDUE  
GOVERNOR

Wednesday, June 09, 2010

EUGENE A. CONTI, JR.  
SECRETARY

**MEMORANDUM TO:** Mr. J. Wally Bowman, PE  
Division Engineer  
Division 5

**FROM:** John C. Farley, Manager  
Geographic Information Systems Unit

**SUBJECT:** 2010 District 1 Road System Changes

The Data Conversion Group has been authorized to make the following changes to the state road system as indicated below. We request that you make similar changes to the related maps and files in your Division and District offices, and install appropriate road number signs if necessary. we have updated our records accordingly. If our system changes do not conform to the actual conditions in the field, please return this memorandum with recommendations.

MUNICIPAL	County	Approval Date
CARY	WAKE	6/3/2010

Inquiries about changes should be referred to the GIS Help Desk at (919) 707-2152.  
Thank you for your assistance.

JCF

- cc: BSIP
- Bridge Maintenance
- Division Right of Way
- IMG
- Pavement Management
- Permit Unit
- State Road Maintenance
- Traffic Engineering
- Traffic Surveys

# 2010 ROAD SYSTEM CHANGES

MUNICIPAL	COUNTY	APPROVAL DATE	ROUTE NUMBER	PORTION REASSIGNED TO	STREET NAME	LENGTH (miles)	TYPE OF CHANGE	REMARKS (See Attached Map)
CARY	WAKE	6/3/2010	SR 1349		DILLARD DR EXTENSION	0.99	System Addition VIA MUNICIPAL	MAP A, SEGMENT
CARY	WAKE	6/3/2010	SR 1653		EVANS RD EXTENSION	1.14	System Addition VIA MUNICIPAL	MAP C, SEGMENT
CARY	WAKE	6/3/2010	SR 3122		LOUIS STEPHENS DR	0.80	System Addition VIA MUNICIPAL	MAP D, SEGMENT
CARY	WAKE	6/3/2010	SR 3977		SW CARY PARKWAY EXTENSION	4.88	System Addition VIA MUNICIPAL	MAP E, SEGMENT
CARY	WAKE	6/3/2010	SR 3977		SE CARY PARKWAY EXTENSION	1.22	System Addition VIA MUNICIPAL	MAP A, SEGMENT
CARY	WAKE	6/3/2010	SR 4067		REGENCY PARKWAY EXTENSION	0.66	System Addition VIA MUNICIPAL	MAP B, SEGMENT
CARY	WAKE	6/3/2010	SR 4067		EDERLEE DR EXTENSION	0.60	System Addition VIA MUNICIPAL	MAP B, SEGMENT

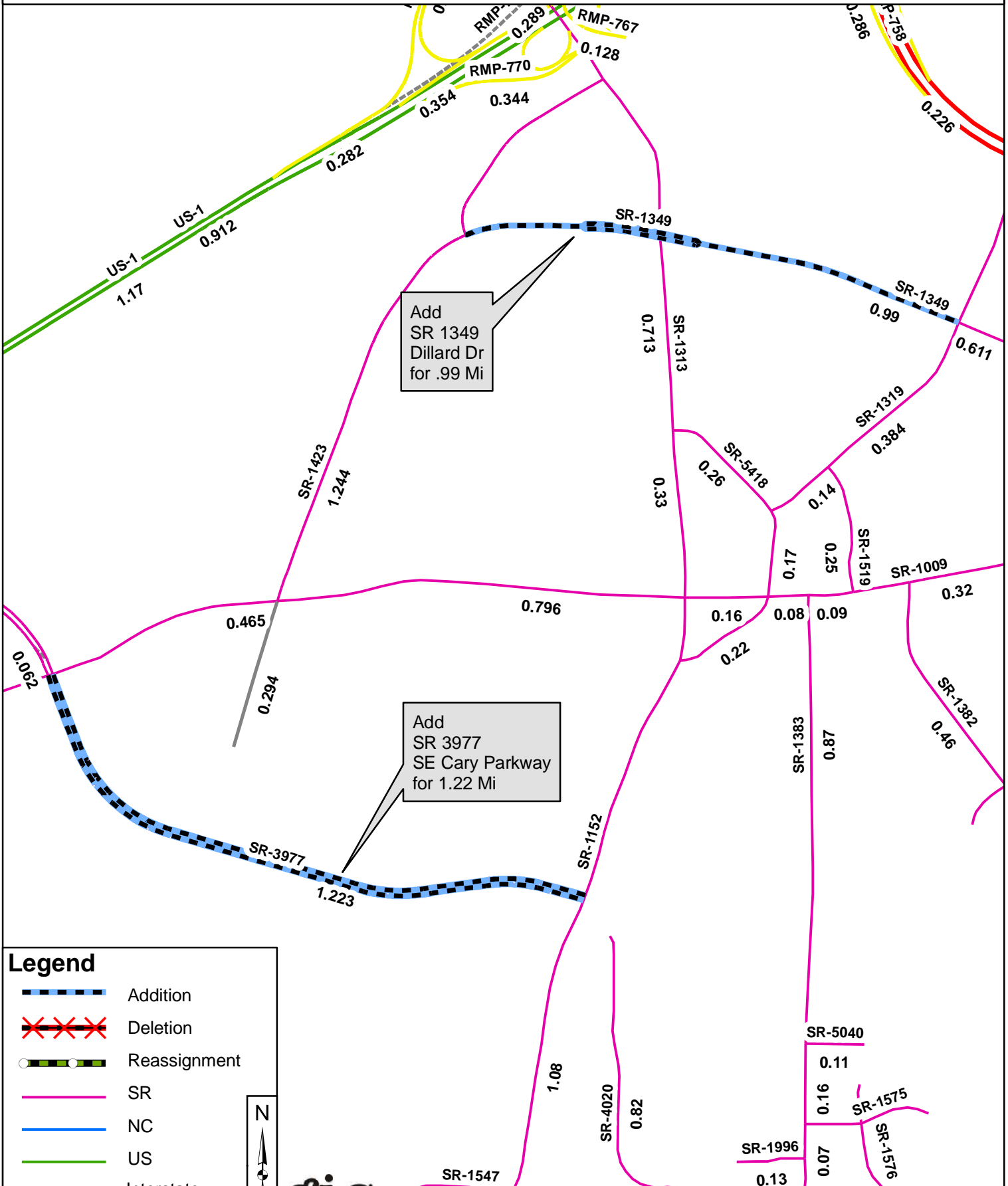

**Legend**

- Addition
- Deletion
- Reassignment
- SR
- NC
- US
- Interstate
- Ramp



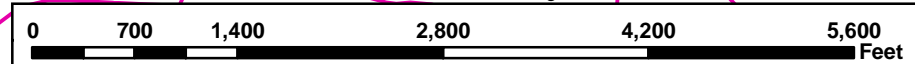

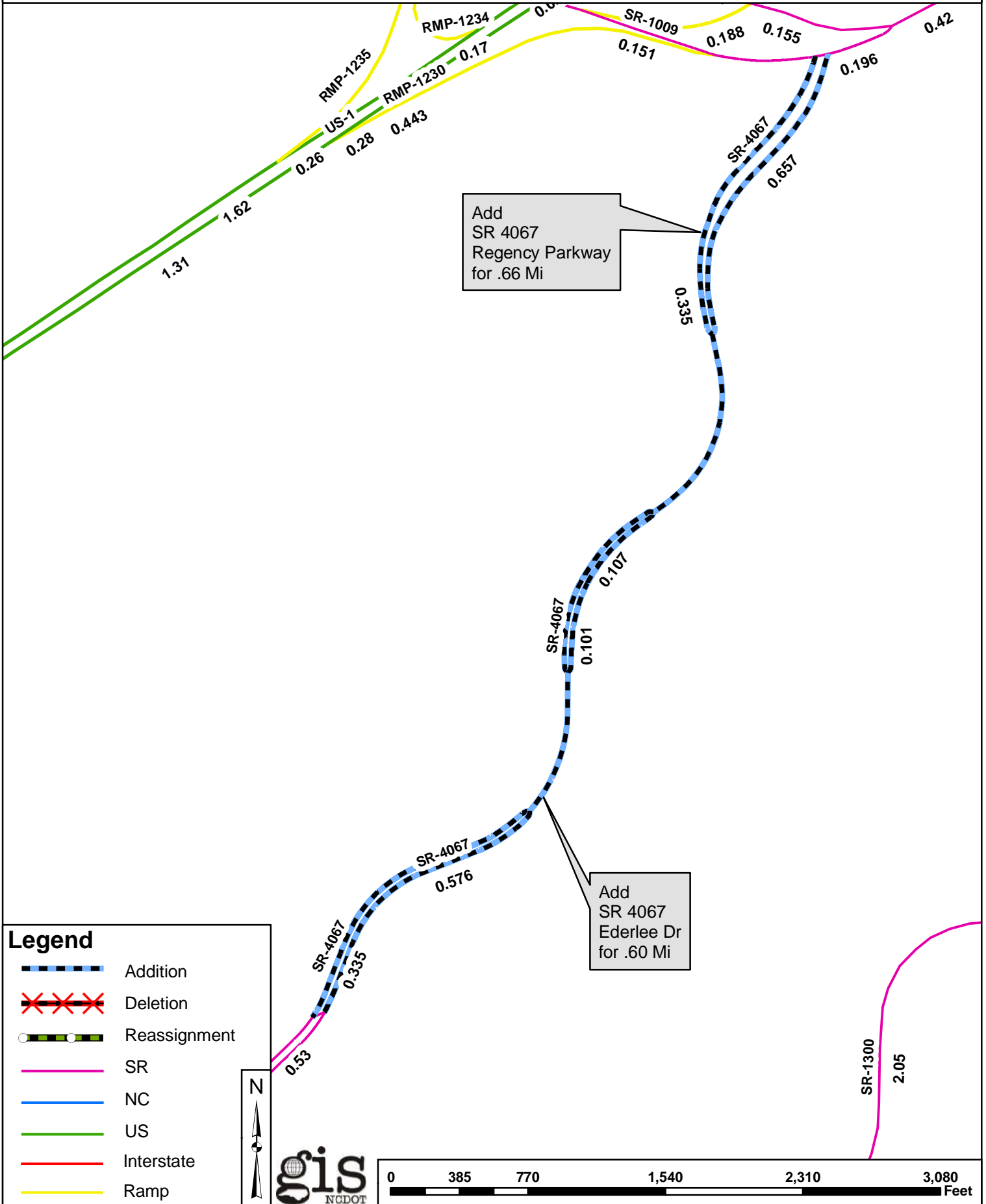
N

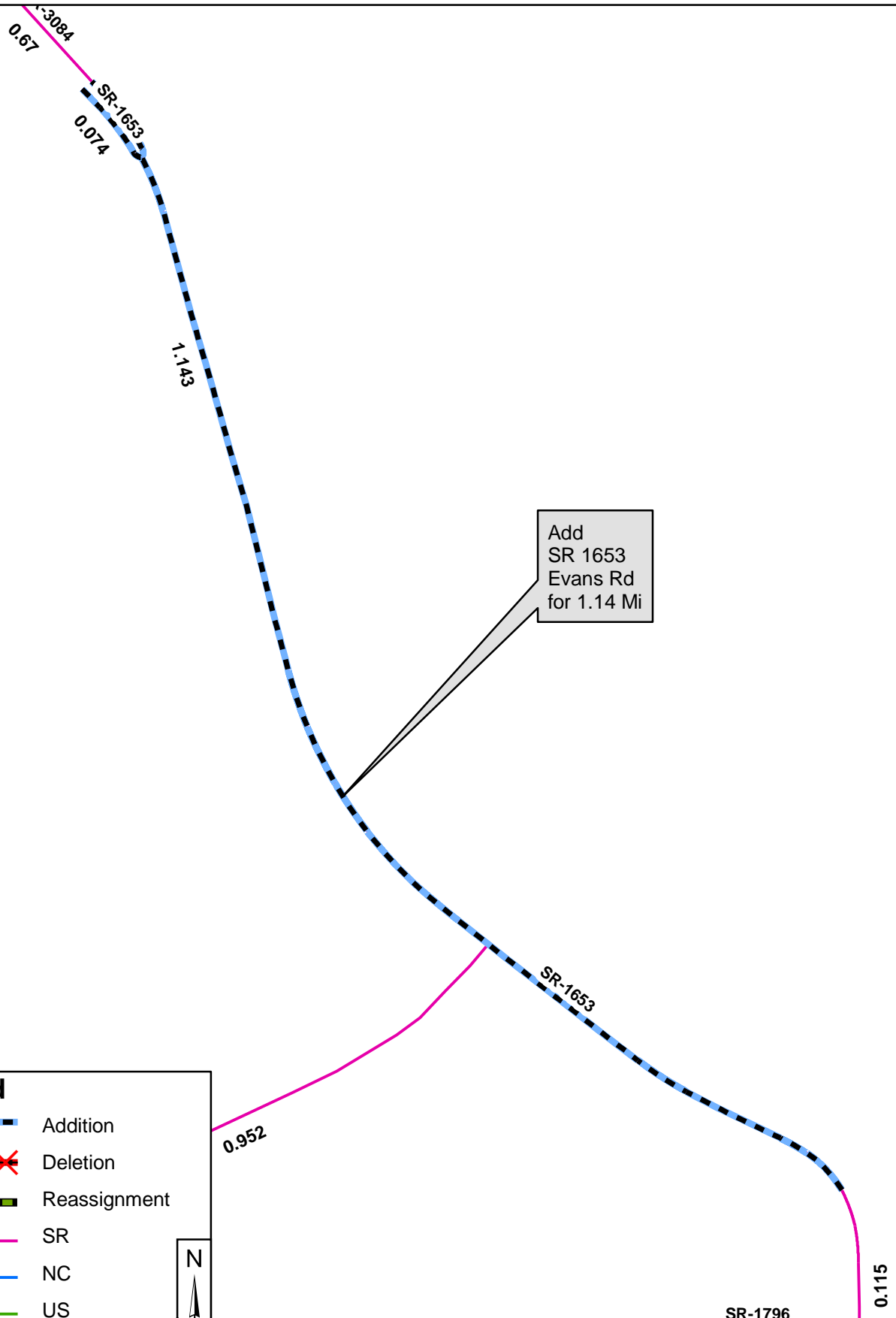









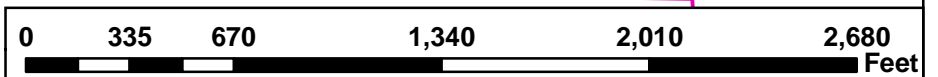

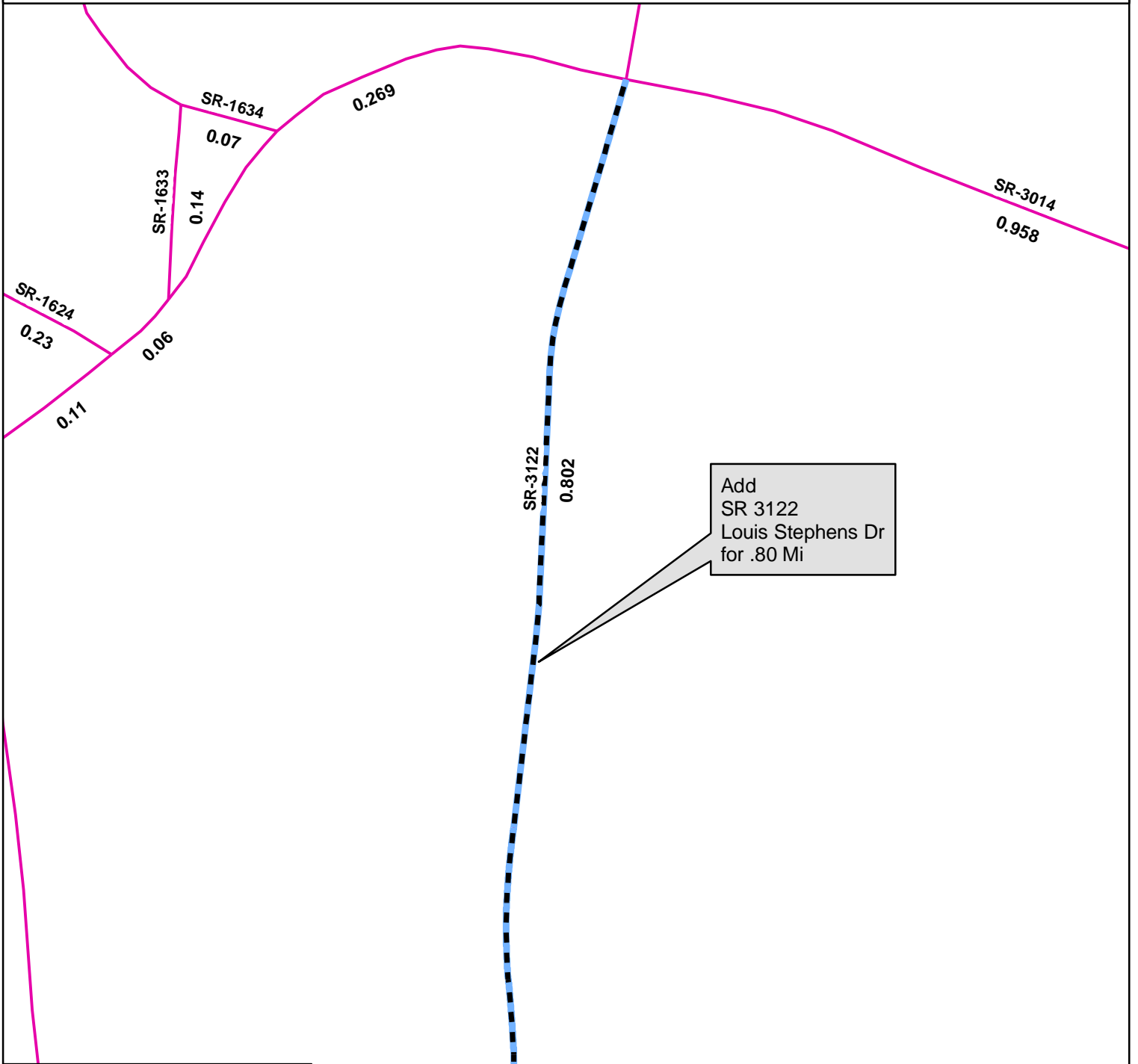

**Legend**

-  Addition
-  Deletion
-  Reassignment
-  SR
-  NC
-  US
-  Interstate
-  Ramp





**Legend**

-  Addition
-  Deletion
-  Reassignment
-  SR
-  NC
-  US
-  Interstate
-  Ramp

N

