



STATE OF NORTH CAROLINA
DEPARTMENT OF TRANSPORTATION

BEVERLY EAVES PERDUE
GOVERNOR

Tuesday, September 21, 2010

EUGENE A. CONTI, JR.
SECRETARY

MEMORANDUM TO: Mr. H. Allen Pope, PE
Division Engineer
Division 3

FROM: John C. Farley, Manager
Geographic Information Systems Unit

SUBJECT: 2010 District 3 Road System Changes

The Data Conversion Group has been authorized to make the following changes to the state road system as indicated below. We request that you make similar changes to the related maps and files in your Division and District offices, and install appropriate road number signs if necessary. we have updated our records accordingly. If our system changes do not conform to the actual conditions in the field, please return this memorandum with recommendations.

MUNICIPAL	County	Approval Date
WILMINGTON	NEW HANOVER	6/30/2010

Inquiries about changes should be referred to the GIS Help Desk at (919) 707-2152.
Thank you for your assistance.

JCF

- cc: BSIP
- Bridge Maintenance
- Division Right of Way
- IMG
- Pavement Management
- Permit Unit
- State Road Maintenance
- Traffic Engineering
- Traffic Surveys

2010 ROAD SYSTEM CHANGES

MUNICIPAL	COUNTY	APPROVAL DATE	ROUTE NUMBER	PORTION REASSIGNED TO	STREET NAME	LENGTH (miles)	TYPE OF CHANGE	REMARKS (See Attached Map)
WILMINGTON	NEW HANOVER	6/30/2010	SR 1492		PINE GROVE DR / MASONBORO LOOP RD	2.66	System Deletion VIA MUNICIPAL	MAP B, SEGMENT
WILMINGTON	NEW HANOVER	6/30/2010	SR 2251		BARCLAY HILLS DR	0.11	System Deletion VIA MUNICIPAL	MAP C, SEGMENT
WILMINGTON	NEW HANOVER	6/30/2010	SR 2814		N. 4TH ST	0.06	System Deletion VIA MUNICIPAL	MAP A, SEGMENT
WILMINGTON	NEW HANOVER	6/30/2010	SR 2815		N. FRONT ST	0.05	System Deletion VIA MUNICIPAL	MAP A, SEGMENT

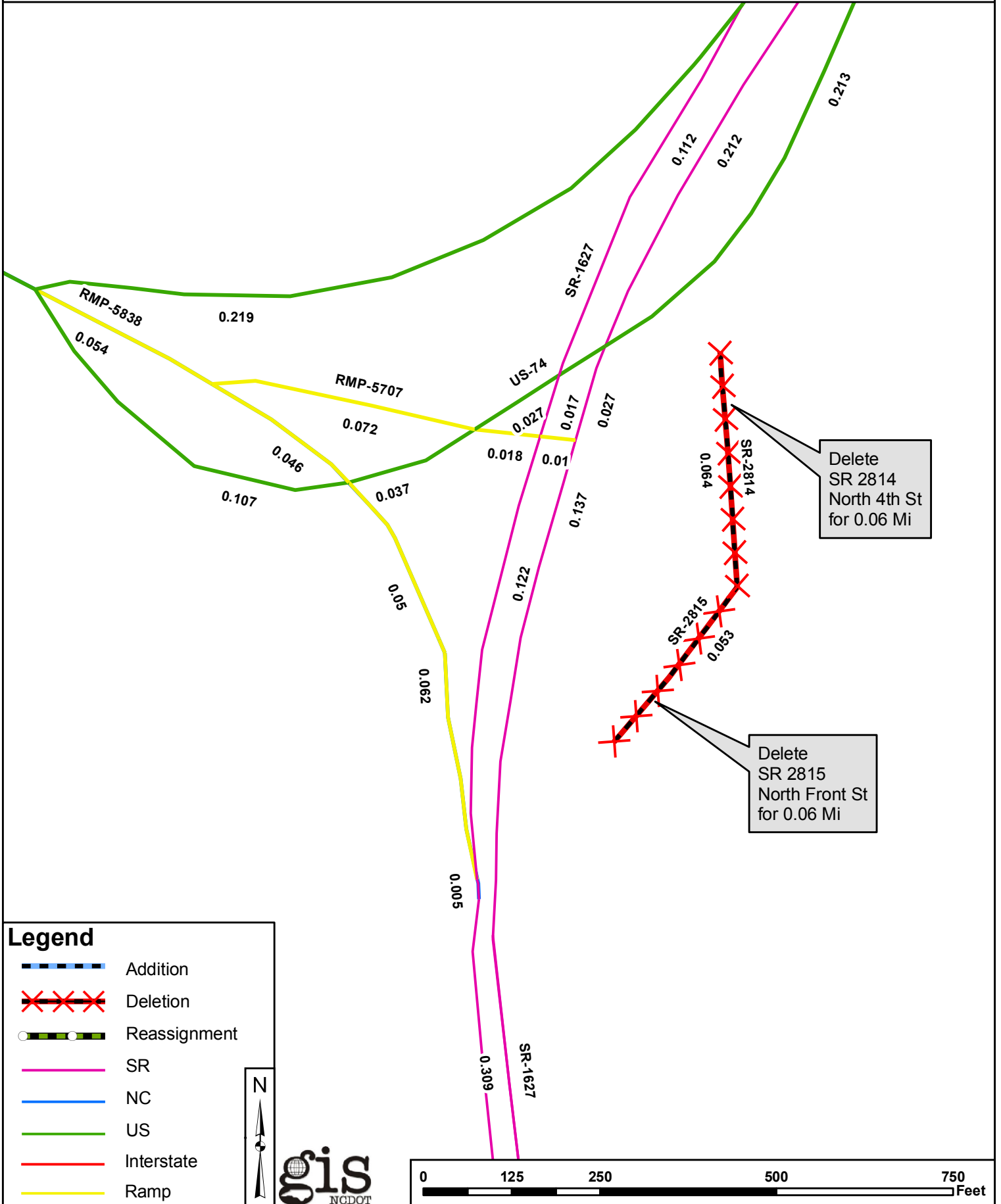

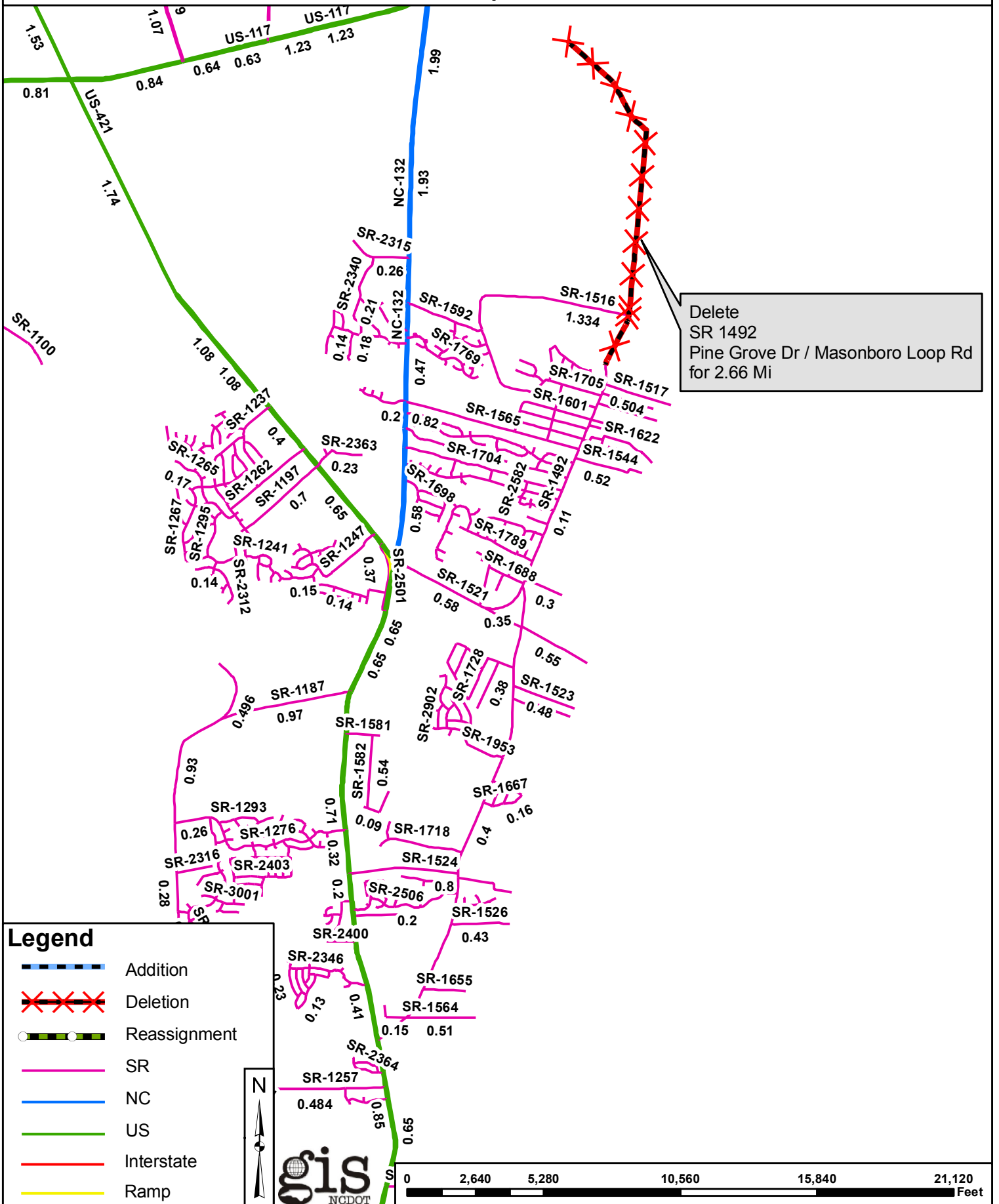

Map: B

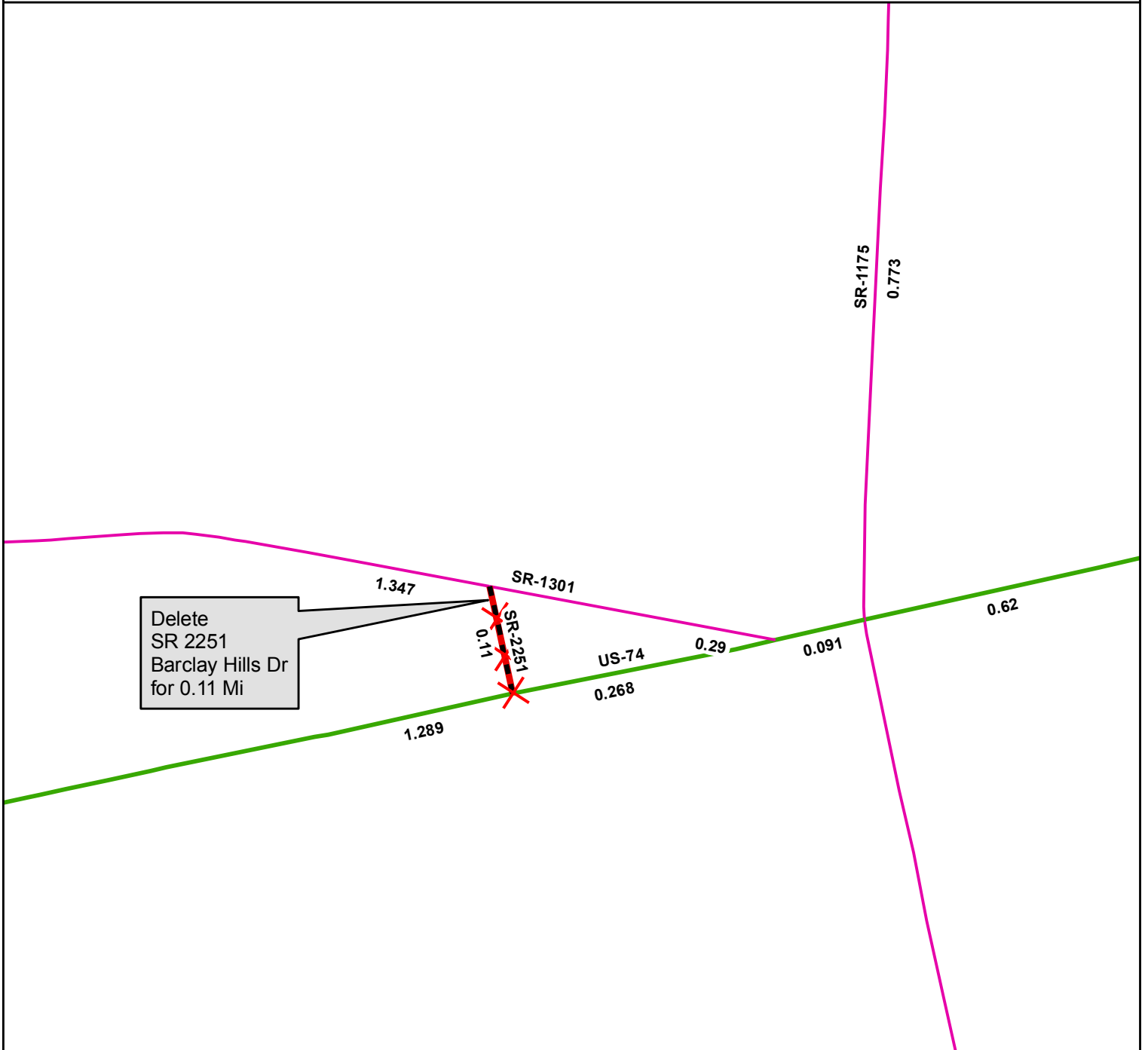



Legend

-  Addition
-  Deletion
-  Reassignment
-  SR
-  NC
-  US
-  Interstate
-  Ramp

