



STATE OF NORTH CAROLINA  
DEPARTMENT OF TRANSPORTATION

BEVERLY EAVES PERDUE  
GOVERNOR

Tuesday, May 11, 2010

EUGENE A. CONTI, JR.  
SECRETARY

**MEMORANDUM TO:** Mr. Michael L. Holder, PE  
Division Engineer  
Division 12

**FROM:** John C. Farley, Manager  
Geographic Information Systems Unit

**SUBJECT:** 2010 District 2 Road System Changes

The Data Conversion Group has been authorized to make the following changes to the state road system as indicated below. We request that you make similar changes to the related maps and files in your Division and District offices, and install appropriate road number signs if necessary. we have updated our records accordingly. If our system changes do not conform to the actual conditions in the field, please return this memorandum with recommendations.

PETITION	County	Approval Date
49431	IREDELL	5/6/2010

Inquiries about changes should be referred to the GIS Help Desk at (919) 707-2152.  
Thank you for your assistance.

JCF







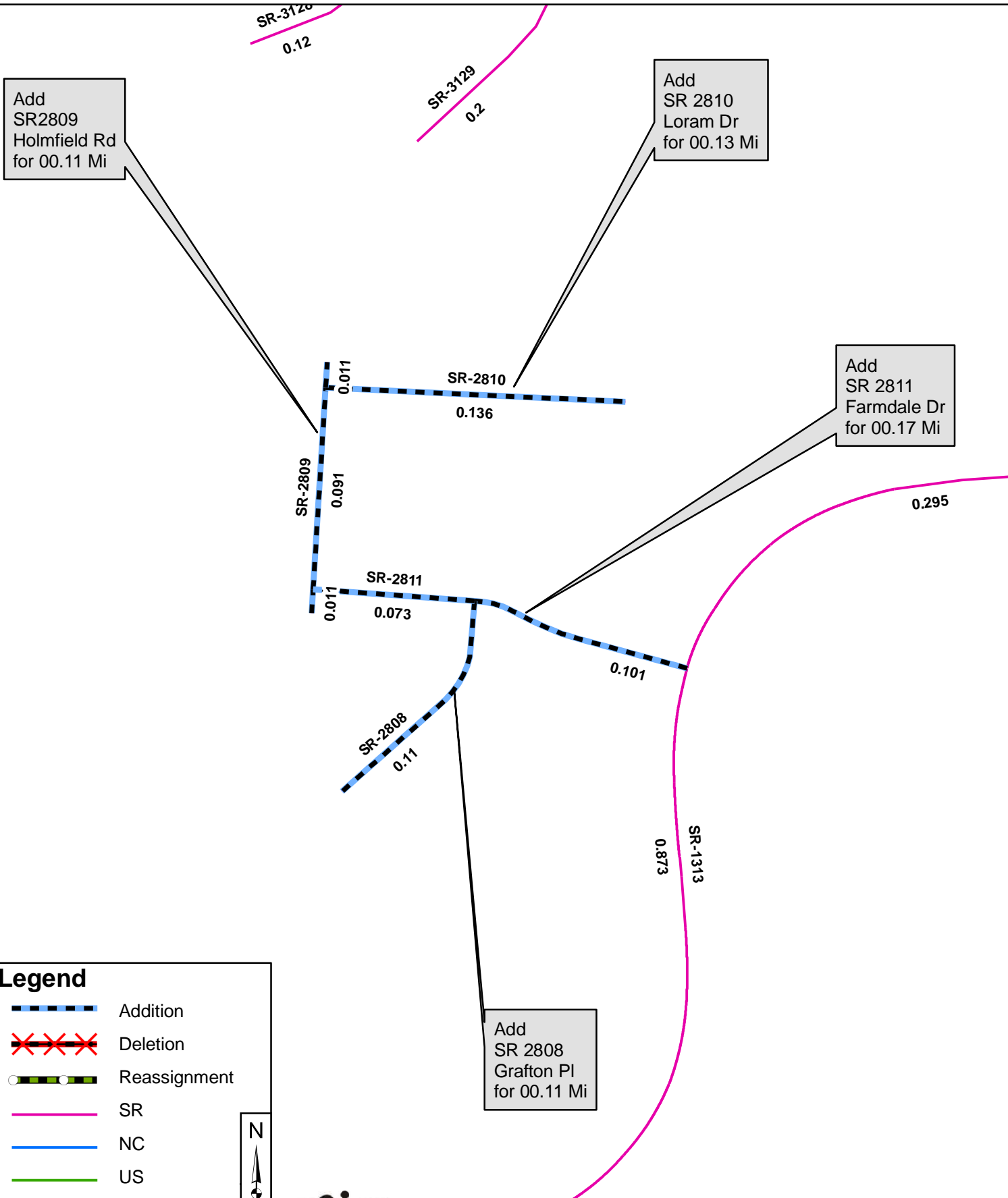

- cc: BSIP
- Bridge Maintenance
- Division Right of Way
- IMG
- Pavement Management
- Permit Unit
- State Road Maintenance
- Traffic Engineering
- Traffic Surveys

# 2010 ROAD SYSTEM CHANGES

<b>PETITION</b>	<b>COUNTY</b>	<b>APPROVAL DATE</b>	<b>ROUTE NUMBER</b>	<b>PORTION REASSIGNED TO</b>	<b>STREET NAME</b>	<b>LENGTH (miles)</b>	<b>TYPE OF CHANGE</b>	<b>REMARKS (See Attached Map)</b>
49431	IREDELL	5/6/2010	SR 2811		FARMDALE DR	.17	System Addition VIA PETITION	
49431	IREDELL	5/6/2010	SR 2810		LORAM DR	.13	System Addition VIA PETITION	
49431	IREDELL	5/6/2010	SR 2809		HOLMFIELD RD	.11	System Addition VIA PETITION	
49431	IREDELL	5/6/2010	SR 2808		GRAFTON PL	.11	System Addition VIA PETITION	



**Legend**

-  Addition
-  Deletion
-  Reassignment
-  SR
-  NC
-  US
-  Interstate
-  Ramp

