



STATE OF NORTH CAROLINA
DEPARTMENT OF TRANSPORTATION

BEVERLY EAVES PERDUE
GOVERNOR

Thursday, December 13, 2012

EUGENE A. CONTI, JR
SECRETARY

MEMORANDUM TO: Mr. Louis Mitchell, PE
Division Engineer
Division 10

FROM: John C. Farley, Manager
Geographic Information Systems Unit

SUBJECT: 2012 District 3 Road System Changes

The Data Conversion Group has been authorized to make the following changes to the state road system as indicated below. We request that you make similar changes to the related maps and files in your Division and District offices, and install appropriate road number signs if necessary. we have updated our records accordingly. If our system changes do not conform to the actual conditions in the field, please return this memorandum with recommendations.

Document Number	County	Approval Date
R-2616	UNION	4/30/2010

Inquiries about changes should be referred to the GIS Help Desk at (919) 707-2152.
Thank you for your assistance.

JCF

- cc: BSIP
- Bridge Maintenance
- Division Right of Way
- IMG
- Pavement Management
- Permit Unit
- State Road Maintenance
- Traffic Engineering
- Traffic Surveys

2012 ROAD SYSTEM CHANGES

TIP	COUNTY	APPROVAL DATE	NEW ROUTE	EXISTING ROUTE	STREET NAME	LENGTH (miles)	TYPE OF CHANGE	REMARKS (See Attached Map)
R-2616	UNION	4/30/2010	SR 2254	SR 1005	LANDSFORD RD	5.60	REASSIGNMENT VIA TIP	MAP B, SEGMENT
R-2616	UNION	4/30/2010	SR 2253	SR 1939	HARGETTE RD	0.50	REASSIGNMENT VIA TIP	MAP C, SEGMENT
R-2616	UNION	4/30/2010		US 601	PAGELAND HWY	10.88	SYSTEM ADDITION - EXISTING VIA TIP	MAP A, SEGMENT
R-2616	UNION	4/30/2010		SR 2111	BELK MILL RD	0.06	SYSTEM ADDITION - EXISTING VIA TIP	MAP C, SEGMENT
R-2616	UNION	4/30/2010		SR 1940	BELK MILL RD	0.07	SYSTEM ADDITION - EXISTING VIA TIP	MAP C, SEGMENT
R-2616	UNION	4/30/2010		SR 2105	MARION LEE RD	0.05	SYSTEM ADDITION - EXISTING VIA TIP	MAP H, SEGMENT
R-2616	UNION	4/30/2010		US 601	PAGELAND HWY	0.39	SYSTEM DELETION VIA TIP	MAP C, SEGMENT
R-2616	UNION	4/30/2010		SR 2111	BELK MILL RD	0.09	SYSTEM DELETION VIA TIP	MAP C, SEGMENT
R-2616	UNION	4/30/2010		SR 1940	BELK MILL RD	0.08	SYSTEM DELETION VIA TIP	MAP C, SEGMENT
R-2616	UNION	4/30/2010		SR 2110	MCMANUS CIR	0.06	SYSTEM DELETION VIA TIP	MAP D, SEGMENT

TIP	COUNTY	APPROVAL DATE	NEW ROUTE	EXISTING ROUTE	STREET NAME	LENGTH (miles)	TYPE OF CHANGE	REMARKS (See Attached Map)
R-2616	UNION	4/30/2010		SR 1951	MOUNTAIN SPRINGS CHURCH RD	0.05	SYSTEM DELETION VIA TIP	MAP D, SEGMENT
R-2616	UNION	4/30/2010		US 601	PAGELAND HWY	0.39	SYSTEM DELETION VIA TIP	MAP E, SEGMENT
R-2616	UNION	4/30/2010		SR 2112	ERVIN THOMAS RD	0.01	SYSTEM DELETION VIA TIP	MAP F, SEGMENT
R-2616	UNION	4/30/2010		US 601	PAGELAND HWY	0.19	SYSTEM DELETION VIA TIP	MAP G, SEGMENT
R-2616	UNION	4/30/2010		SR 2105	MARION LEE RD	0.08	SYSTEM DELETION VIA TIP	MAP H, SEGMENT

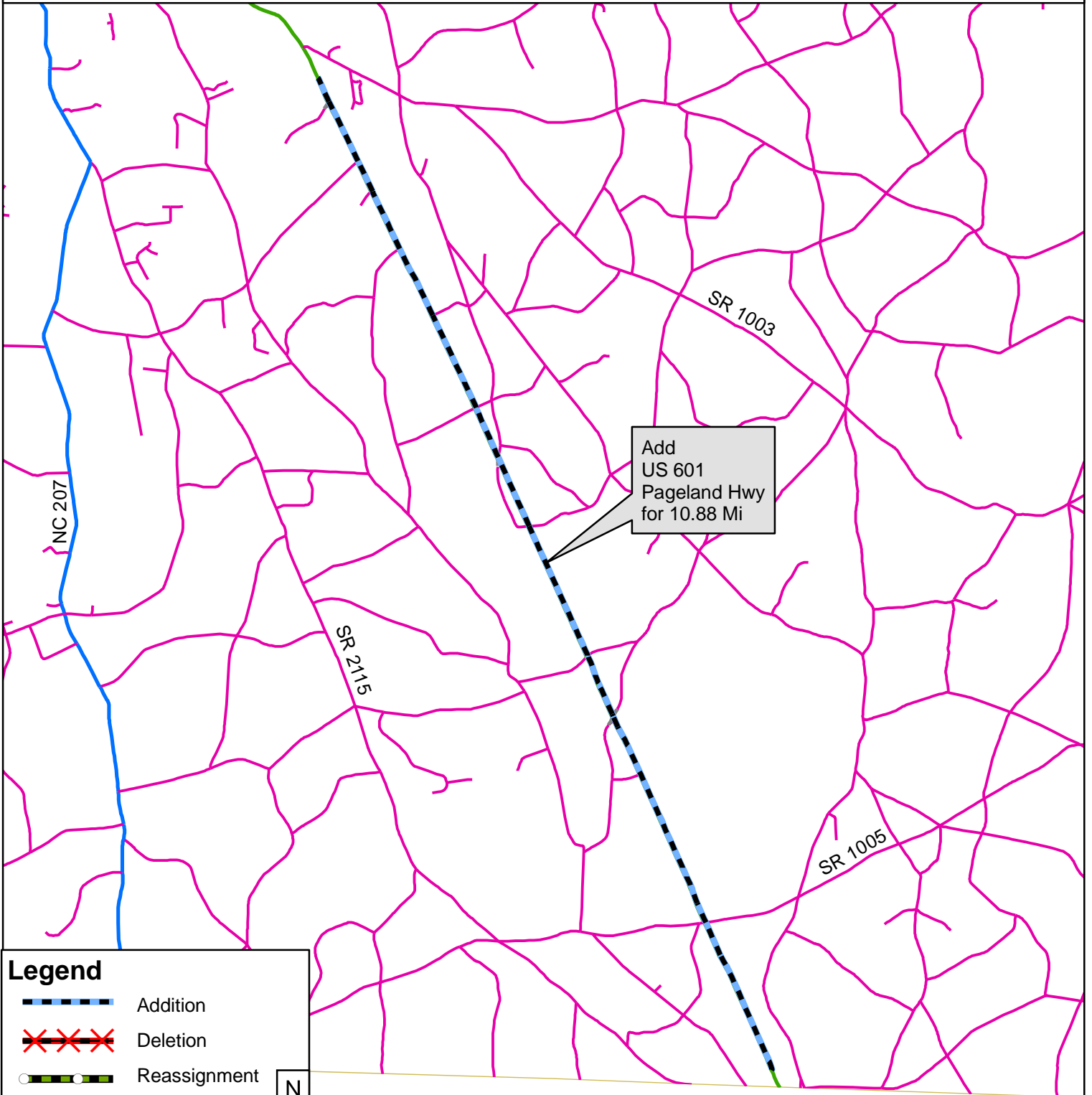

Legend





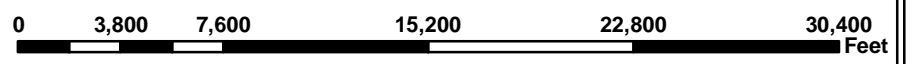

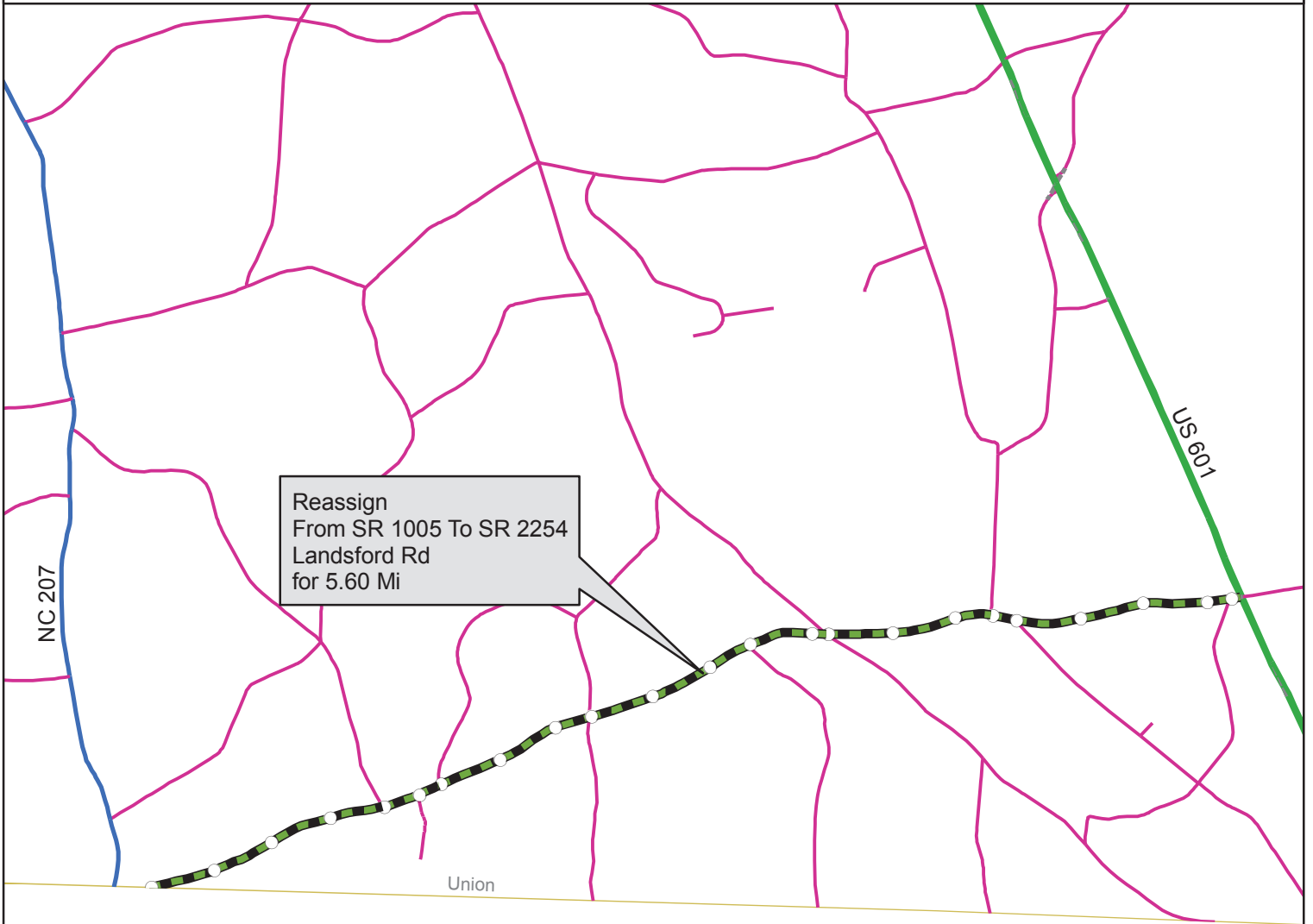

- Addition
- Deletion
- Reassignment
- SR
- NC
- US
- Interstate
- Ramp
- County Boundary

N





Legend

-  Addition
-  Deletion
-  Reassignment
-  SR
-  NC
-  US
-  Interstate
-  Ramp
-  County Boundary

N
↑
↓



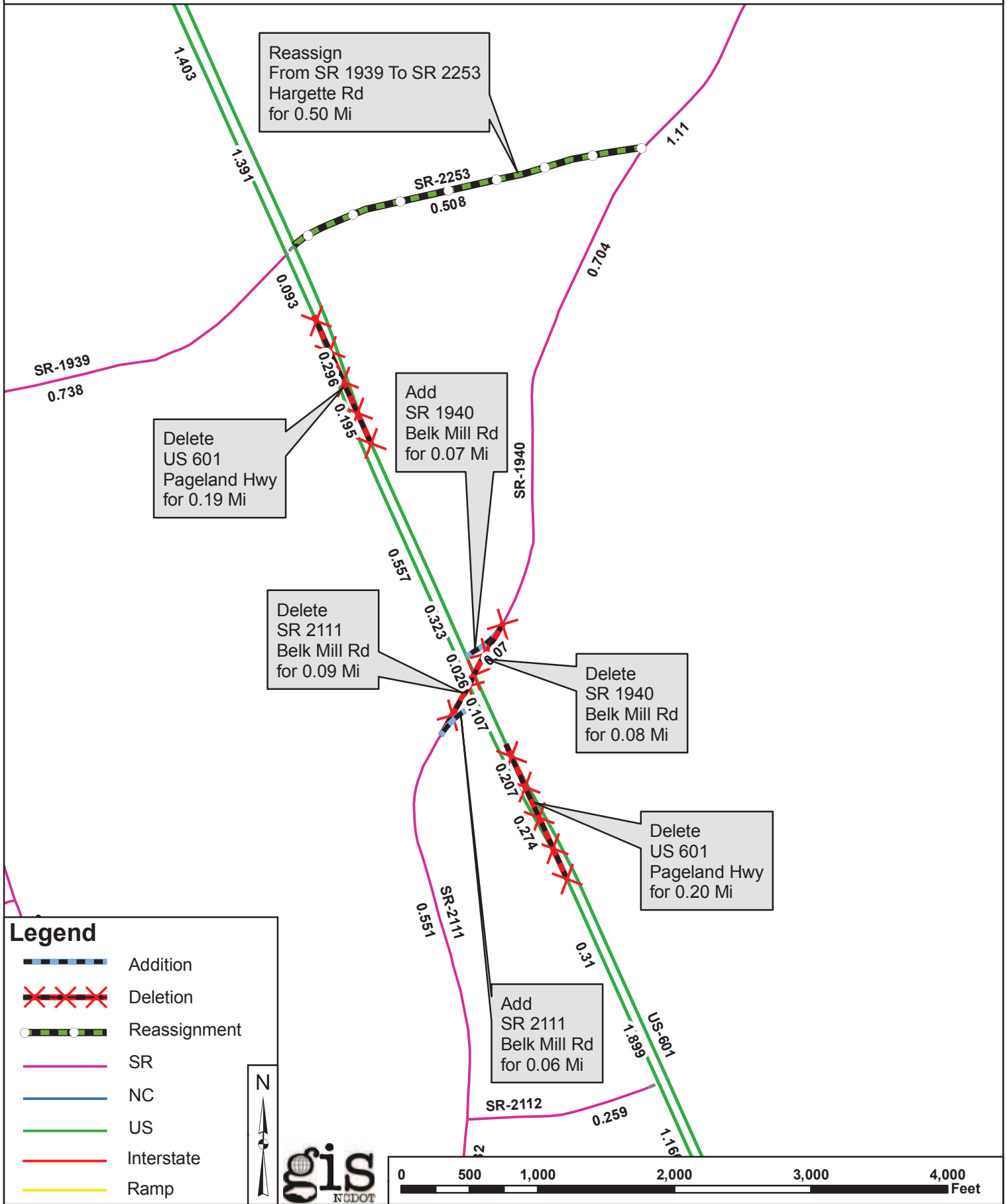

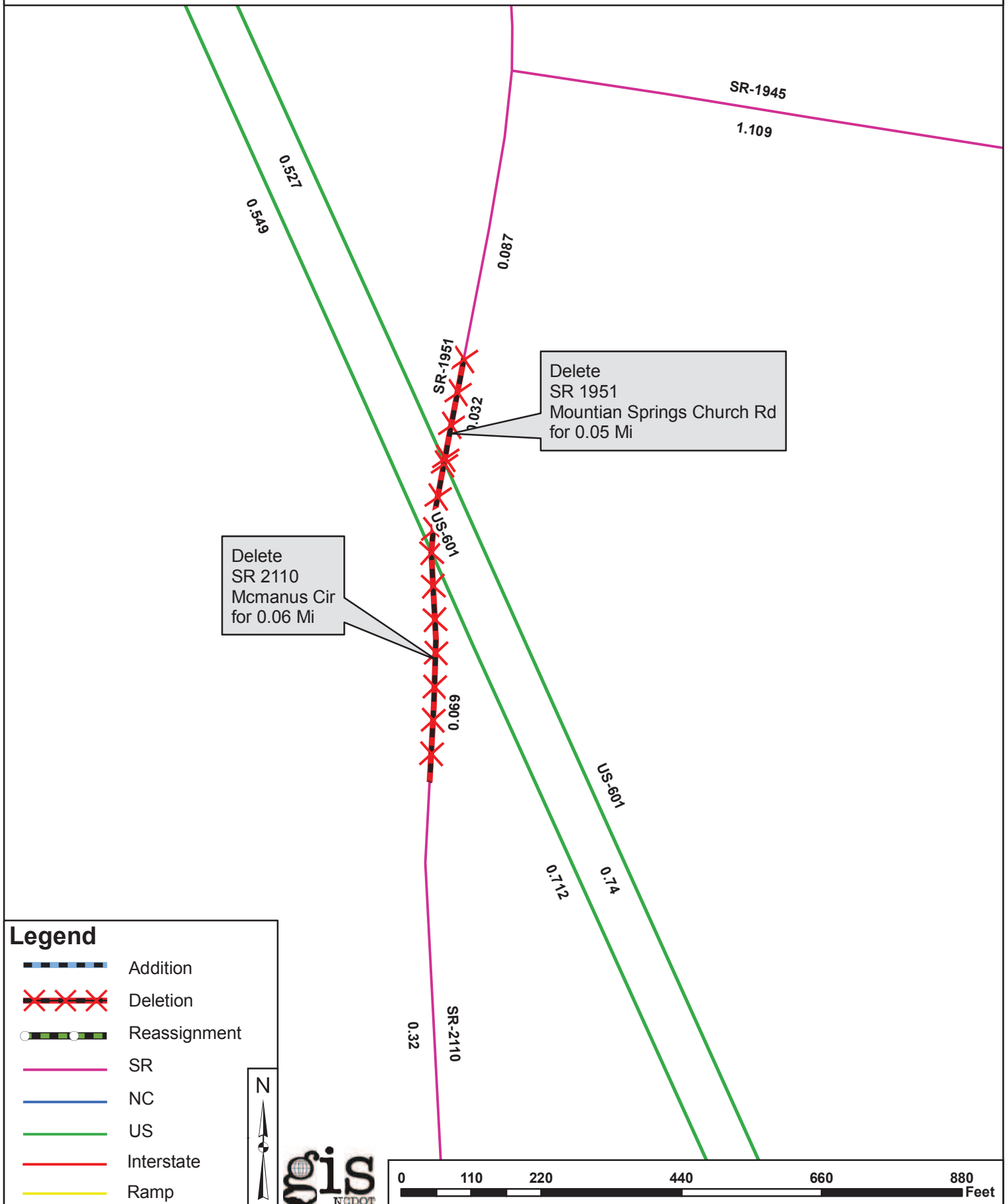

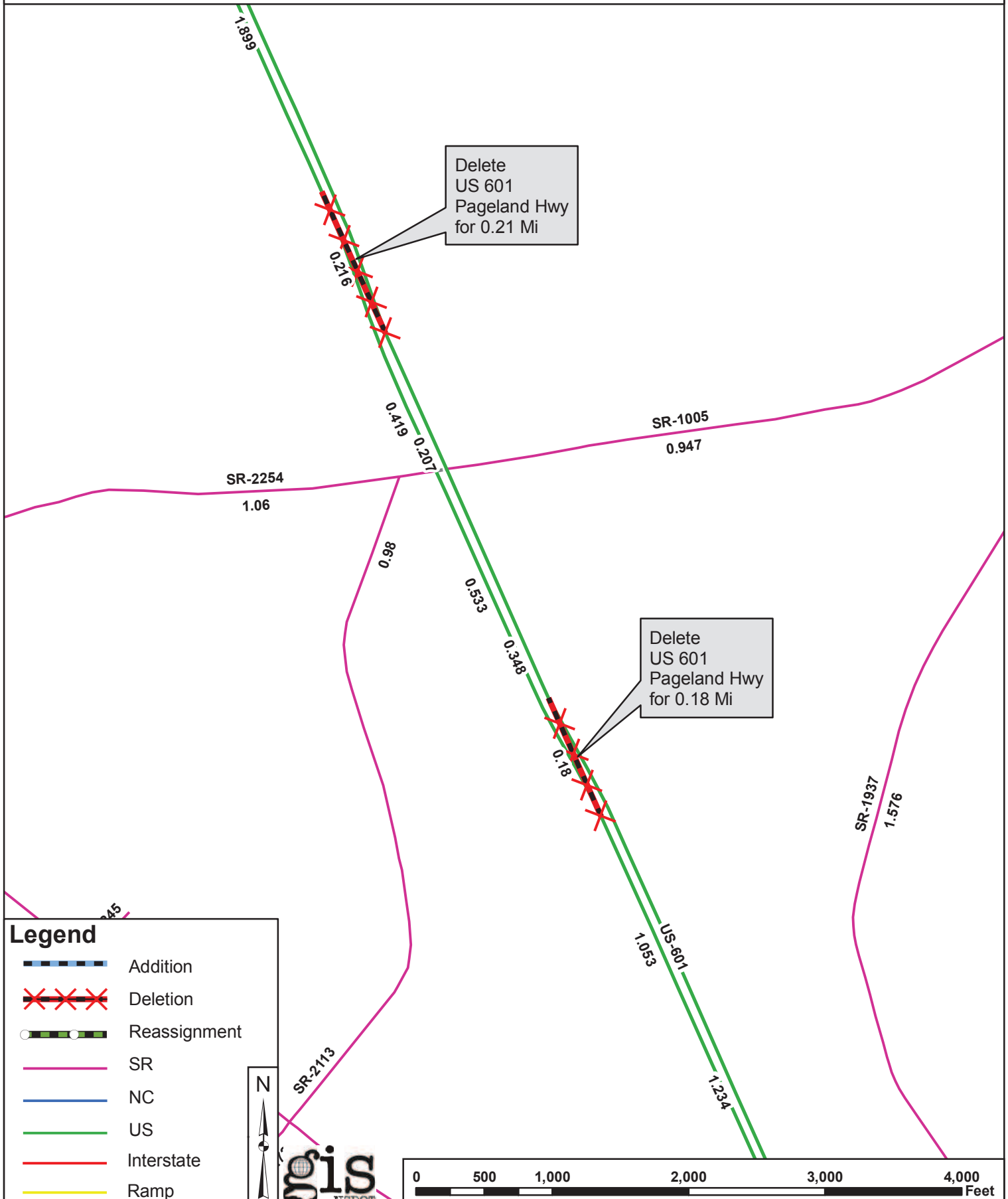

Delete
US 601
Pageland Hwy
for 0.21 Mi

Delete
US 601
Pageland Hwy
for 0.18 Mi



Legend

-  Addition
-  Deletion
-  Reassignment
-  SR
-  NC
-  US
-  Interstate
-  Ramp

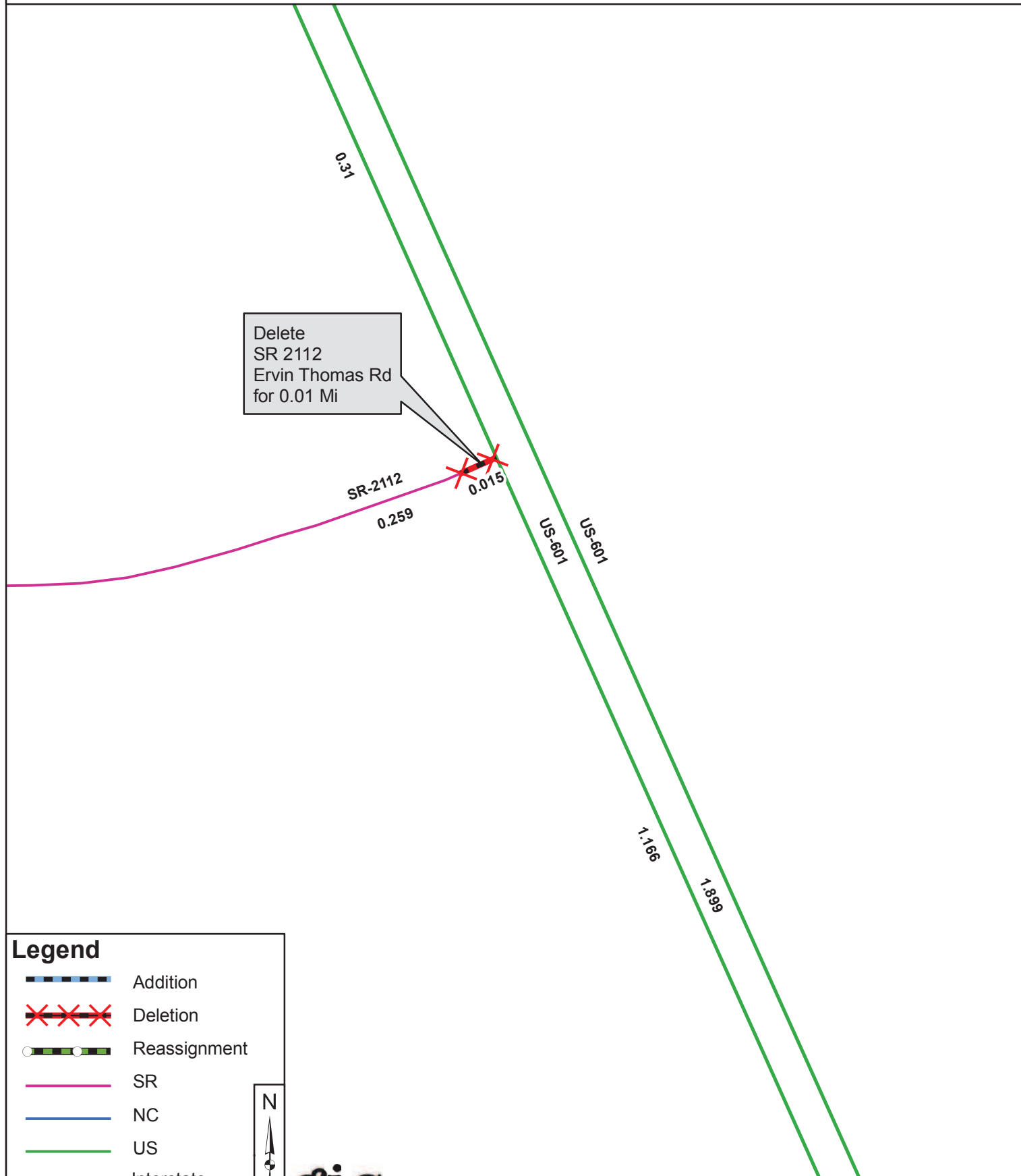









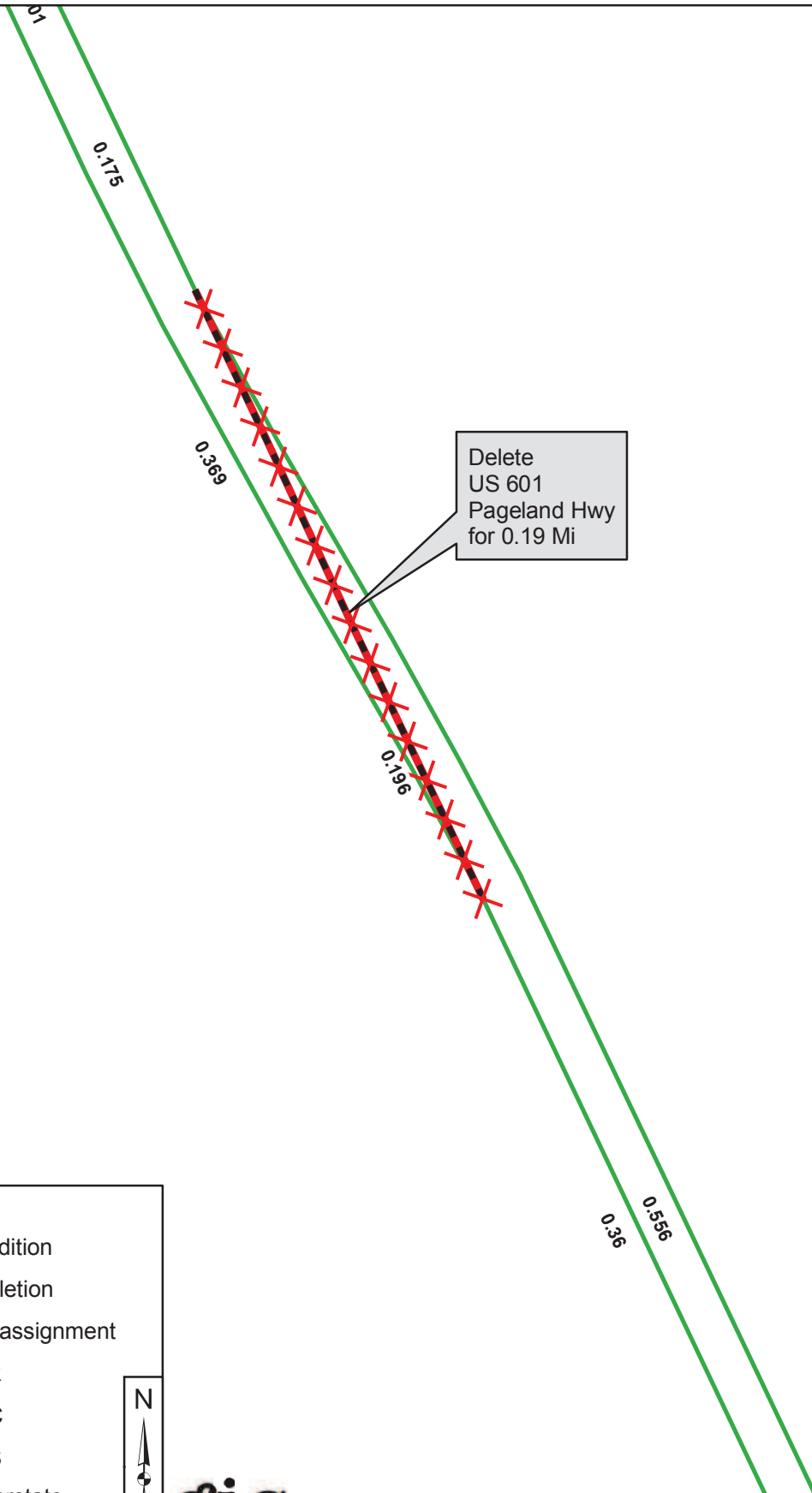

Legend

-  Addition
-  Deletion
-  Reassignment
-  SR
-  NC
-  US
-  Interstate
-  Ramp







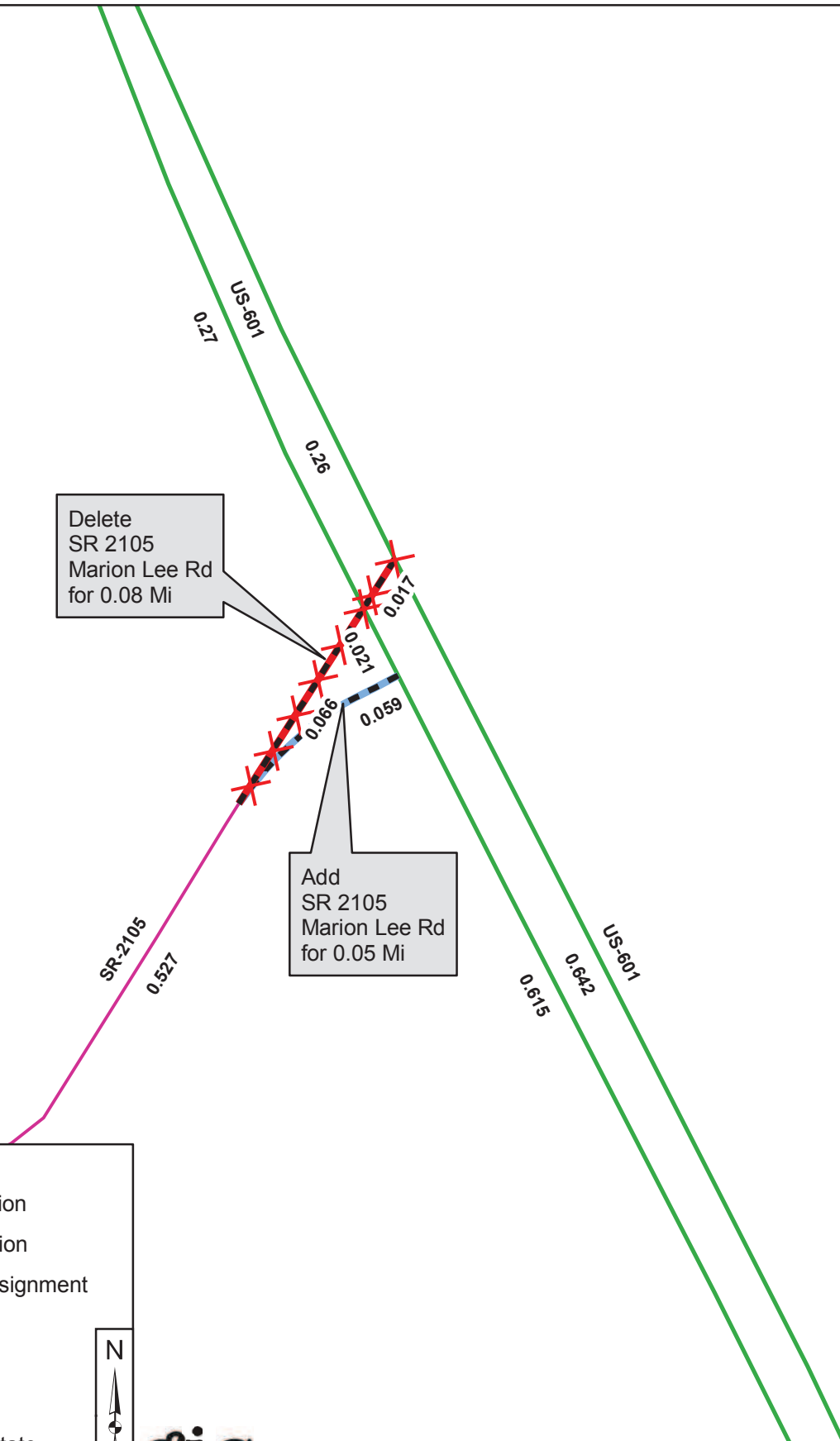

Legend

-  Addition
-  Deletion
-  Reassignment
-  SR
-  NC
-  US
-  Interstate
-  Ramp





Legend

-  Addition
-  Deletion
-  Reassignment
-  SR
-  NC
-  US
-  Interstate
-  Ramp

