



STATE OF NORTH CAROLINA  
DEPARTMENT OF TRANSPORTATION

BEVERLY EAVES PERDUE  
GOVERNOR

Wednesday, January 20, 2010

EUGENE A. CONTI, JR.  
SECRETARY

**MEMORANDUM TO:** Mr. S. Pat Ivey, PE  
Division Engineer  
Division 9

**FROM:** John C. Farley, Manager  
Geographic Information Systems Unit

**SUBJECT:** 2010 District 2 Road System Changes

The Data Conversion Group has been authorized to make the following changes to the state road system as indicated below. We request that you make similar changes to the related maps and files in your Division and District offices, and install appropriate road number signs if necessary. we have updated our records accordingly. If our system changes do not conform to the actual conditions in the field, please return this memorandum with recommendations.

PETITION	County	Approval Date
49324	FORSYTH	1/7/2010

Inquiries about changes should be referred to the GIS Help Desk at (919) 707-2152.  
Thank you for your assistance.

JCF

- cc: BSIP
- Bridge Maintenance
- Division Right of Way
- IMG
- Pavement Management
- Permit Unit
- State Road Maintenance
- Traffic Engineering
- Traffic Surveys

# 2010 ROAD SYSTEM CHANGES

<b>PETITION</b>	<b>COUNTY</b>	<b>APPROVAL DATE</b>	<b>ROUTE NUMBER</b>	<b>PORTION REASSIGNED TO</b>	<b>STREET NAME</b>	<b>LENGTH (miles)</b>	<b>TYPE OF CHANGE</b>	<b>REMARKS (See Attached Map)</b>
49324	FORSYTH	1/7/2010	SR 3428		TEAL CT	.04	System Addition VIA PETITION	
49324	FORSYTH	1/7/2010	SR 3427		TEAL DR	.09	System Addition VIA PETITION	
49324	FORSYTH	1/7/2010	SR 3426		WALDEN RIDGE CT	.18	System Addition VIA PETITION	
49324	FORSYTH	1/7/2010	SR 3425		WALDEN RIDGE DR	.20	System Addition VIA PETITION	
49324	FORSYTH	1/7/2010	SR 3424		SAILWAY RD	.20	System Addition VIA PETITION	

Add  
SR 3426  
Walden Ridge Ct  
for 00.18 Mi

Add  
SR 3425  
Walden Ridge Dr  
for 00.20 Mi

Add  
SR 3427  
Teal Ct  
for 00.04 Mi

Add  
SR 3427  
Teal Dr  
for 00.09 Mi

Add  
SR 3424  
Sailway Rd  
for 00.20 Mi

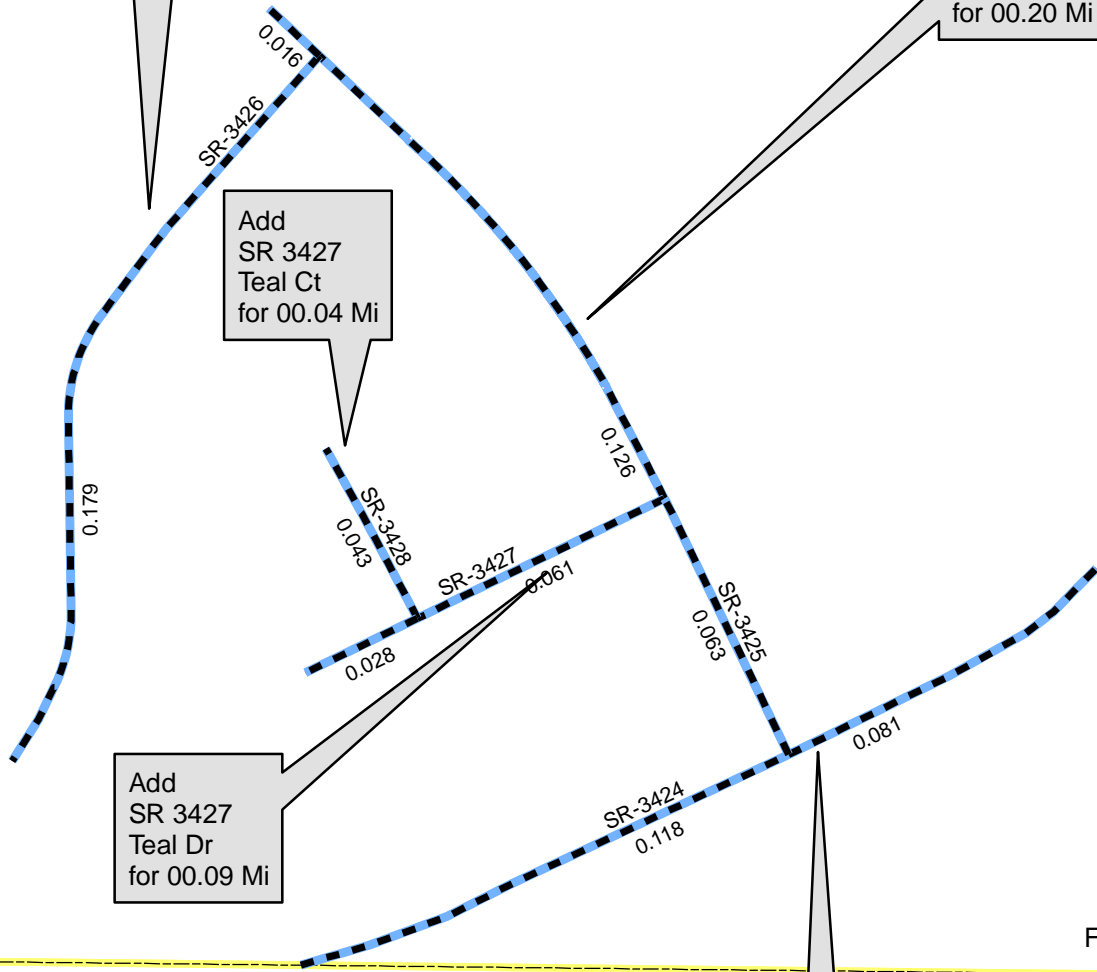

Forsyth

Davidson

**Legend**

- Addition
- Deletion
- Reassignment
- SR
- NC
- US
- Interstate
- Ramp
- County Boundary

