



STATE OF NORTH CAROLINA
DEPARTMENT OF TRANSPORTATION

BEVERLY EAVES PERDUE
GOVERNOR

Monday, January 11, 2010

EUGENE A. CONTI, JR.
SECRETARY

MEMORANDUM TO: Mr. Mike Mills, PE
Division Engineer
Division 7

FROM: John C. Farley, Manager
Geographic Information Systems Unit

SUBJECT: 2010 District 2 Road System Changes

The Data Conversion Group has been authorized to make the following changes to the state road system as indicated below. We request that you make similar changes to the related maps and files in your Division and District offices, and install appropriate road number signs if necessary. we have updated our records accordingly. If our system changes do not conform to the actual conditions in the field, please return this memorandum with recommendations.

MUNICIPAL	County	Approval Date
SUMMERFIELD	GUILFORD	1/7/2010

Inquiries about changes should be referred to the GIS Help Desk at (919) 707-2152.
Thank you for your assistance.

JCF

- cc: BSIP
- Bridge Maintenance
- Division Right of Way
- IMG
- Pavement Management
- Permit Unit
- State Road Maintenance
- Traffic Engineering
- Traffic Surveys

2010 ROAD SYSTEM CHANGES

MUNICIPAL	COUNTY	APPROVAL DATE	ROUTE NUMBER	PORTION REASSIGNED TO	STREET NAME	LENGTH (miles)	TYPE OF CHANGE	REMARKS (See Attached Map)
SUMMERFIELD	GUILFORD	1/7/2010	SR 2256		CRESTFIELD RD	0.05	System Addition VIA MUNICIPAL	

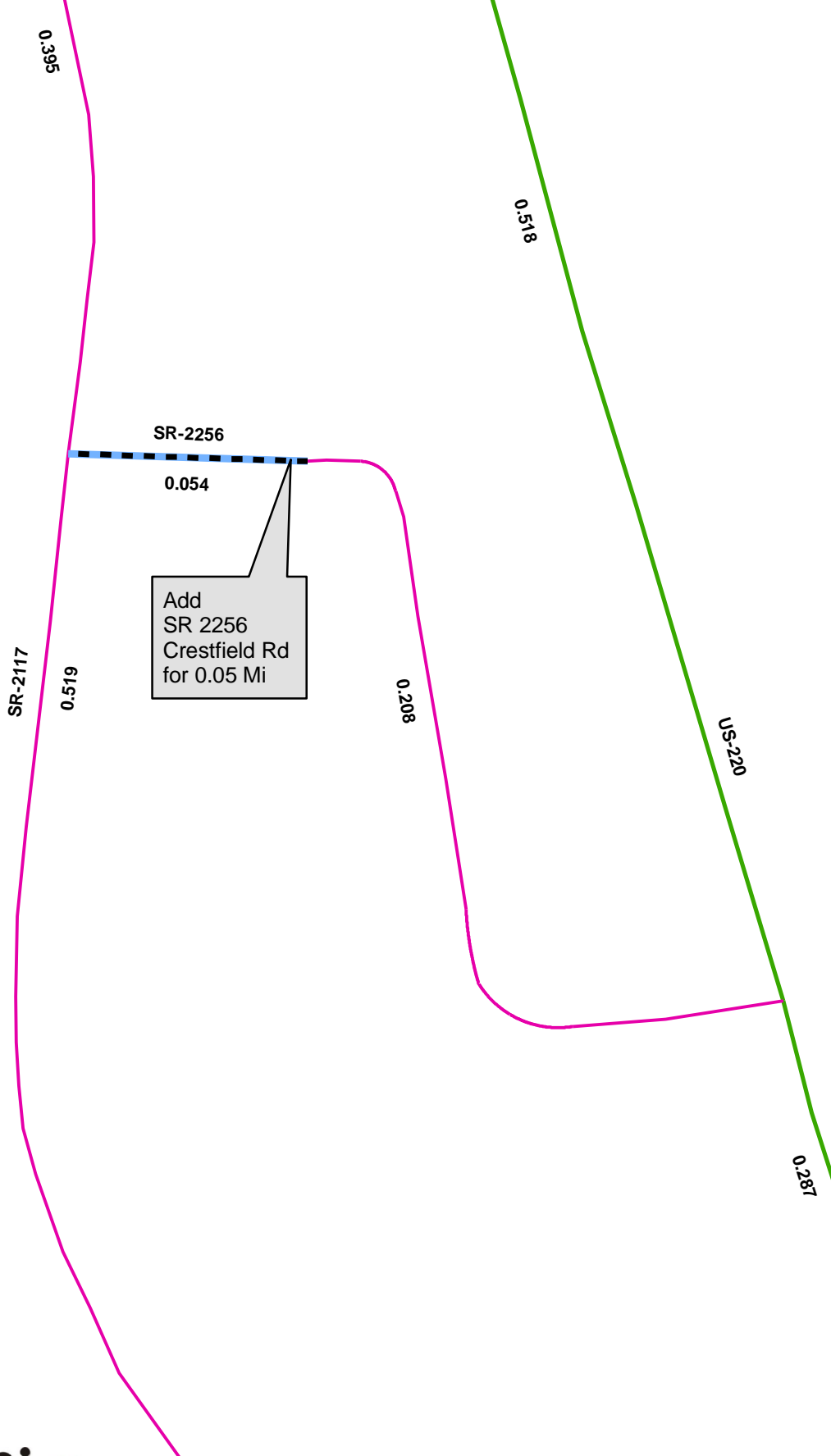

SR-2256

0.054

Add
SR 2256
Crestfield Rd
for 0.05 Mi

SR-2117

0.519

0.208

0.518

US-220

0.287

Legend

-  Addition
-  Deletion
-  Reassignment
-  SR
-  NC
-  US
-  Interstate
-  Ramp

3

