



STATE OF NORTH CAROLINA
DEPARTMENT OF TRANSPORTATION

BEVERLY EAVES PERDUE
GOVERNOR

Tuesday, December 15, 2009

EUGENE A. CONTI, JR.
SECRETARY

MEMORANDUM TO: Mr. J. Wally Bowman, PE
Division Engineer
Division 5

FROM: John C. Farley, Manager
Geographic Information Systems Unit

SUBJECT: 2009 District 1 Road System Changes

The Data Conversion Group has been authorized to make the following changes to the state road system as indicated below. We request that you make similar changes to the related maps and files in your Division and District offices, and install appropriate road number signs if necessary. we have updated our records accordingly. If our system changes do not conform to the actual conditions in the field, please return this memorandum with recommendations.

PETITION	County	Approval Date
49298	WAKE	12/10/2009

Inquiries about changes should be referred to the GIS Help Desk at (919) 707-2152.
Thank you for your assistance.

JCF

cc: BSIP
Bridge Maintenance
Division Right of Way
IMG
Pavement Management
Permit Unit
State Road Maintenance
Traffic Engineering
Traffic Surveys

MAILING ADDRESS:
NC DEPARTMENT OF TRANSPORTATION
GEOGRAPHIC INFORMATION SYSTEMS
1521 MAIL SERVICE CENTER
RALEIGH NC 27699-1521

gis
NCDOT
WWW.NCDOT.ORG/IT/GIS







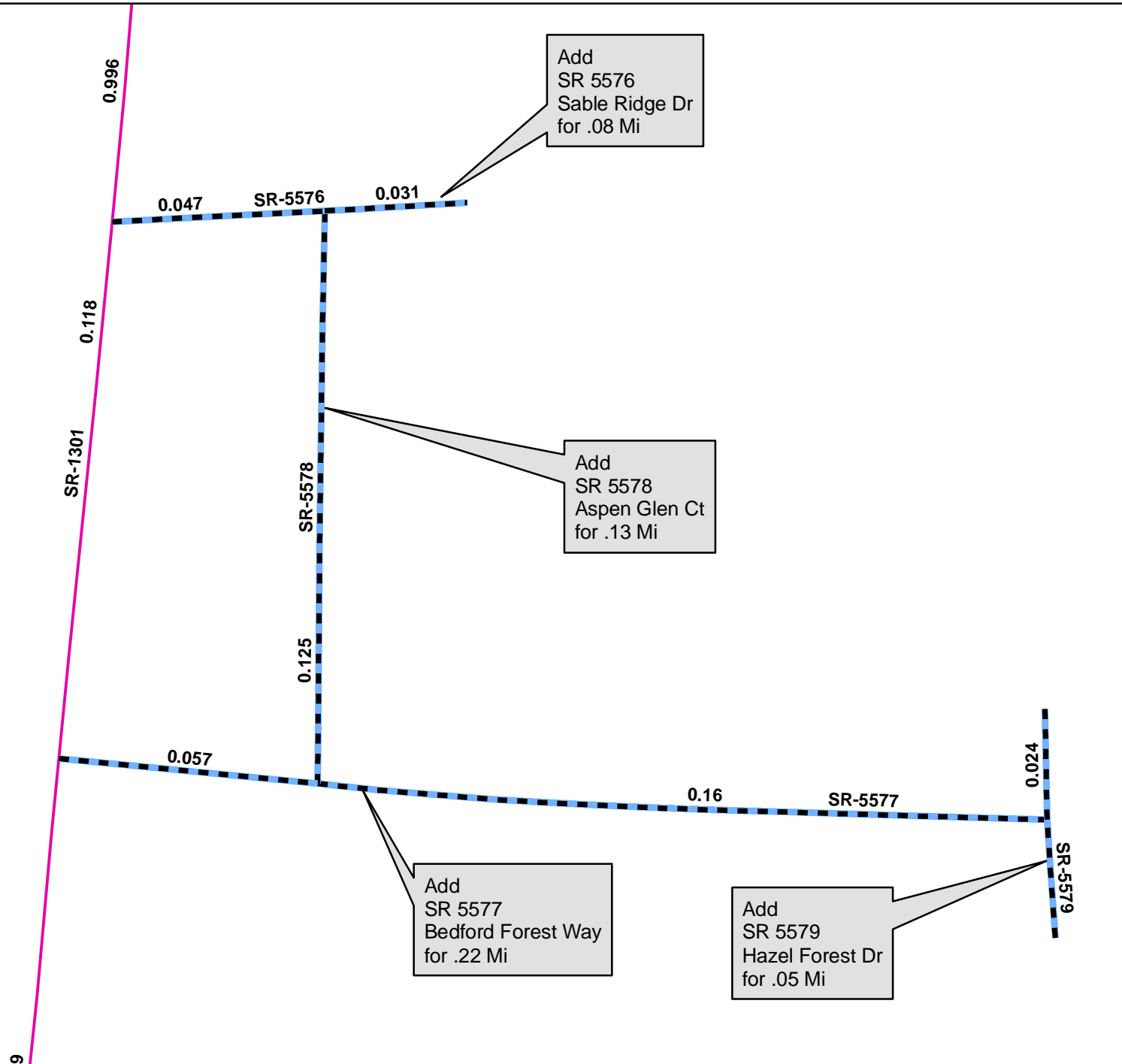

Delivery Address:
4101 CAPITAL BLVD.
RALEIGH, NC 27604
PHONE: (919) 707-2152
FAX: (919) 707-2214

2009 ROAD SYSTEM CHANGES

PETITION	COUNTY	APPROVAL DATE	ROUTE NUMBER	PORTION REASSIGNED	STREET NAME	LENGT H	TYPE OF CHANGE	REMARKS (See Attached Map)
49298	WAKE	12/10/2009	SR 5579		HAZEL FOREST DR	.05	System Addition VIA PETITION	
49298	WAKE	12/10/2009	SR 5578		ASPEN GLEN CT	.13	System Addition VIA PETITION	
49298	WAKE	12/10/2009	SR 5577		BEDFORD FOREST WAY	.22	System Addition VIA PETITION	
49298	WAKE	12/10/2009	SR 5576		SABLE RIDGE DR	.08	System Addition VIA PETITION	



Legend

-  Addition
-  Deletion
-  Reassignment
-  SR
-  NC
-  US
-  Interstate
-  Ramp

