



STATE OF NORTH CAROLINA  
DEPARTMENT OF TRANSPORTATION

BEVERLY EAVES PERDUE  
GOVERNOR

Friday, September 11, 2009

EUGENE A. CONTI, JR.  
SECRETARY

**MEMORANDUM TO:** Mr. Barry Moose, PE  
Division Engineer  
Division 10

**FROM:** John C. Farley, Manager  
Geographic Information Systems Unit

**SUBJECT:** 2009 District 3 Road System Changes

The Data Conversion Group has been authorized to make the following changes to the state road system as indicated below. We request that you make similar changes to the related maps and files in your Division and District offices, and install appropriate road number signs if necessary. we have updated our records accordingly. If our system changes do not conform to the actual conditions in the field, please return this memorandum with recommendations.

PETITION	County	Approval Date
49216	UNION	9/3/2009

Inquiries about changes should be referred to the GIS Help Desk at (919) 707-2152.  
Thank you for your assistance.

JCF

- cc: BSIP
- Bridge Maintenance
- Division Right of Way
- IMG
- Pavement Management
- Permit Unit
- State Road Maintenance
- Traffic Engineering
- Traffic Surveys

# 2009 ROAD SYSTEM CHANGES

<b>PETITION</b>	<b>COUNTY</b>	<b>APPROVAL DATE</b>	<b>ROUTE NUMBER</b>	<b>PORTION REASSIGNED TO</b>	<b>STREET NAME</b>	<b>LENGTH (miles)</b>	<b>TYPE OF CHANGE</b>	<b>REMARKS (See Attached Map)</b>
49216	UNION	9/3/2009	SR 3658		ROBBINS MEADOW DR	.23	System Addition VIA PETITION	
49216	UNION	9/3/2009	SR 3657		CARTER WOODS CT	.06	System Addition VIA PETITION	
49216	UNION	9/3/2009	SR 3656		WILLOWCREST DR	.23	System Addition VIA PETITION	
49216	UNION	9/3/2009	SR 3655		SHENANDOAH DR	.21	System Addition VIA PETITION	

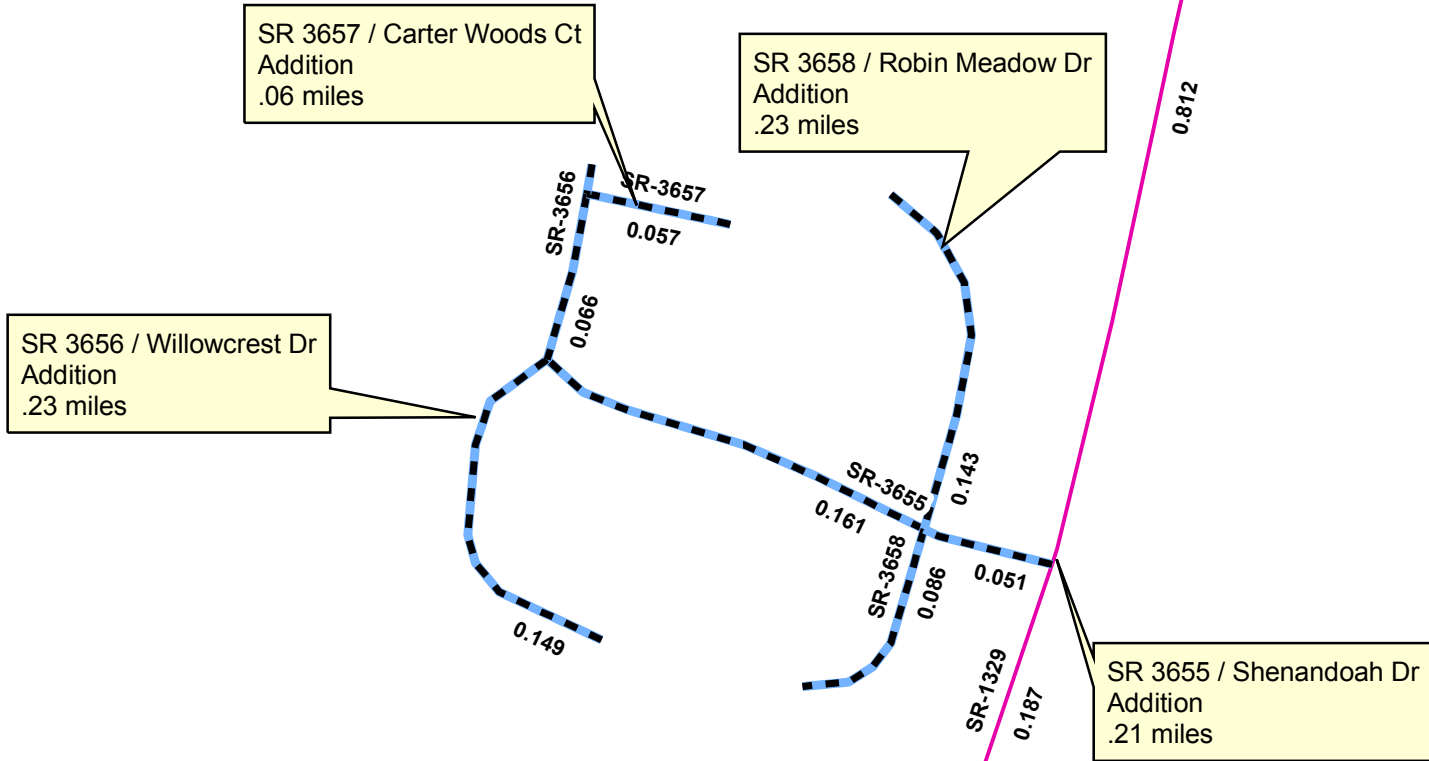

**Legend**

-  Addition
-  Deletion
-  Reassignment
-  SR
-  NC
-  US
-  Interstate
-  Ramp

