



STATE OF NORTH CAROLINA
DEPARTMENT OF TRANSPORTATION

PATRICK MCCRORY
GOVERNOR

Wednesday, February 05, 2014

ANTHONY TATA
SECRETARY

MEMORANDUM TO: Mr. Michael L. Holder, PE
Division Engineer
Division 12

FROM: John C. Farley, Manager
Geographic Information Systems Unit

SUBJECT: 2014 District 1 Road System Changes

The Data Conversion Group has been authorized to make the following changes to the state road system as indicated below. We request that you make similar changes to the related maps and files in your Division and District offices, and install appropriate road number signs if necessary. We have updated our records accordingly. If our system changes do not conform to the actual conditions in the field, please return this memorandum with recommendations.

| LRS Change | County | Approval Date |
|----------------|--------|---------------|
| LRS_6069_02-14 | GASTON | 2/11/2009 |

Inquiries about changes should be referred to the GIS Help Desk at (919) 707-2152.
Thank you for your assistance.

JCF

cc: BSIP
Bridge Maintenance
Division Right of Way
IMG
Pavement Management
Permit Unit
State Road Maintenance
Traffic Engineering
Traffic Surveys

MAILING ADDRESS:
NC DEPARTMENT OF TRANSPORTATION
GEOGRAPHIC INFORMATION SYSTEMS
1521 MAIL SERVICE CENTER
RALEIGH, NC 27699-1521



DELIVERY ADDRESS:
4101 CAPITAL BLVD.
RALEIGH, NC 27604
PHONE: (919) 707-2152
FAX: (919) 707-2214

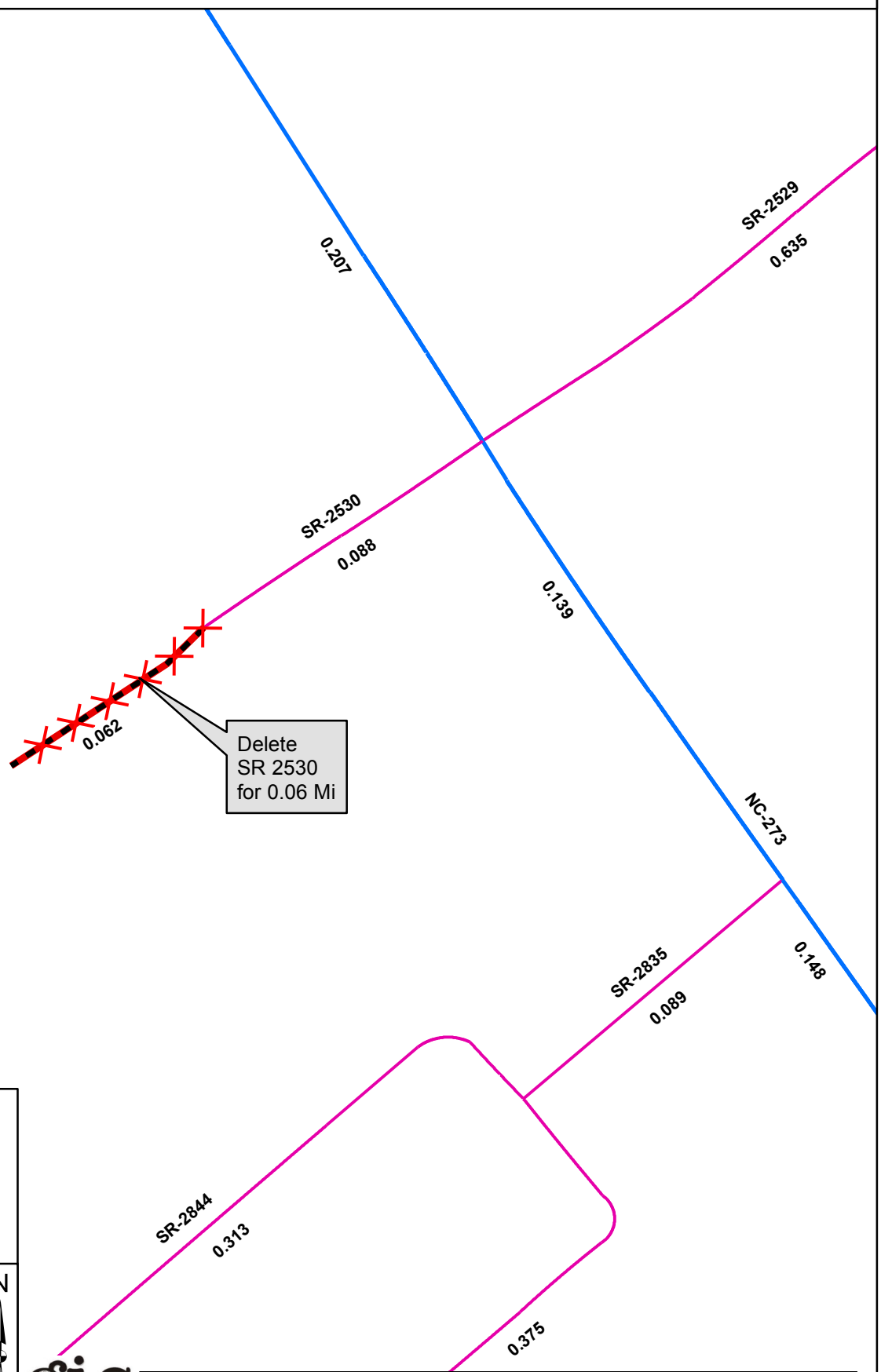

2014 ROAD SYSTEM CHANGES

| LRS | COUNTY | APPROVAL DATE | NEW ROUTE | EXISTING ROUTE | STREET NAME | LENGTH (miles) | TYPE OF CHANGE | REMARKS (See Attached M: |
|--------------------|---------------|--------------------------|----------------------|---------------------------|------------------------|---------------------------|--------------------------------------|-------------------------------------|
| LRS_6069_02- 14 | GASTON | 2/11/2009 | | SR 2530 | | 0.06 | SYSTEM DELETION VIA LRS CHANGE | MAP , SEGMENT |



Delete
SR 2530
for 0.06 Mi

Legend

-  Addition
-  Deletion
-  Reassignment
-  SR
-  NC
-  US
-  Interstate
-  Ramp

