



STATE OF NORTH CAROLINA
DEPARTMENT OF TRANSPORTATION

MICHAEL F. EASLEY
GOVERNOR

Tuesday, 04 November, 2008

LYNDO TIPPETT
SECRETARY

MEMORANDUM TO: Mr. Mike Mills, PE
Division Engineer
Division 7

FROM: Information, and Mapping Unit

SUBJECT: 2008 District 2 Road System Changes

The Road Inventory Information Section has been authorized to make the following changes to the state road system as indicated below. We request that you make similar changes to the related maps and files in your Division and District offices, and install appropriate road number signs if necessary. We have updated our records and county maps accordingly. If our system changes do not conform to the actual conditions in the field, please return this memorandum with recommendations.

| Petition Number | County | Approval Date |
|-----------------|----------|---------------|
| 48828 | GUILFORD | 9/4/2008 |

Inquires about changes should be referred to one of the following: For Primary Roads call Paulette Smith at (919)-212-6100, and for Secondary Roads call Ron Tucker at (919)-212-6085. Thank you for your assistance.

HRC
enclosures ()

- cc: BSIP
Bridge Maintenance
Division Right of Way
GIS
Pavement Management
Permit Unit
State Road Maintenance
Traffic Engineering
Traffic Surveys

2008 ROAD SYSTEM CHANGES

| PETITION NUMBER | COUNTY | APPROVAL DATE | NEW NUMBER | EXISTING NUMBER | STREET NAME | LENGTH (miles) | TYPE OF CHANGE | REMARKS (See Attached Map) |
|------------------------|---------------|----------------------|-------------------|------------------------|--------------------|-----------------------|------------------------------------|-----------------------------------|
| 48828 | GUILFORD | 9/4/2008 | SR 5401 | | YOUNGSTOWN DRIVE | 0.10 | SYSTEM ADDITION VIA PETITION | MAP , SEGMENT |
| 48828 | GUILFORD | 9/4/2008 | SR 5400 | | LANGSTON DRIVE | 0.08 | SYSTEM ADDITION VIA PETITION | MAP , SEGMENT |
| 48828 | GUILFORD | 9/4/2008 | SR 3299 | | WATERLYN DRIVE | 0.20 | SYSTEM ADDITION VIA PETITION | MAP , SEGMENT |

PETITION: 48828

CO: Guilford

SR #: 3299 5400 5401 _____

Approval Date: 04 Sept. 08 Map Date: 23 Oct. 08



Legend:

- Addition
- Deletion
- Reassignment

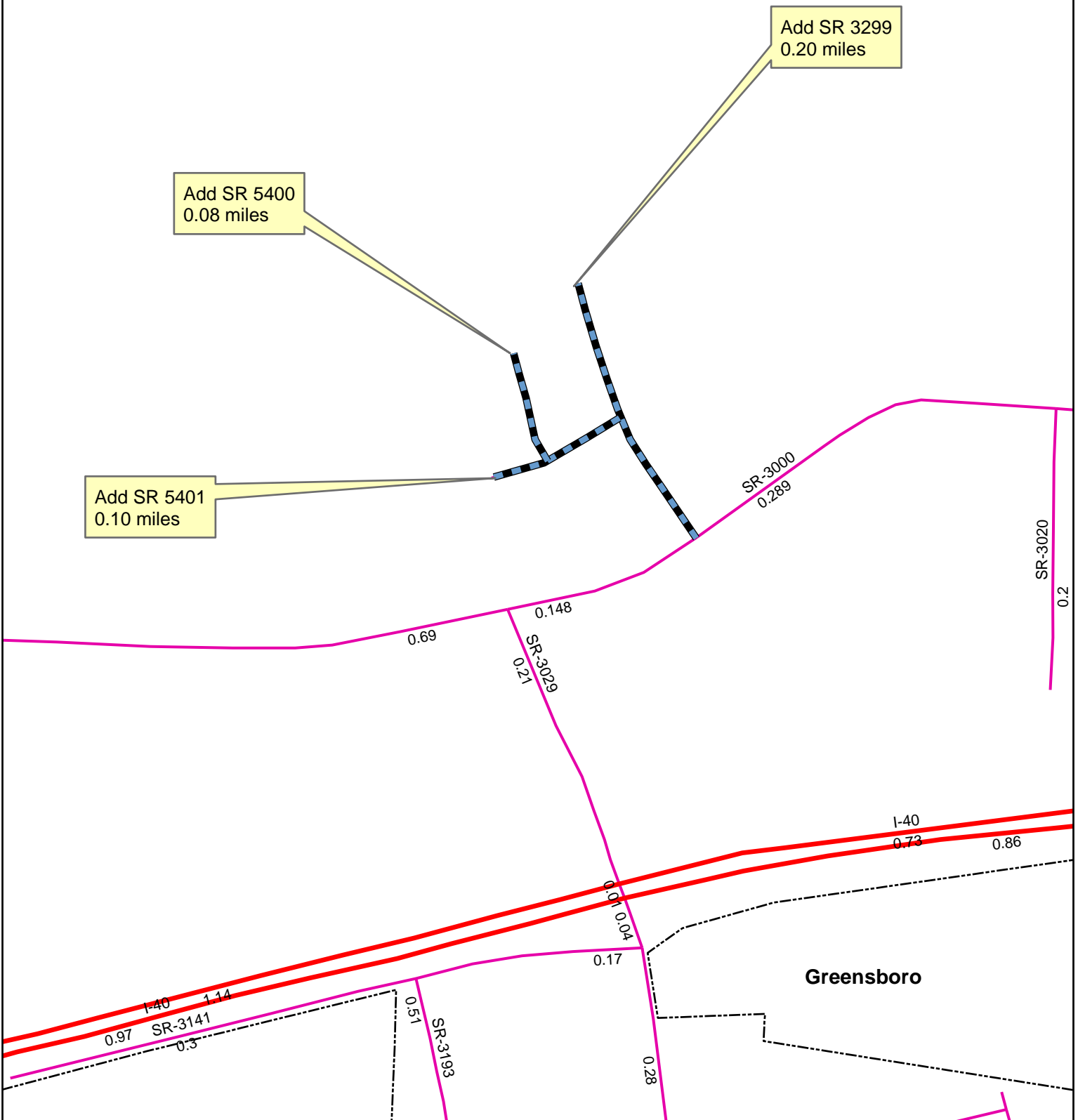

Source: Plat

NAME: RBT

SCALE: N/A

Map: A