



STATE OF NORTH CAROLINA  
DEPARTMENT OF TRANSPORTATION

MICHAEL F. EASLEY  
GOVERNOR

Tuesday, 12 August, 2008

LYNDO TIPPETT  
SECRETARY

**MEMORANDUM TO:** Mr. H. Allen Pope, PE  
Division Engineer  
Division 3

**FROM:** Information, Mapping, and Graphics Unit

**SUBJECT:** 2008 District 1 Road System Changes

The Road Inventory Information Section has been authorized to make the following changes to the state road system as indicated below. We request that you make similar changes to the related maps and files in your Division and District offices, and install appropriate road number signs if necessary. We have updated our records and county maps accordingly. If our system changes do not conform to the actual conditions in the field, please return this memorandum with recommendations.

Petition Number	County	Approval Date
48726	PENDER	7/10/2008

Inquires about changes should be referred to one of the following: Ron Tucker at (919) 212-6080 or Tom Schroder at (919) 212-6090. If you have further questions, please contact Hardee Cox, Road Inventory Information Section Manager at (919) 212-6060. Thank you for your assistance.

HRC  
enclosures ( )

- cc: BSIP  
 Bridge Maintenance  
 Division Right of Way  
 GIS  
 Pavement Management  
 Permit Unit  
 State Road Maintenance  
 Traffic Engineering  
 Traffic Surveys

# 2008 ROAD SYSTEM CHANGES

<b>PETITION NUMBER</b>	<b>COUNTY</b>	<b>APPROVAL DATE</b>	<b>NEW NUMBER</b>	<b>EXISTING NUMBER</b>	<b>STREET NAME</b>	<b>LENGT H</b>	<b>TYPE OF CHANGE</b>	<b>REMARKS (See Attached Map)</b>
48726	PENDER	7/10/2008	SR 1751		TANAGER WY		SYSTEM ADDITION VIA PETITION	MAP , SEGMENT
48726	PENDER	7/10/2008	SR 1750		AZALEA DR.	0.05	SYSTEM ADDITION VIA PETITION	MAP , SEGMENT

PETITION: 48726

CO: Pender

SR #: 1750 1751 \_\_\_\_\_

Approval Date: 10 Jun. 08

Map Date: 11 Aug. 08

\_\_\_\_\_  
\_\_\_\_\_  
\_\_\_\_\_



 Addition

 Deletion

 Reassignment

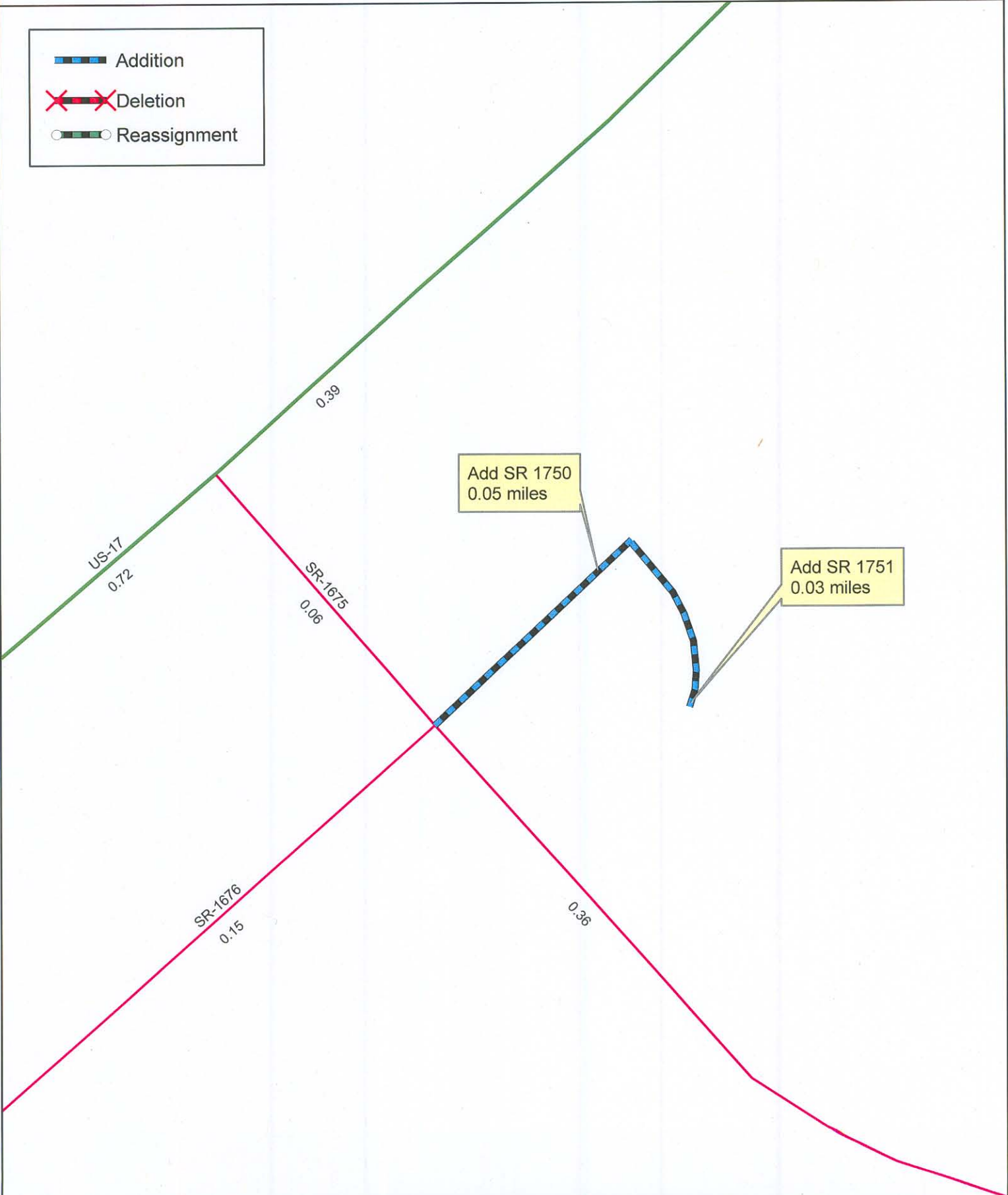

Source: Plat

NAME: RBT

SCALE: N/A

Map: A