



STATE OF NORTH CAROLINA  
DEPARTMENT OF TRANSPORTATION

Beverly Eaves Perdue  
GOVERNOR

Tuesday, 25 August, 2009

EUGENE A. CONTI, JR.  
SECRETARY

**MEMORANDUM TO:** Mr. Anthony W. Roper, PE  
Division Engineer  
Division 1

**FROM:** Information, and Mapping Unit

**SUBJECT:** 2008 District 1 Road System Changes

The Road Inventory Information Section has been authorized to make the following changes to the state road system as indicated below. We request that you make similar changes to the related maps and files in your Division and District offices, and install appropriate road number signs if necessary. We have updated our records and county maps accordingly. If our system changes do not conform to the actual conditions in the field, please return this memorandum with recommendations.

Petition Number	County	Approval Date
48675	DARE	6/5/2008

Inquires about changes should be referred to one of the following: For Primary Roads call Paulette Smith at (919)-212-6100, and for Secondary Roads call Ron Tucker at (919)-212-6085. Thank you for your assistance.

JLC  
enclosures ( )

- cc: BSIP  
Bridge Maintenance  
Division Right of Way  
GIS  
Pavement Management  
Permit Unit  
State Road Maintenance  
Traffic Engineering  
Traffic Surveys

---

# 2008 ROAD SYSTEM CHANGES

---

<b>PETITION NUMBER</b>	<b>COUNTY</b>	<b>APPROVAL DATE</b>	<b>NEW NUMBER</b>	<b>EXISTING NUMBER</b>	<b>STREET NAME</b>	<b>LENGT H</b>	<b>TYPE OF CHANGE</b>	<b>REMARKS (See Attached Map)</b>
48675	DARE	6/5/2008	SR 1359		LAURAL BAY	0.05	SYSTEM ADDITION VIA PETITION	MAP , SEGMENT
48675	DARE	6/5/2008	SR 1358		BUFFALO CITY CT.	0.05	SYSTEM ADDITION VIA PETITION	MAP , SEGMENT

PETITION: 48675

CO: Dare

SR #: 1358 1359 \_\_\_\_\_



Approval Date: 05 Jun.09

Map Date: 25 Aug. 09

\_\_\_\_\_  
\_\_\_\_\_  
\_\_\_\_\_



Legend:

-  Addition
-  Deletion
-  Reassignment

Add SR 1359  
0.05 miles

Add SR 1358  
0.05 miles

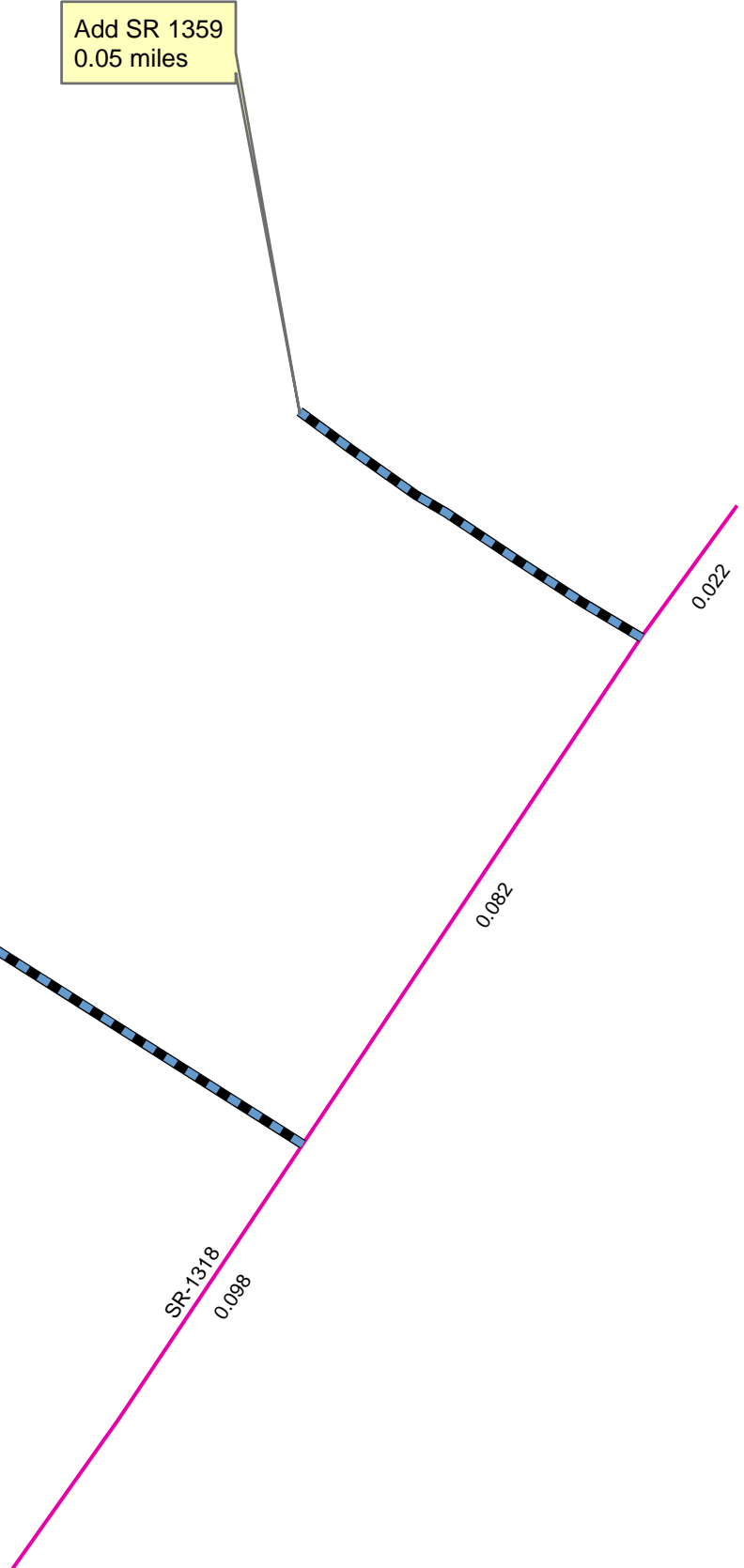

US-64

Source: Plat

NAME: RBT

SCALE: M/A

Map: X